

GERMAN 3 TONS AND PAK 40

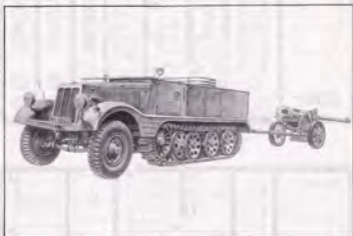

SPECIFICATION

1/72 SCALE

GENERAL

KIT 8349

CREW: DRIVER AND 8 MEN.

WEIGHT, COMBAT LOADED: 15,852 LBS.

DESIGNED TRAILER WEIGHT: 1,3 TO.

GROUND PRESSURE: HARD 42.7 LBS/SQ. IN. - SOFT GROUND 7.1 LBS/SQ. IN.

DIMENSIONS

LENGTH: 5.50 M.

HEIGHT: 2.20 M.

WIDTH: 2.00 M.

WIDTH OF TRACK: 28 CM.

GROUND CLEARANCE: 32 CM.

FRONT WHEEL CENTRES: 165 CM.

ENGINE

1 MAYBACH NL38TUR, 6 CYLINDERS IN LINE, WATER-COOLED, PETROL ENGINE OF 3,791 C.C. DEVELOPING 90 BHP AT 2,800 RPM OR 1 MAYBACH HL42TURM, 4,170 C.C. DEVELOPING 100 BHP AT 2,800 RPM.



MADE IN ITALY

PERFORMANCE

SPEED: MAX. ROAD 33 MPH.

FORDING DEPTH: 50 CM.

RADIUS OF ACTION: 155 MILES ON ROADS;
76 MILES CROSS-COUNTRY.

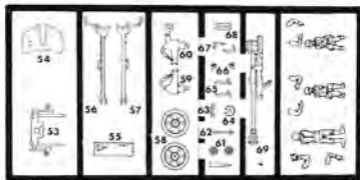
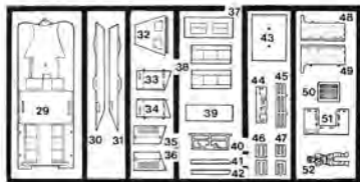
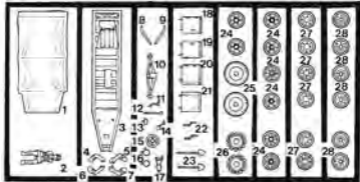

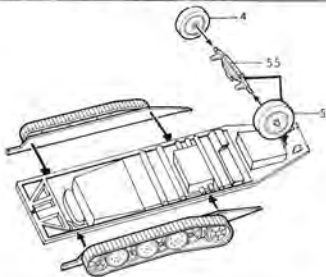
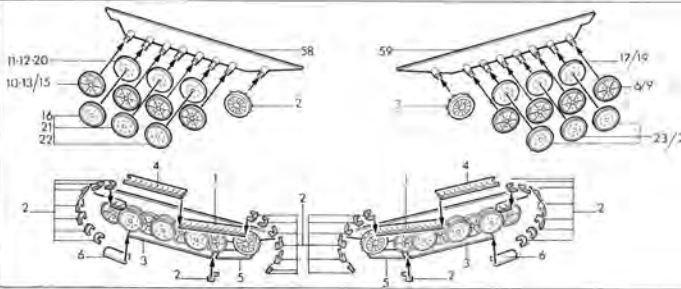

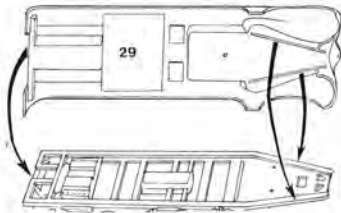
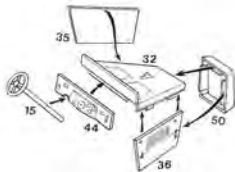
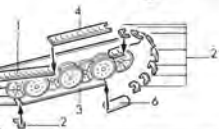
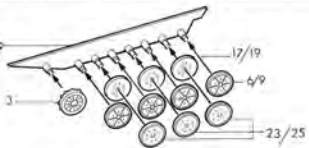

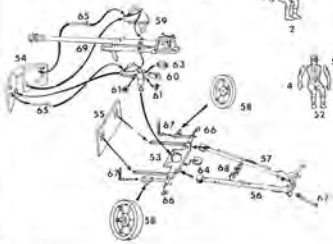
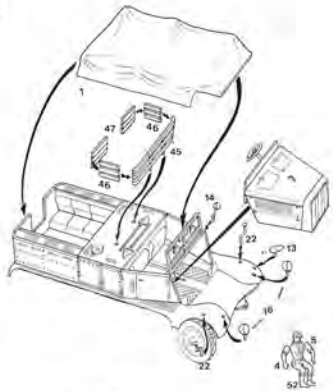
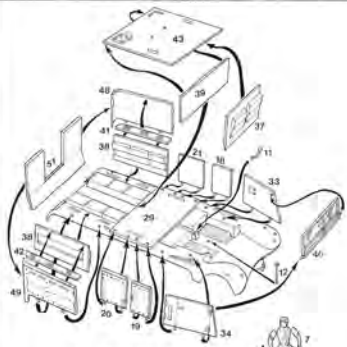

MARRONE
BACCHINI
BAGNOLA
BIALLE
BARTOLINI



1000
1000
1000
1000

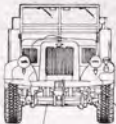

1000
1000
1000

1000
1000
1000
1000

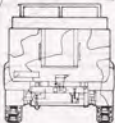

METALLO SPINITE
PUNTOLETTI METAL
METAL. BICAL
BORGHETTI & METALLOREANI
METAL. GRIFFINO



1000
1000
1000

1000
1000
1000