

FOR SUGGESTED DETAIL PAINTING SCHEME - SEE ILLUSTRATIONS. Paint parts as indicated and allow to dry before assembling.

For best results, use only AURORA'S SPEED-DRY ENAMEL - ONE COAT COVERS - DRIES IN 30 MINUTES - NO BRUSH MARKS.

PIPER *Aster*

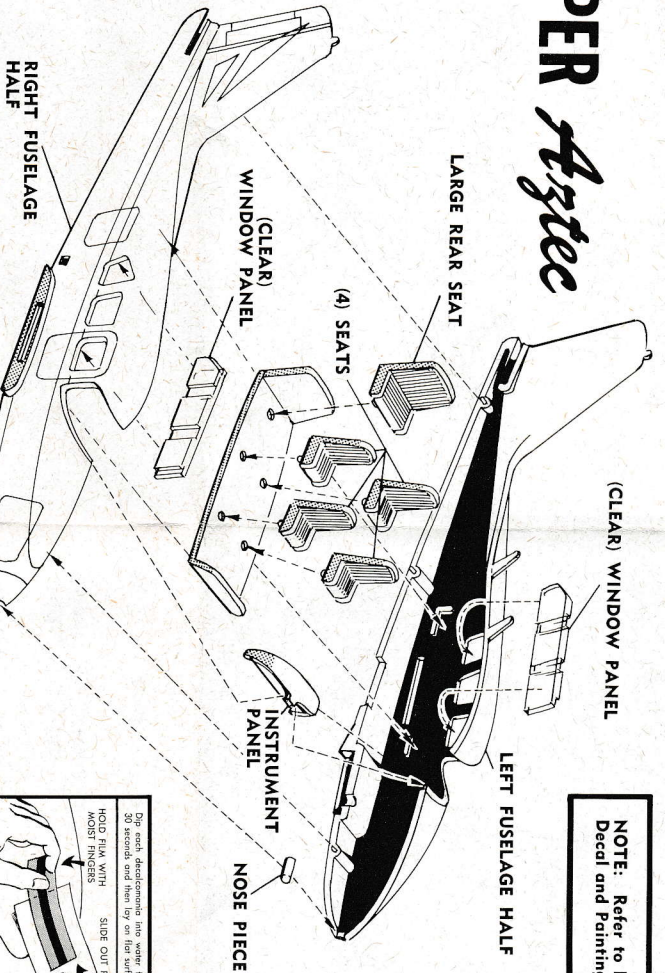

NOTE: Refer to Box Wrap Illustration for Decal and Printing Details.

1. Cement pins on (4) SMALL SEATS into holes in FLOOR PANEL ASSEMBLY and LARGE REAR SEAT at REAR of FLOOR PANEL.
2. Cement (CLEAR) SIDE WINDOW PANELS in position on inside of LEFT and RIGHT FUSELAGE HALVES.
3. Cement FLOOR PANEL ASSEMBLY at RIBS on inside of LEFT FUSELAGE. (Hold in position until dry.)
4. Cement INSTRUMENT PANEL in position at opening in LEFT FUSELAGE HALF and NOSE PIECE at FRONT of FUSELAGE.
5. Cement LEFT and RIGHT FUSELAGE HALVES together.

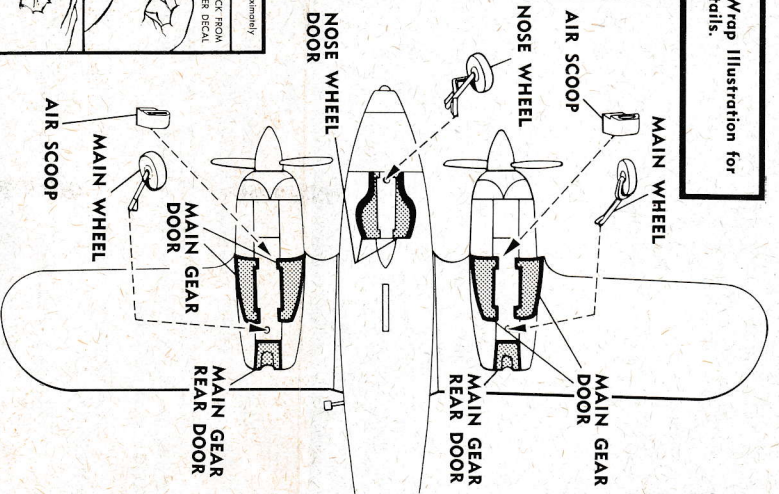
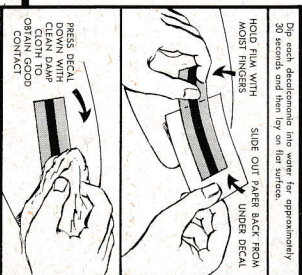

2

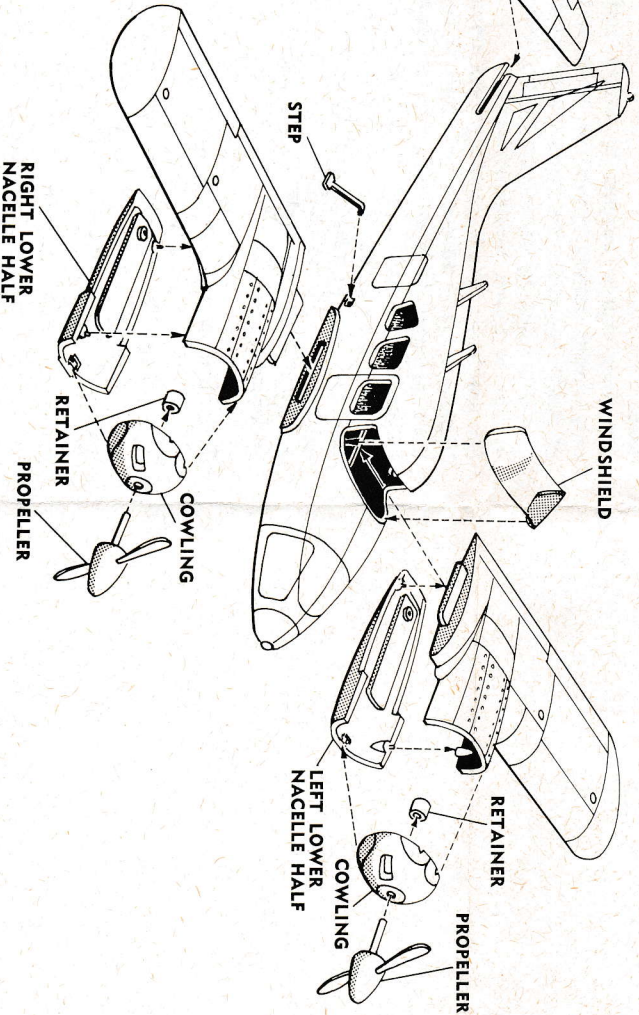

6. Cement LEFT LOWER NACELLE HALF to NACELLE on LEFT WING ASSEMBLY and RIGHT LOWER NACELLE HALF to NACELLE on RIGHT WING ASSEMBLY.
7. Cement LEFT and RIGHT WING ASSEMBLES to FUSELAGE. (Hold in position until dry.)
8. Carefully cement (CLEAR) WINDSHIELD into position.
9. Cement STABILIZER into slot at REAR of FUSELAGE.
10. Pass a PROPELLER SHAFT through hole in a cowling, then carefully cement a RETAINER over SHAFT end making sure PROPELLER turns freely. Repeat same procedure for remaining PROPELLER, RETAINER and COWLING.
11. Cement a cowling to front of LEFT and RIGHT NACELLES.
12. Cement STEP into hole in RIGHT SIDE of FUSELAGE.

3

13. See UNDERSIDE VIEW. Cement NOSE WHEEL and LEFT and RIGHT MAIN WHEELS into small holes as shown. (Hold in position until dry.)
14. Cement AIR SCOOPS in position on each NACELLE.
15. Cement NOSE WHEEL DOORS at each side of NOSE WHEEL. (Shown in position.)
16. Cement MAIN GEAR DOORS at each side of MAIN WHEELS and MAIN GEAR REAR DOORS behind MAIN WHEELS. (Shown in position.)
17. Cut out sections of DECALS to correspond with markings on MODEL. Read Directions on back of DECALS before applying. Allow to dry before any further handling.

FOR SUGGESTED DETAIL PAINTING SCHEME - SEE ILLUSTRATIONS. Paint parts as indicated and allow to dry before assembling.

For best results, use only AURORA'S SPEED-DRY ENAMEL - ONE COAT COVERS - DRIES IN 30 MINUTES - NO BRUSH MARKS.

PIPER *Aster*

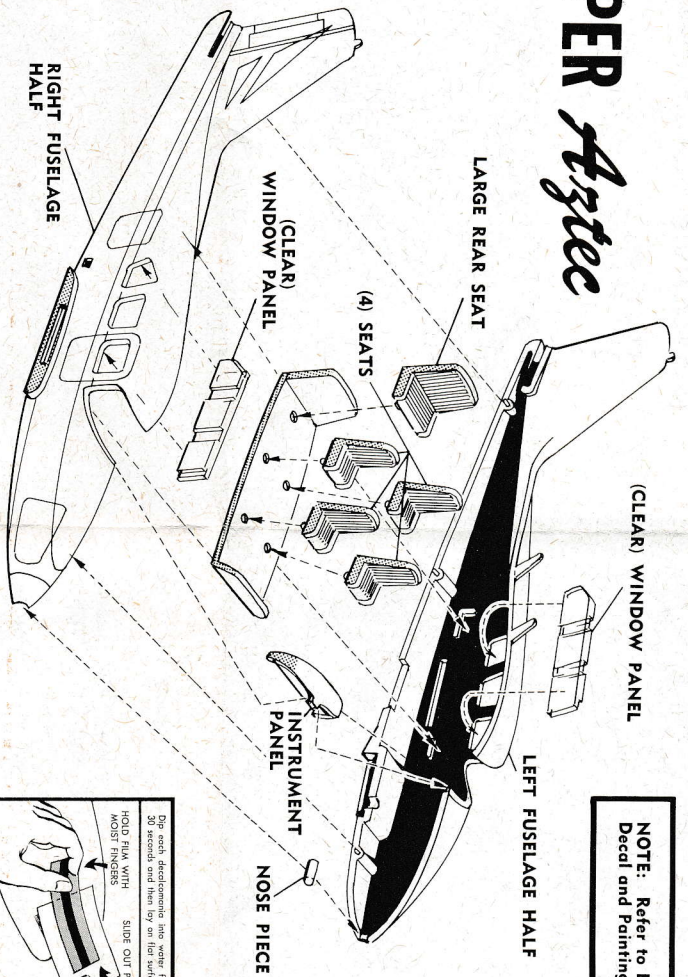

NOTE: Refer to Box Wrap Illustration for Decal and Painting Details.

1. Cement pins on (4) SMALL SEATS into holes in FLOOR PANEL ASSEMBLY and LARGE REAR SEAT at REAR of FLOOR PANEL.
2. Cement (CLEAR) SIDE WINDOW PANELS in position on inside of LEFT and RIGHT FUSELAGE HALVES.
3. Cement FLOOR PANEL ASSEMBLY at RIBS on inside of LEFT FUSELAGE. (Hold in position until dry.)
4. Cement INSTRUMENT PANEL in position at opening in LEFT FUSELAGE HALF and NOSE PIECE at FRONT of FUSELAGE.
5. Cement LEFT and RIGHT FUSELAGE HALVES together.

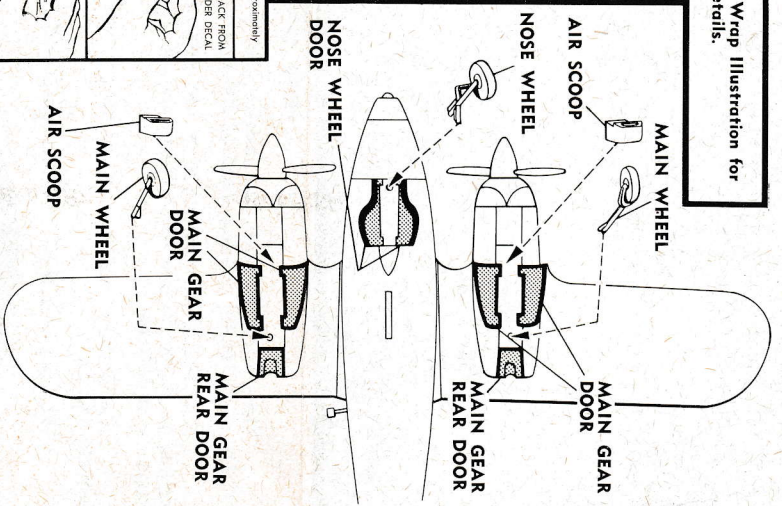
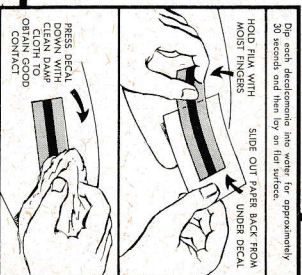

3

13. See UNDERSIDE VIEW, Cement NOSE WHEEL and LEFT and RIGHT MAIN WHEELS into small holes as shown. (Hold in position until dry.)
14. Cement AIR SCOOPS in position on each NACELLE.
15. Cement NOSE WHEEL DOORS at each side of NOSE WHEEL. (Shown in position.)
16. Cement MAIN GEAR DOORS at each side of MAIN WHEELS and MAIN GEAR REAR DOORS behind MAIN WHEELS. (Shown in position.)
17. Cut out sections of DECALS to correspond with markings on MODEL. Read Directions on back of DECALS before applying. Allow to dry before any further handling.

2

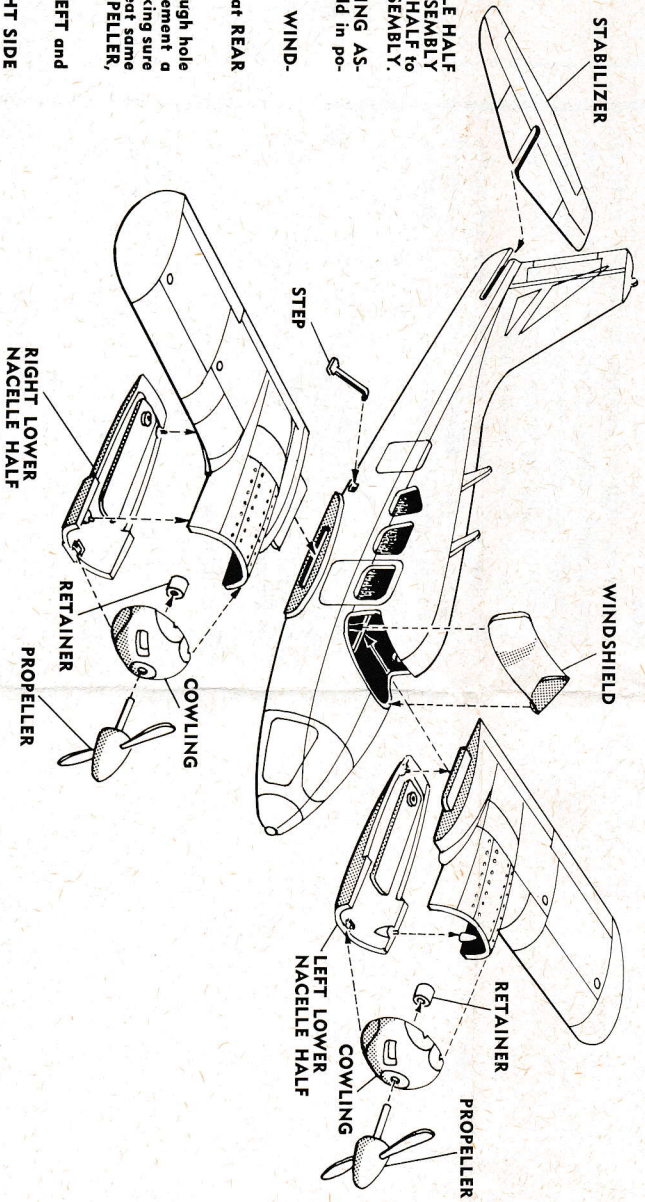

6. Cement LEFT LOWER NACELLE HALF to NACELLE on LEFT WING ASSEMBLY and RIGHT LOWER NACELLE HALF to NACELLE on RIGHT WING ASSEMBLY.
7. Cement LEFT and RIGHT WING ASSEMBLIES to FUSELAGE. (Hold in position until dry.)
8. Carefully cement (CLEAR) WINDSHIELD into position.
9. Cement STABILIZER into slot at REAR of FUSELAGE.
10. Pass a PROPELLER SHAFT through hole in a cowling, then carefully cement a RETAINER over SHAFT and making sure PROPELLER turns freely. Repeat same procedure for remaining PROPELLER, RETAINER and COWLING.
11. Cement a cowling to front of LEFT and RIGHT NACELLES.
12. Cement STEP into hole in RIGHT SIDE of FUSELAGE.

PIPER *Aztec*

AURORA

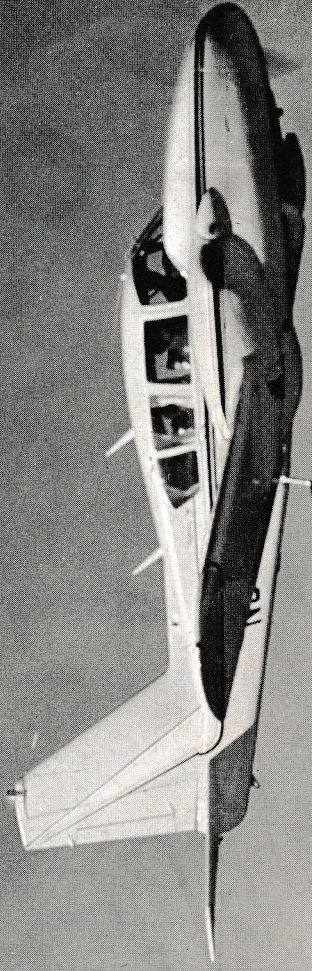
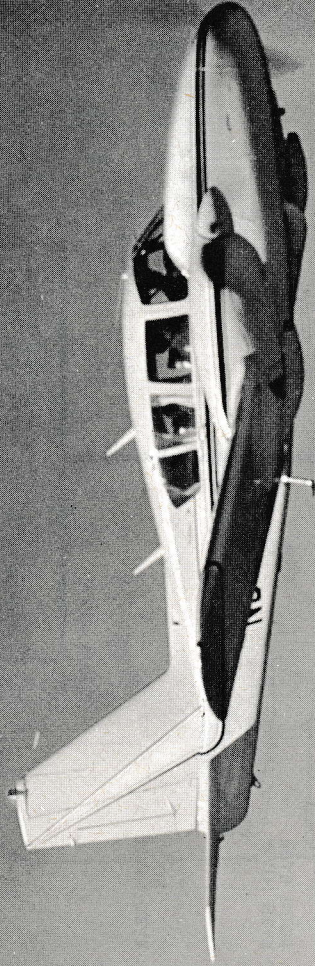

PIPER AZTEC

The Aztec C has twin fuel injected 250 hp Lycoming engines that will give a top speed of 216 m.p.h. and a cruising speed of 206 m.p.h.

The takeoff distance is 820 ft. Its rate of climb 1,490 ft. per minute. The absolute ceiling is 21,100 ft. and its cruising range is 1,055 to 1,250 miles. It also has a luggage capacity of 300 lbs.

The Aztec is widely used by corporation government agencies, military forces and private owners.

The wing span is 37 ft. It has an overall length of 30.2 ft. and a height of 10.3 ft.



Every effort has been made to insure the completeness of this Kit

IMPORTANT - READ THIS FIRST!

Before assembling model, study sketch carefully.

Important—Apply cement to inside surfaces only. Avoid getting cement on outer surfaces of model sections. Use cement very sparingly and avoid getting cement on hands, so as not to mar or smear plastic surfaces.

Do not hurry. Work carefully and patiently. **Important Note:** Before proceeding to cement parts together, it is advisable to fit parts together dry (without cement) so that you may familiarize yourself with the parts and how they go together, also noting the points where cement is to be applied.

For best results assemble model exactly in the order indicated.

**This kit is molded of styrene plastic—
Use only**

**Aurora's Fireproof Styrene Cement
and Aurora's Speed-Dry Enamel. Assure
yourself of a perfect model every time!**

THIS KIT IS MOLDED OF STYRENE PLASTIC

Use Only . . .

**AURORA'S
FIREPROOF
STYRENE PLASTIC
CEMENT**



"THE ENAMEL WITH THE SPRAYED ON LOOK"



- ONE COAT COVERS
- NO BRUSH MARKS
- DRIES IN 30 MINUTES

SPEED-DRY ENAMELS are AURORA'S REVOLUTIONARY NEW ENAMEL PAINTS developed after years of research especially for Plastic Models and other products of Wood, Metal, Glass or China.