

"Cut from decal sheet the section required. Place in warm water for 10-15 seconds. Slide from backing sheet directly on to model. Locate accurately and press down with soft cloth, removing excess water at same time."

In case of complaint please complete this section and send to:



Pioneer 2 Models 46 Haworth Road, Crossroads, Keighley, BD22 9DL, UK.

NAME _____

ADDRESS _____

Quoting where purchased _____

date purchased _____

missing part no _____

1/72 Scale Series 4 4005

PIONEER 2

46 HAWORTH ROAD
CROSSROADS,
KEIGHLEY
W. YORKSHIRE BD22 9DL
ENGLAND

Horten Ho-229 A-1 (Ho-IX)

The Horten IX was discovered by the US forces at the Gotha factory in Friedrichsroda in 1945 and from that time, this aircraft has been incorrectly designated the Gotha 229. In fact, the brothers Horten were using these facilities to further develop their experimental tailless fighter. This project was for a jet-powered all-wing aircraft and the proto-type first flew in January 1945. It is understood the handling characteristics were excellent and since Horten were intent, on developing second and third generation aircraft from this version, it would be interesting to consider the qualities of the ultimate aircraft.

Intended armament of the Horten Ho 229 was to be four HK 103 or 108 cannon with provision for 2 x 1000 kgs. bombs.

The front cover illustration (by Don Greer of Squadron/Signal) illustrates the colour scheme of one of the prototypes:

Upper Surfaces	RLM75 Gray/Violet
Lower Surfaces	RLM76 Light Blue
Wing Walk	RLM28 Wine Red
Serial Numbers	RLM22 Black



The who is aircraft would then be covered in RLM00 waterbright, a clear finish suitable for polishing.

The sole surviving aircraft is a waiting restoration at the National Air and Space Museum, Silver Hill, Maryland.

Colour Scheme:	Upper Surface	RLM82 Bright Green
		RLM83 Dark Green
	Under Surface	RLM76 Light Blue

There were proposal to paint these aircraft in single colours only for the upper surfaces and it is suggested that apart from RLM82 RLM83 also RLM81 Brown-violet might have been used.

Specification:	Powerplant	2 Jumo 004B turbojets
	Span	55' (16,75 m)
	Length	24'6" (7,47)
	Height	9'2" (2,80m)
	Max Speed	607mph (977 kph)
	Ceiling	52500' (16000 m)

		
GLUE	CUT	OPTIONAL CHOICE

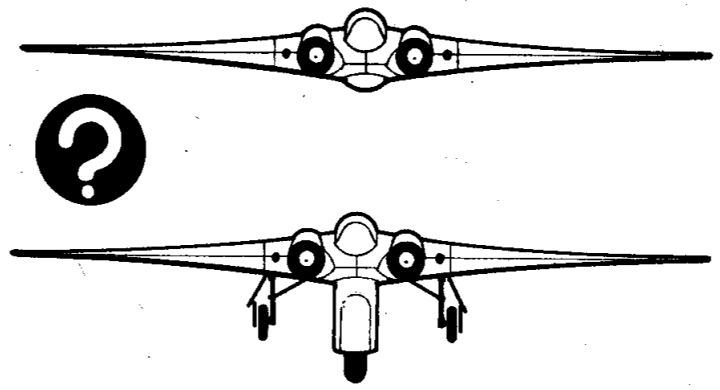
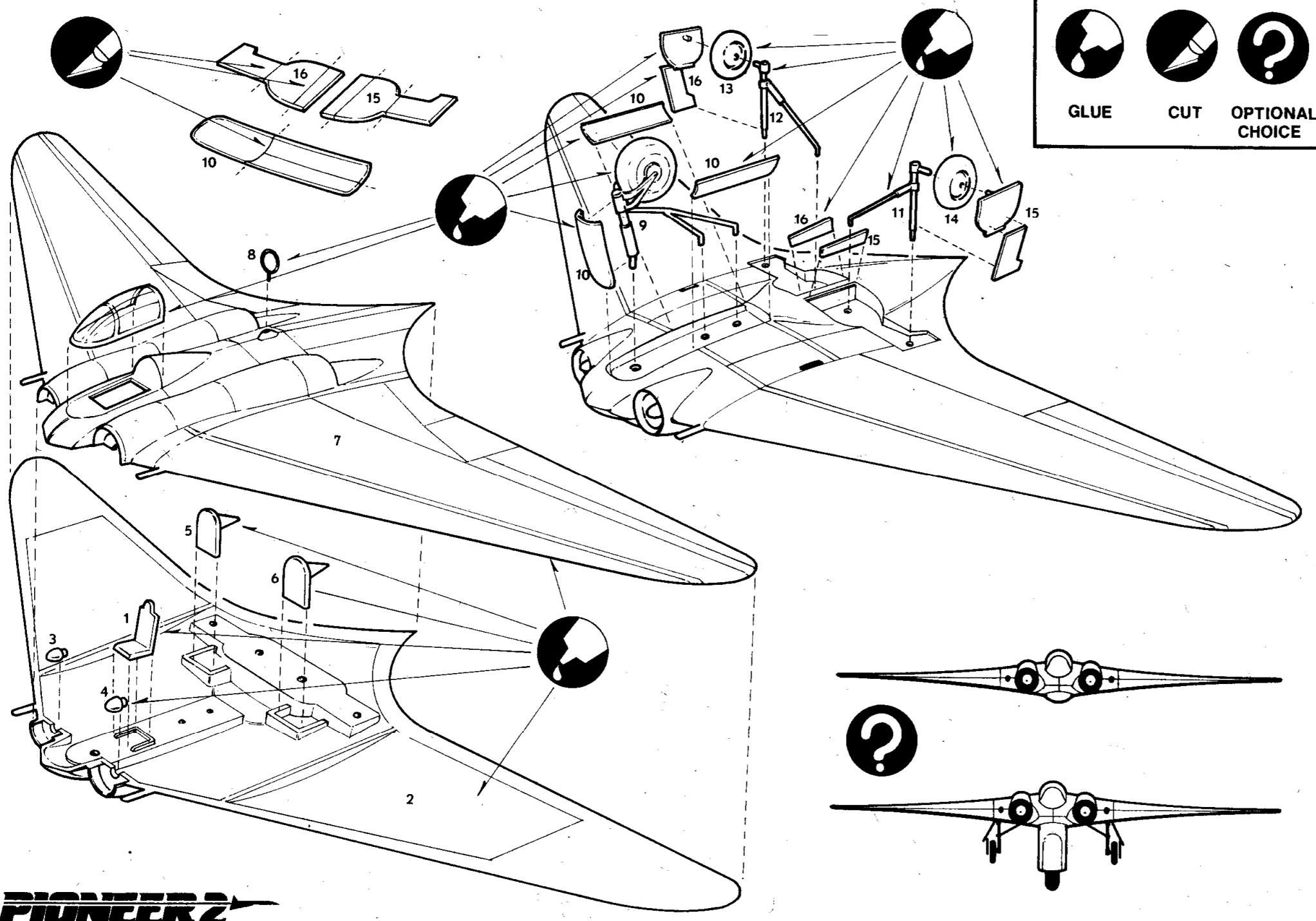

PIONEER 2

PRINTED IN TURKEY

Horten

Ho-229 A-1 (Ho-IX)

German Experimental
Single Seat Flying Wing

PIONEER 2

SERIE 4 4005

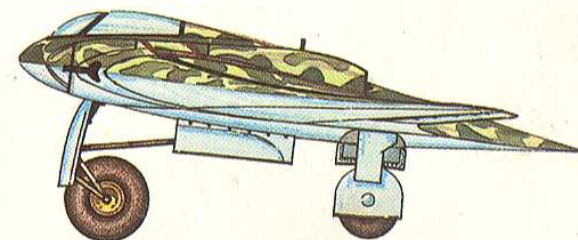
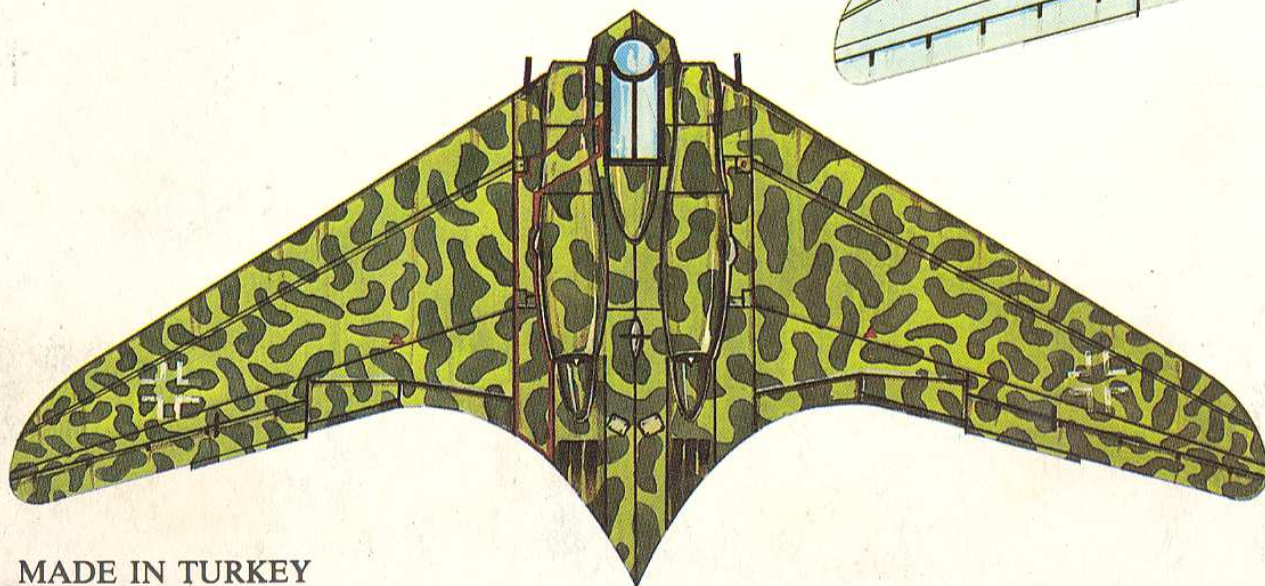
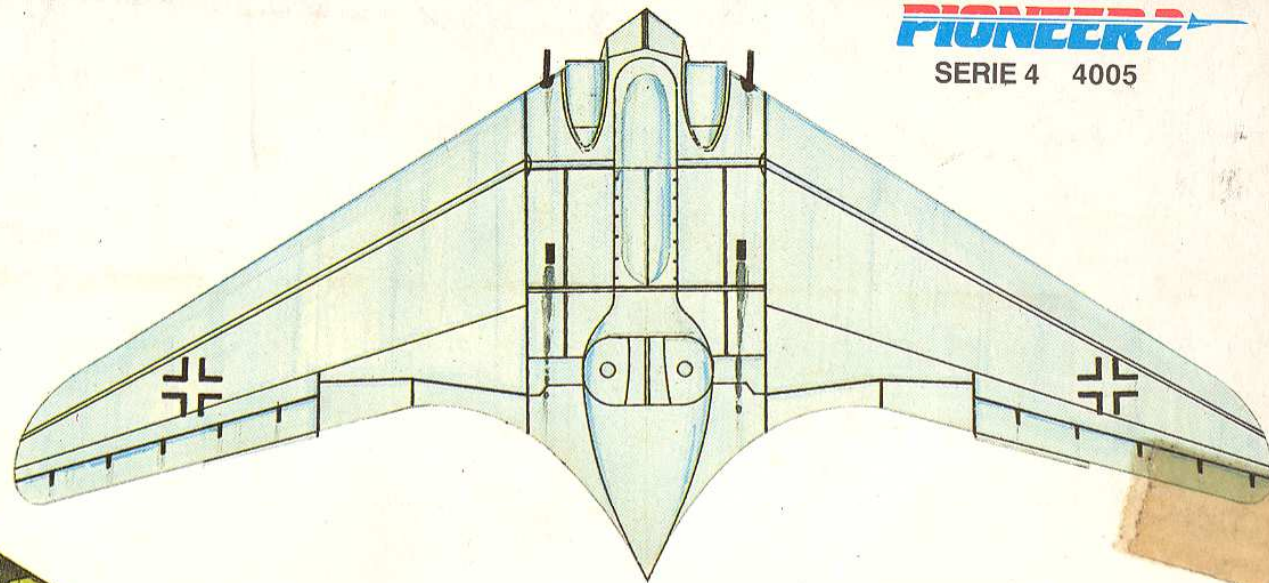

MADE IN TURKEY