



KIT 2354

85235400200

# Corvette® C5-R™

The 24 Hours of Le Mans, held every year in the middle of June in Le Mans, France, is considered the most difficult race in the world. It is not just an endurance of the cars but also of the men that drive them and the crews that keep them running. In the year 2000 General Motors and Chevrolet sent their C5-R Corvette Team to do battle. The American team of Pratt&Miller Engineering / Corvette Racing went head to head with the French team of Oreca Pacing Team Viper. This was a muscle car revival of the 60's era Chrysler vs. Chevy heydays!

The two Corvette's split the three Vipers in qualifying with the 2nd spot going to the #63 C5-R and 3rd to the #64 C5-R. The Vipers took 1st, 4th and 5th. The stage was set for a fight to the end.

all through the first evening, that night and the next morning, the Corvette / Viper dual ran the pace of a sprint race, not an endurance race. The #64 car had run as high as 2nd place, pushing the lead #51 Viper to run as hard as it could go! The #63 Corvette had also pushed for the lead until a stop for a new gearbox had cost it six laps, dropping it to 4th place. The #64 C5-R had to settle for a 3rd place podium finish due to a faulty starter, but both Corvette's finished the gruelling race 10th and 11th overall. An excellent finish for what was General Motors, Chevrolet's and Corvette's first factory supported effort at the world's most famous race!



The powerplant is a 600 h.p. aluminum small block Chevrolet® V8. The sleek fiberglass body uses a production windshield, taillights and marker lights, but the race car body work includes aerodynamic devices like a front air dam with an extended splitter and a rear mounted underbody diffuser, along with an independent rear wing. The complete race car rides on modular aluminum BBS wheels, shod with a set of Goodyear Eagle racing tires. Your Revell kit builds into an accurate replica of this radical Corvette race car!



\* REPEAT SEVERAL TIMES  
\* A REPETER PLUSIEURS FOIS



\* OPTIONAL PARTS  
\* PIECES EN OPTION



\* DECAL  
\* DECAL COMANIE



\* ALTERNATIVE ASSEMBLY  
\* ENSEMBLAGE ALTERNATIVE



\* CEMENT TOGETHER  
\* A COLLER



\* REMOVE AND THROW AWAY  
\* A RETIRER ET JETER



\* DO NOT CEMENT  
\* NE PAS COLLER

### READ THIS BEFORE YOU BEGIN

- Study the assembly drawings.
- Each plastic part is identified by a number.
- In the assembly drawings, some parts will be marked by a star (\*) to indicate chrome plated plastic.
- For better paint and decal adhesion, wash the plastic parts in a mild detergent solution. Rinse and let air dry.
- Check the fit of each piece before cementing in place.
- Use only cement for polystyrene plastic.
- Scrape plating and paint from areas to be cemented.
- Allow paint to dry thoroughly before handling parts.
- Any unused parts may be discarded.

### DECAL APPLICATION INSTRUCTIONS

1. Cut desired decal from sheet.
2. Dip decal in water for a few seconds.
3. Place wet decal on paper towel.
4. Wait until decal is movable on paper backing.
5. Place decal in position on model, face up and slide backing away.
6. Press out air bubbles with a soft damp cloth.
7. Milkyness that may appear is for better decal adhesion and will dry clear. Wipe away any excess adhesive.
8. Do not touch decal until fully dry.
9. Allow the decals 48 hours to dry before applying clear coat.

### LIRE CE QUI SUIT AVANT DE COMMENCER

- Etudier les schémas de montage.
- Chaque pièce en plastique est identifiée par un numéro.
- Sur les schémas de montage, certaines pièces sont marquées d'une étoile (\*) pour indiquer qu'elles sont en plastique chromé.
- Pour une meilleure prise de la peinture et des autocollants, laver les pièces en plastique avec une solution détergente peu concentrée. Les rincer et les laisser sécher à l'air.
- Vérifier que chaque pièce s'ajuste bien avant de la coller en place.
- N'utiliser que de la colle pour polystyrène.
- Gratter les parties à coller pour enlever le chrome et la peinture.
- Laisser la peinture bien sécher avant de manipuler les pièces.
- Toute pièce inutilisée peut être jetée.

### DIRECTIVES D'APPLICATION DES AUTOCOLLANTS

1. Découper l'autocollant désiré de la feuille.
2. Tremper l'autocollant dans de l'eau pendant quelques secondes.
3. Placer l'autocollant mouillé sur une serviette en papier.
4. Attendez que l'autocollant puisse être déplacé sur son support en papier.
5. Mettre l'autocollant en position sur le modèle face sur le dessus et faire glisser le support pour l'enlever.
6. Appuyer avec un chiffon doux humide pour éliminer les bulles d'air.
7. La substance laiteuse qui peut apparaître est destinée à améliorer l'adhésion de l'autocollant et devient incolore au séchage. Essuyer pour enlever tout excédent d'adhésif.
8. Ne pas toucher l'autocollant tant qu'il n'est pas bien sec.
9. Laisser l'autocollant sécher pendant 48 heures avant d'appliquer une couche transparente.

This optional paint guide is provided if you choose to detail paint your model.

Ce guide de peinture vous sera fourni si vous choisissez de peindre votre modèle en détail.

Aluminum	Aluminium
Satin Black	Noir satiné
Flat Black	Noir mat
Gloss Black	Noir lustré
Gloss Red	Rouge lustré
Gloss Yellow	Jaune lustré
Gloss White	Blanc lustré
Silver	Argent
Steel	Acier
Gunmetal	Bronze
Jet Exhaust	Flux d'éjection
Transparent Blue	Bleu transparent
Transparent Red	rouge transparent
Turn Signal Amber	Feu de virage amber

If you have any questions or comments, call our hotline at: **(800) 833-3570**  
or, please write to:

Revell-Monogram Consumer Service Department, 8601 Waukegan Road, Morton Grove, Illinois 60053

Be sure to include the plan number (85235400200), part number, description, your return address and phone number.

Visit our website: [www.revell-monogram.com](http://www.revell-monogram.com)

# 1

# ENGINE ASSEMBLY

**A**

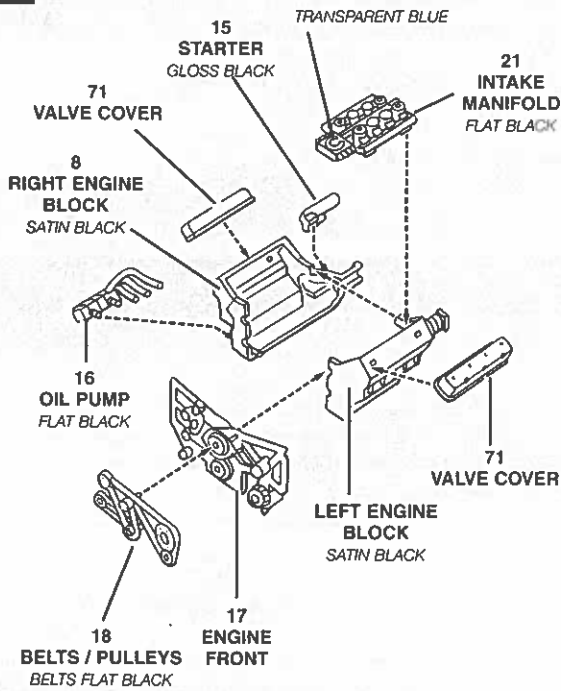

**B**

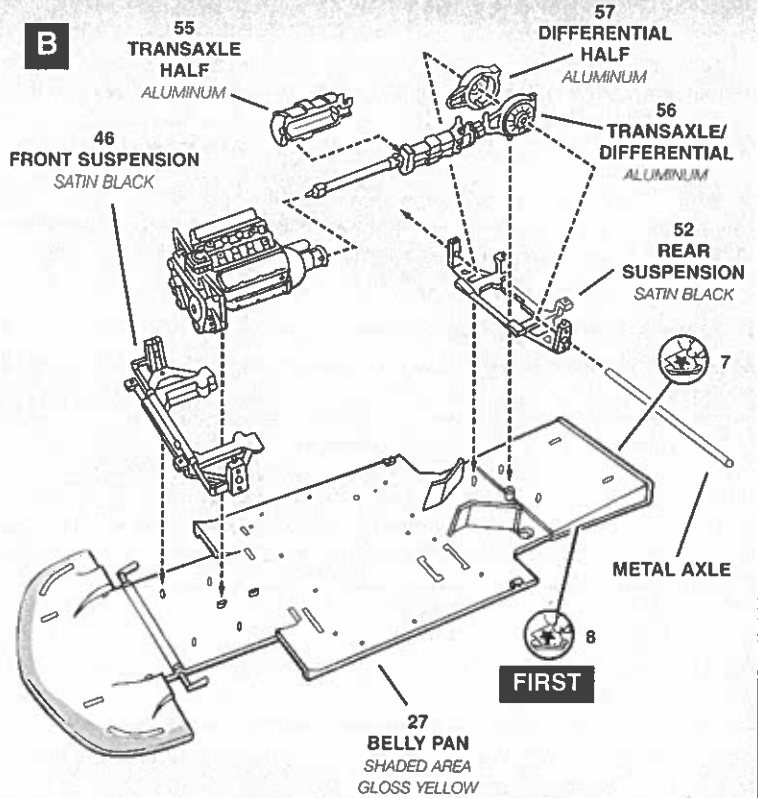

# 2

# ROLL CAGE ASSEMBLY

**A**

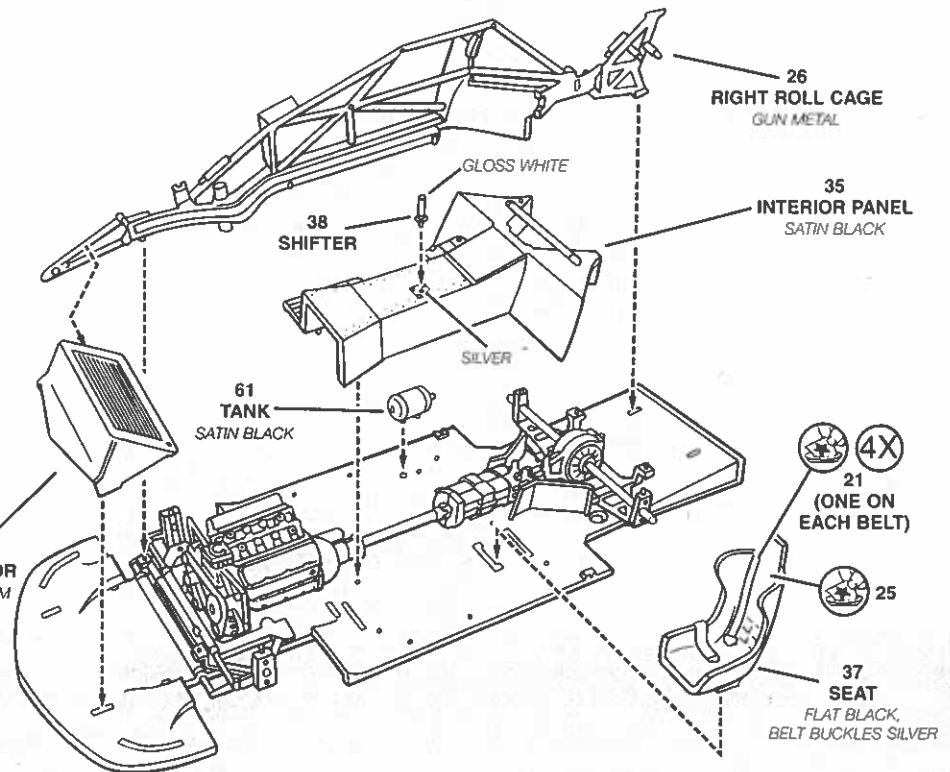
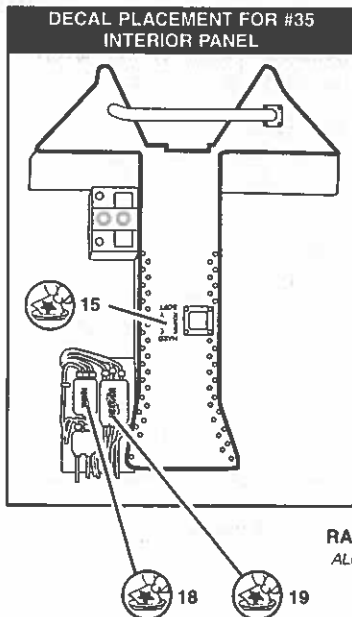

# 2

# ROLL CAGE ASSEMBLY CONTINUED

**B**

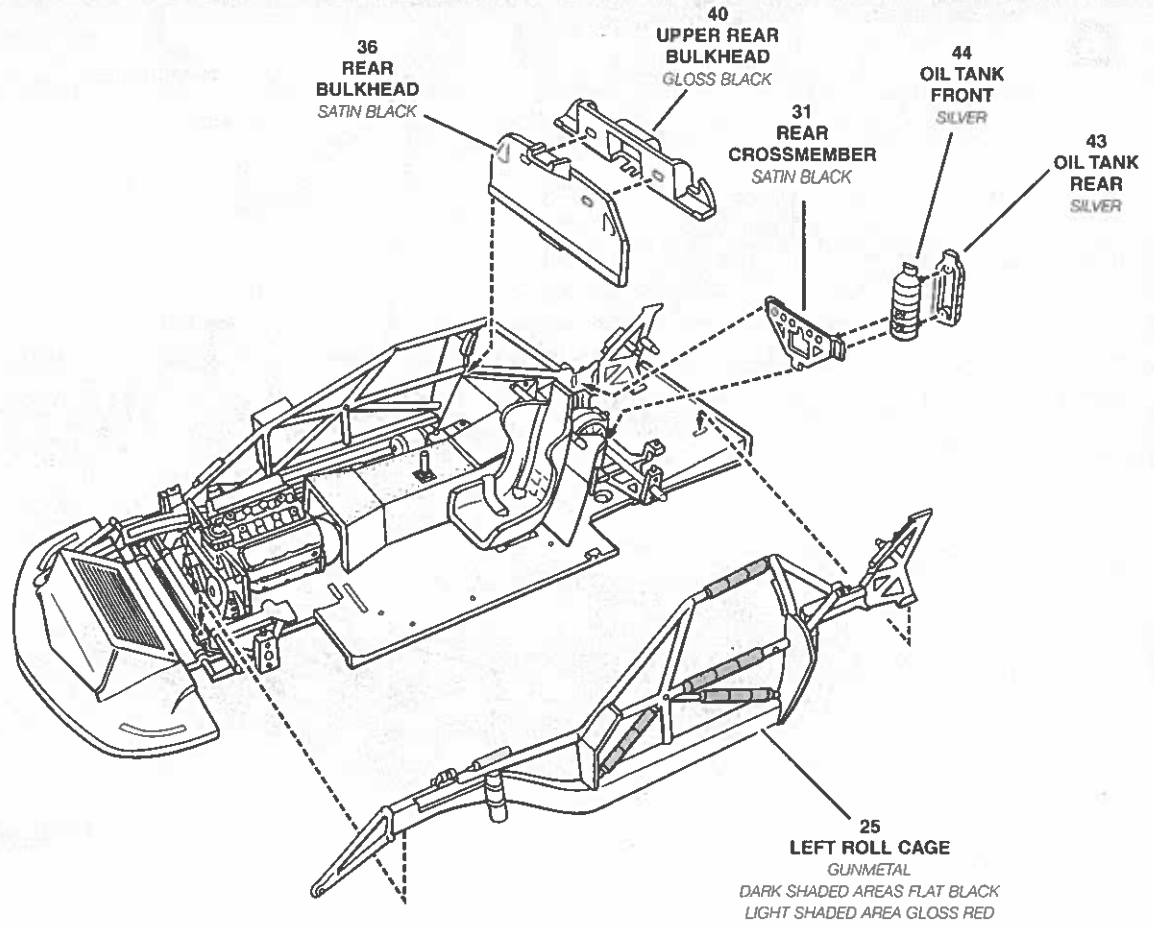

# 3

# COOLING DUCT ASSEMBLY

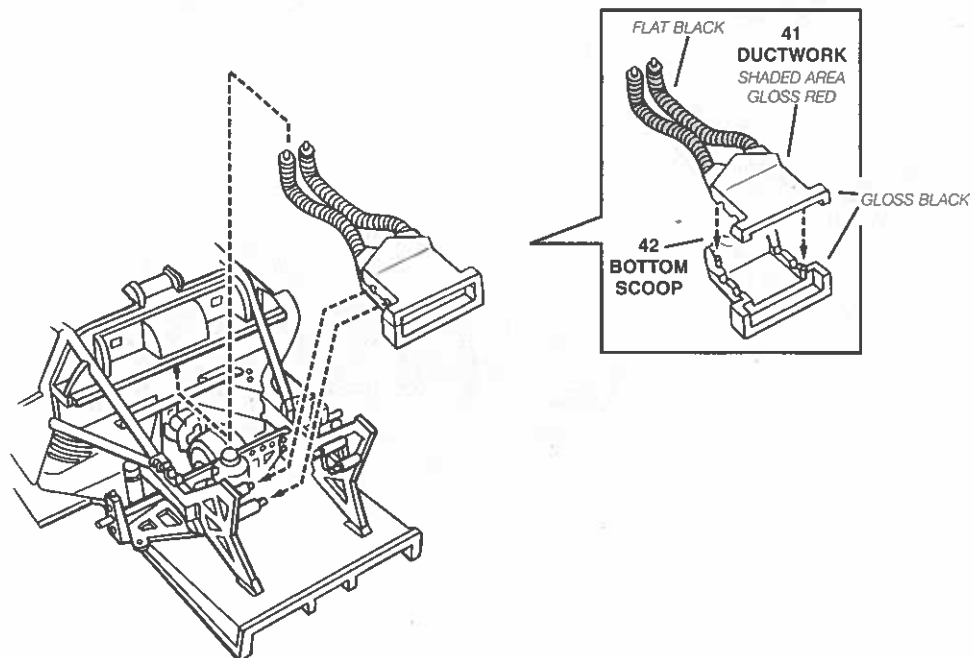

# 4

# BRACE AND DASHBOARD ASSEMBLY

**A**

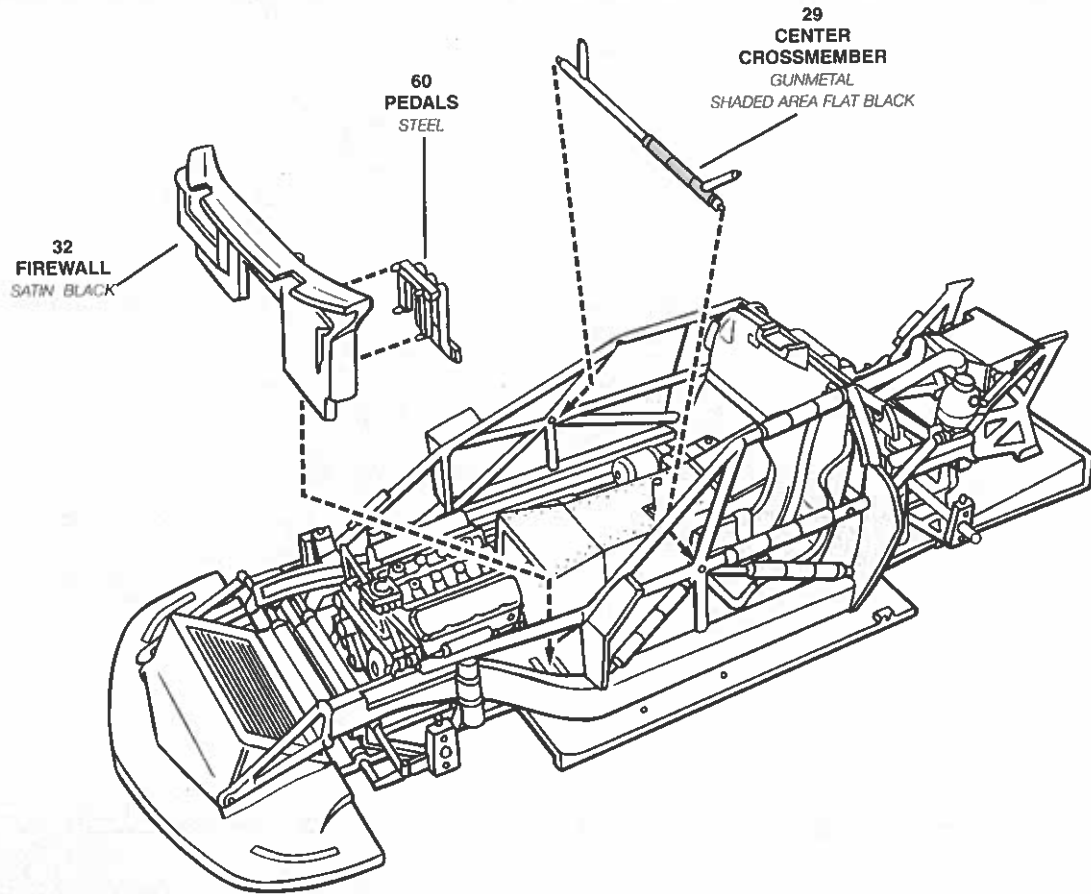

**B**

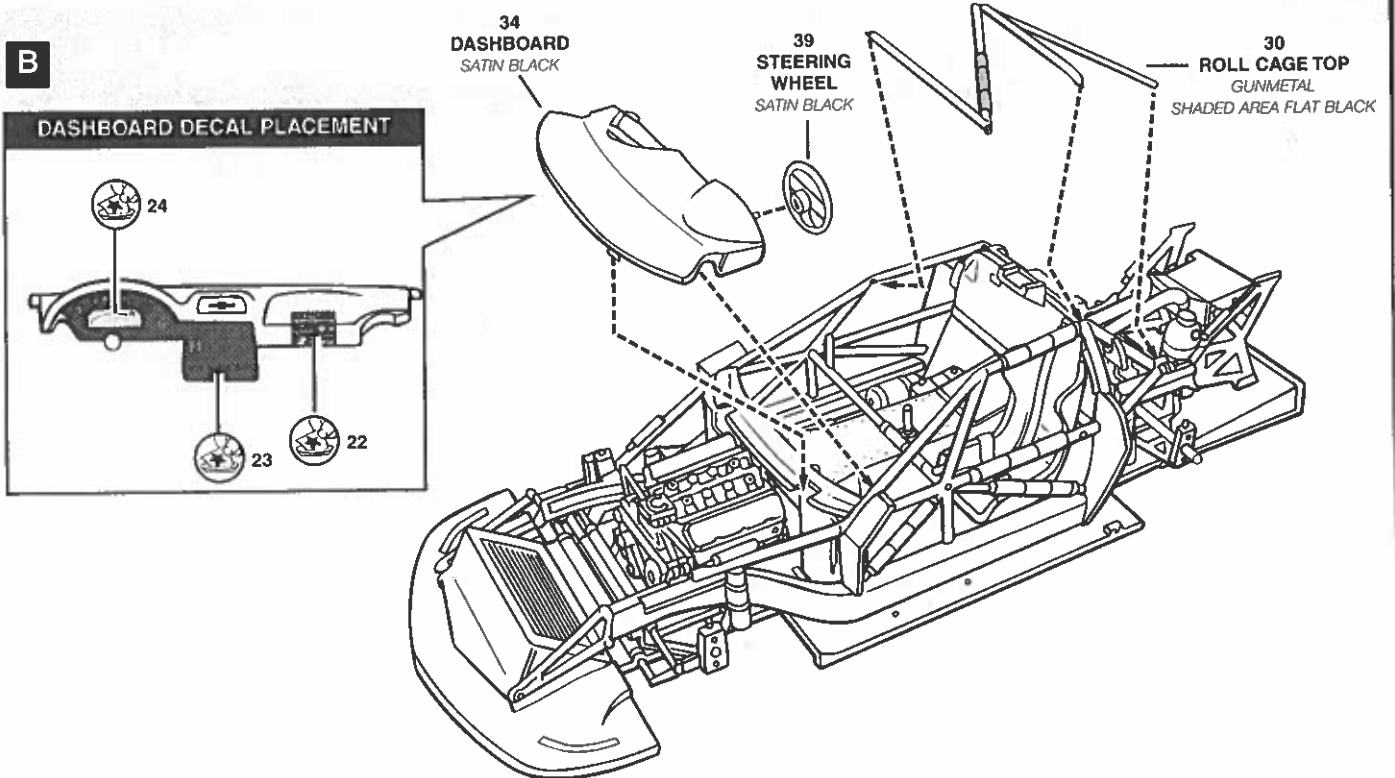

# 5

# SUSPENSION AND INTAKE ASSEMBLY

**A**

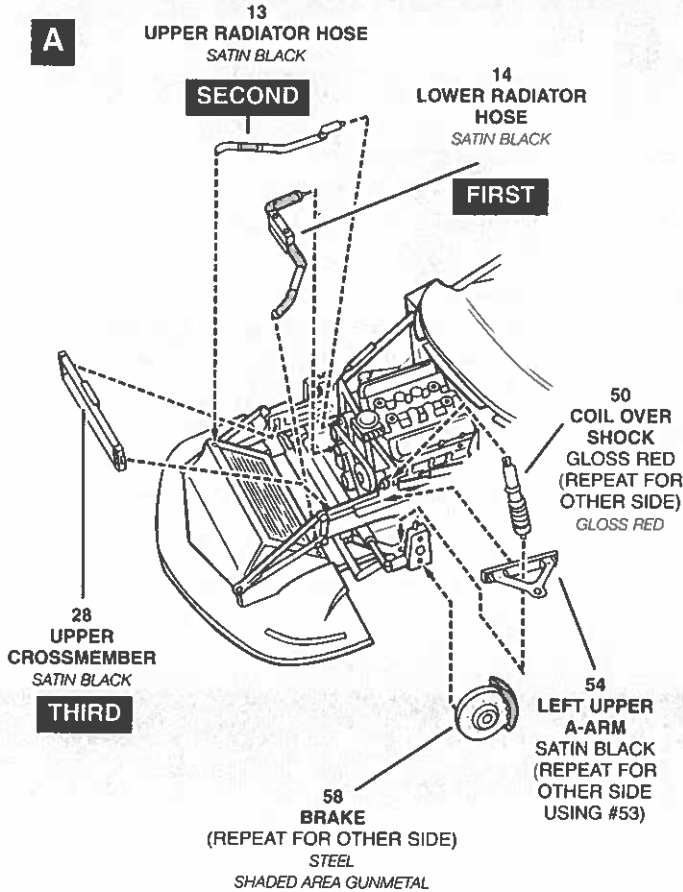

**B**

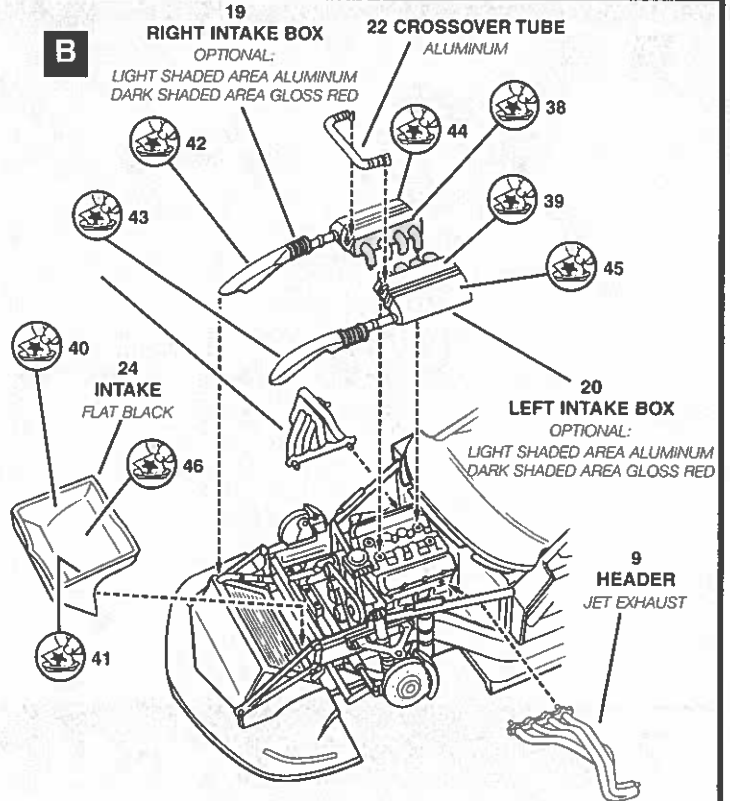

**C**

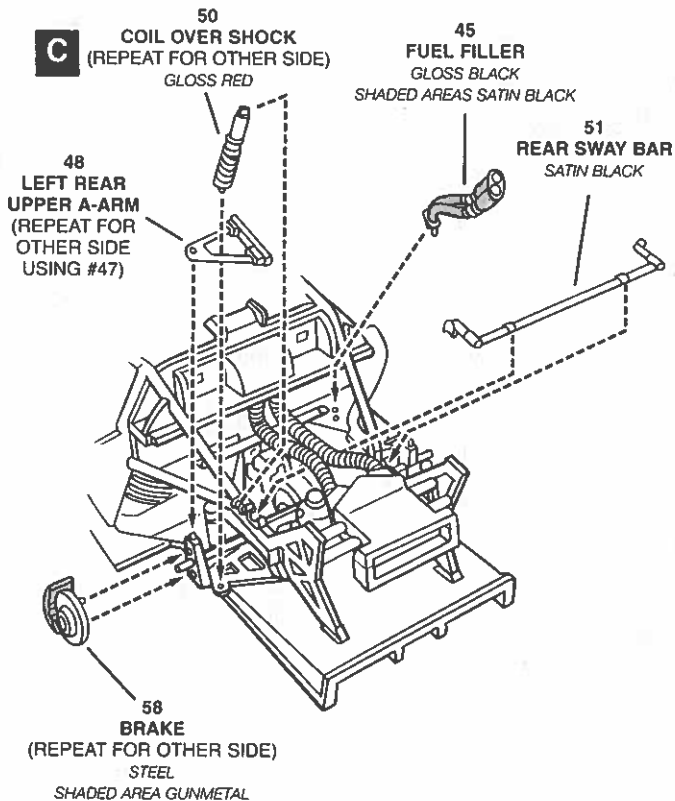

**D**

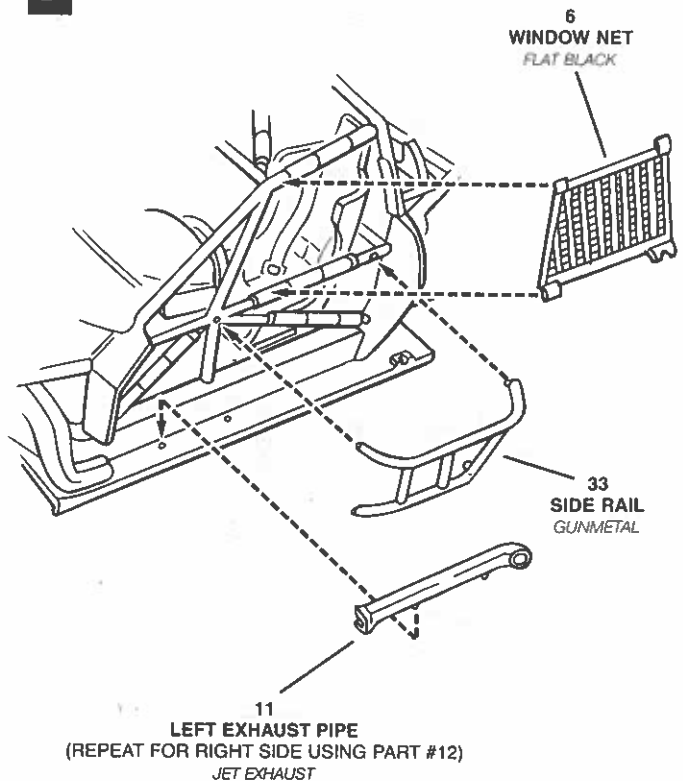

# 6

# WHEEL ASSEMBLY

**A** (2X)

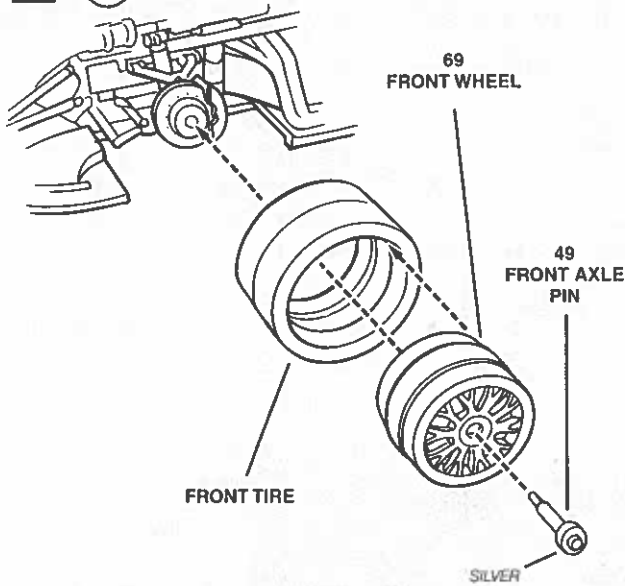

**B** (2X)

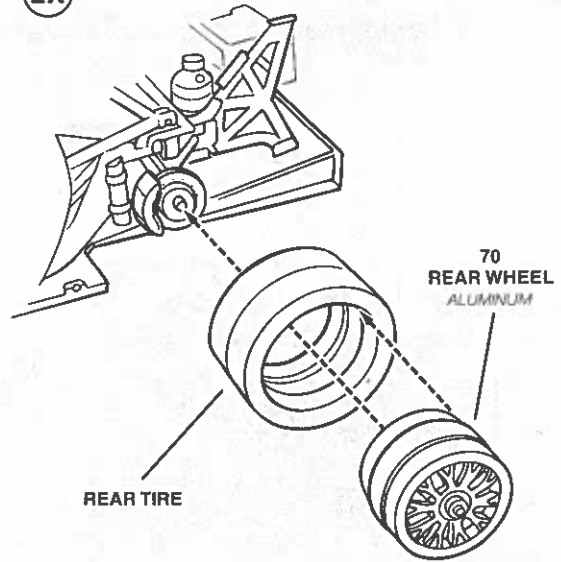

# 7

# FINAL ASSEMBLY

**A**

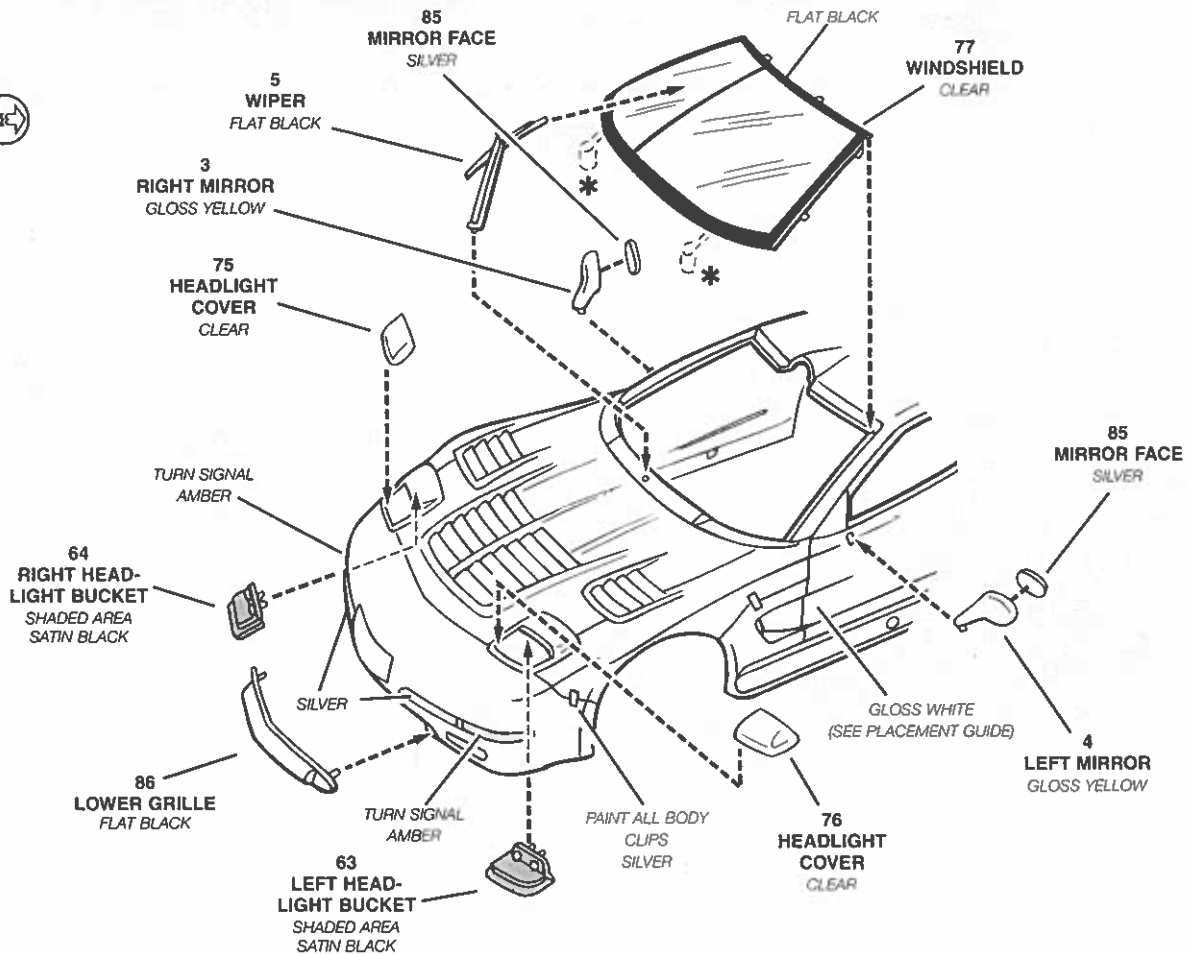

**B**

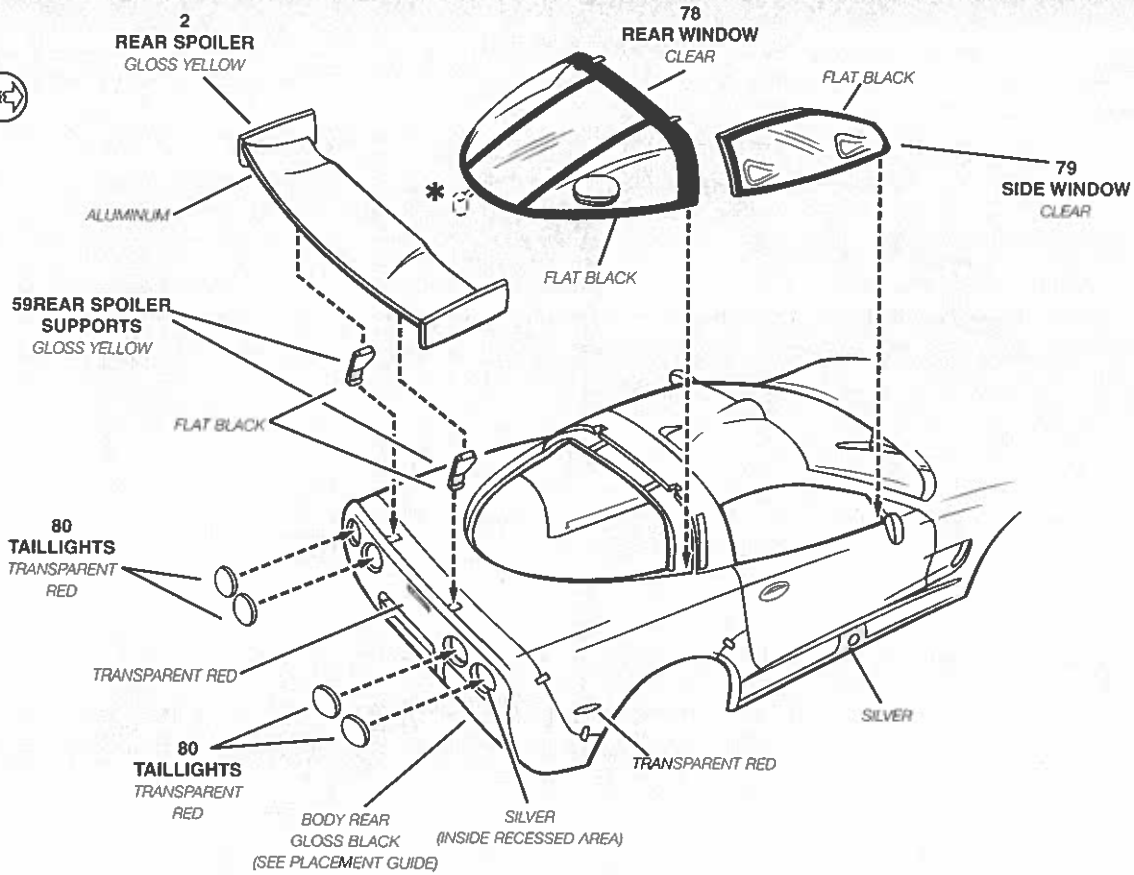

**C**

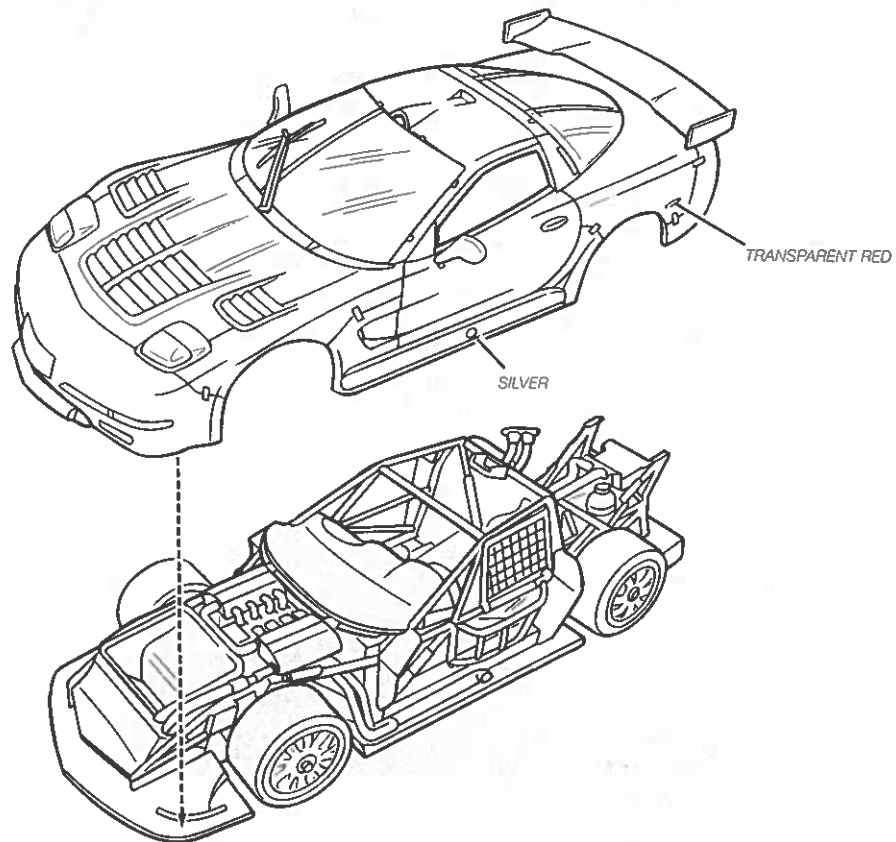



# DECAL PLACEMENT

- Yellow
- White

Apply Decals 16 and 17 first.

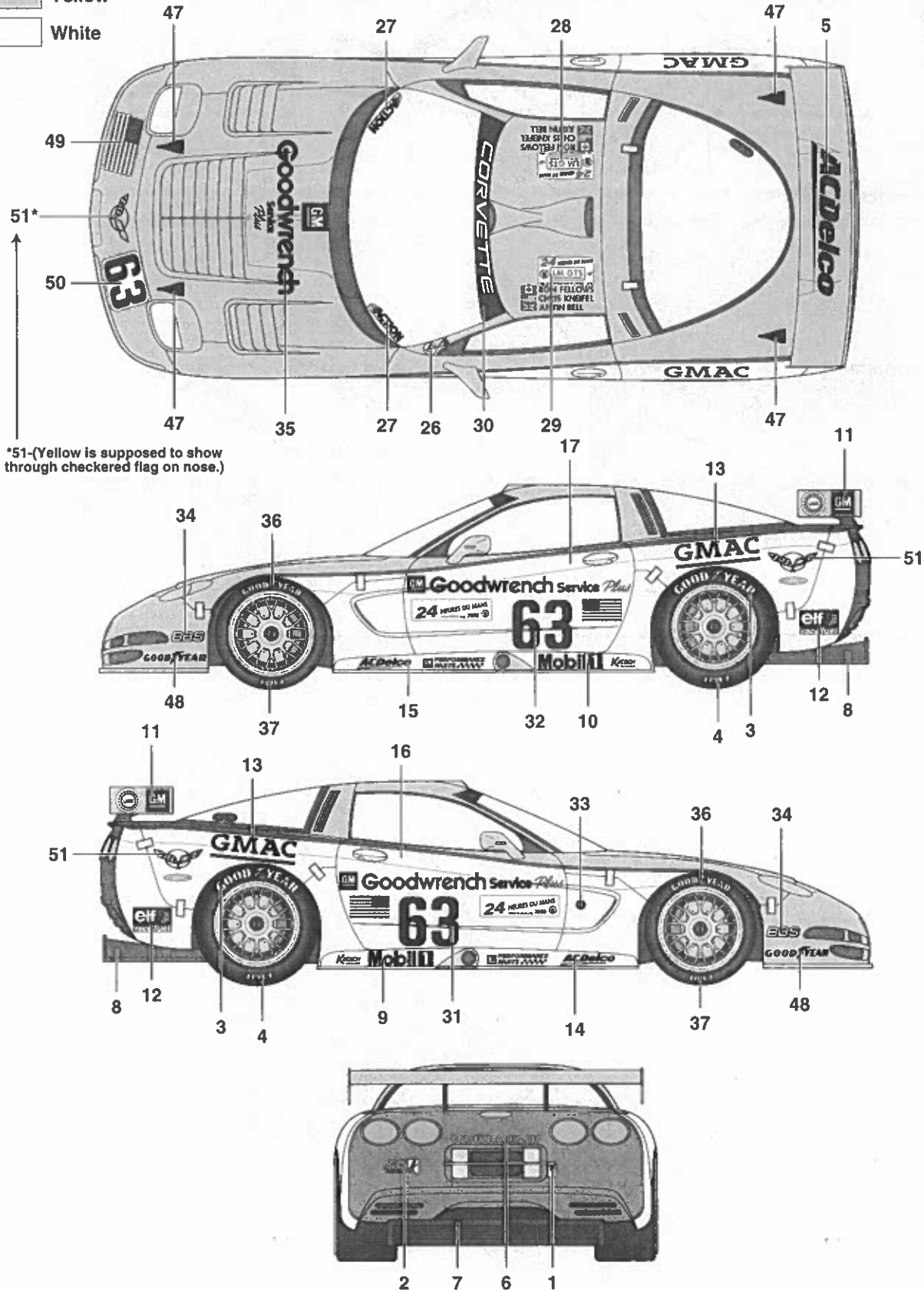

\*51-(Yellow is supposed to show through checkered flag on nose.)