

DECALING - PAINTING

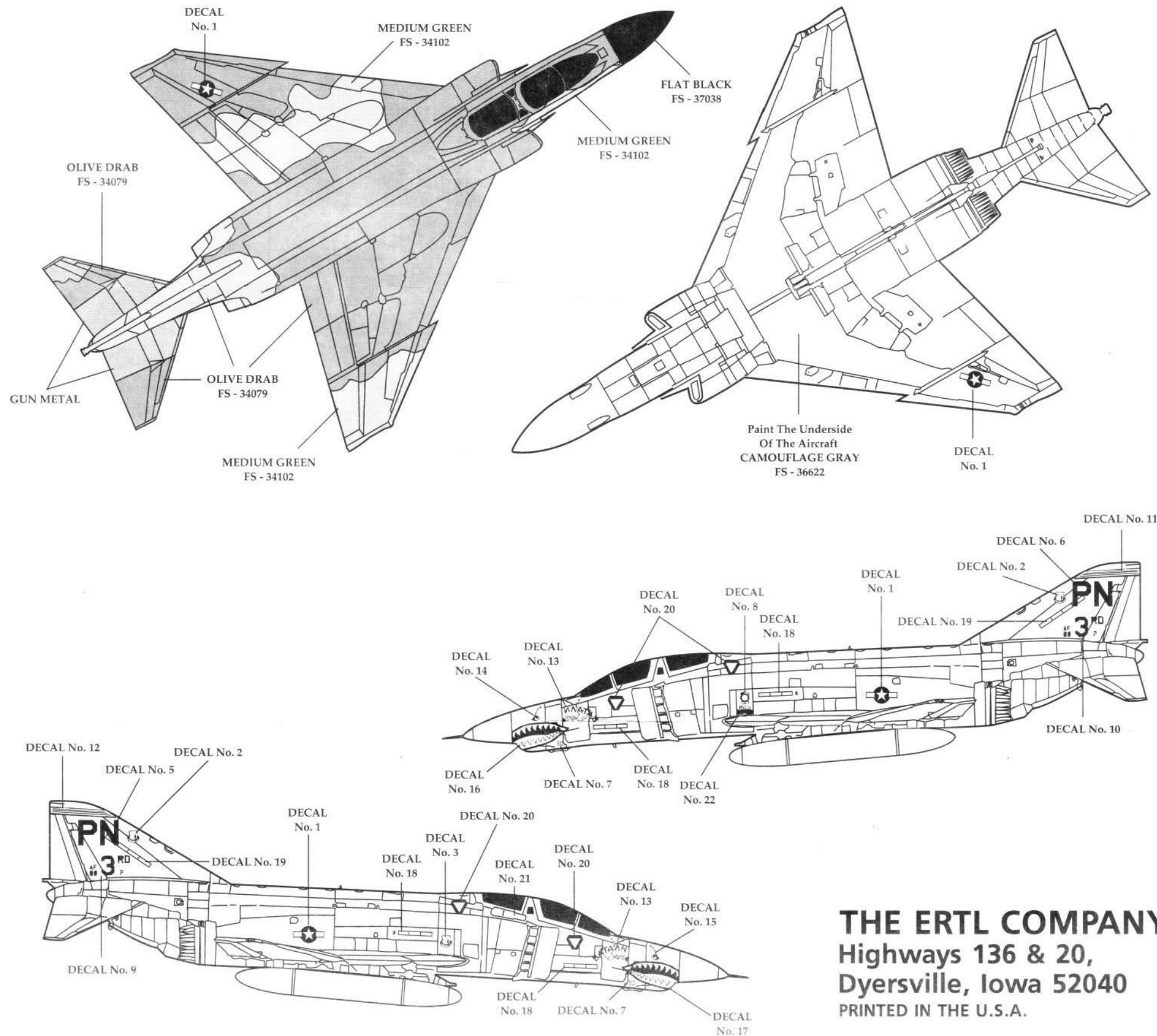

THE ERTL COMPANY
 Highways 136 & 20,
 Dyersville, Iowa 52040
 PRINTED IN THE U.S.A.

FORCE ONE

1 / 144 Scale
 Model Kit



Stock No. 8849
 Form No. 099 - 8849



**McDONNELL
 DOUGLAS**

F-4E PHANTOM

The F4 Phantom did not start out as the result of the normal contract bidding requirements from one of the U.S. services, but rather was the result of an in-house development at McDonnell - Douglas. They had lost out on a bid for a ship-borne supersonic fighter to another manufacturer, but were determined to show the Navy they could develop a superior aircraft. Their presentation so impressed the U.S. Bureau of Aeronautics that they ordered two flying prototypes which were to incorporate additional Navy requirements. In the four months it took to build the planes, all the Navy specifications were built in, with a little extra from the McDonnell - Douglas designers. The results were that the new Phantom met and, in many cases, exceeded all the Navy requirements. It flew faster, higher, further and with a faster climb rate than was requested, and was the first U.S. fighter to have a self-contained radar system for tracking and shooting enemy aircraft. Previous fighters depended on ground controlled radar to intercept unfriendly planes.

Not only did the U.S. Navy purchase this remarkable plane in large quantities, the U.S. Air Force also purchased their own version of the versatile Phantom. From the first flight in 1958, it has been up-graded over the years with bigger engines, advanced radar and sophisticated weapons systems. The Phantom has proven the value of its original design and has carved out its own niche in the history of aviation.

IMPORTANT

Before you begin to assemble your model kit, study the instructions carefully. This will help you to familiarize yourself with the part locations as you proceed. Prior to cementing parts together, be sure to "TEST FIT" them in order to assure proper alignment and also to check for "excess" FLASH that may occur along parting lines. Use a sharp hobby knife or file to remove flash if necessary.

If you wish to paint your model, various sub-assemblies and components should be painted before any parts are attached. During assembly, you may note that the recommended color is stated after the part name.

This model kit is molded from the finest high-impact styrene plastic. Use only paints and cements which are specifically formulated for styrene. Read all labels and warnings carefully.

Because the cement will only adhere to bare plastic it is necessary to remove any paint or "plating" from the area to which the cement is to be applied.

HOBBY KNIFE

Use a sharp hobby knife to remove parts from the trees. Some parts may appear to have an extra "tab" on them, these should be removed.

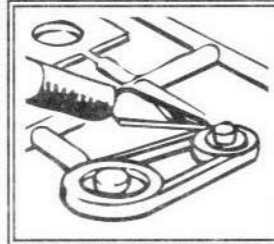

TWEEZERS

Tweezers are handy for holding very small parts during assembly or painting.

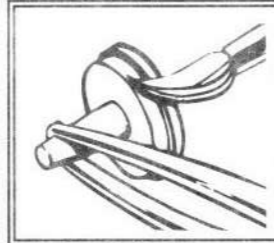

CEMENT

We recommend the use of liquid polystyrene cement. Apply with a fine brush or toothpick. Use cement sparingly or a sloppy job will result.

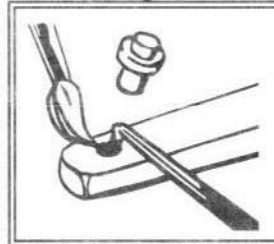

We take great pride in providing the finest model kits available, giving strong attention to detail and craftsmanship. Should you have any difficulty with assembly or missing parts, please call the appropriate number listed below between the hours of 8:00 am to 4:30 pm central time, Monday through Friday.

In IOWA (toll free) 1-800-942-4618
 Elsewhere in the U.S.A. (toll free) 1-800-553-4886
 Outside of the United States call 1-319-875-2000

1

REAR VIEW

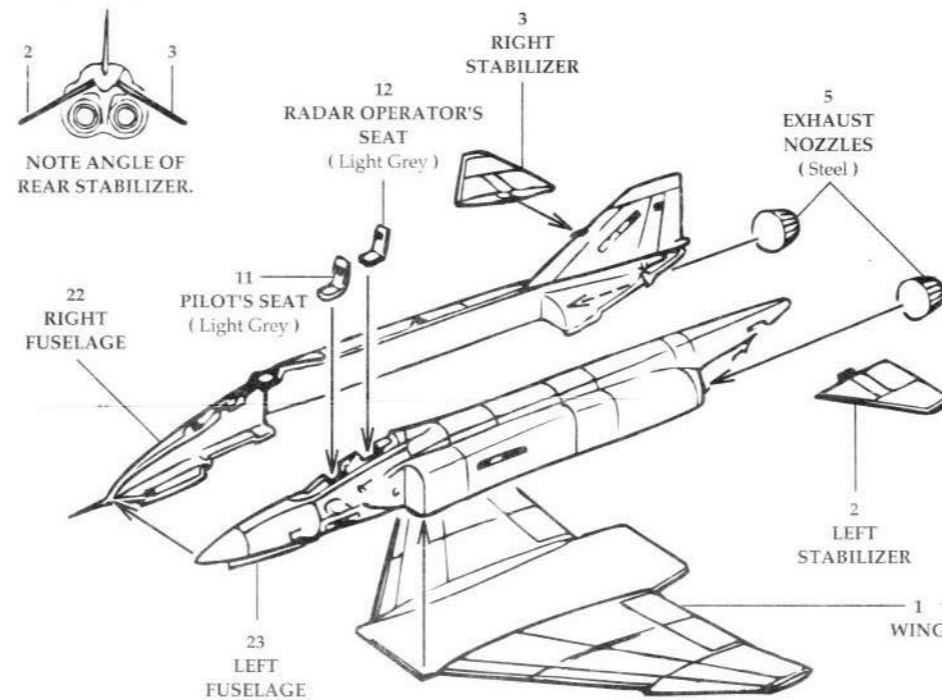

2

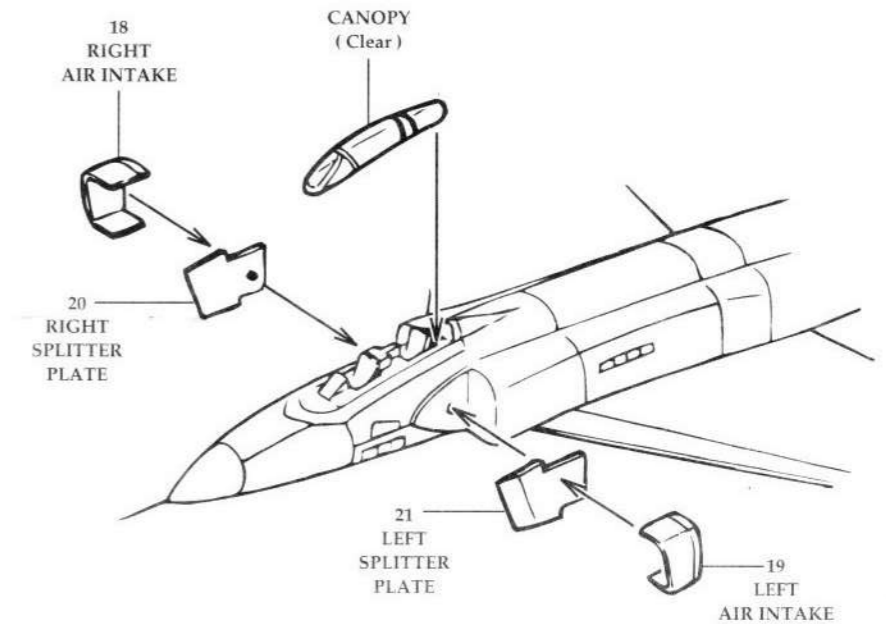

3

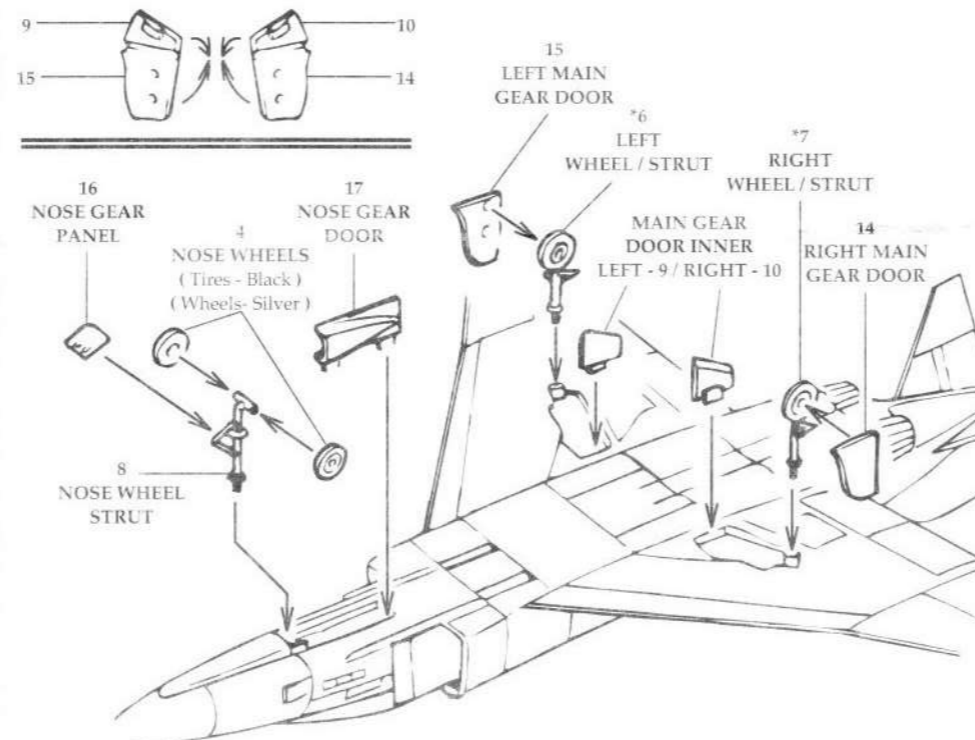

4

