

Revell



Tornado GR1 RAF

04619-0389

©2000 BY REVELL GmbH. A subsidiary of Hobbico, Inc.

PRINTED IN POLAND

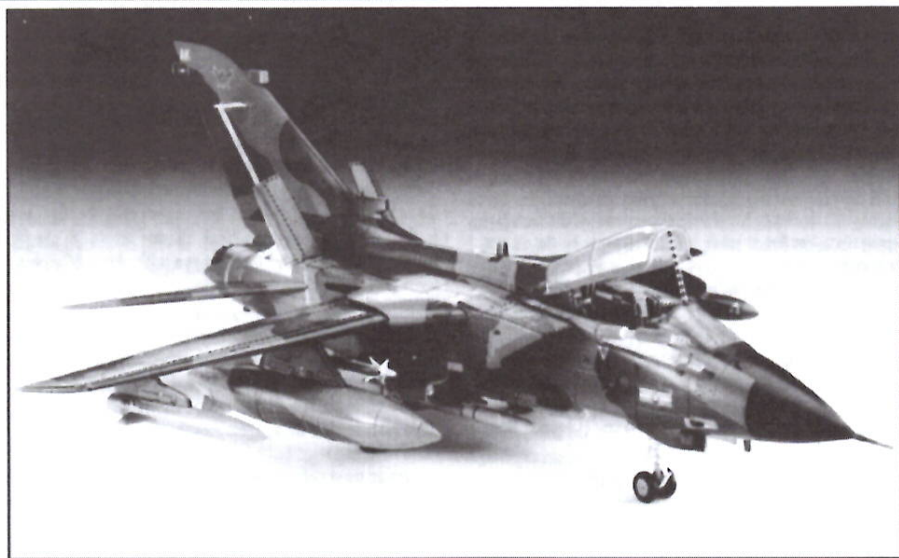

Tornado GR1 RAF

Der Panavia Tornado wird bereits seit 1980, als die Tornado Tri-national Training Unit (TTTE) auf dem RAF-Stützpunkt Cottesmore gegründet wurde, in großem Umfang von den Luftstreitkräften Großbritanniens, Deutschland und Italiens eingesetzt. In den vergangenen Jahren wurde der Tornado im Hinblick auf Avioniksysteme, Triebwerke und Waffen mehrfach verbessert; auch die neueste Variante der GR4 ist bereits im Einsatz. Die ersten Kampfeinsätze erfolgten mit der RAF und der italienischen Luftwaffe 1991 im Golfkrieg; in jüngerer Zeit flogen Tornados während des Kosovo-Konflikts 1999 Kampfeinsätze. Auf dem Höhepunkt ihrer Einsatzzeit bei der RAF gab es 12 Einsatzstaffeln des Modells GR1, die in Großbritannien und bei der RAF Deutschland stationiert waren. Seit dem Ende des kalten Krieges und aufgrund der allgemeinen Reduzierung von Kampfverbänden auf allen Seiten wurden die Front-Einsatzeinheiten der RAF auf acht reduziert. Während der 90er Jahre wurden den Staffeln bestimmte Funktionen zugewiesen. So sind in Großbritannien die Staffeln Nr. 2 und 13 vorwiegend mit dem Muster GR1A für Aufklärungszwecke und die Nr. 12 und 617 mit dem Typ GR1B für den Kampfeinsatz auf See ausgestattet. In Brüggen unterhält die RAF Deutschland vier Staffeln, wovon die Nr. 9 und 31 in erster Linie für SEAD-Einsätze vorgesehen sind (Suppression of Enemy Air Defences - Unterdrückung der feindlichen Luftabwehr) und hierfür Bae ALARM-Raketen (Air Launched Anti-Radiation Missiles - flugzeuggestützte Anti-Radar-Raketen) einsetzen, die zum ersten Mal 1991 im Golfkrieg verwendet worden waren. Die Staffeln Nr. 14 und 17 sind für den Präzisions-Bombeneinsatz mit TIALD-Behältern ausgerüstet (Thermal Imaging and Laser Designator - Wärmebild- und Laserzielkennung); die Staffel Nr. 17 wurde im März 1999 aufgelöst. In letzter Zeit besteht die Tendenz, einzelne Rollen weniger scharf voneinander abzugrenzen, so daß zum Beispiel viele Einheiten je nach Bedarf für Bombeneinsätze auf Land- und Seeziele eingesetzt werden können. Das Konzept der Bae ALARM ist einzigartig, und in jedem größeren Konflikt wären Tornados der 9. und 31. Staffel unter den ersten, die in den feindlichen Luftraum eindringen würden. Wenn das vom feindlichen Radar erfassbare Gebiet beinahe erreicht ist, werden die ALARM-Raketen in große Höhe geschossen, wo die Raketenmotoren abgeschaltet werden. Jede Rakete sinkt an einem Fallschirm langsam nach unten und sucht dabei ständig nach feindlichen Radarstrahlen, denen sie folgen könnte. Wenn ein solcher entdeckt wird, wird der Fallschirm abgeworfen und der Motor wieder gestartet, um die Rakete an ihr Ziel zu bringen. Der Tornado kann eine große Bandbreite an Außenlasten und Waffen mitführen; auch in den kommenden Jahren werden weitere Verbesserungen dafür sorgen, daß der Tornado auch weiterhin im Kampfeinsatz volle Leistung erbringen kann. Die mit 2.250 Liter „Hindenburg“ Treibstofftanks ausgerüsteten Tornados der RAF haben eine größere Reichweite ohne Nachtankbedarf als alle anderen. Angetrieben von zwei Turbo Union RB199-34R Mk. 103 Turbofantriebwerken mit Nachbrenner mit jeweils 40,5 kN (9.104 lbs.) Leistung bzw. 71,5 kN (16.073 lbs.) Leistung mit eingeschalteten Nachbrenner, erreicht der Tornado GR1 eine Höchstgeschwindigkeit von 1.340 km/h (840 mph) auf 150 m (500 ft.) Höhe. Grundmaße: Spannweite (bei voll ausgeschwenkten Tragflächen) 13,90 m (45 ft. 8 in.), Länge 16,70 m (54 ft. 9 in.), Höhe 5,7 m (18 ft. 8 in.)

Tornado GR1 RAF

The Panavia Tornado has been in large scale service with the air forces of Great Britain, Germany and Italy since 1980, when the first unit, the Tornado Tri-national Training Unit (TTTE) formed at RAF Cottesmore. In recent years the type has received several upgrades in avionics, engines and weapons; the latest GR4 version is also in service. First used operationally by the RAF and Italian Air Force during the 1991 Gulf War more recently Tornados saw action during the Kosovo conflict in 1999. At the peak of its RAF service there were 12 operational GR1 squadrons based in the UK and in RAF Germany; since the end of the cold war and general military force reductions on all sides, RAF front line units have shrunk to eight. During the 1990s the squadrons had dedicated roles; in the UK nos. 2 and 13 are primarily equipped with the GR1A for reconnaissance and nos. 12 and 617 with the GR1B for maritime strike. In RAF Germany four squadrons reside at Brüggen; of these nos. 9 and 31 are primarily dedicated to the SEAD (Suppression of Enemy Air Defences) role using the Bae ALARM (Air Launched Anti-Radiation Missile), first used in the 1991 Gulf War, while nos. 14 and 17 have a precision bombing role and are equipped with TIALD (Thermal Imaging and Laser Designator) pod, also first used in the Gulf War; (No. 17 Squadron was disbanded in March 1999). More recently some of the dedicated roles have become less well defined and, for example, many of the units can engage in the overland and maritime bombing roles as required. The concept of the Bae ALARM missile is unique and in any major conflict the Tornados of nos. 9 and 31 Squadrons would be amongst the first to enter enemy airspace. When flying almost within range of enemy radar's several ALARMS will be launched to high altitude where rocket motors are cut. Each missile slowly descends on its parachute, all the time searching for any enemy radar beams it can lock onto; if detected, the parachute is jettisoned and the rocket motor restarted to drive the missile into its target. The Tornado can carry a wide variety of stores and weapons and during the coming years new weapons and further upgrades will be introduced to ensure that Tornado remains operationally effective; carrying the 2,250 ltr. "Hindenburg" tanks RAF Tornados have a greater unrefuelled range than any others. Powered by two Turbo Union RB 199-34R Mk. 103 afterburning turbofans each rated at 40.5 kN (9,104 lbs.) and 71.5 kN (16,073 lbs.) with afterburner, the GR1 has a maximum speed of 1,340 km/h (840 mph) at 150m (500ft). Basic dimensions: wing span (wings spread) 13.90 m (45ft 8in.). Length: 16.7m (54ft 9in.). Height: 5.7m (18ft 8in.)

Form hergestellt und im Eigentum von Revell AG/Revell Monogram Inc. Wiederrichtliche Nachahmungen werden gerichtlich verfolgt.
Ce produit est propriété de la société Revell AG/Revell Monogram Inc. Toute utilisation ou duplication frauduleuse fera l'objet de poursuites en justice.
Modelado y en propiedad de Revell AG/Revell Monogram Inc. Imitaciones ilícitas serán perseguidas por la ley.
Forma prodotta dalla Revell AG/Revell Monogram Inc. e di proprietà della stessa impresa, la quale procederà legalmente contro ogni imitazione abusiva.
Malli on Revell AG/Revell Monogram Inc. valmistama ja omisuutena. Laittamaan kopiointiin tullaan puuttamaan oikeudelliset toimet.
Formen er fremstillet af Revell AG/Revell Monogram Inc. Efterligning uden tilladelse vil bli gjenstand for rettslig forfølgelse.
Produkcija i prava vlasnosti firme Revell AG/Revell Monogram Inc. Niekolwiek podrobienie jest zabronione pod odpowiedzialnością sądową.
Model, Revell AG/Revell Monogram Inc. firmasının mülkiyeti altında imal edilmiştir. Kanununa aykırı taklitler mahkumata tabii edilecektir.
A forma edeltője és a tulajdonjog birtokosa a Revell AG/Revell Monogram Inc. A jogellenes utánzatokat és hamisítványokat bíróságlag üldözök.

Model manufactured by and property of Revell AG/Revell Monogram Inc. Illegal imitations are subject to prosecution.
Vorm vervaardigd door en eigendom van Revell AG/Revell Monogram Inc. Onrechtmatige nabootelingen worden gerechtelijk vervolgd.
Formas produzidas e de propriedade da Revell SA/Revell Monogram Inc. Cópias não autorizadas serão processadas juridicamente como determinado na lei.
Modellen tillverkad av och tillhör Revell AG/Revell Monogram Inc. All kopiering beivras enligt lagen om upphovsrätt.
Formen er fremstillet af Revell AG/Revell Monogram Inc. som også har ejendomsret. Lovstridige efterligninger søgges.
Modela proizvedena i vlasnosti firme Revell AG/Revell Monogram Inc. Illegalne kopiranje kažnjivo je po zakonu.
H jopori katrokuvdotyca kai nepijloa any vivotyria tny Revell AG/Revell Monogram Inc. O nepijovayc jupitoye; Ba katojivkovta; Eavotavayc; Tvar byl vyholen firmou Revell AG/Revell Monogram Inc. a je jejim vlastnickim. Prati nezakonnym napodobenim se bude postupovat soudni cestou.
Forma je proizvedena in je vlasništvo Revell AG/Revell Monogram Inc. Neovlašeno kopije bodo pravno kaznjene.

Benötigte Farben / Used Colors

Benötigte Farben / Required colours Peintures nécessaires / Benötigte kleuren Pinturas necesarias / Tintas necesarias Colori necessari / Avândă țiger Tarvittavat värit / Du trenger følgende farger Nødvendige farger / Нεοχρυσίσιμα χρώματα Potrzebne kolory / Αναπαιτούμενα χρώματα Gereگی renkler / Potřebné barvy Szükséges színek / Potrebne barve

A bronzegrün, matt 65 bronze green, matt vert bronze, mat bronzegreen, mat verde bronce, mate verde bronce, fosco verde bronce, opaco bronzgrün, matt bronzgrün, himmel bronzgrün, mat bronzgrün, matt бронзово-зеленый, матовый bronzozöldönny, matowy πρόσινο μπρούτζου, ματ bronz yeşil, mat bronzová zelená, matná bronzözlíd, matt bronza zelena, mat	B bleaugrau, matt 79 greyish blue, matt gris-bleu, mat blaugrüß, mat gris azulado, mate cinzento azulado, fosco grigio blu, opaco blágrá, matt sinharmaa, himmel blágrá, mat blágrá, matt сине-серый, матовый sivay, matowy γκριζομπλέ, ματ modrósedá, matná kékesszürke, matt plavo siva, mat	C mauagrau, matt 47 mouse grey, matt gris souris, mat maugrüß, mat gris rutilé, mate cinzento pardo, fosco grigio topo, opaco puszta, matt hivshharmaa, himmel puszta, mat puszta, matt маузо-серый, матовый szary, matowy γκρι ποικιλία, ματ lars gri, mat nyári szédá, matná egresszürke, matt mijsje siva, mat	60% D + 40% grau, matt 57 grey, matt gris, mat grüß, mat gris, mate cinzento, fosco grigio, opaco grá, matt harmaa, himmel grá, mat grá, matt серый, матовый szary, matowy γκρι, ματ gri, mat szédá, matná szürke, matt siva, mat	E rot, klar 731 red, clear rouge, clair rood, helder rojo, claro vermello, claro rosso, chiaro röd, klar punainen, kirjas röd röd красный, прозрачный czarny, jasny κόκκινο, διαυγές kimmiz, gefaf červená, čirá piros, áttetsző rödeá, jasna	F grau, matt 57 grey, matt gris, mat grüß, mat gris, mate cinzento, fosco grigio, opaco grá, matt harmaa, himmel grá, mat grá, matt серый, матовый szary, matowy γκρι, ματ gri, mat szédá, matná szürke, matt siva, mat	G schwarz, seidenmatt 302 black, silky-matt noir, satiné mat zwart, zijdemat negro, mate seda prelo, fosco sedoso nero, opaco seta svart, sidenmatt musta, silkkihimmel sort, silkmatt sort, silkmatt чёрный, атласно-матовый czarny, jedwabisto-matowy μαύρο, μεταξωτό ματ siyah, ipek mat černá, hedvábná matná fekete, selyemmatt črna, svila mat	H schwarz, matt 8 black, matt noir, mat zwart, mat negro, mate prelo, fosco nero, opaco svart, mat musta, himmel sort, mat sort, mat чёрный, матовый czarny, matowy μαύρο, ματ siyah, mat černá, matná fekete, matt črna, mat
---	--	--	--	--	--	---	--

I weiß, matt 5 white, matt blanc, mat wit, mat blanco, mate branco, fosco bianco, opaco vit, matt valkoinen, himmel hvid, mat hvit, matt белый, матовый biały, matowy λευκό, ματ beyaz, mat biilá, matná fehér, matt bela, mat	15% J + 85% lederbraun, matt 64 leather brown, matt brun cuir, mat lederbrun, mat marón cuero, mate castanho couro, fosco marone couro, opaco laderbrun, mat náhkanruskea, himmel lederbrun, mat larbrun, mat коричневая кожа, матовый brunaty jak skóra, matowy кафэ дэрматос, мат deni kahverengi, mat közénél hódá, matná börbarna, matt koža jryva, mat	K eisen, metallic 91 steel, metallic coloris fer, métallique jærklarung, metallic ferro, metalizado ferro, metallic ferro, metallic järntårg, metallic teräksenvärinen, metallikilla jern, metallic jern, metallic СТАЛЫЙ, МЕТАЛЛИК želazo, metaliczny ουδέρου, μεταλλικό demir, metallic železná, metaliza vas, metallá železna, metallic	65% L + 35% lederbraun, matt 64 leather brown, matt brun cuir, mat lederbrun, mat marón cuero, mate castanho couro, fosco marone couro, opaco laderbrun, mat náhkanruskea, himmel lederbrun, mat larbrun, mat коричневая кожа, матовый brunaty jak skóra, matowy кафэ дэрматос, мат deni kahverengi, mat közénél hódá, matná börbarna, matt koža jryva, mat	aluminium, metallic 99 aluminium metallic aluminium métallique aluminium, metalizado aluminio, metallic aluminio, metallic aluminium, metallic aluminium, metallikilla aluminium, metallik aluminium, metallic алюминиевый, металлический aluminium, metaliczny ολουμίνιου, μεταλλικό aluminium, metallic aluminium, metallá aluminium, metallic	10% M + 45% schwarz, matt 8 black, matt noir, mat zwart, mat negro, mate prelo, fosco nero, opaco svart, mat musta, himmel sort, mat sort, mat чёрный, матовый czarny, matowy μαύρο, ματ siyah, mat černá, matná fekete, matt črna, mat	45% + 45% lederbraun, matt 64 leather brown, matt brun cuir, mat lederbrun, mat marón cuero, mate castanho couro, fosco marone couro, opaco laderbrun, mat náhkanruskea, himmel lederbrun, mat larbrun, mat коричневая кожа, матовый brunaty jak skóra, matowy кафэ дэрматос, мат deni kahverengi, mat közénél hódá, matná börbarna, matt koža jryva, mat	kupfer, metallic 93 copper, metallic cuivre, métallique koper, metallic cobre, metalizado cobre, metallic rame, metallic kopper, metallic kopar, metallikilla kobber, metallic kobber, metallic медный, металлический miedzi, metaliczny χάλκινο, μεταλλικό bakir, metallic metalliza vörböréz, metallá bakier, metallic
---	--	---	--	--	--	--	--

50% N + 50% gelb, matt 15 yellow, matt jaune, mat geel, mat amarillo, mate amarillo, fosco giallo, opaco gul, matt keltainen, himmel gul, mat gul, matt жёлтый, матовый żółty, matowy κίτρινο, ματ sarı, mat žlutá, matná sárga, matt rumena, mat	weiß, matt 5 white, matt blanc, mat wit, mat blanco, mate branco, fosco bianco, opaco vit, matt valkoinen, himmel hvid, mat hvit, matt белый, матовый biały, matowy λευκό, ματ beyaz, mat biilá, matná fehér, matt bela, mat	O feuerrot, glanzend 31 fiery red, gloss rouge feu, brillant rood helder, glanzend rojo lago, brillante vermelho vivo, brilhante rosso fuoco, lucente pióro, blank tuupainen, kiiltävä ilidred, skinnende ilidred, blank огне-красный, блестящий czarnony ognisty, błyszczący κόκκινο φωτιάς, γυαλιστερό aleg karmizien, parlak ohivné červená, lesklá tűzpiros, fényes ogonj rdeča, bleskajoča	P ultramarinblau, glanzend 51 ultra marine blue, gloss bleu outremer, brillant ultramarijn blauw, glanzend azul de ultramar, brillante azul ultramarino, brilhante blu ultramarino, lucente ultramarinblá, blank ultramarini, kiiltävä ultramarinblá, skinnende ultramarin, blank ροζκόβη υπερμαρμερα, блестящий błękit ultramaryna, błyszczący κυανό, γυαλιστερό deniz mavisi, parlak ultramarinová modř, lesklá ultramarinikék, fényes ultramarinok plava, bleskajoča	Q silber, metallic 90 silver, metallic argent, métallique silver, metallic prata, metalizado prata, metallic argento, metallic silver, metallic hopea, metallikilla solv, metallic серебряный, металлический srebro, metaliczny σημείο, μεταλλικό gümüş, metallic stříbrná, metaliza ejbiat, metallá srebrna, metallic	R rot, matt 63 rust, matt rouille, mat roest, mat roin, mate ferrogen, fosco color ruggine, opaco roed, matt ruoste, himmel rust, mat rust, matt ржавина, матовый rdzawy, matowy χρúμο σκουριάς, ματ pas rengi, mat rezavá, matná rozada, matt ryjva, mat	S seegrün, matt 48 sea green, matt vert d'eau, mat zeegroen, mat blanco, mate verde mar, mate verde-mar, fosco verde lago, opaco havgrön, matt merenvärinen, himmel havgrün, mat sjøgrün, matt szesnały morski, матовый zielón morská, matowy πρόσινο λίμνης, ματ bayaz, mat mořská zelená, matná fengergrüß, matt morsko zelena, mat	70% T + 30% weiß, matt 5 white, matt blanc, mat wit, mat blanco, mate branco, fosco bianco, opaco vit, matt valkoinen, himmel hvid, mat hvit, matt белый, матовый biały, matowy λευκό, ματ beyaz, mat biilá, matná fehér, matt bela, mat	grau, matt 57 grey, matt gris, mat grüß, mat gris, mate cinzento, fosco grigio, opaco grá, matt harmaa, himmel grá, mat grá, matt серый, матовый szary, matowy γκρι, ματ gri, mat szédá, matná szürke, matt siva, mat
--	--	--	--	--	--	---	---	---

U nato-oliv, matt 46 Nato-olive, matt olive O.T.A.N., mat Nato-oliv, mat azuluna Nato, mate oliva Nato, fosco oliva nato, opaco Nato-oliv, matt nato-oliv, himmel Nato-oliv, mat NATO-oliv, matt оливково-зеленый "НАТО", матовый olivk. NATO, matowy χούλι του NATO, ματ nato yeşil, mat olivová NATO, matná Nato-oliv, matt NATO oliva, mat	50% V + 50% nato-oliv, matt 46 Nato-olive, matt olive O.T.A.N., mat Nato-oliv, mat azuluna Nato, mate oliva Nato, fosco oliva nato, opaco Nato-oliv, matt nato-oliv, himmel Nato-oliv, mat NATO-oliv, matt оливково-зеленый "НАТО", матовый olivk. NATO, matowy χούλι του NATO, ματ nato yeşil, mat olivová NATO, matná Nato-oliv, matt NATO oliva, mat	schwarz, matt 8 black, matt noir, mat zwart, mat negro, mate prelo, fosco nero, opaco svart, mat musta, himmel sort, mat sort, mat чёрный, матовый czarny, matowy μαύρο, ματ siyah, mat černá, matná fekete, matt črna, mat	W luffthansa-blau, seidenmatt 350 "Luffthansa" blue, silky-matt bleu "Luffthansa", satiné mat Luffthansa blauw, zijdemat azul Luffthansa, mate seda azul Luffthansa, fosco sedoso blu Luffthansa, opaco seta Luffthansa-blá, sidenmatt Luffthansa-sininen, silkkihimmel Luffthansa-blá, silkmatt Luffthansa-blá, silkmatt синий "люфтганза", атласно-матовый nieb -Luffthansa, jedwabisto-matowy μπλε δ'ύδ'όδού, μεταξωτό ματ luffthansa mavisi, ipek mat modrá Luffthansa, hedvábná matná Luffthansa-kék, selyemmatt luffthansa plava, svila mat	X gelb, matt 15 yellow, matt jaune, mat geel, mat amarillo, mate amarillo, fosco giallo, opaco gul, matt keltainen, himmel gul, mat gul, matt жёлтый, матовый żółty, matowy κίτρινο, ματ sarı, mat žlutá, matná sárga, matt rumena, mat	50% Y + 50% gelb, matt 15 yellow, matt jaune, mat geel, mat amarillo, mate amarillo, fosco giallo, opaco gul, matt keltainen, himmel gul, mat gul, matt жёлтый, матовый żółty, matowy κίτρινο, ματ sarı, mat žlutá, matná sárga, matt rumena, mat	oker, matt 88 ochre brown, matt ocre, mat oker, mat ocre, mate ocre, fosco ocra, opaco ocra, matt okra (keltamulta), himmel óker, mat óker, mat охра, матовый ochra, matowy óхра, ματ koyu kavuniji, mat okrové žlutá, matná óker, matt óker, mat
--	--	---	--	--	--	---

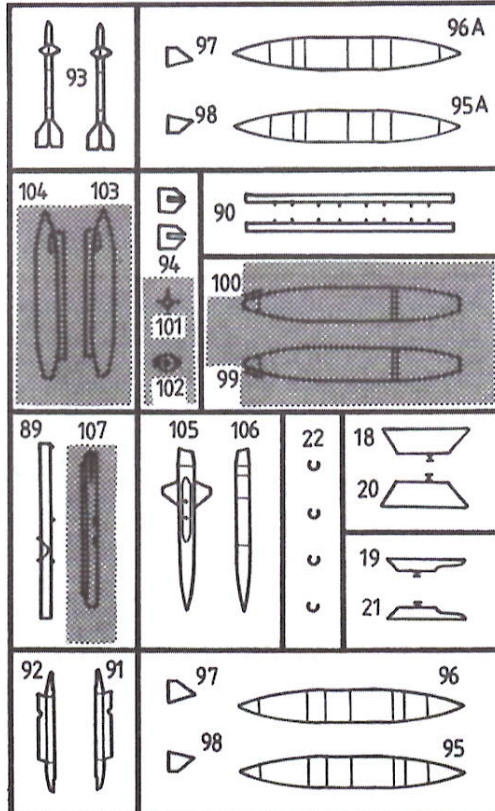
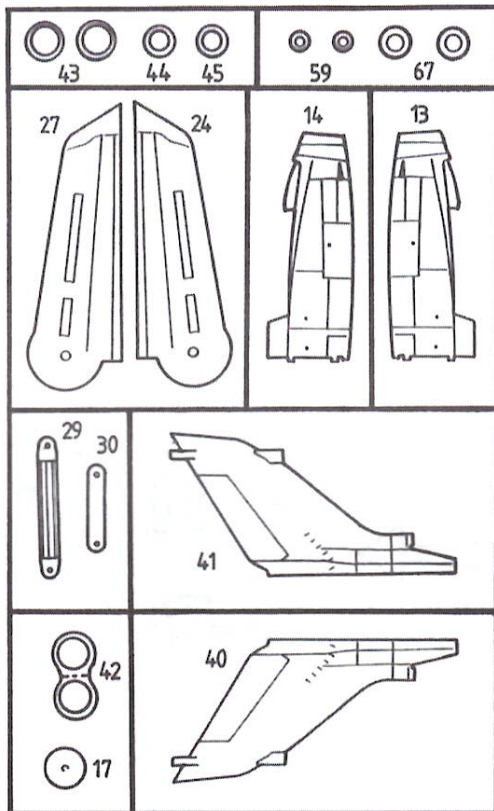
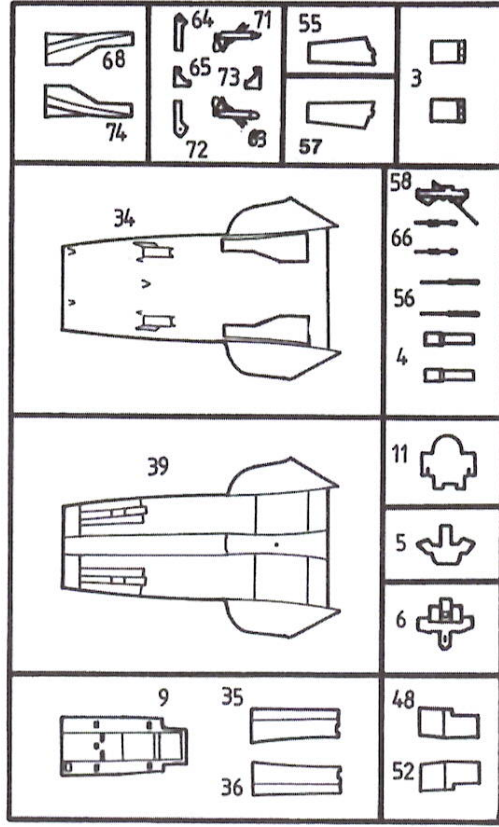
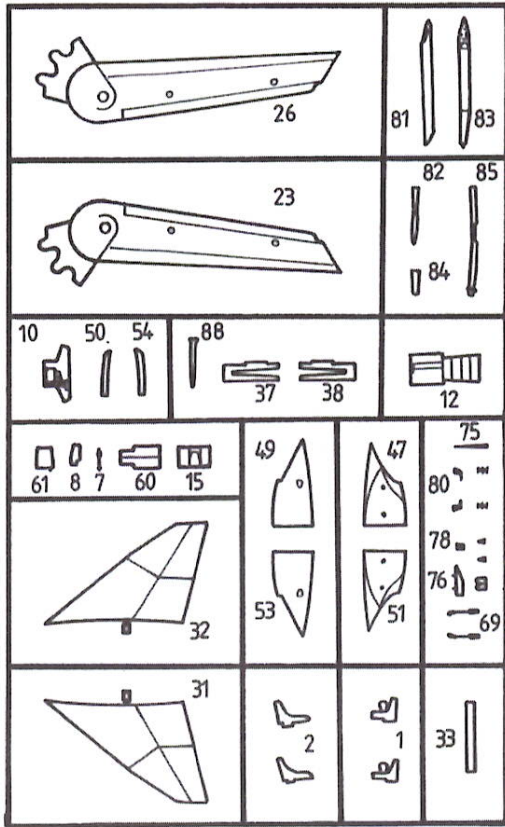

 = Teile werden nicht verwendet / Parts not for use / Parti da non utilizzare / Pièces à ne pas utiliser

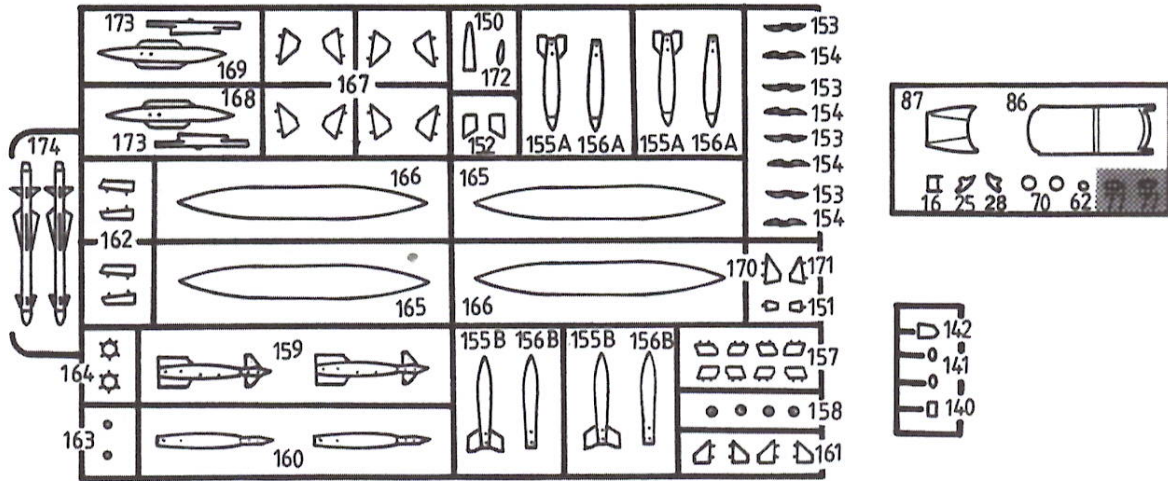

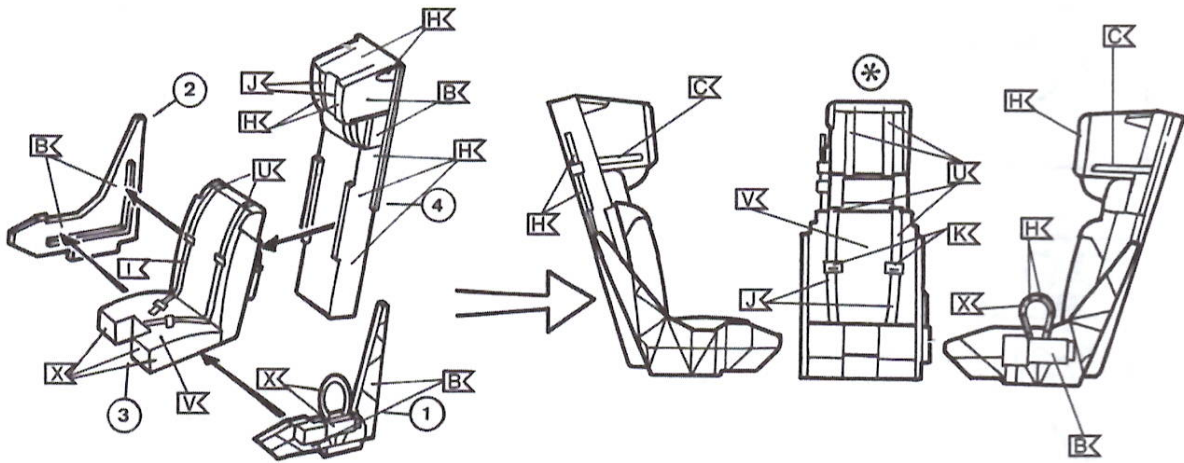

1 **(2X)**

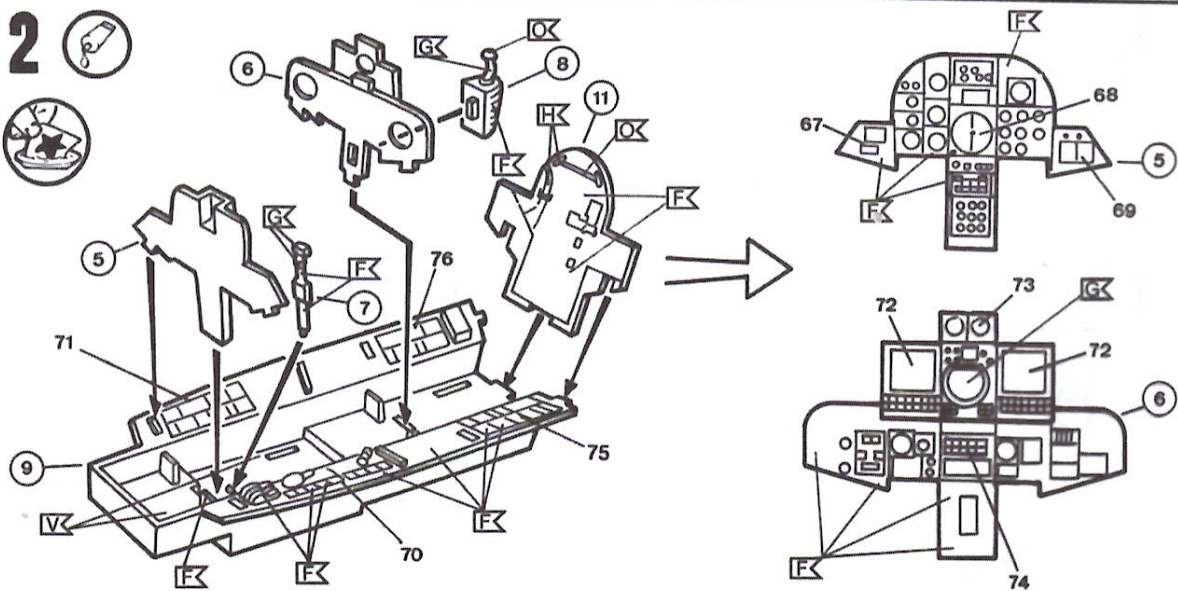

2

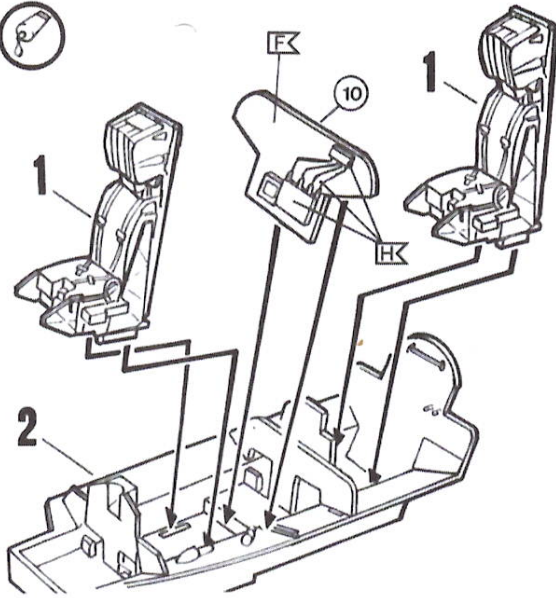
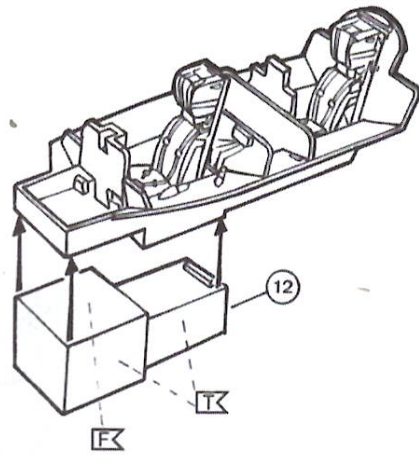

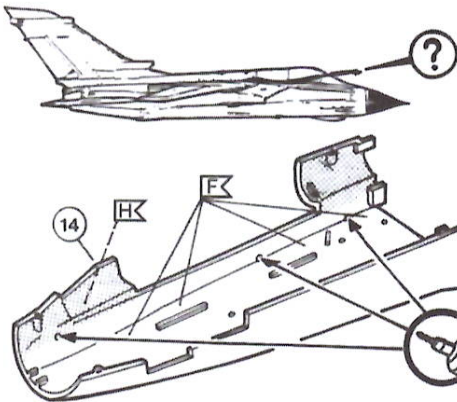
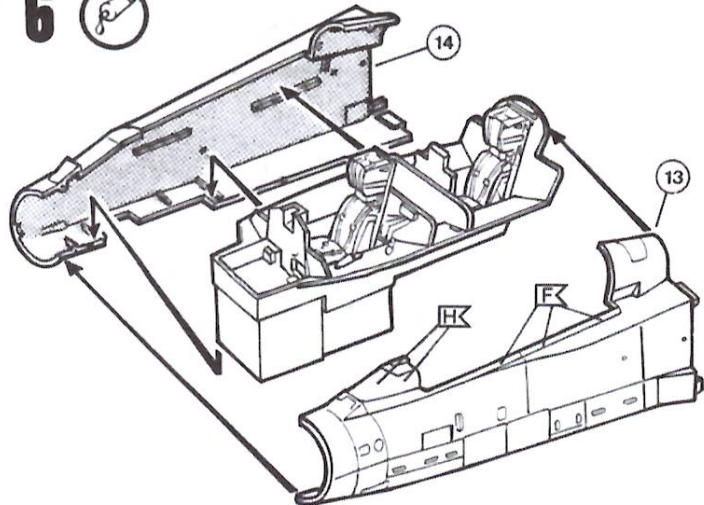
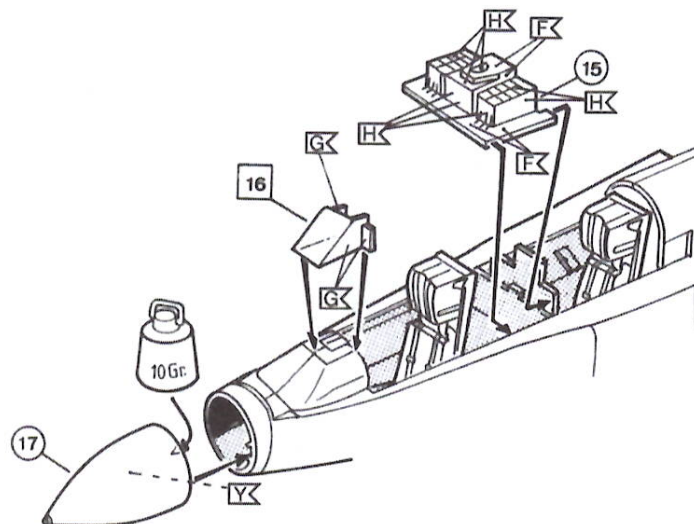
3 **4** **5**  → **43 / 44****6** **7** 

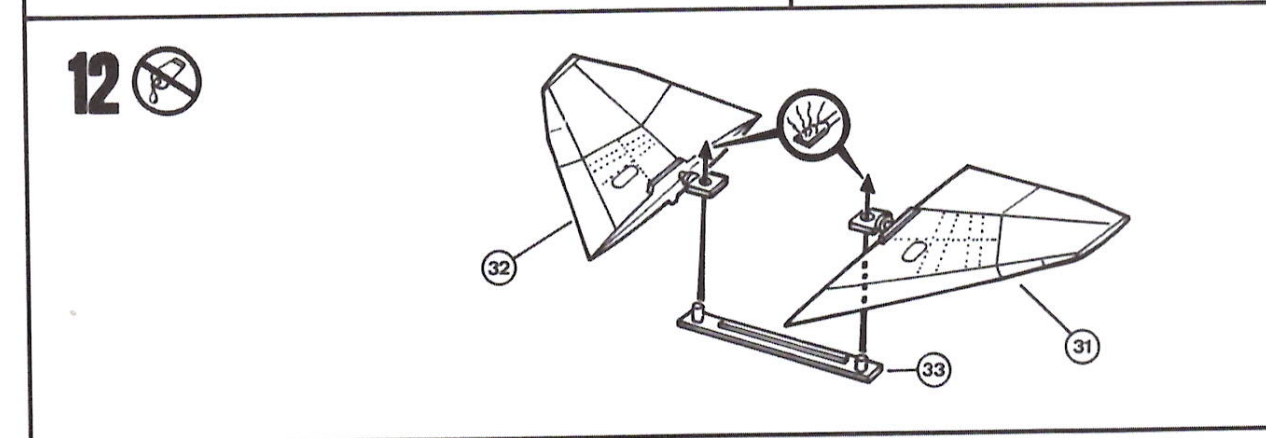
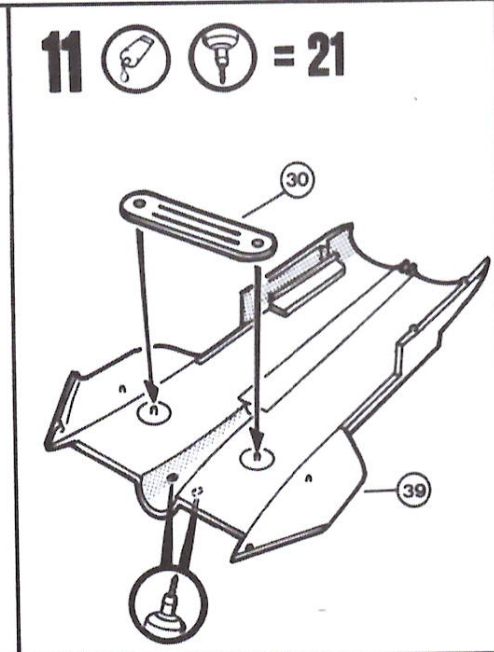
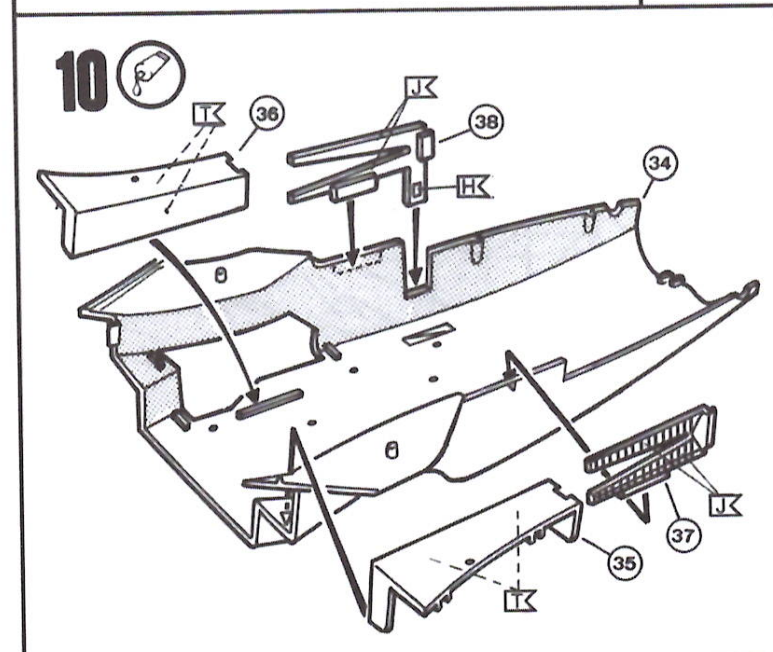
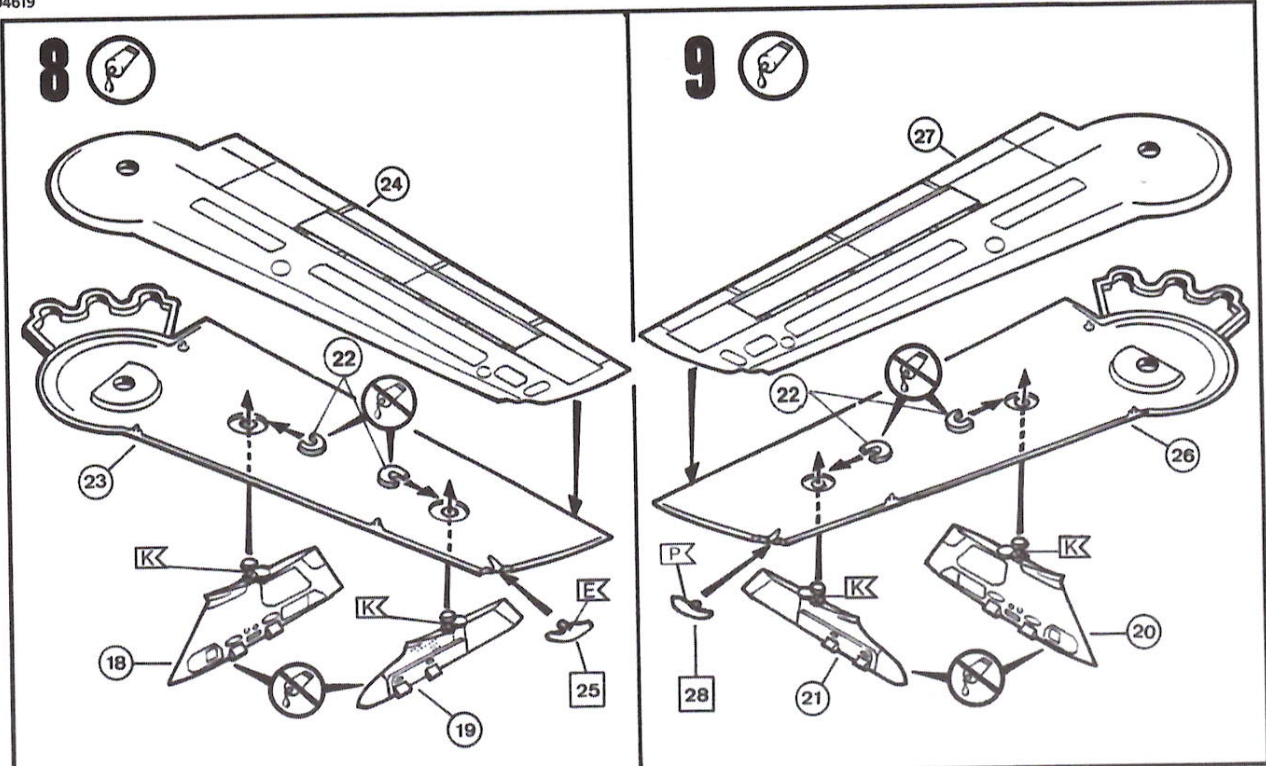

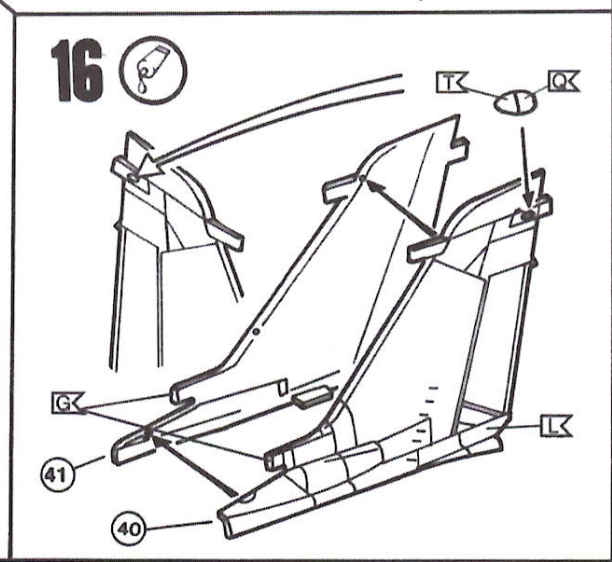
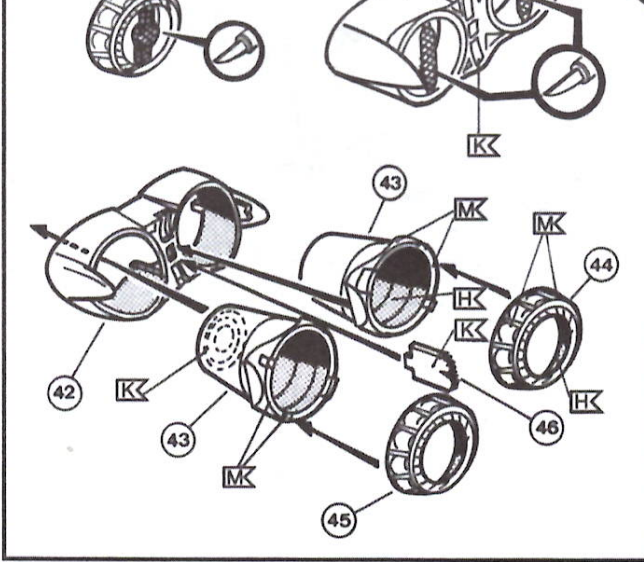
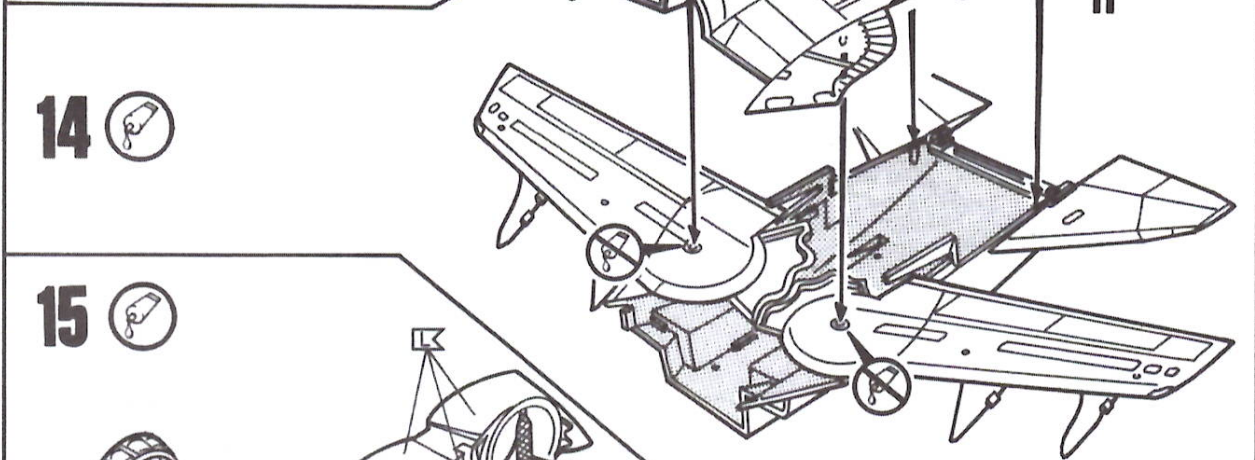
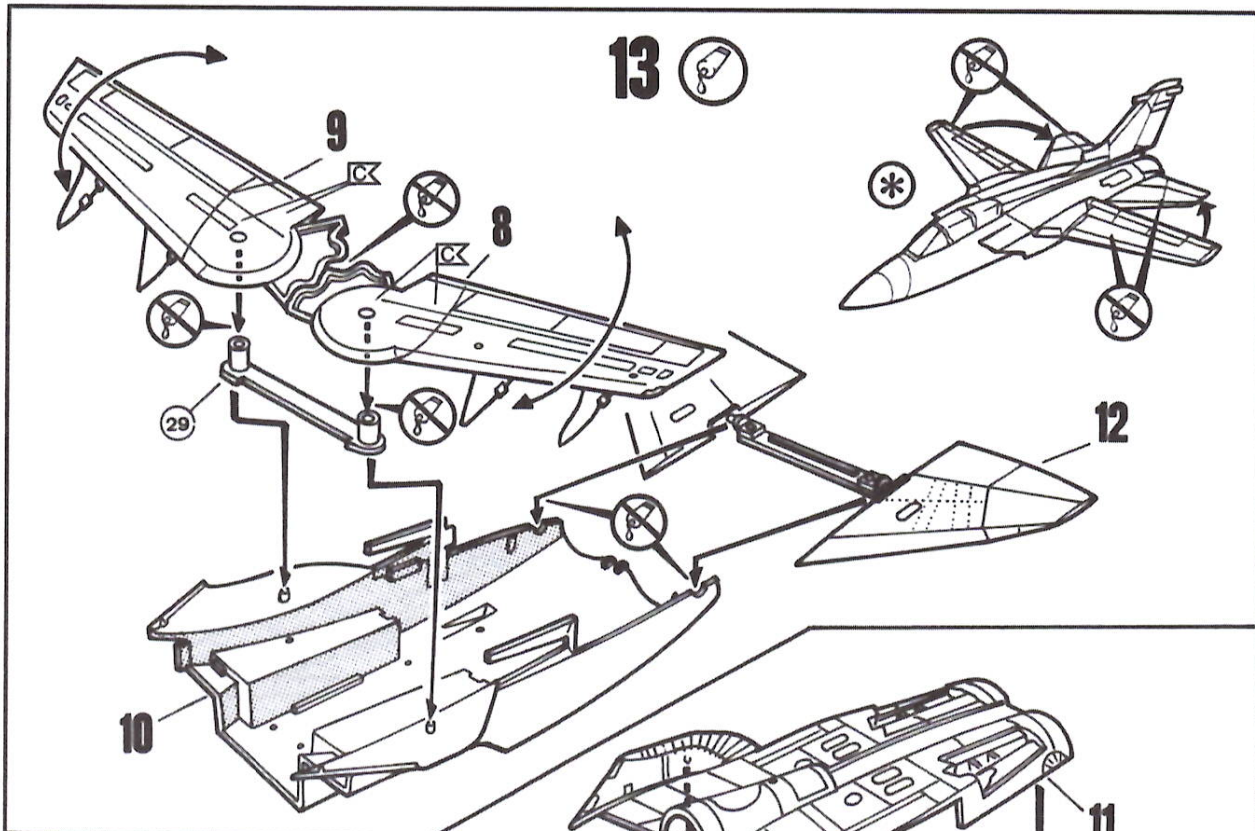

17

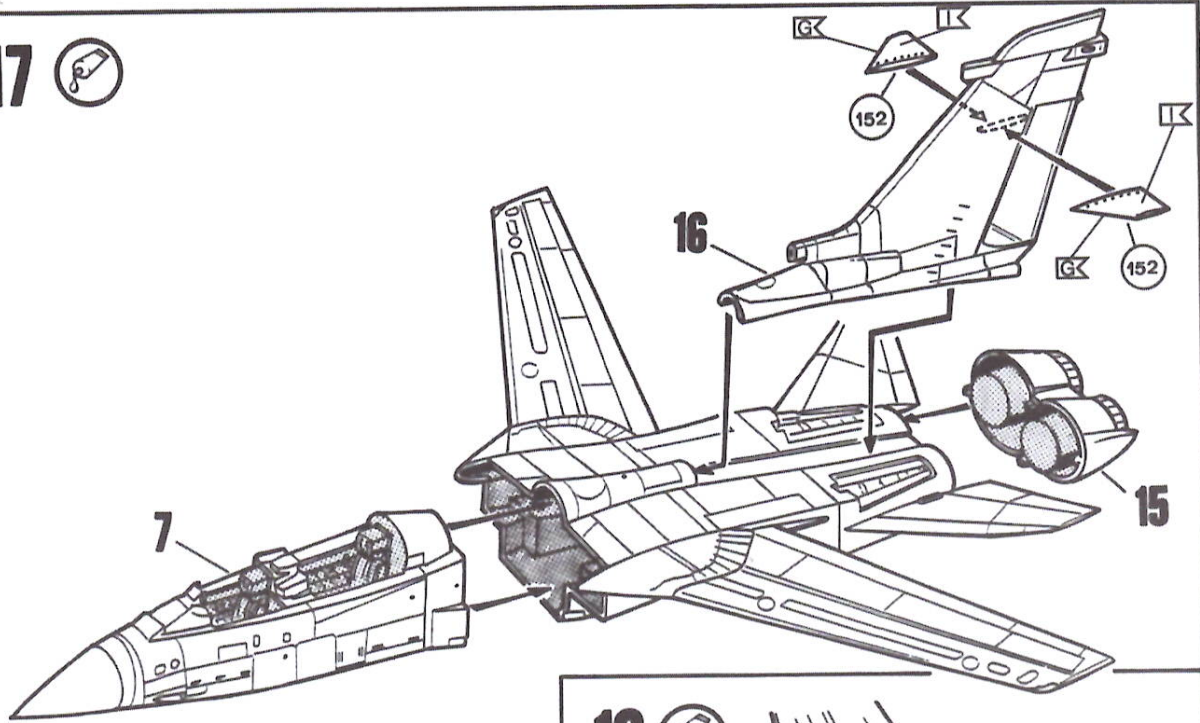

18

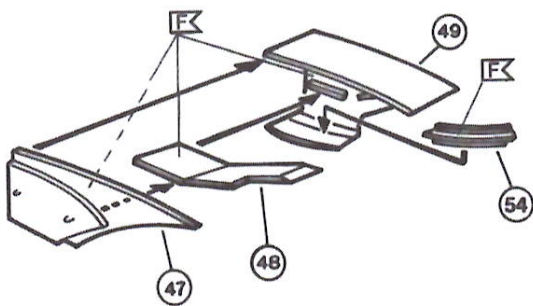

19

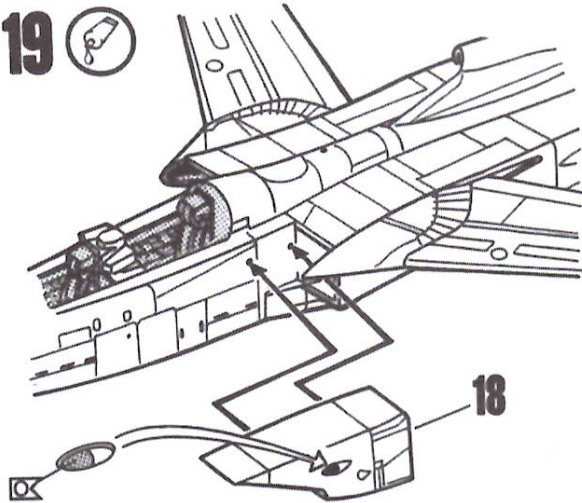

20

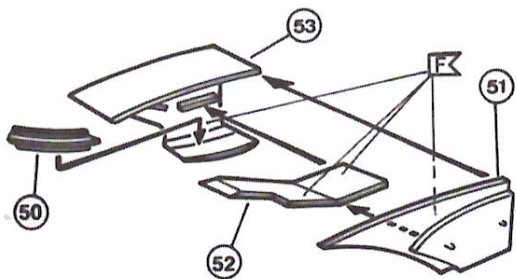

21

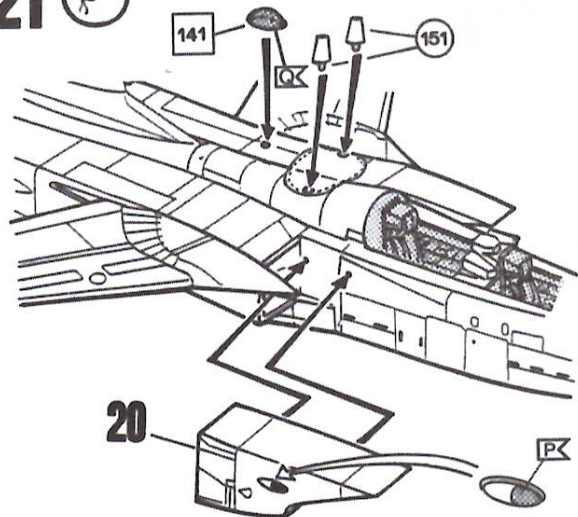

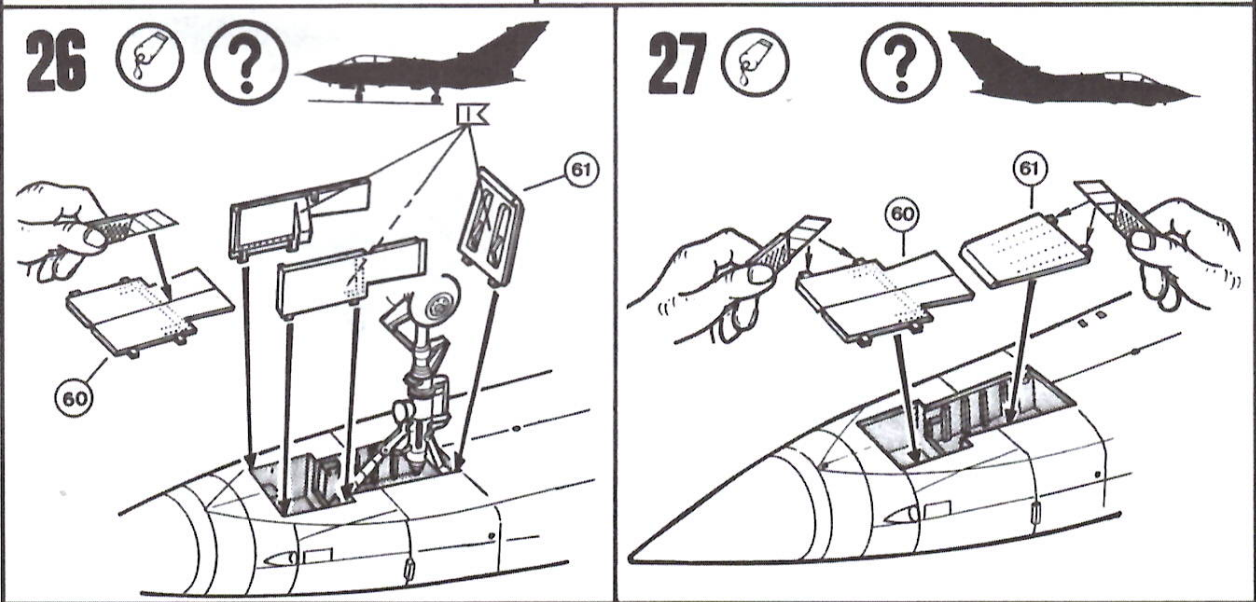
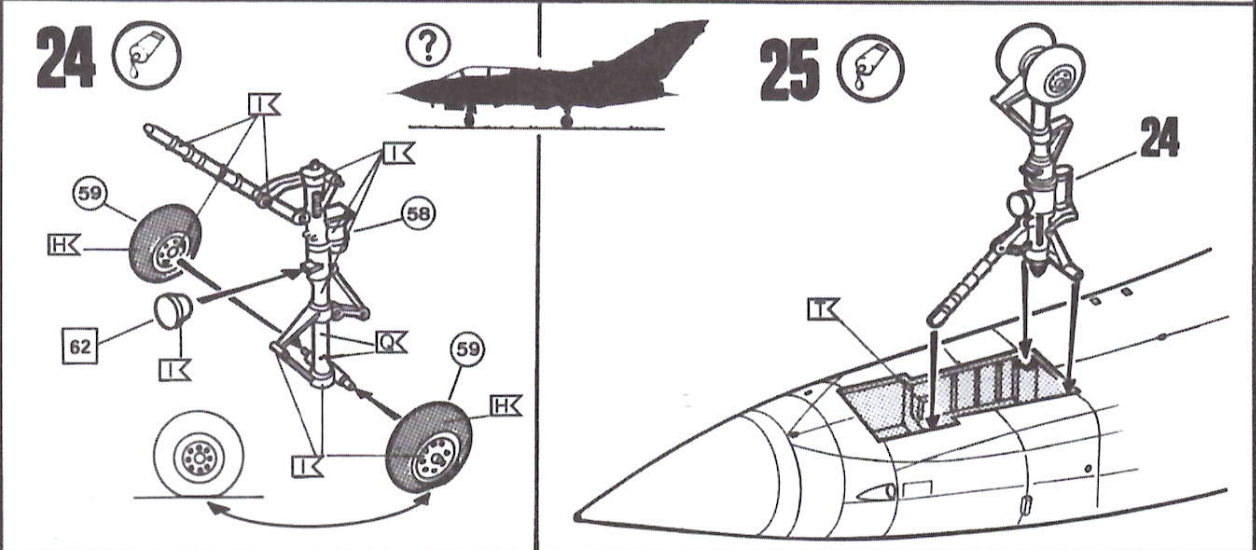
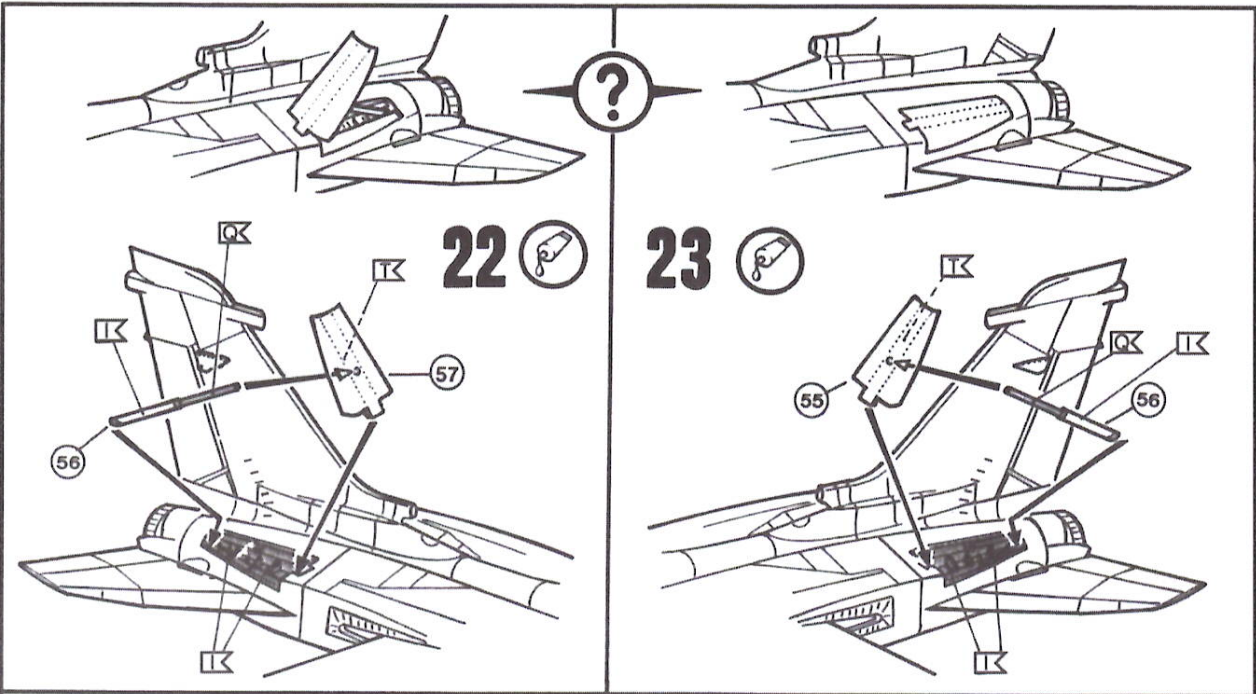

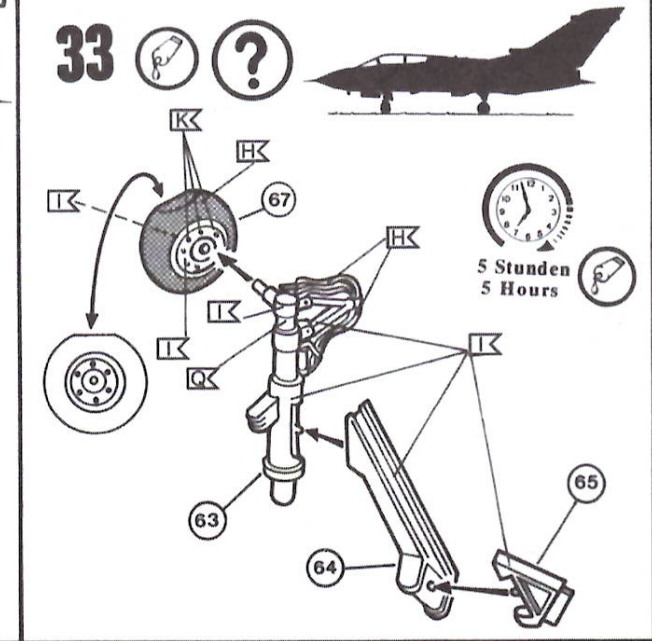
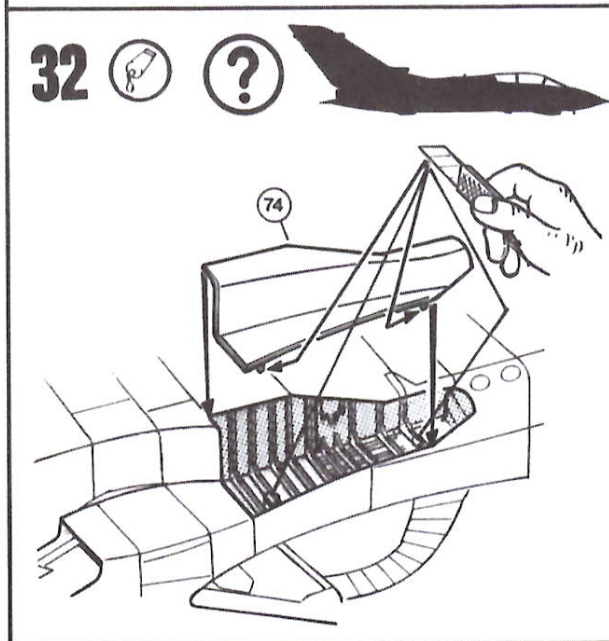
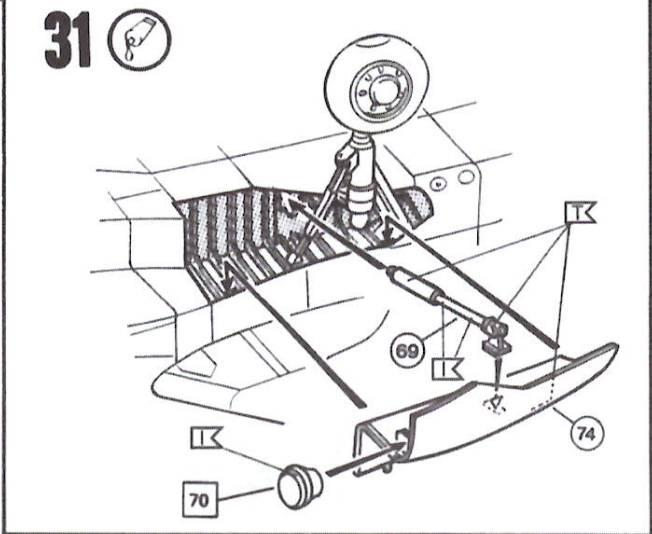
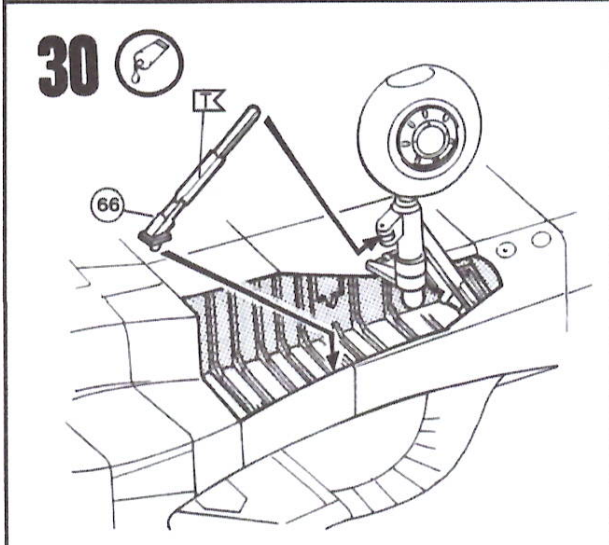
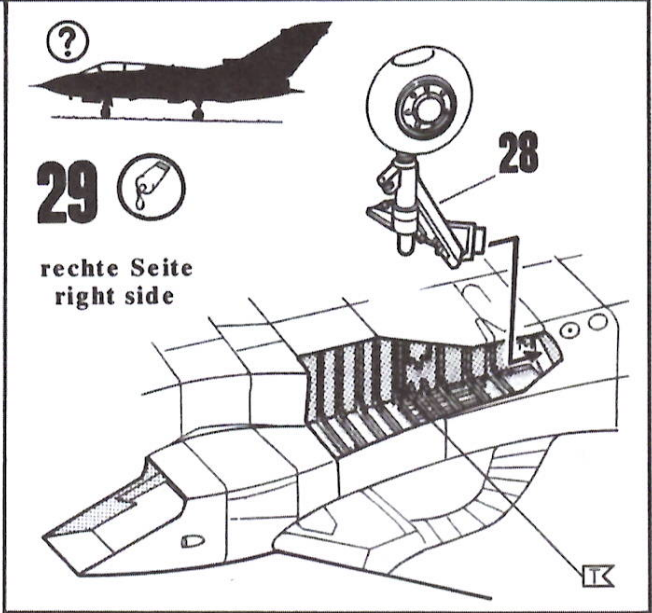
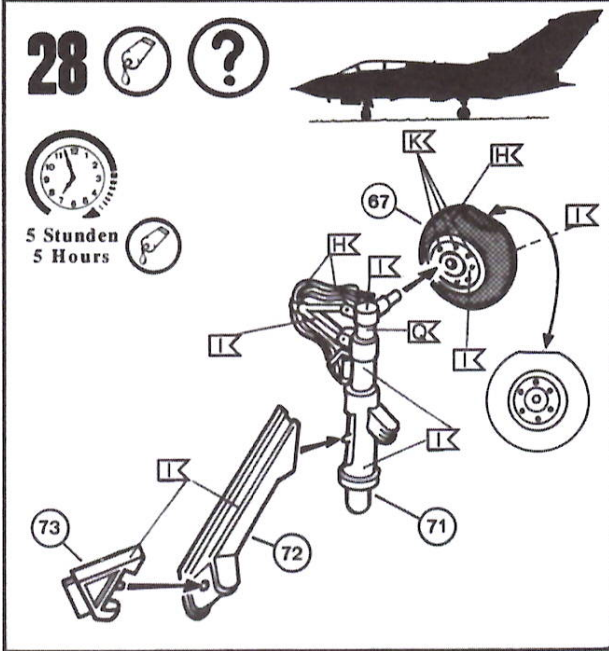

34 

linke Seite
left side

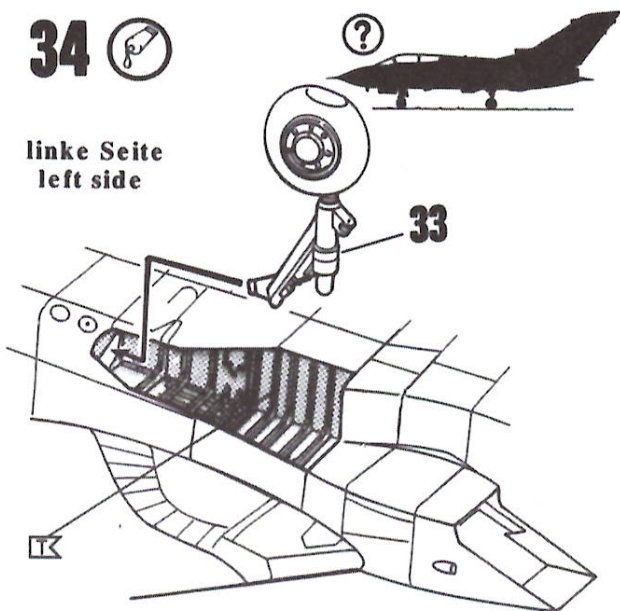

35 

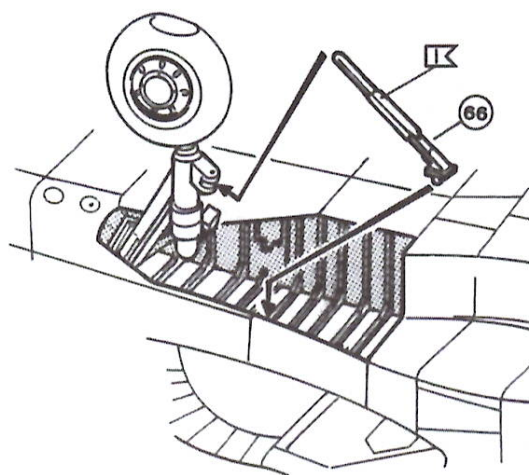

36 

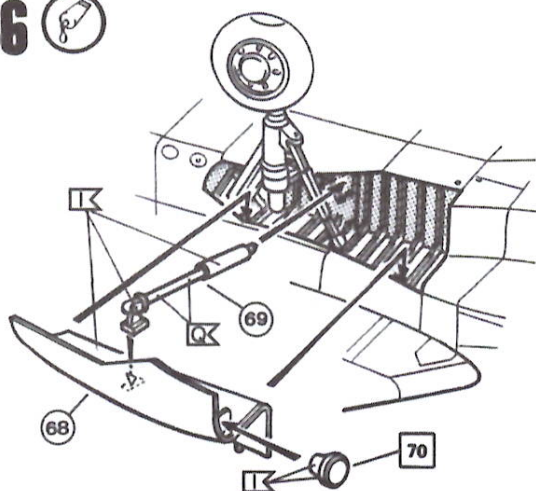

37  

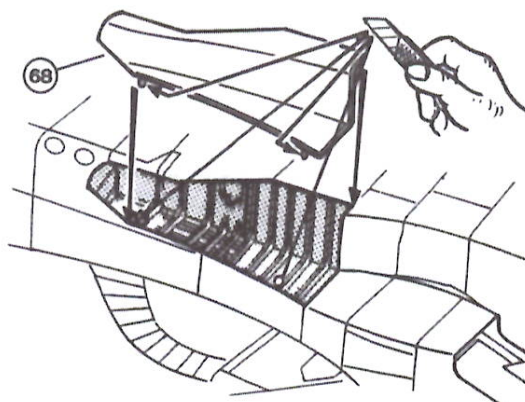

38 

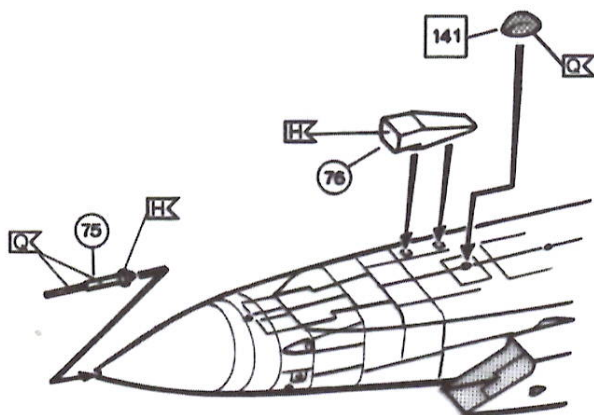

39 

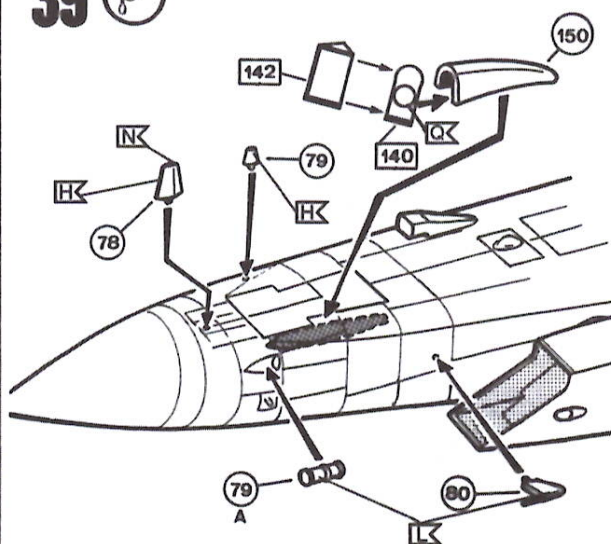

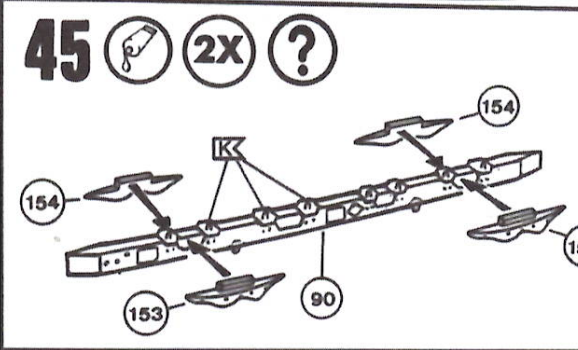
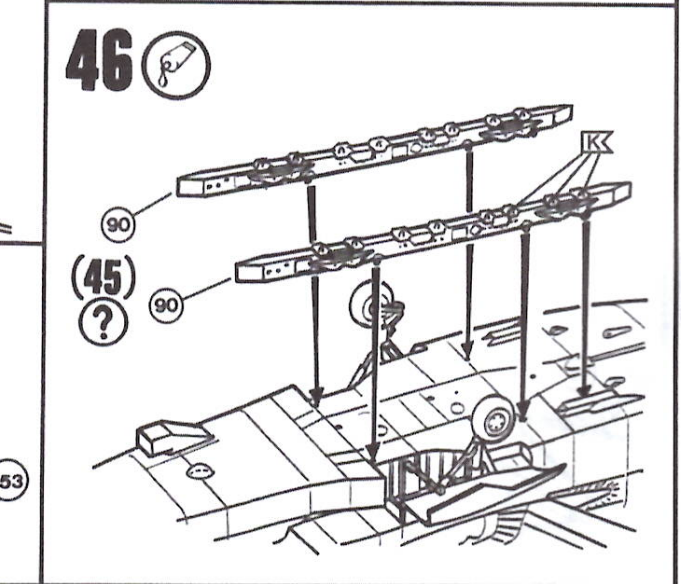
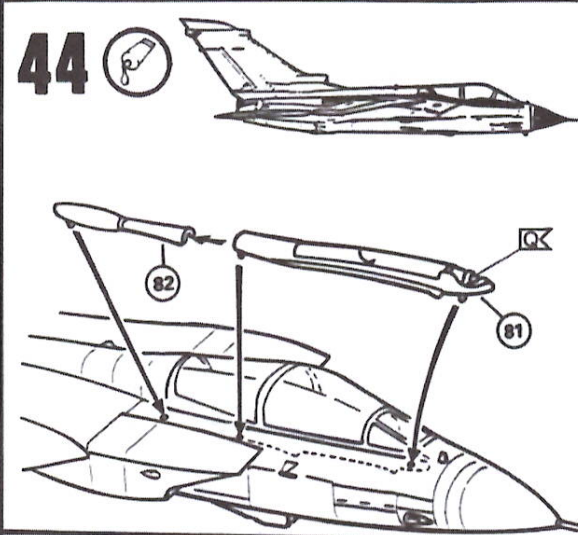
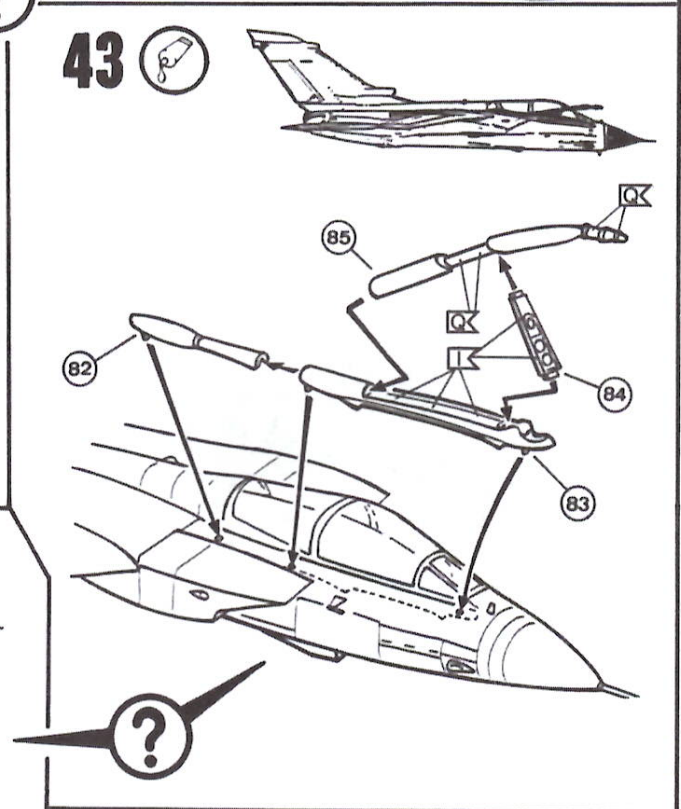
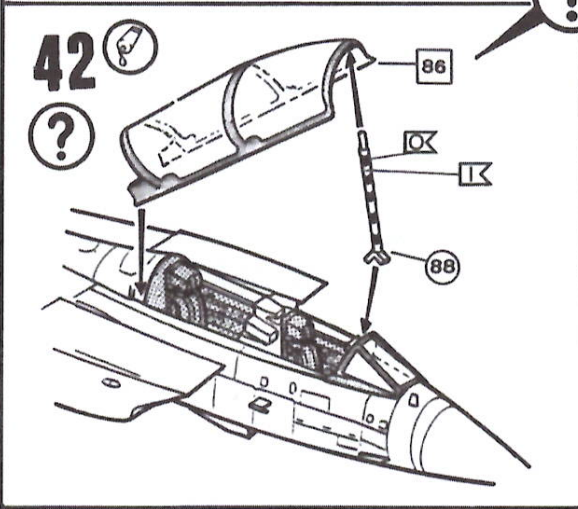
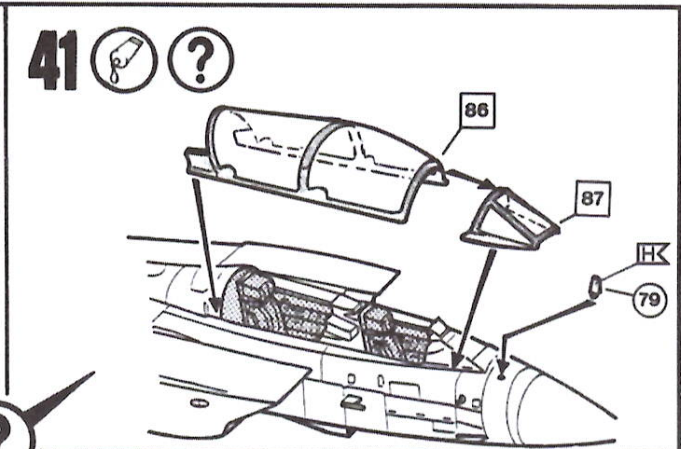
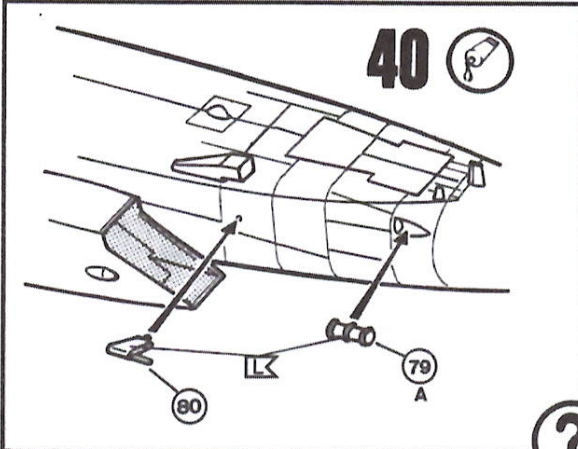

47 

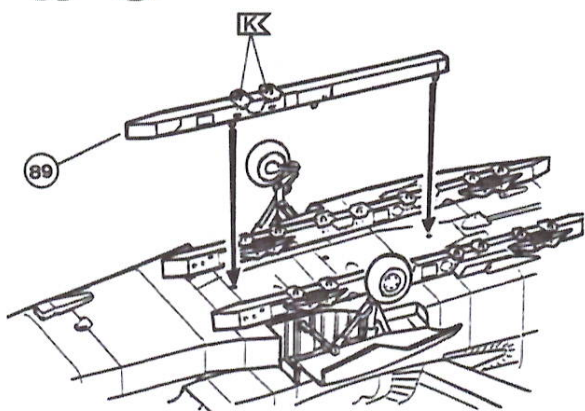

48   1500 Ltr. tank

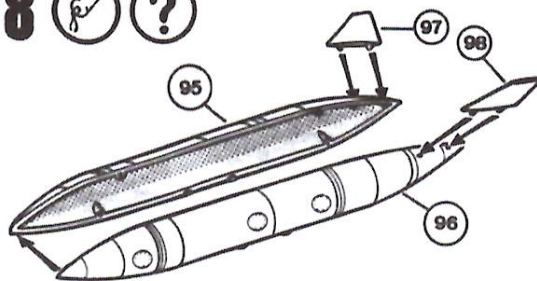

49   1500 Ltr. tank

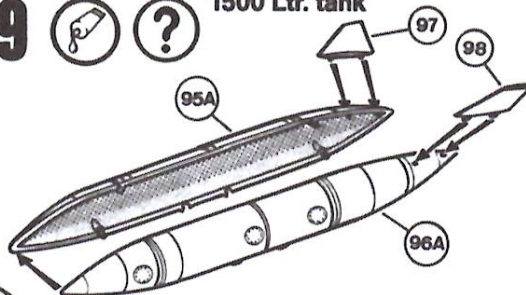

50 

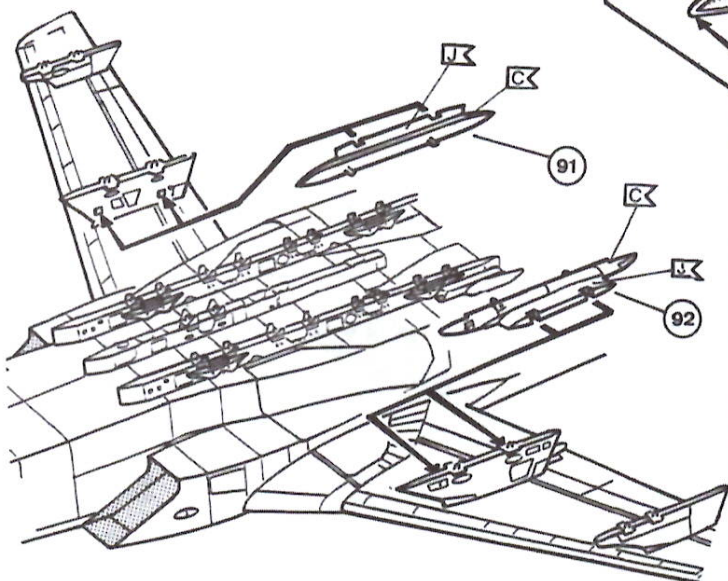

51  

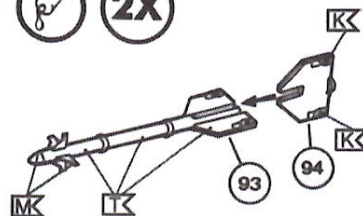

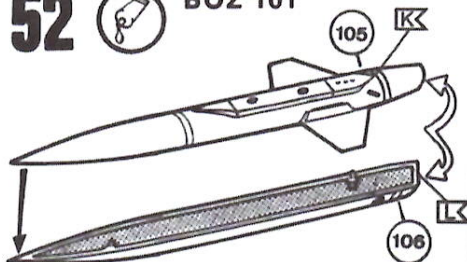

52  BOZ 101

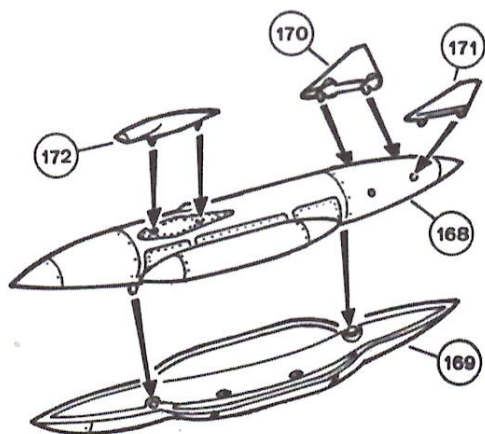

53  SKY SHADOW pod



54    2250 Ltr. Hindenburger tank

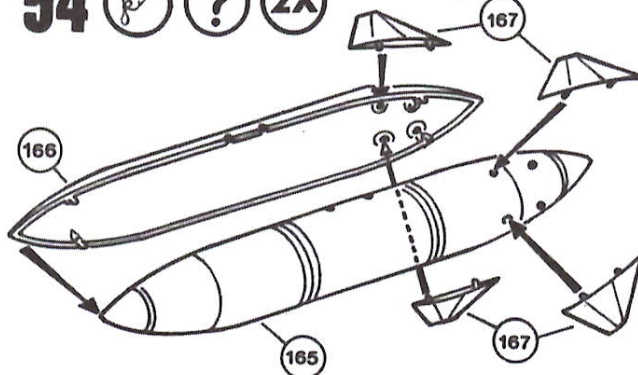

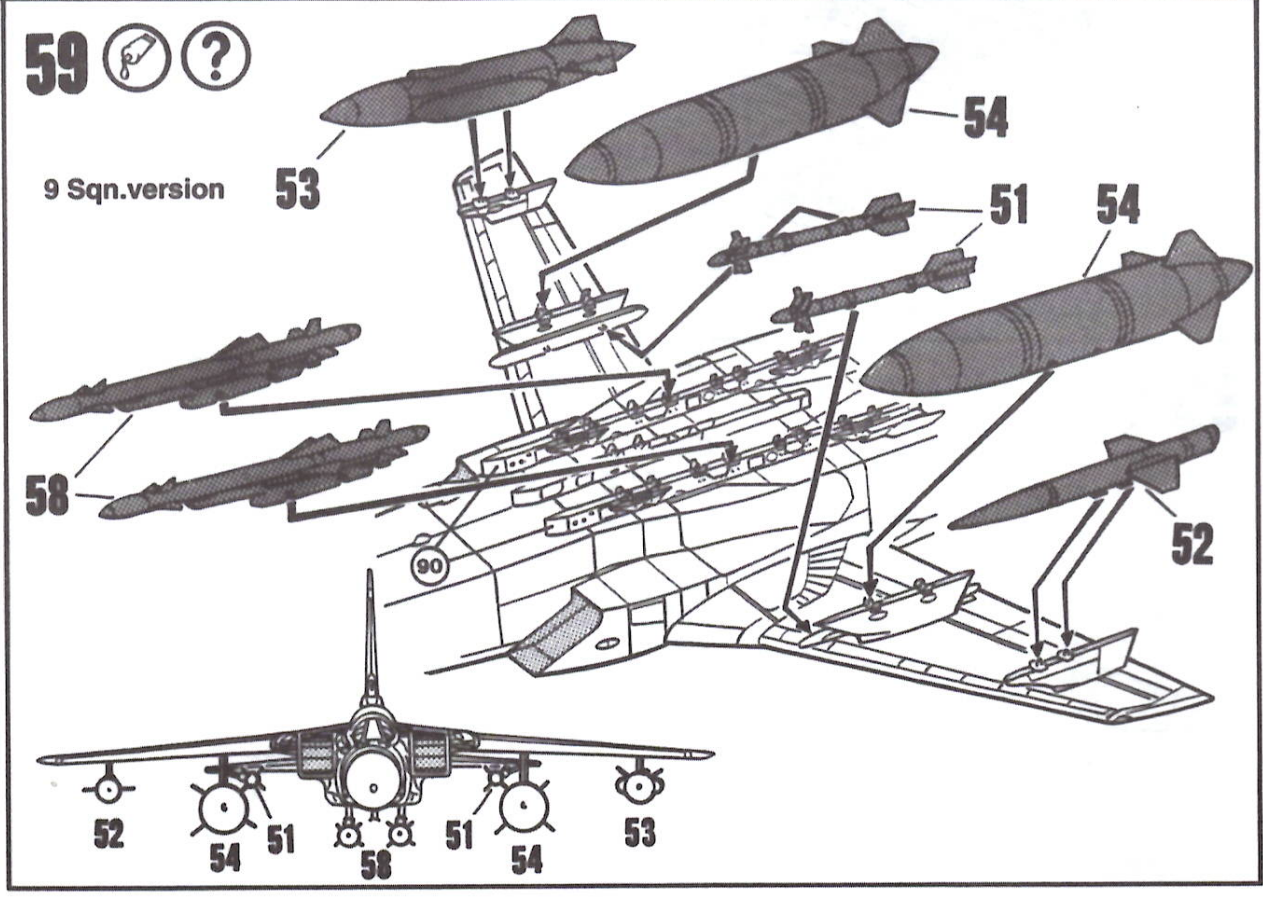
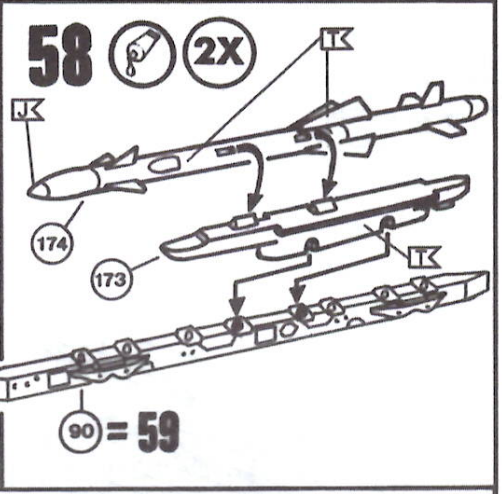
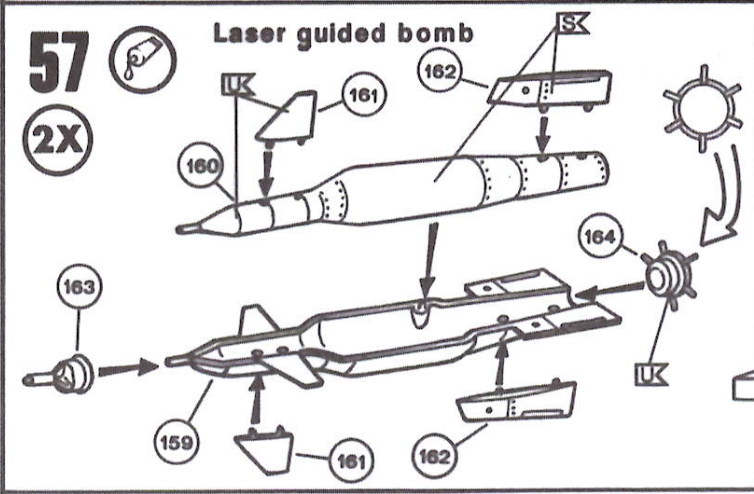
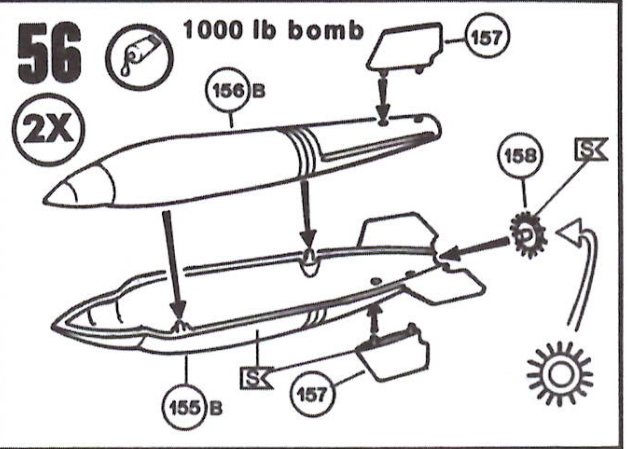
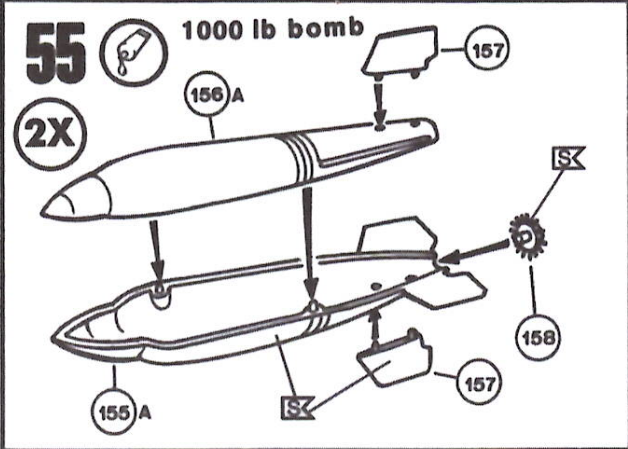

60

17 Sqn.version

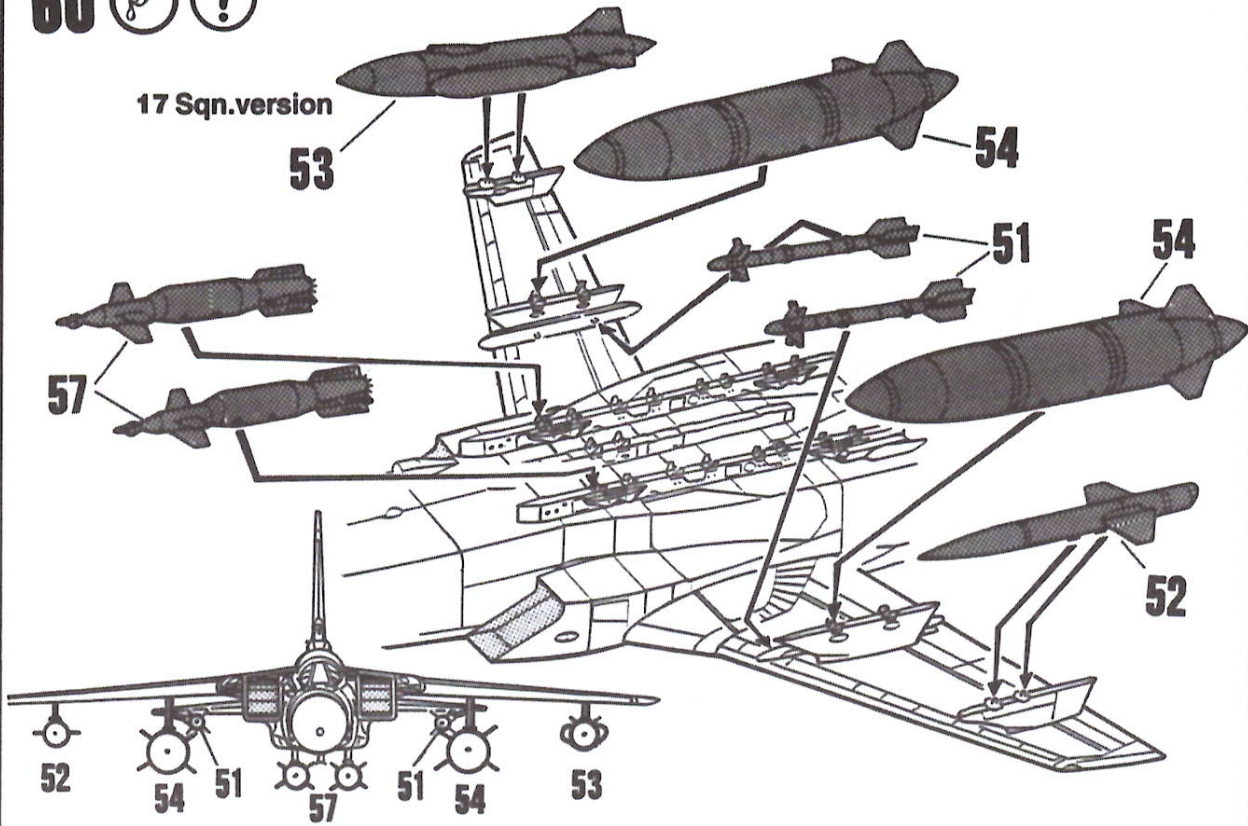

61

17 Sqn.version

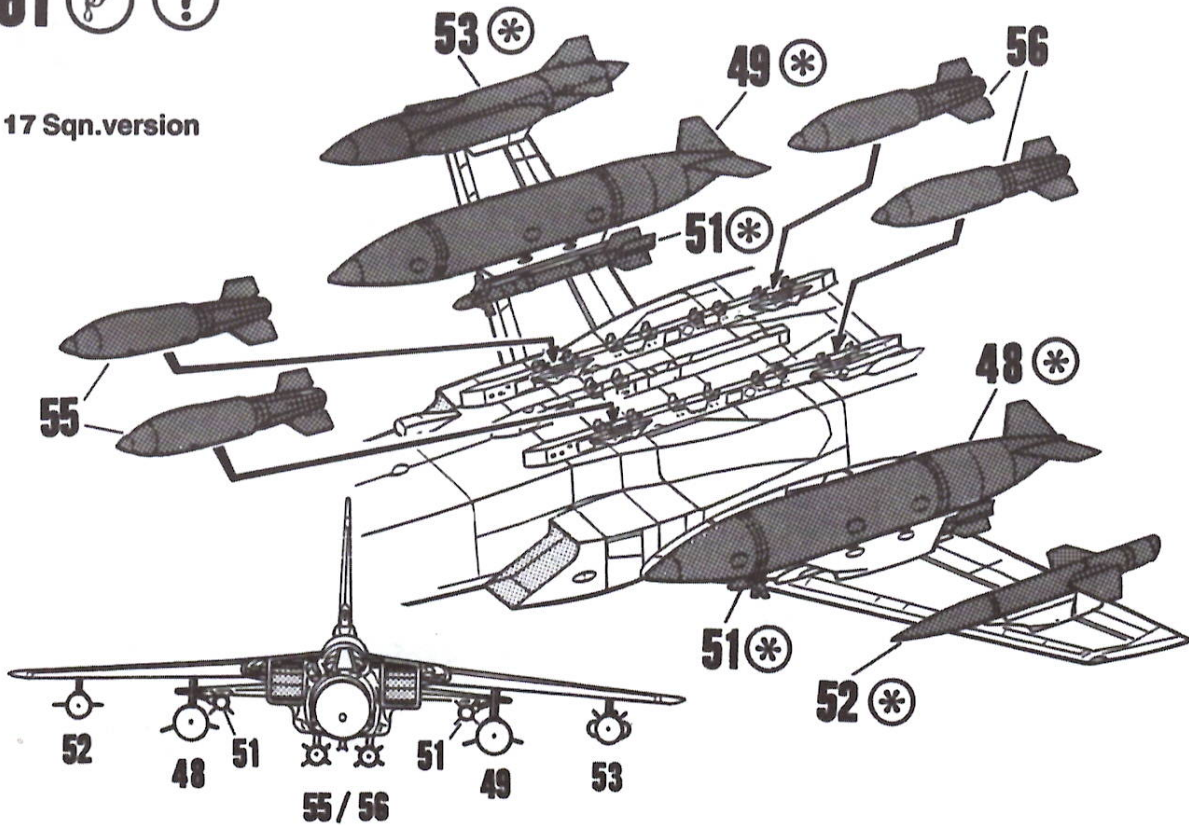

62



General Decals - Sheet 1

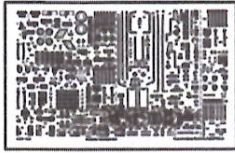

DECAL NOS:

9 SQN: 1-35; 67-131; 132-148; 164-167; 168-175

17 SQN: 36-66; 67-131; 132-143; 149-167; 176-182

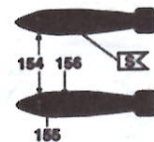
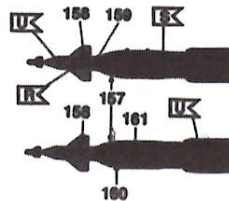
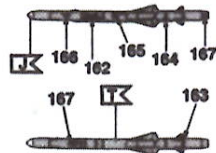
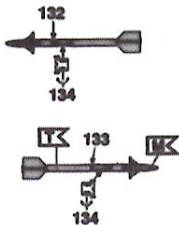
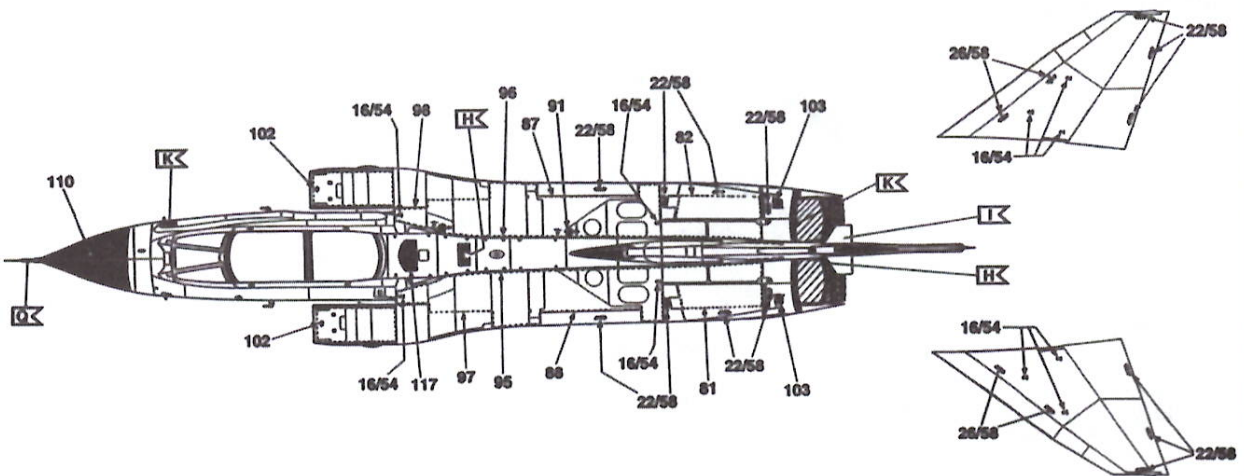
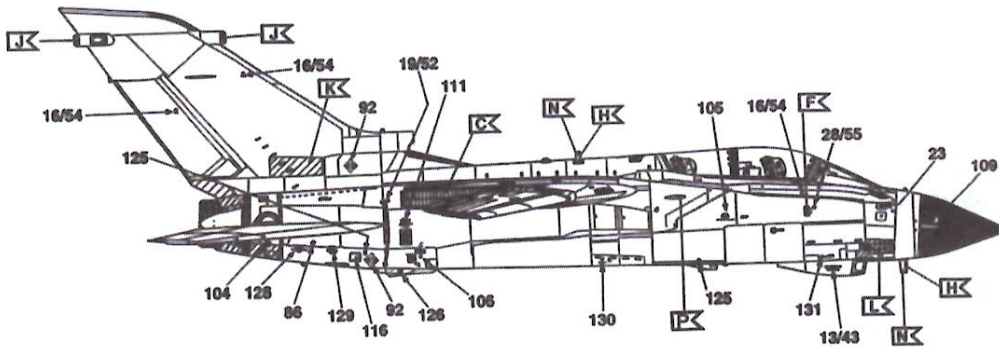
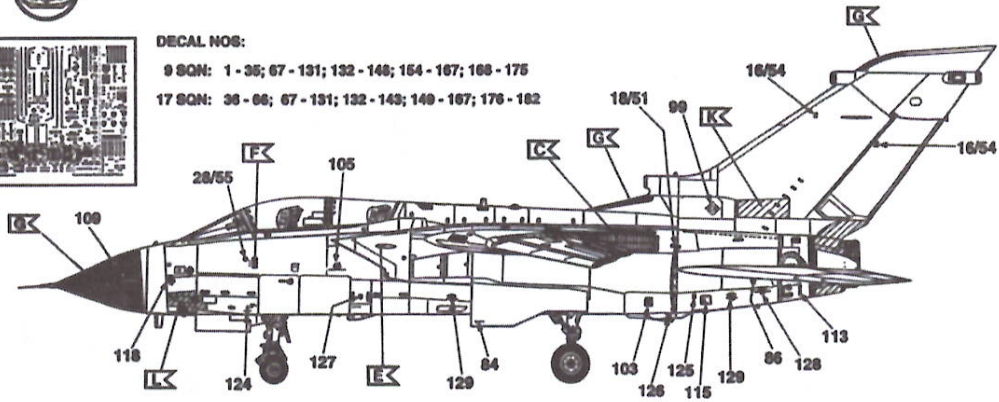

63



General Decals - Sheet 2

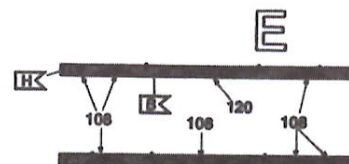
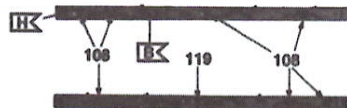
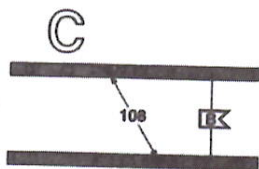
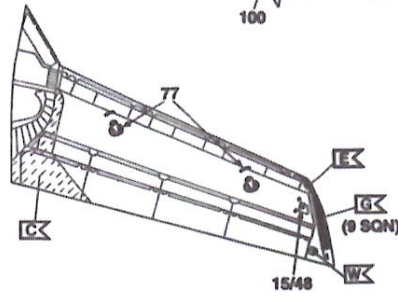
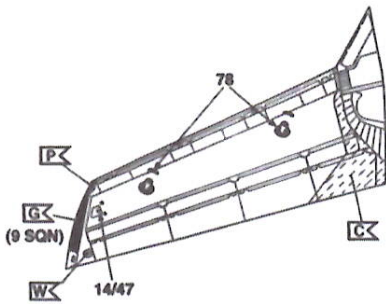
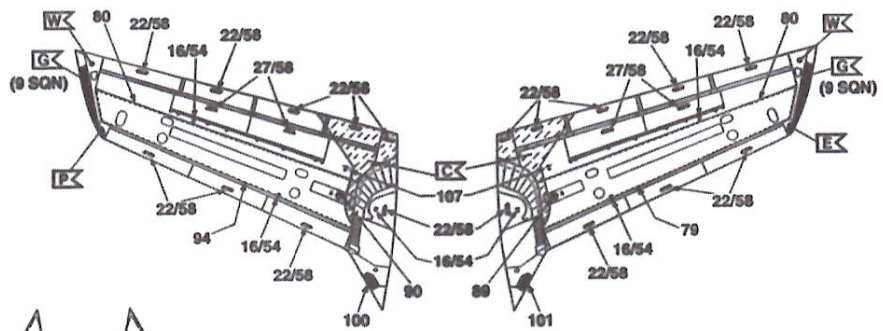
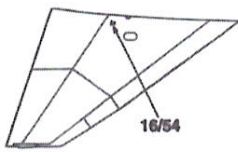
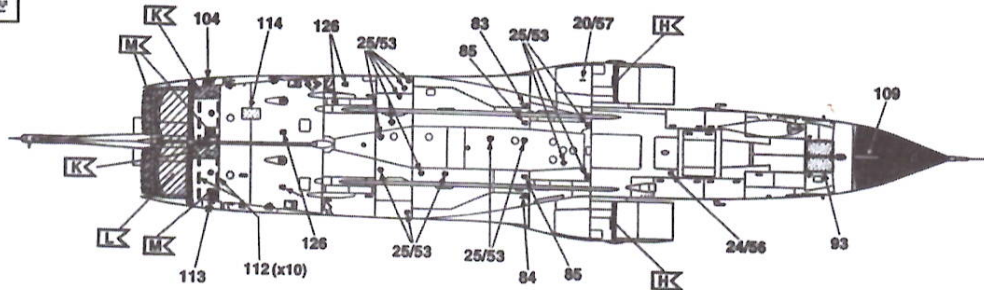
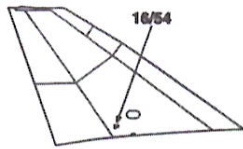
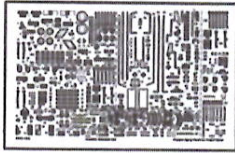

64



PANAVIA TORNADO GR1, No.9 SQUADRON, ROYAL AIR FORCE, BRÜGGEN, GERMANY, 1998

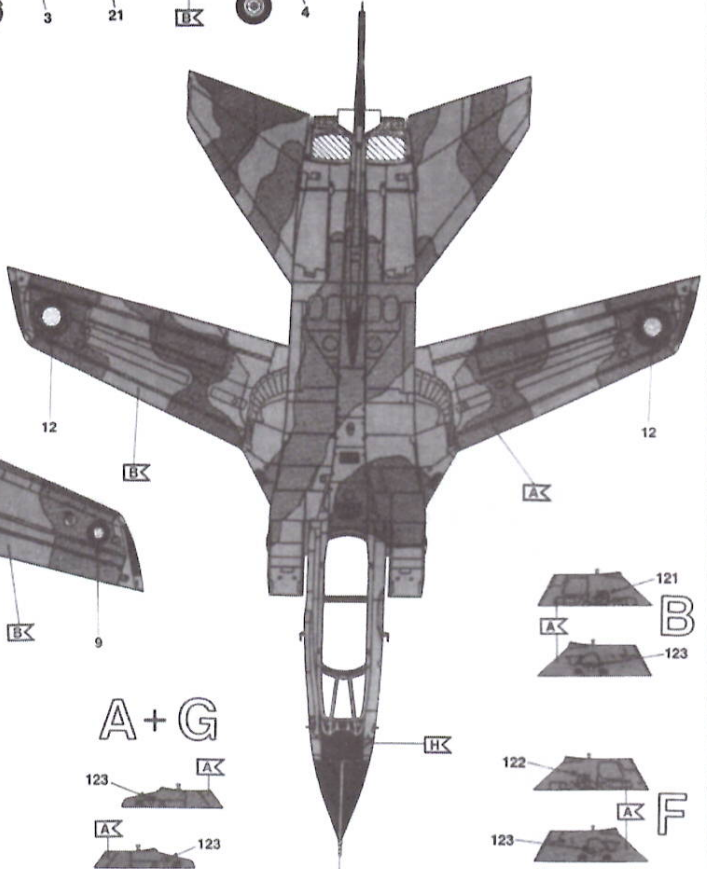
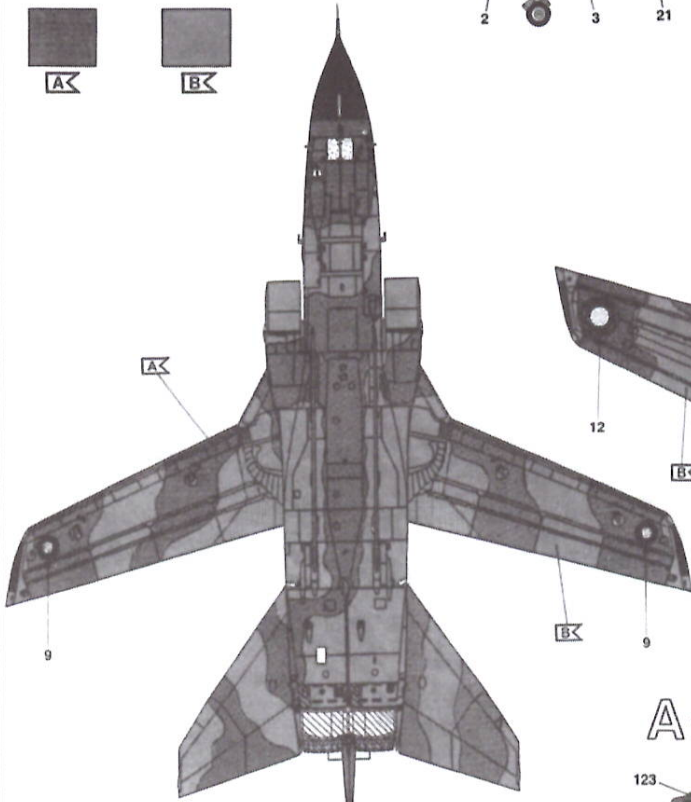
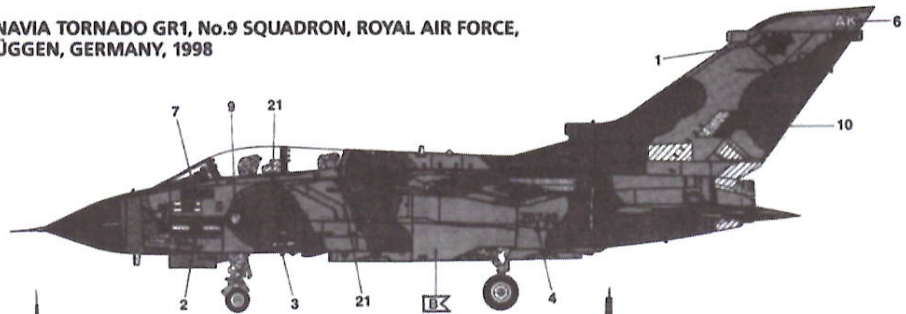
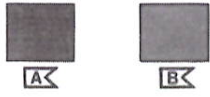
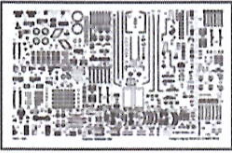

A + G

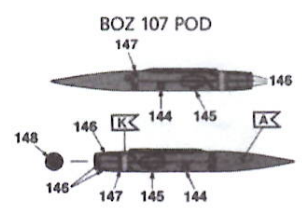
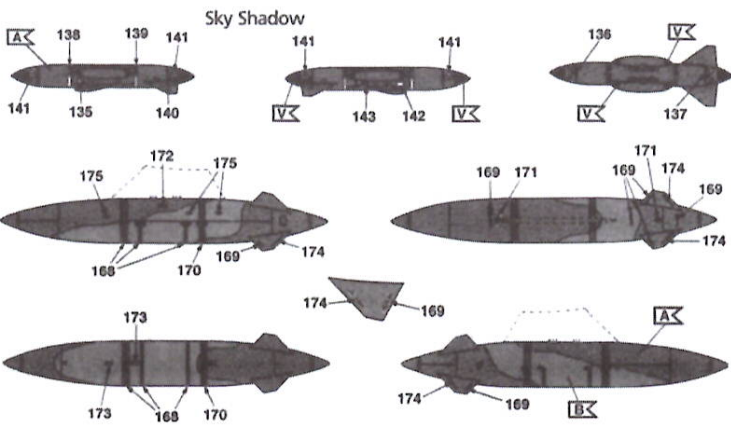
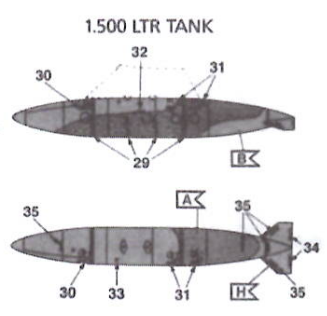
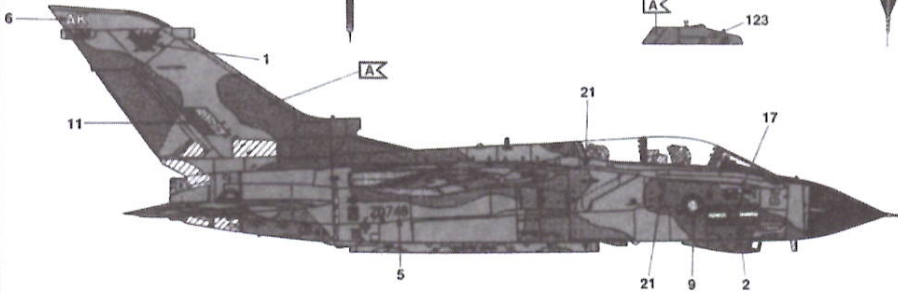
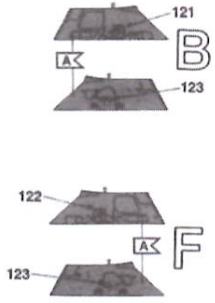
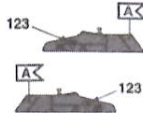

65



PANAVIA TORNADO GR1, No.17 SQUADRON, ROYAL AIR FORCE,
BRÜGGEN, GERMANY, 1998

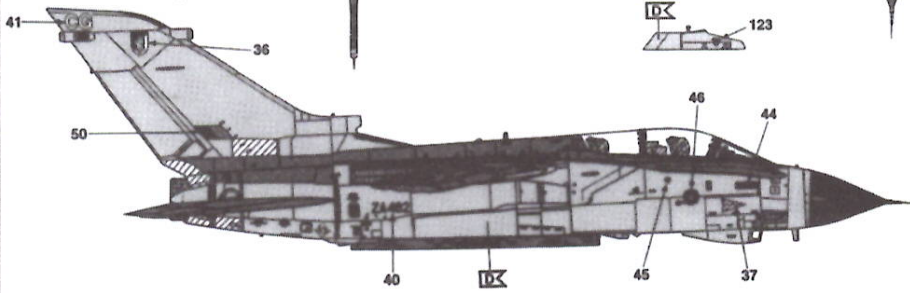
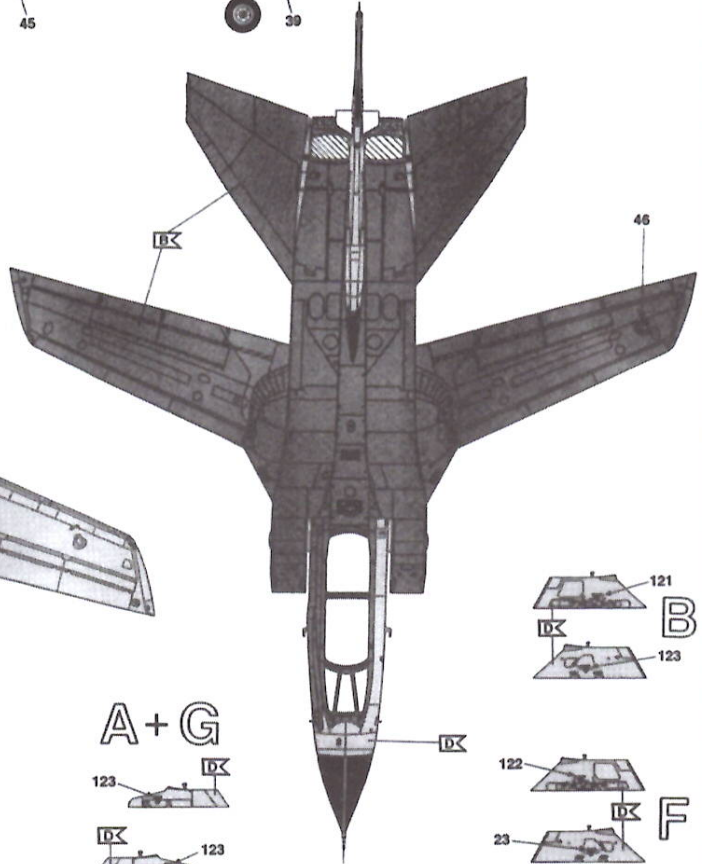
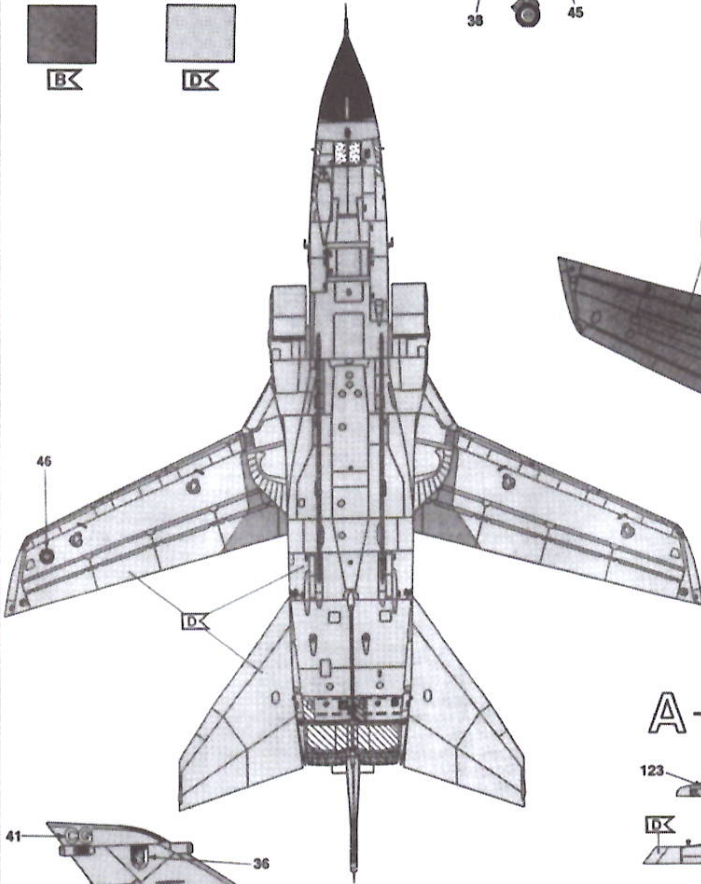
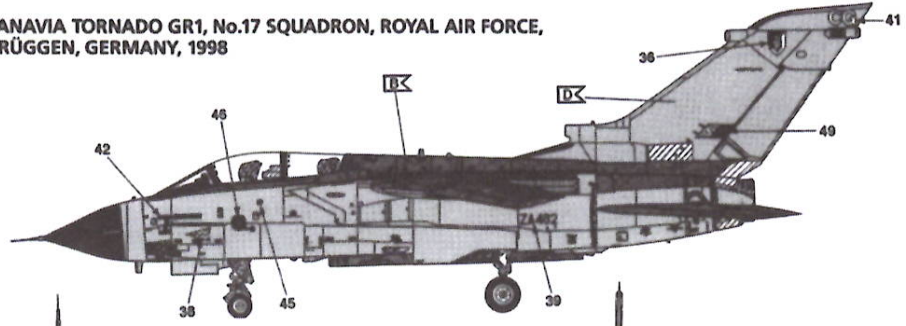
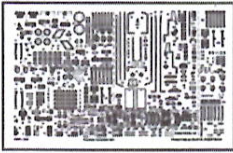

A + G

