

To construct this kit you will need:

1. A modellers knife.
2. Sharp scissors
3. A cutting surface (thick card will do).
4. Card glue, UHU clear adhesive is good.
5. Tweezers for the fine components.

PLEASE READ THESE INSTRUCTIONS THOROUGHLY BEFORE YOU START.

Start by extracting all the components from the backing sheet. Each component is fastened to the sheet by means of a score line. These are cut lines that have only gone part way through the card. They are indicated with BLUE arrows. Run the point of your knife carefully along these score lines to detach from sheet. Place the components on a separate sheet of card until needed.

Fig. 1. GLAZING.

Cut out the glazing pieces along the outer white lines indicated and fix each one to the back of its corresponding window frame and door, with the matt printed side showing through the opening.

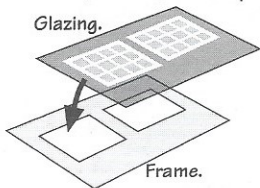

NOTE:
Trim off any edges of glazing that stick out over outer edges of the window frames.

Place windows to one side until needed.

© Copyright 2011 Metcalfe Models and Toys Ltd.



Fig. 2. MAIN WALLS.

Fold the three yellow tabs over and glue to the back of the walls.

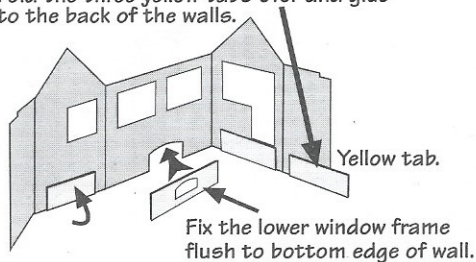

Fig. 3. INSERT THE FLOOR.

Fold the walls around the floor, making sure that it is sitting firmly down on the yellow tabs and the door step sitting on the bottom of the door opening.

The two halves of the back wall meet butt ended together.

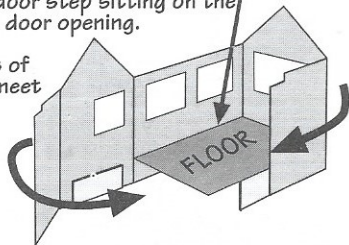
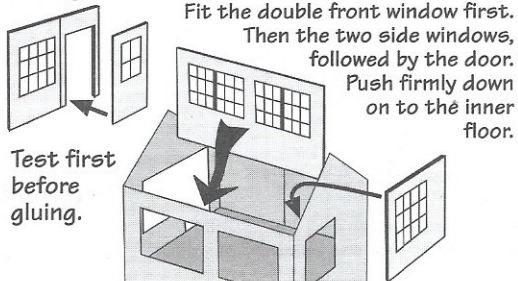

Fig. 4. FIT THE WINDOWS & DOOR.

Fit the double front window first. Then the two side windows, followed by the door. Push firmly down on to the inner floor.



Test first before gluing.

Fig. 5. CHIMNEY STACK.

Glue the seven blue chimney inner spacers together to form a solid block. Keep all edges flush.

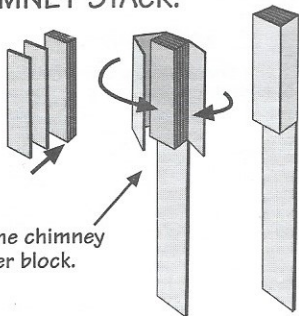

Fold the top of the chimney around the spacer block.

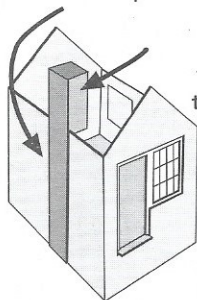

The chimney stack fits so that the long tab covers the joint on the back wall, with the stack sitting on the wall top inside the building.

Fig. 7. ROOF & BARGEBOARDS.

The roof fits neatly around the chimney stack and overhangs equally at both ends.



The three chimney top stones fit centred one on top of the other with the chimney pot (Fig. 8.) sitting on top.

When fast, attach the whole unit on to the top of the chimney stack.

The bargeboards fit onto the gable walls up under the roof. Space out from the wall with strips of waste card cut to 2mm thick.

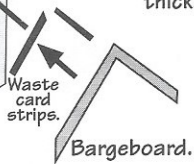
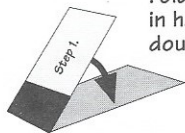

Fig. 6. STEPS.

Fold each of the six steps in half and glue to make double thickness.



Glue the steps on top of each other, starting at the bottom with the longest step no. 1.

Line all the steps up vertically on the back and side edges.

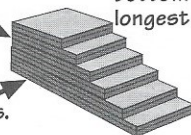

Fit the steps against the wall sitting under the doorstep.

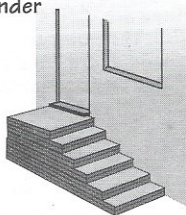

Stairs wall.

Fold the inner walls in to make double sided

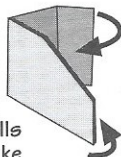

Fit wall to steps and fix handrail.

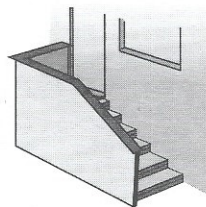

Fig. 8. CHIMNEY POT.

Cut out the terracotta coloured strip below and roll tightly around a nail or drill bit (approx. 4mm. dia.)

