



**SPECIFICATION
GENERAL**

1/72 SCALE

CREW: 5

**COMBAT WEIGHT: 46 TONS
LENGTH OVERALL: MT. 10.10
HULL LENGTH: MT. 7.20
WIDTH: MT. 3.27
HEIGHT: MT. 2.72**

KIT 8312

**GROUND CLEARANCE: MT. 0.55
TRACK WIDTH: MT. 0.66**

**ENGINE
1 MAYBACH HL 230**

**ARMAMENT
1 88 MM PAK 43 GUN
1 7.92 MACHINE GUN**



**PERFORMANCE
MAXIMUM SPEED: 50 KM/H
COMBAT RANGE: 160 KMS**

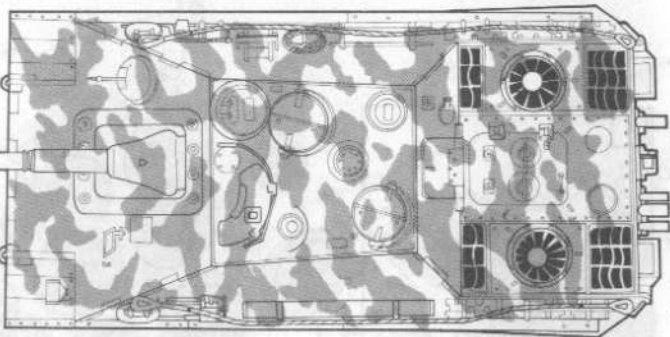

SAND
121 PALE STONE
BEIGE
BLAUGRAU
CREME
SANDFARG
ARENA
SABBIA
FS - 33531

DARK GREEN
30/MS DARK GREEN
VERT FONCE
DUNKELGRÜN
DUNKELGRÜN
MÖRKGRÜN
VERDE SCURO
VERDE SCURO

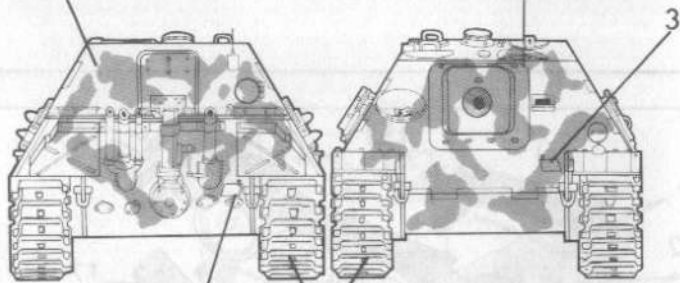

BURNISHED METAL
83 GUN METAL
METAL BRUNI
BRUNIERTE METALL
LIZERLEUR
OKSIDERAD METALL
METAL BRUNIDO
METALLO BRUNITO

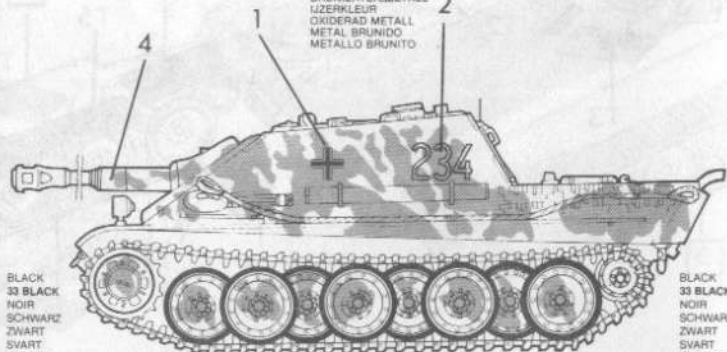

BLACK
33 BLACK
NOIR
SCHWARZ
ZWART
SVART
NEGRO
NERO

BLACK
33 BLACK
NOIR
SCHWARZ
ZWART
SVART
NEGRO
NERO

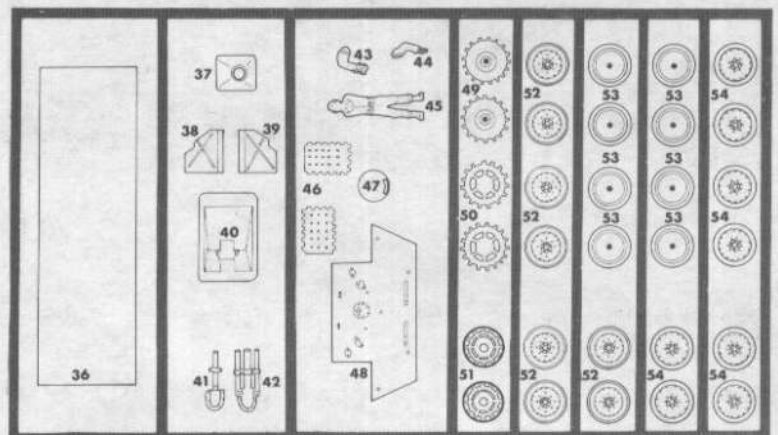
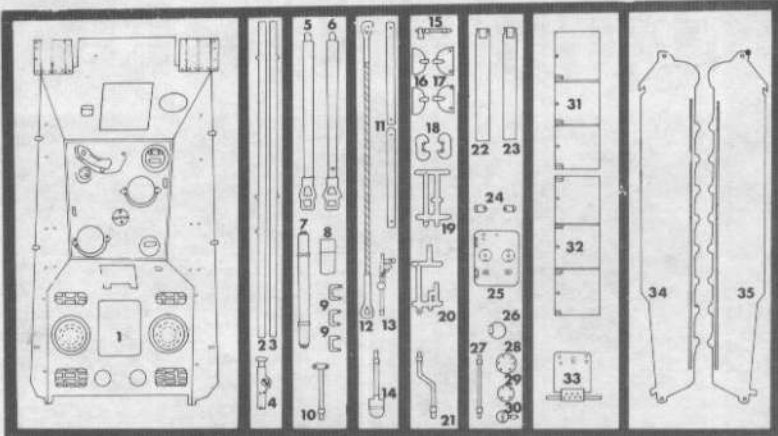

WARNING

Before starting to assemble the model, carefully examine the various assembly phases indicated in the drawings. Carefully remove the parts from the sprues using a razor blade or emery paper. Eliminate any burrs, check the fit of each piece before cementing in place. Before assembly, paint any internal parts of the model or parts which are difficult to get at once assembly has been made. Always follow the assembly order indicated on the tables and, in the case of alternative parts which make it possible to obtain different versions, always choose the version you prefer before assembly. **STEPS TO FOLLOW IN ATTACHING THE DECALS PROPERLY:** Cut out the subject you have chosen, being very careful to clip along its outlines so as not to leave any ragged edges. Soak it for a few seconds in warm water. Carefully separate it from its backing. Place the decal on the model. Remove all drops of water with a dry cloth. Any air bubbles which may have formed can be removed by gently squeezing them out to the edges of the decal.

