

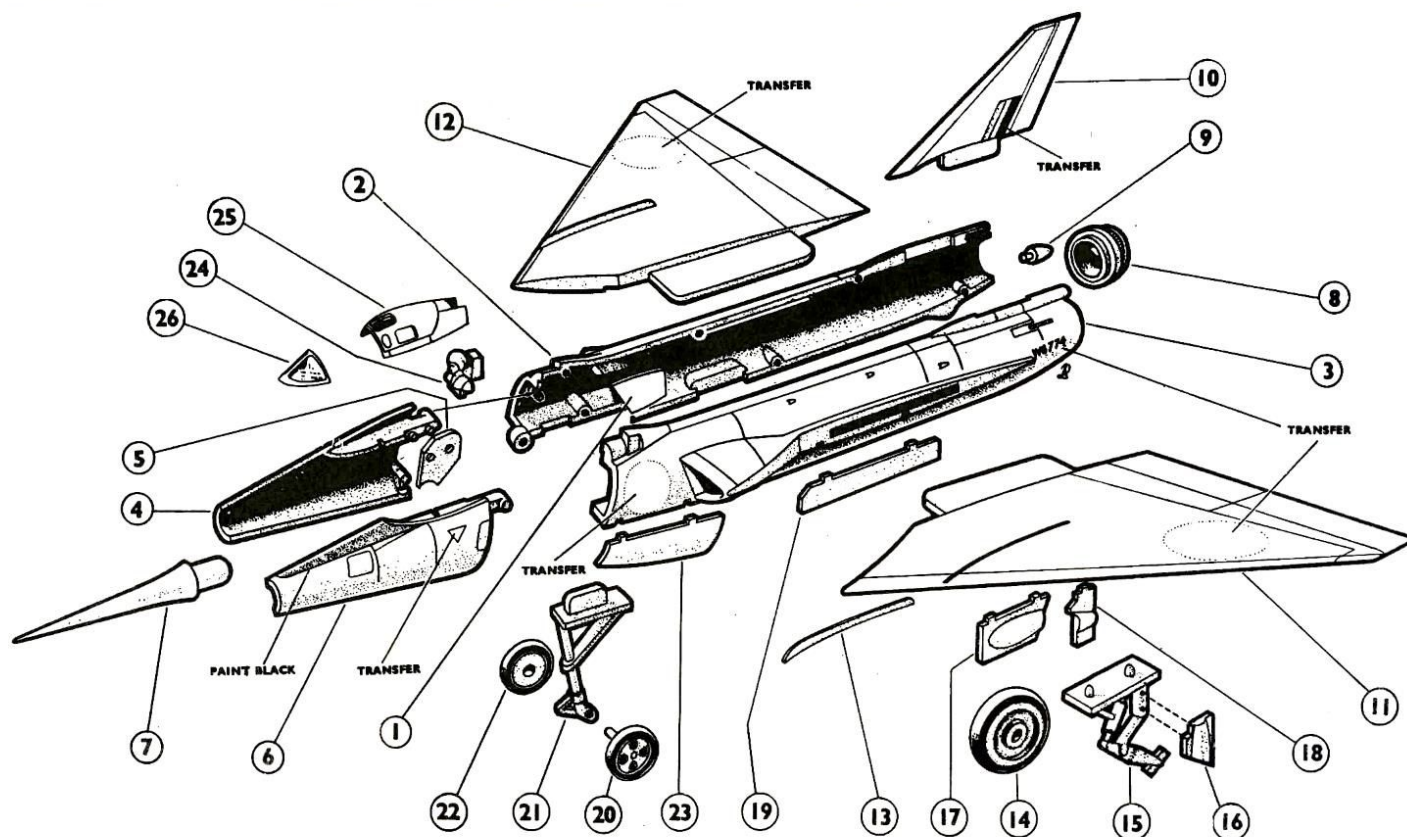

7908

**FAIREY DELTA  
EXPERIMENTAL JET**

1/72nd CONSTANT SCALE KIT



Incorporated in this model is a working "Droop Snoot" nose, as in the real aircraft. The nose of the fuselage is designed to drop to an angle of  $10^{\circ}$  to give the pilot a better view when approaching to land at the steep angle of attack that this type of aircraft has to maintain.

### ASSEMBLY INSTRUCTIONS

For best results study the following instructions and the exploded view before beginning to assemble your kit.

Make sure you know where every part goes and clean away any excess plastic from the parts before starting.

It is best to paint the small parts and any parts which will be inside the fuselage before assembly.

1. First cement the light-deflectors (1) in place in the fuselage halves (2) and (3).

2. Now take the starboard nose-piece (4), fit the light deflector (5) over the guide pins and assemble this to the rear right half (2) by the two larger pins and sockets. **Do not cement these together.** Then cement the other half of the nose (6) by the edges **only**, to the starboard half (4).

Finally assemble the rear port side (3) in place against (2) by cementing the edges only. Use elastic bands to hold them together until they are set. Carefully clean off any surplus cement with a knife, which may have squeezed out.

3. Cement the nose-probe (7) in place at the front of the fuselage, and the exhaust ring (8) at the rear. Also fix the cone piece (9) in place. (This is the braking-parachute housing).

4. Cement the fin (10) in place in the slot provided.  
5. Next cement the wings (11) and (12) in the slots in the fuselage.

6. Carefully cement the "fences" (13) into the slots in the wings.

7. Assemble the main wheels (14) to the undercarriage (15) and seal the ends of the axles by touching them with a hot iron or any heated metal. Fix the cover pieces (16) to the legs, then cement the other doors (17), (18) and (19) in place in their respective slots.

8. Assemble the front undercarriage wheel (20) to the leg (21) and carefully cement the other wheel (22) to the axle. Then cement the doors (23) in place in their slots.

9. Paint the pilot (24) before fixing into place. Then cement it in the slot in the cockpit. Paint the inside of this light green, then cement the canopy (25) to the windshield (26). When set, fix it to the front half of the fuselage only. The rear end of the canopy is meant to slide away from the fuselage when the nose droops. This completes the construction.

# FAIREY DELTA EXPERIMENTAL JET

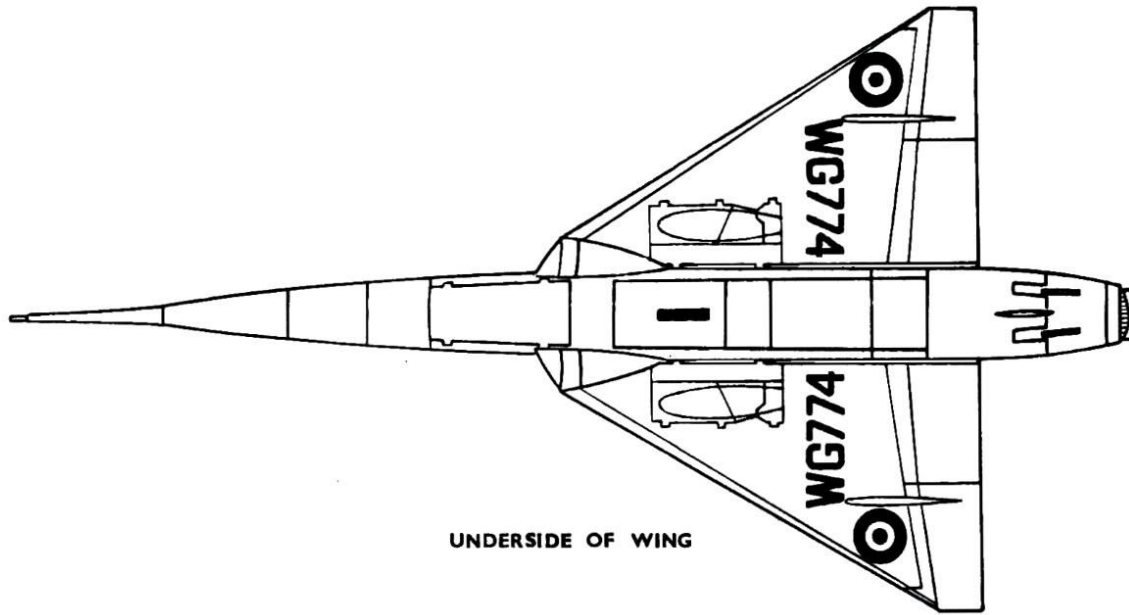

UNDERSIDE OF WING

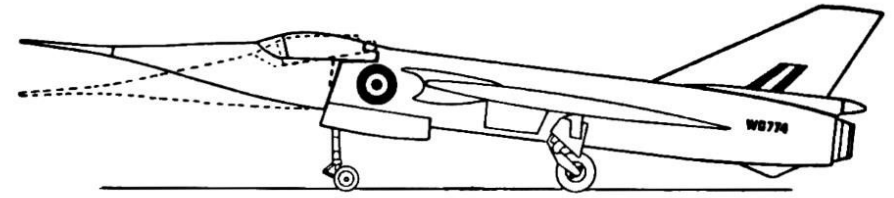

## PAINING AND FINISHING

The model can be left the natural plastic finish, or painted silver (preferably sprayed on). One of the actual aircraft is colored silver, while another carries a purple finish. Paint the top front of the fuselage black as shown on diagram; also the wheel tires, exhaust ring, and undercarriage openings.

## HISTORY

Designed originally for investigating problems at high subsonic speeds, the F.D.2 has proved to be capable of a much higher performance, with speeds well in excess of Mach 1.0 in level flight, as evidenced by its remarkable feat in bettering, by a considerable margin, the World's Air Speed Record at 1,132 m.p.h.

It embodies in its fine aerodynamic design, an extremely thin

wing of 4-5% thickness/chord ratio, and carefully designed intakes to the Rolls Royce Avon turbo-jet engine, which develops some 10,000 lb thrust. An unusual feature is the hinged nose, which allows the pilot an improved view when landing and taxiing on the ground.

Wingspan 26'10". Length 51'7½".