

hawk

SKYRAY F4D-1

The Skyray was first flown on January 23, 1951. The aircraft is powered with a Pratt and Whitney J57-P-2 engine with afterburner. This powerplant has a total thrust of 14,500 pounds. This aircraft is supersonic in level flight.

Wingspan is 33 ft. 6 in. Length is 42 ft. Height is 12 ft. 10 in. The F4D-1 weighs 20,000 lbs. loaded.

Normal armament for all-weather interception is air-to-air missiles, of infra-red and radar homing type. The aircraft shown here is from Marine Squadron VMF 513. This squadron is all-weather and during 1959 was stationed at El Toro Marine Corps Air Station, California.

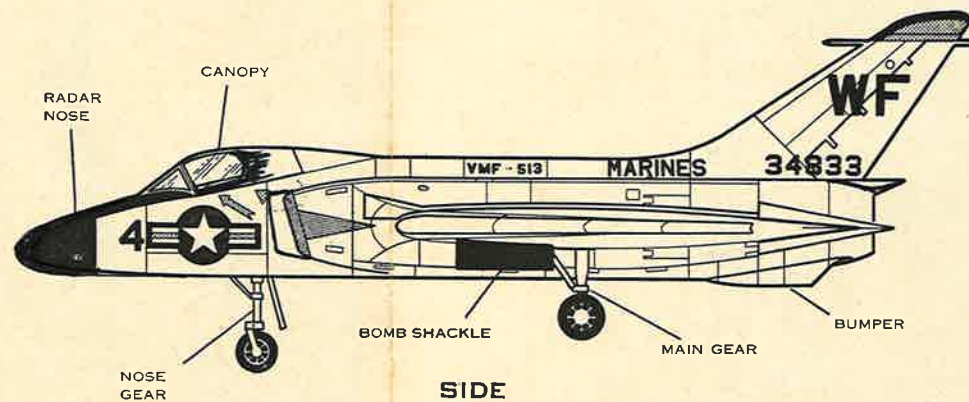
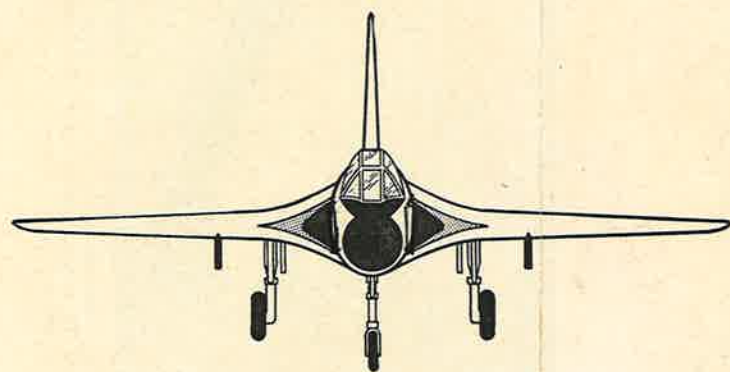
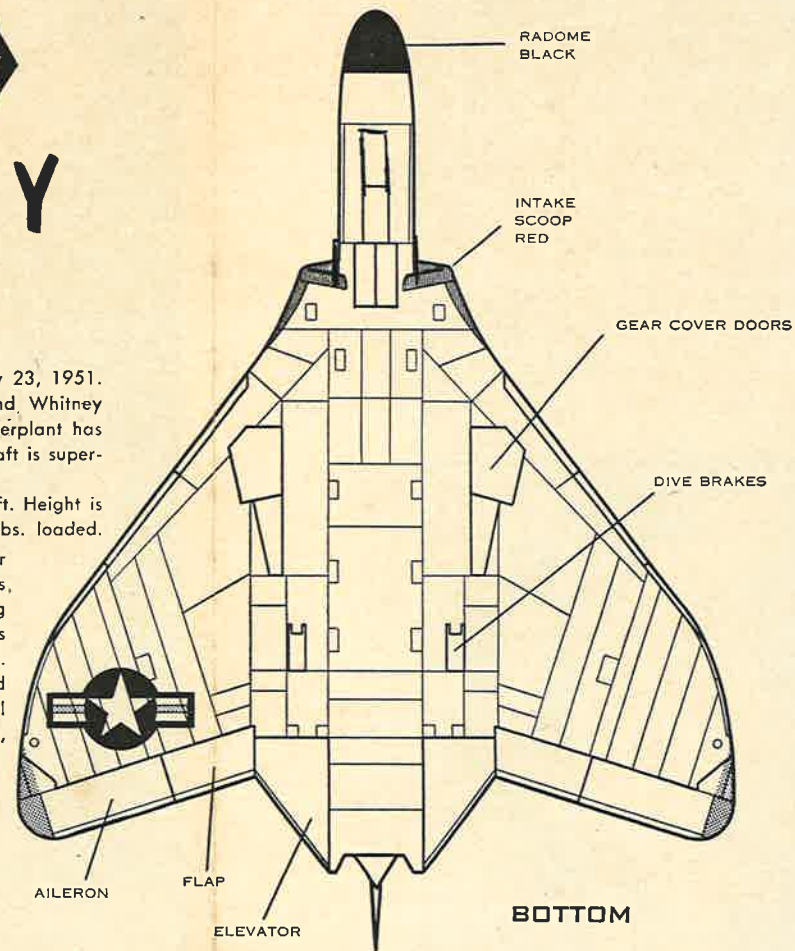
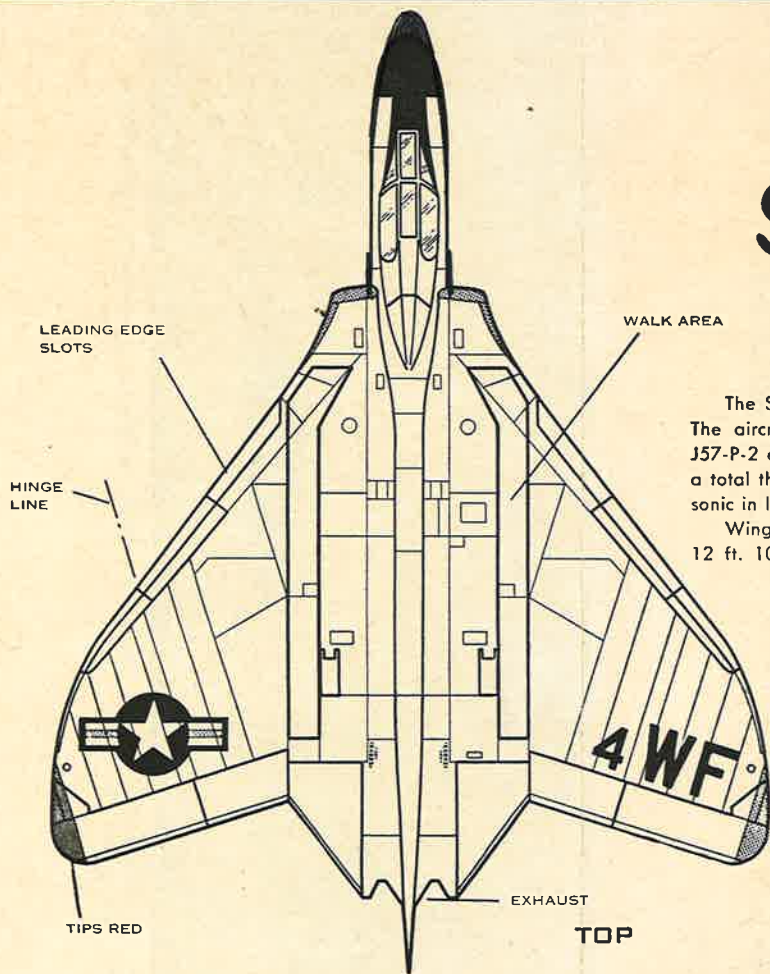

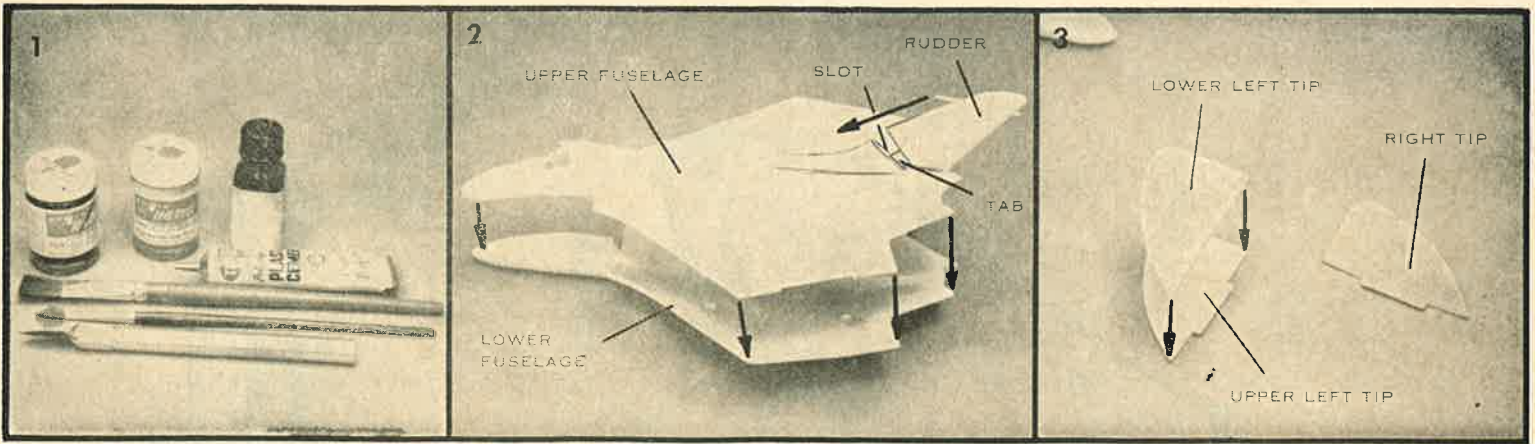

Shown above are tools needed for a perfect model. Paint: flat gray and flat black. Glue: tube or liquid. Brushes: small and wide. An X-Acto knife. Read the instructions carefully. Decide now to make your model with wings folded or extended.

Glue the upper fuselage to the lower fuselage. Now glue the rudder into place. Be neat! Do not use too much glue.

Glue the wing tips together as shown.

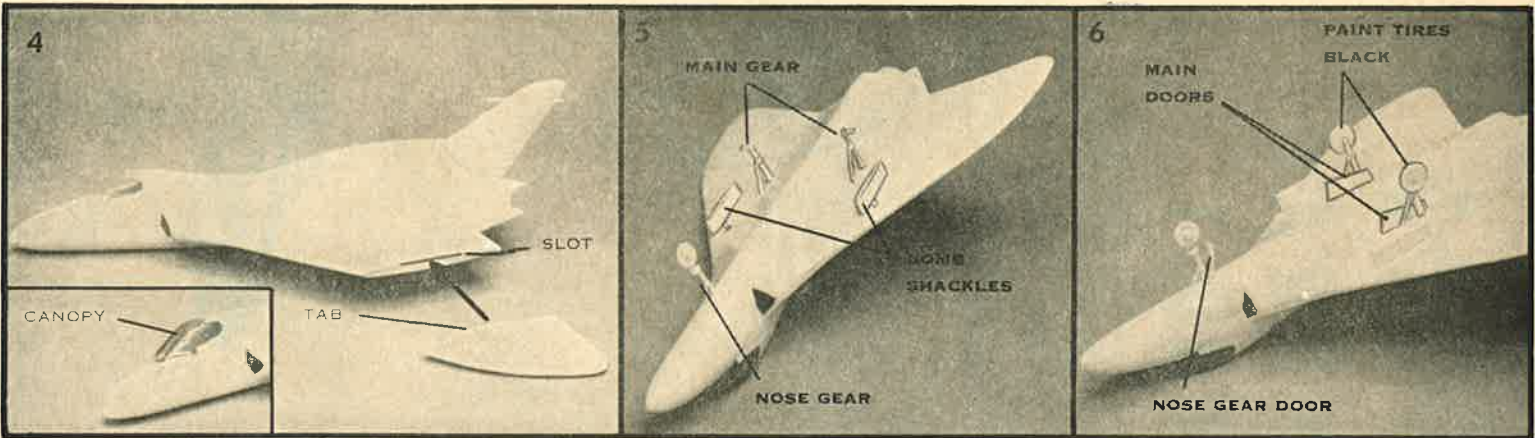

If you want the model to have the wings extended glue them in place now. If you want the tips folded then wait until later before attaching them. Glue the canopy into position.

Glue the landing gear into place. Now attach the bomb shackles as shown.

Paint the tires black and attach them to the model. Now glue the landing gear door into place.

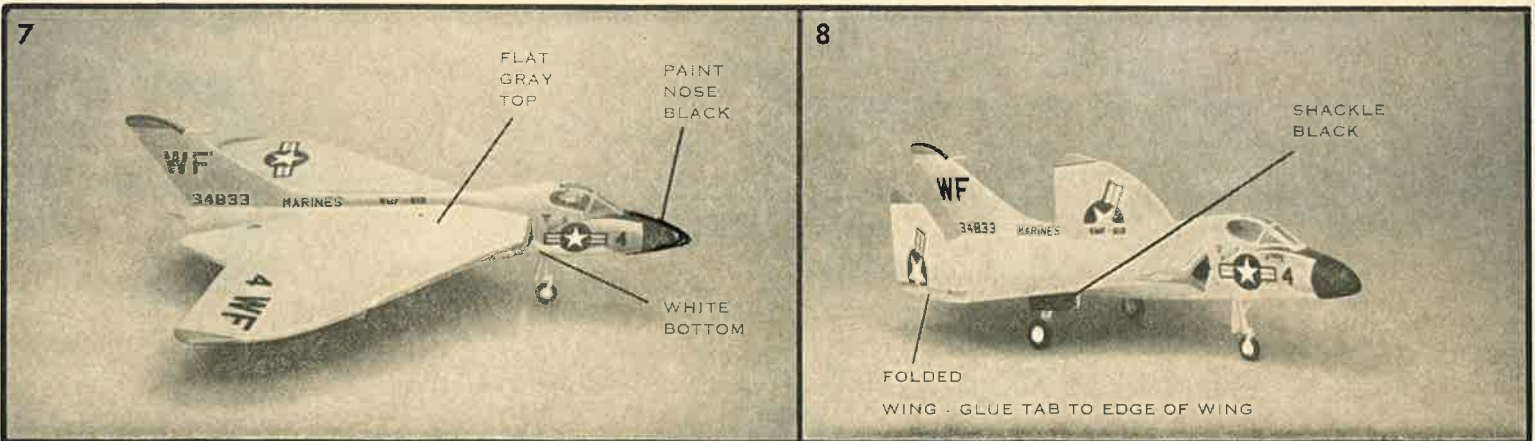

You may attach the decals without painting the model. It is more realistic to paint the model however. Apply the decals as shown here and on the four-view plan.

The folded wing tips are glued to the end of the wing as shown.