



# Kenworth W-900

07659-0389

© 2019 by REVELL GmbH



## Ersatzteile benötigt?

Kein Problem. Einfach den Revell-Service mit Angabe von Artikel- und Teilenummer kontaktieren. Entweder unter [service@revell.de](mailto:service@revell.de) oder Revell GmbH, Abteilung X, Henschelstr. 20-30, 32257 Bünde.\*

\*Wir bitten um Verständnis, dass eine Gewährleistung nur bei aktuellen Artikeln, die im Zeitraum der letzten 24 Monate erworben wurden, übernommen werden kann. Mit der Ersatzteil-Bestellung können Kosten z.B. für Verpackung und Versand entstehen. Ob diese Kosten anfallen wird im Vorfeld schriftlich durch unseren Service mitgeteilt. Das Angebot kann dann angenommen oder abgelehnt werden. Unfrei eingesandte Ersatzteil-Bestellungen werden von uns nicht angenommen! Dieser Direktservice gilt für die Länder Deutschland, Benelux, Österreich, Frankreich, Großbritannien. Ersatzteil-Bestellungen aus den übrigen Ländern werden über die jeweiligen Distributeure abgewickelt. Bitte kontaktieren Sie Ihren Händler.

## Need spare parts?

No problem. Contact Revell Service with the item number and part numbers you need: [service@revell.de](mailto:service@revell.de) or Revell GmbH, Unit 10, Old Airfield Industrial Estate, Cheddington Lane, Tring, Herts, HP23 4QR, Great Britain.\*

\*We request your understanding that a warranty can only be accepted for current articles which have been purchased in the last 24 months. Orders for spare parts may also be subject to costs for packaging and shipping. You will be notified in advance by our Service department if such costs are incurred. The offer can then be accepted or rejected. We will not be able to process any postal requests unless correct postage has been applied to mailing! This direct service applies to the countries: Germany, Benelux, Austria, France, and the United Kingdom. Spare part orders from other countries are processed by the local distributors. Please contact your dealer.

## Besoin de pièces de rechange?

Il vous suffit de contacter le service Revell et d'indiquer la référence de l'article et de la pièce. Soit en écrivant par mail à [france@revell.de](mailto:france@revell.de) (uniquement pour la France) ou par courrier à Revell GmbH, Département X, Henschelstr. 20-30, D-32257 Bünde.\*

\*La garantie s'applique pour les articles présents au catalogue et achetés au cours des 24 derniers mois. Merci de votre compréhension. La commande de pièces de rechange peut donner lieu à des frais supplémentaires, par ex. pour l'emballage et le port. Notre service client vous en informera au préalable par écrit. Vous pourrez accepter ou refuser le devis. Nous n'acceptons pas les commandes de pièces de rechange envoyées sans affranchissement! Ce service direct est valable pour les pays suivants : Allemagne, Benelux, Autriche, France, Grande-Bretagne. Les commandes de pièces en provenance d'autres pays sont traitées par les distributeurs correspondants. Veuillez contacter votre revendeur.

## Hebt u reserveonderdelen nodig?

Geen probleem! Neem eenvoudig contact op met de klantenservice van Revell en geef ons het artikel- en onderdeelnummer door. U kunt ons bereiken op [service@revell.de](mailto:service@revell.de) of per post: Revell GmbH, Afdeling X, Henschelstr. 20-30, 32257 Bünde.\*

\*Wij vragen uw begrip voor de omstandigheid, dat er alleen garantie kan worden geboden voor actuele artikelen, die in de afgelopen 24 maanden zijn gekocht. Met het bestellen van reserveonderdelen kunnen kosten gemoed zijn, bijv. voor verpakking en verzending. U wordt vooraf schriftelijk door onze klantenservice op de hoogte gesteld als er kosten zouden ontstaan. Het aanbod kan dan worden aangenomen of afgewezen. Wij nemen geen ongefrankeerde bestellingen van reserveonderdelen aan! Deze rechtstreekse service wordt verleend in de landen Duitsland, de Benelux, Oostenrijk, Frankrijk en Groot-Brittannië. Bestellingen van reserveonderdelen in de overige landen worden afgewikkeld via de betreffende distributeurs. Neem hiervoor contact op met uw verkoper.



## Verwendete Symbole/Used Symbols

Bitte beachten Sie folgende Symbole, die in den nachfolgenden Baustufen verwendet werden.  
**Veuillez noter les symboles indiqués ci-dessous, qui sont utilisés dans les étapes suivantes du montage.**  
 Sivanse tener en cuenta los símbolos facilitados a continuación, a utilizar en las siguientes fases de construcción.  
**Si prega di fare attenzione ai seguenti simboli che vengono usati nei susseguenti stadi di costruzione.**  
 Huomioi seuraavat symbolit, joita käytetään seuraavissa kokoomisvaiheissa.  
**Legg merke til symbolene som benyttes i monteringsstribene som følger.**  
 Pozostważać na następujące symbole, które są użyte w poniższych etapach montażowych.  
**Daha sonrakı montaj basamaklarında kullanılacak olan, aşağıdaki sembollere lütfen dikkat edin.**  
 Kérjük, hogy a következő szimbólumokat, melyek az alábbi építési fokokban alkalmazásra kerülnek, vegyétek figyelembe.

Please note the following symbols, which are used in the following construction stages.  
**Neen a.u.b. de volgende symbolen in acht, die in de onderstaande bouwfasen worden gebruikt.**  
 Por favor, preste atenção aos símbolos que seguem pois os mesmos serão usados nas próximas etapas de montagem.  
**Observara: Nedanstående piktogram används i de följande arbetsmomenten.**  
 Læg venligst mærke til følgende symboler, som benyttes i de følgende byggefaser.  
 Пожалуйста, обратите внимание на следующие символы, которые используются в последующих их операциях сборки.  
 Παρακαλώ προσέξτε τα παρακάτω σύμβολα, τα οποία χρησιμοποιούνται στις παρακάτω βαθμίδες συναρμολόγησης.  
**Dbejte prosím na dáte uvedené symboly, které se používají v konstrukčních stupních.**  
 Prosimo za Vašu pozornost na sledeče simbole ki se uporabljajo v naslednjih korakih gradbe.



Kleben  
Glue  
Coller  
Lijmen  
Engomar  
Colar  
Incollare  
Limmas  
Limmaa  
Klæbning  
Lim  
Клеить  
Przykleić  
κόλλημα  
Yapıştırma  
Lepení  
ragasztani  
Lepti



Nicht kleben  
Don't glue  
Ne pas coller  
Niet lijmen  
No engomar  
Não colar  
Non incollare  
Limmas ej  
Älä limmaa  
Må ikke klæbes  
Ikke lim  
Не клеить  
Nie przyklejać  
μη κολλάτε  
Yapıştırılmayın  
Nelepit  
nem szabad ragasztani  
Ne lepti



Wahlweise  
Optional  
Facultatif  
Naar keuze  
No engomar  
Alternado  
Facultativo  
Valfritt  
Valtuohtoisesti  
Efter eget valg  
Ikke lim  
На выбор  
Nie przyklejać  
μη κολλάτε  
Yapıştırılmayın  
Nelepit  
nem szabad ragasztani  
Ne lepti



Anzahl der Arbeitsgänge  
Number of working steps  
Nombre d'étapes de travail  
Het aantal bouwstappen  
Número de operaciones de trabajo  
Número de etapas de trabalho  
Numero di passaggi  
Antal arbetsmoment  
Työvaiheiden lukumäärä  
Antal arbeidsforløb  
Antal arbeidstrinn  
Antal arbeidstrinn  
Κοличество операцій  
Liczba operacji  
αριθμός των εργασιών  
Ís safhalarinn sayvis  
Počet pracovnich operaci  
A munkafolyamatok száma  
Številka koraka montaže



Abziehbild in Wasser einweichen und anbringen  
Soak and apply decals  
Mouiller et appliquer les décalcomanies  
Transfer in water even laten weken en aanbrengen  
Remojar y aplicar las calcomanías  
Pór de molho em água e aplicar o decalque  
Immergere in acqua ed applicare decalcomanie  
Blöt och fäst dekalerna  
Kostuta siirtokuvaa vedessä ja aseta paikalleen  
Overførselsbilledet lægges i blød og anbringes  
Dypp bildet i vann og sett det på  
Переводную картинку намочить и нанести  
Zmieknąć kalkomanie w wodzie a następnie nakleić  
βουτήξτε τη χαλκομανία στο νερό και τοποθετήστε την  
Çıkarılmayı suya yumuşatın ve koyun  
Obtisk namočite ve vodě a umístěte  
a matricát vízben beáztatni és felhelyezni  
Preslikač potopiti v vodo in zatem nanašati



Chromteile  
Chrom parts  
Pièces chromées  
Chroom onderdelen  
Cromar las piezas  
Peça cromada  
Parti cromate  
Kromdetaljer  
Kromatut osat  
Krom-dele  
Kromdeler  
Хромированные детали  
Elementy chromowane  
εξαρτήματα χρωμίου  
Krom parçalar  
Chrómové diely  
króm alkatrészek  
Kromirani deli



Bauteile trocken lassen  
Allow the parts to dry  
Laisser sécher les pièces  
Dejar secar las piezas  
Deixar secar os componentes  
la delene tørke  
Onderdelen laten drogen  
Far asciugarsi i componenti  
Anna osien kuivua  
Låt byggdelarna torka  
Lad komponenterne tørre  
Czesci pozostawic do wyschniecia  
Yapı parçalarını kurumaya bırakınız  
Jednotlivé díly nechte zaschnout  
Αφίστε τα μέρη να στεγνώσουν  
Alkatrészeket hagyja száradni  
Pustite da sestavni deli posušijo  
Дать деталям высохнуть



Klarsichtteile  
Clear parts  
Pièces transparentes  
Transparente onderdelen  
Limpiar las piezas  
Peça transparente  
Parte transparente  
Genomskinliga detaljer  
Läpinäkyvät osat  
Gjennomsiktige dele  
Прозрачные детали  
Elementy przezroczyste  
διαφανή εξαρτήματα  
Şeffaf parçalar  
Průzračné díly  
áttetsző alkatrészek  
Deli ki se jasno vide



Abbildung zusammengesetzter Teile  
Illustration of assembled parts  
Figure représentant les pièces assemblées  
Afbeelding van samengevoegde onderdelen  
Ilustración de piezas ensambladas  
Figura representando peças encaixadas  
Illustrazione delle parti assemblate  
Bildet visar delarna hopsatta  
Kuva yhteennliitetystä osista  
Illustration af sammensatte dele  
Illustrasjon, sammensatte deler  
Изображение смонтированных деталей  
Fysunek złożonych części  
απεικόνιση των συναρμολογημένων εξαρτημάτων  
Birleştirilen parçaların şekli  
Zobrazení sestavených dílů  
összeállított alkatrészek ábrája  
Slika slopljenega dela



Klebeband  
Adhesive tape  
Dévidoir de ruban adhésif  
Plakband  
Cinta adhesiva  
Fita adesiva  
Nastro adesivo  
Tejp  
Teippi  
Tape  
Tape  
Клейкая лента  
Tašma Klejasa  
κολλητική ταινία  
Yapıştırma bandı  
Lepici páska  
ragasztószalag  
Traka z lepilom



Mit einem Messer abtrennen  
Detach with knife  
Détacher au couteau  
Met een mesje afsnijden  
Separarlo con un cuchillo  
Separar utilizando uma faca  
Staccare col coltello  
Skär loss med kniv  
Irrota veitsellä  
Adskilles med en kniv  
Skjær av med en kniv  
Отделять ножом  
Odciać nożem  
διαχωρίστε με ένα μαχαίρι  
Bir bıçak ile kesin  
Oddělit pomocí nože  
kés segítségével leválasztani  
Oddeliti z nožem

# 1.

Zusammenbau-Reihenfolge  
Sequence of assembly  
Ordre d'assemblage  
Volgorde van montage  
Orden de montaje  
Ordine di montaggio  
Ordem de montagem  
Monteringsrekkefølge  
Kokoomisjärjestys  
Monteringsföljd  
Rækkefølgen af monteringen  
Последовательность монтажа  
Összeszerelési sorrend  
Ακολουθία συναρμολόγησης  
Kurmak-Sıra  
Kolejność montażu  
Vrstni red sestavljanja  
Montáž - postup



Gleichen Vorgang auf der gegenüberliegenden Seite wiederholen  
Repeat same procedure on opposite side  
Opérer de la même façon sur l'autre face  
Dezelfde handeling herhalen aan de tegenoverliggende kant  
Realizar el mismo procedimiento en el lado opuesto  
Repertir o mesmo procedimento utilizado no lado oposto  
Stessa procedura sul lato opposto  
Upprepa proceduren på motsatta sidan  
Toista sama toimenpide kuten vieraissellä sivulla  
Det samme arbejde gentages på den modsattiliggende side  
Gjenta prosedyren på siden tværs overfor  
Повторять такую же операцию на противоположной стороне  
Taki sam przebieg czynności powtórzyc na stronie przeciwnej  
επαναλάβετε την ίδια διαδικασία στην απέναντι πλευρά  
Aynı işlemi karşı tarafta tekrarlayın  
Stejný postup zopakovat na protilehlé straně  
ugyantoz a folyamatot a szemben található oldalon megismételni  
Isti postopek ponoviti in na suprotni strani



Zur Anbringung der Abziehbilder empfohlen  
Recommended for affixing the decals  
Recommandé pour l'application des décalcomanies  
Aanbevelen voor het aanbrengen van de transfers  
Recomendado para fijar las calcas  
Posição recomendada para aplicar os decalques  
Raccomandato per applicare le decalcomanie  
Rekommenderas för montering av dekaler  
Anbefales til påsætning og placering af decals  
Рекомендується використовувати для фіксації переводних картинок на поверхності моделі  
Zalecane do nanoszenia kalkomanii  
Zalecany jest ten sposób naklejenia naklejek.  
Dekallerin yapıştırılmasında kullanılması tavsiye edilir  
Připravte na zipsání přilnavosti obtisků  
Ματρία лёгит  
Priporočljivo za prilepljevanje nalepk  
Oporučené na zlepenie prínavostí nálepiek  
RECOMANDAT PENTRU APLICAREA ACTIVILURILOR  
Подходящ за фиксация на картинки върху повърхността на моделта



Zur Anbringung der Klarteile empfohlen  
Recommended to fix clear parts  
Recommandé pour fixer les pièces transparentes  
Aanbevelen voor het aanbrengen van transparante delen  
Recomendado para fijar piezas transparentes  
Consigliato per fissare pezzi trasparenti  
Recomendado para colar peças transparentes.  
Rekommenderas för fastsättning av transparenta delar  
Suositellaan läpinäkyvien osien kiinnittämiseen  
Anbefales til fastgørelse af gennemsigtige dele  
Συνιστάται για την τοποθέτηση χρωματισμένων στοιχείων  
Anbefales til å feste kromdeler  
Recomendado para colar peças cromadas  
Suositellaan kromiosien kiinnittämiseen  
Rekommenderas för fästning av kromfärgade delarna  
Zalecany do mocowania przezroczystych elementów  
Krom parçaların birleştirilme tavsiye edilir  
Doporučeno pro připevnění průzračných částí  
Általános alkatrészek felerősítéséhez ajánlott  
Priporočeno za namestitve prozornih delov  
Doporučuje se pre montáž priesvitných prvkov  
Recomandat pentru fixarea pieselor transparente  
Препорачува се за закрепяване на прозрачни части



Zur Anbringung der Chromteile empfohlen  
Recommended to fix chrome parts  
Recommandé pour fixer les pièces chromées  
Aanbevelen voor het aanbrengen van verchroomde delen  
Recomendado para fijar piezas de cromo  
Consigliato per fissare pezzi cromati  
Rekommenderas för fastsättning av kromfärgade delarna  
Anbefales til fastgørelse af kromdele  
Συνιστάται για την τοποθέτηση χρωματισμένων στοιχείων  
Anbefales til å feste kromdeler  
Recomendado para colar peças cromadas  
Suositellaan kromiosien kiinnittämiseen  
Rekommenderas för fästning av kromfärgade delarna  
Zalecany do mocowania chromowych elementów  
Krom parçaların birleştirilme tavsiye edilir  
Doporučeno pro připevnění chromových částí  
Krom alkatrészek felerősítéséhez ajánlott  
Priporočeno za namestitve delov iz kroma  
Doporučuje se pre montáž chromových prvkov  
Recomandat pentru fixarea pieselor cromate.  
Препорачува се за закрепяване на хромирани части



Nicht enthalten  
Not included  
Non fourni

Behoort niet tot de levering  
No included  
Non compresi

Não incluído  
Ikke medsendt  
Ingår ej

Ikke inkluderet  
Eivät sisällyä  
Δεν συμπεριλαμβάνεται

Ne содержится  
Nem tartalmazza  
Nie zawiera

Ni vsebovano  
Igerisinde bulunmamaktadır  
Není obsaženo

### D: Beiliegenden Sicherheitstext beachten und nachschlagebereit halten.

GB: Please note the enclosed safety advice and keep safe for later reference.

### F: Respecter les consignes de sécurité ci-jointes et les conserver à portée de main.

NL: Houdt u aan de bijgaande veiligheidsinstructies en hou deze steeds bij de hand.

### E: Observar y siempre tener a disposición este texto de seguridad adjunto.

I. Seguire le avvertenze di sicurezza allegate e tenerle a portata di mano.

### P: Ter em atenção o texto de segurança anexo e guard-!lo para consulta.

S: Beakta bifogad säkerhetstext och håll den i beredskap.

### FIN: Huomioi ja säilytä ohjeist tekstit.

DK: Overhold vedlagte sikkerhedsanvisninger og hav dem liggende i nærheden.

### N: Ha alltid vedlagt sikkerhetstekt klar til bruk.

RUS: Соблюдать прилагаемый текст по технике безопасности, хранить его в легко доступном месте.

PL: Stosować się do załączonej karty bezpieczeństwa i mieć ją stale do wglądu.  
GR: ροσ έτε τις συνμμ νες υποδείξεις ασ άλειας και υάξετε τις ωςτε να τις χτε πάντα σε διαθέ ση σας.

TR: Ekteki güvenli talimatlarını dikkate alıp, bakabileceğiniz bir şekilde muafaza ediniz.

CZ: Dbejte na příložen bezpečnostní text a mŕjte jej pfiipraven na dosah.

H: A mellékelt biztonsi g szöveget vegye figyelembe és tartsa fellapoz-sra készen!  
SLO: Prilofena varnostna navodila izvajte in jih hranite na vsem dostopnem mestu.

## Benötigte Farben/Used Colors

Benötigte Farben Peintures nécessaires Pinturas necesarias Colori necessari Tarvittavat värit Nødvendige farger Potrzebne kolory Gerekkil renkler Szükséges színek  
 Required colours Benodigde kleuren Tintas necessárias Använda färger Du trenger følgende farger Необходимые краски Απαιτούμενα χρώματα Potrebne barvy

**A**

aluminium, metallic 99  
 aluminium, metallic  
 aluminium, métallique  
 aluminium, metallic  
 aluminio, metalizado  
 alumínio, metálico  
 alluminio, metallico  
 aluminium, metallic  
 alumiini, metallikiitto  
 aluminium, metallak  
 aluminium, metallic  
 алюминий, металл  
 aluminium, metallicny  
 αλουμινίου, μεταλλικό  
 aluminium, metalik  
 hliníková, metaliza  
 aluminium, metall  
 aluminium, metalik

**B**

schwarz, seidenmatt 302  
 black, silky-matt  
 noir, satiné mat  
 zwart, zijdemat  
 negro, mate seda  
 preto, fosco sedoso  
 nero, opaco seta  
 svart, sidenmatt  
 musta, silkinhimmeä  
 sort, silkemat  
 sort, silkematt  
 черный, шелковисто-матовый  
 czarny, jedwabisto-matowy  
 μαύρο, μεταξωτό ματ  
 siyah, ipek mat  
 černá, hedvábně matná  
 fekete, selyemmatt  
 črna, svila mat

**C**

silber, metallic 90  
 silver, metallic  
 argent, métallique  
 zilver, metallic  
 plata, metalizado  
 prata, metálico  
 argento, metallico  
 silver, metallic  
 hopea, metallikiitto  
 sølv, metallak  
 sølv, metallic  
 серебряный, металл  
 srebro, metaliczny  
 ασήμι, μεταλλικό  
 gümüş, metalik  
 stříbrná, metaliza  
 ezüst, metall  
 srebrna, metalik

**D**

anthrazit, matt 9  
 anthracite grey, matt  
 anthracite, mat  
 antraciet, mat  
 antracita, mate  
 antracite, fosco  
 antracite, opaco  
 antracit, matt  
 antrasiitti, himmeä  
 koksgrå, mat  
 antrasitt, matt  
 антрацит, матовый  
 antracyt, matowy  
 ανθρακί, ματ  
 antrasit, mat  
 antracit, matná  
 antracit, matt  
 tamno siva, mat

**E**

eisen, metallic 91  
 steel, metallic  
 coloris fer, métallique  
 ijzerkleurig, metallic  
 ferroso, metalizado  
 ferro, metálico  
 ferro, metallico  
 järntåg, metallic  
 teräksenvärinen, metallikiitto  
 jern, metallak  
 jern, metallic  
 стальной, металл  
 antracyt, metaliczny  
 σιδήρου, μεταλλικό  
 demir, metalik  
 železná, metaliza  
 vas, metall  
 železna, metalik

**F**

schwarz, glänzend 7  
 black, gloss  
 noir, brillant  
 zwart, glansend  
 negro, brillante  
 preto, brilhante  
 nero, lucente  
 svart, blank  
 musta, kiiltävä  
 sort, skinnende  
 sort, blank  
 черный, блестящий  
 czarny, blyszczący  
 μαύρο, γυαλιστερό  
 siyah, parlak  
 černá, lesklá  
 fekete, fényes  
 črna, bleskajoča

**G**

dunkelgrau, seidenmatt 378  
 dark grey, silky-matt  
 gris foncé, satiné mat  
 donkergrijs, zijdemat  
 gris oscuro, mate seda  
 cinzento escuro, fosco sedoso  
 grigio scuro, opaco seta  
 mörkgrå, sidenmatt  
 harmaa, silkinhimmeä  
 mørkegrå, silkemat  
 mørkegrå, silkematt  
 серый, шелковисто-матовый  
 szary, jedwabisto-matowy  
 γκρι, μεταξωτό ματ  
 gri, ipek mat  
 šedá, hedvábně matná  
 szürke, selyemmatt  
 siva, svila mat

**H**

leuchtgelb, seidenmatt 312  
 Luminous yellow, silky-matt  
 jaune voyant, satiné mat  
 neongeel, zijdemat  
 amarillo brillante, mate seda  
 amarelo brilhante, fosco sedoso  
 giallo, opaco seta  
 gul, sidenmatt  
 keltainen, silkinhimmeä  
 gul, silkemat  
 gul, silkematt  
 желтый, шелк-матовый  
 żółty, jedwabisto-matowy  
 κίτρινο, μεταξωτό ματ  
 sari, ipek mat  
 žlutá, hedvábně matná  
 sárga, selyemmatt  
 rumena, svila mat

**50%**

silber, metallic 90  
 silver, metallic  
 argent, métallique  
 zilver, metallic  
 plata, metalizado  
 prata, metálico  
 argento, metallico  
 silver, metallic  
 hopea, metallikiitto  
 sølv, metallak  
 sølv, metallic  
 серебряный, металл  
 srebro, metaliczny  
 ασήμι, μεταλλικό  
 gümüş, metalik  
 stříbrná, metaliza  
 ezüst, metall  
 srebrna, metalik

**I****50%**

+ gold, metallic 94  
 gold, metallic  
 or, métallique  
 goud, metallic  
 oro, metalizado  
 ouro, metálico  
 oro, metallico  
 guld, metallic  
 kulta, metallikiitto  
 guld, metallak  
 guld, metallic  
 золотой, металл  
 złoto, metaliczny  
 χρυσάφι, μεταλλικό  
 altın, metalik  
 zlatá, metaliza  
 arany, metall  
 zlatna, metalik

**50%**

leuchtgelb, seidenmatt 312  
 Luminous yellow, silky-matt  
 jaune voyant, satiné mat  
 neongeel, zijdemat  
 amarillo brillante, mate seda  
 amarelo brilhante, fosco sedoso  
 giallo, opaco seta  
 gul, sidenmatt  
 keltainen, silkinhimmeä  
 gul, silkemat  
 gul, silkematt  
 желтый, шелк-матовый  
 żółty, jedwabisto-matowy  
 κίτρινο, μεταξωτό ματ  
 sari, ipek mat  
 žlutá, hedvábně matná  
 sárga, selyemmatt  
 rumena, svila mat

**J****50%**

+ beige, seidenmatt 314  
 beige, silky-matt  
 beige, satiné mat  
 beige, zijdemat  
 beige, mate seda  
 bege, fosco sedoso  
 beige, opaco seta  
 beige, sidenmatt  
 beige, silkinhimmeä  
 beige, silkemat  
 beige, silkematt  
 бежевый, шелковисто-матовый  
 beżowy, jedwabisto-matowy  
 μεζ, μεταξωτό ματ  
 bej, ipek mat  
 béžová, hedvábně matná  
 bézs, selyemmatt  
 slonova kost, svila mat

**K**

weiß, glänzend 4  
 white, gloss  
 blanc, brillant  
 wit, glansend  
 blanco, brillante  
 branco, brilhante  
 bianco, lucente  
 vit, blank  
 valkoinen, kiiltävä  
 hvid, skinnende  
 hvit, blank  
 белый, блестящий  
 biały, blyszczący  
 λευκό, γυαλιστερό  
 beyaz, parlak  
 bílá, lesklá  
 fehé, fényes  
 bela, bleskajoča

**50%**

dunkelgrau, seidenmatt 378  
 dark grey, silky-matt  
 gris foncé, satiné mat  
 donkergrijs, zijdemat  
 gris oscuro, mate seda  
 cinzento escuro, fosco sedoso  
 grigio scuro, opaco seta  
 mörkgrå, sidenmatt  
 harmaa, silkinhimmeä  
 mørkegrå, silkemat  
 mørkegrå, silkematt  
 серый, шелковисто-матовый  
 szary, jedwabisto-matowy  
 γκρι, μεταξωτό ματ  
 gri, ipek mat  
 šedá, hedvábně matná  
 szürke, selyemmatt  
 siva, svila mat

**L****50%**

+ schwarz, seidenmatt 302  
 black, silky-matt  
 noir, satiné mat  
 zwart, zijdemat  
 negro, mate seda  
 preto, fosco sedoso  
 nero, opaco seta  
 svart, sidenmatt  
 musta, silkinhimmeä  
 sort, silkemat  
 sort, silkematt  
 черный, шелковисто-матовый  
 czarny, jedwabisto-matowy  
 μαύρο, μεταξωτό ματ  
 siyah, ipek mat  
 černá, hedvábně matná  
 fekete, selyemmatt  
 črna, svila mat

**M**

feuerrot, seidenmatt 330  
 fiery red, silky-matt  
 rouge feu, satiné mat  
 rood helder, zijdemat  
 rojo fuego, mate seda  
 vermelho vivo, fosco sedoso  
 rosso fuoco, opaco seta  
 eldröd, sidenmatt  
 tulipunainen, silkinhimmeä  
 ildröd, silkemat  
 ildröd, silkematt  
 огненно-красный, шелк-матовый  
 czerwony ognisty, jedwabisto-mat.  
 κόκκινο φωτιάς, μεταξωτό ματ  
 ateş kırmızı, ipek mat  
 ohnivě červená, hedvábně matná  
 tűzpiros, selyemmatt  
 ogenj rdeča, svila mat

**50%**

holzbraun, seidenmatt 382  
 wood brown, silky-matt  
 brun bois, satiné mat  
 houtbruin, zijdemat  
 marrón madera, mate seda  
 castanho madeira, fosco sedoso  
 marrone legno, opaco seta  
 träbrun, sidenmatt  
 puunruskea, silkinhimmeä  
 träbrun, silkemat  
 trebrun, silkematt  
 древесно-коричнев., шелк-матовый  
 drewnobrązowy, jedwabisto-matowy  
 καφέ ξύλου, μεταξωτό ματ  
 odun kahverengisi, ipek mat  
 hnědá barvy dřeva, hedvábně mat.  
 fabarna, selyemmatt  
 drevo plava, svila mat

**N****50%**

+ beige, seidenmatt 314  
 beige, silky-matt  
 beige, satiné mat  
 beige, zijdemat  
 beige, mate seda  
 bege, fosco sedoso  
 beige, opaco seta  
 beige, sidenmatt  
 beige, silkinhimmeä  
 beige, silkemat  
 beige, silkematt  
 бежевый, шелковисто-матовый  
 beżowy, jedwabisto-matowy  
 μεζ, μεταξωτό ματ  
 bej, ipek mat  
 béžová, hedvábně matná  
 bézs, selyemmatt  
 slonova kost, svila mat

**O**

braun, seidenmatt 381  
 brown, silky-matt  
 brun, satiné mat  
 bruin, zijdemat  
 marrón, mate seda  
 castanho, fosco sedoso  
 marrone, opaco seta  
 brun, sidenmatt  
 ruskea, silkinhimmeä  
 brun, silkemat  
 brun, silkematt  
 коричневый, шелковисто-матовый  
 brązowy, jedwabisto-matowy  
 καφέ, μεταξωτό ματ  
 kahverengi, ipek mat  
 hnědá, hedvábně matná  
 barna, selyemmatt  
 java, svila mat

**P**

orange, klar 730  
 orange, clear  
 orange, clair  
 oranje, helder  
 naranja, claro  
 laranja, claro  
 arancione, chiaro  
 orange, klar  
 oranssi, kirkas  
 orange  
 orange  
 оранжевый  
 pomarańczowy  
 πορτοκάλι, διαυγές  
 portakal, şeffaf  
 oranžová, čirá  
 narancs, áttetszE  
 pomarandzasta, jasna

**Q**

rot, klar 731  
 red, clear  
 rouge, clair  
 rood, helder  
 rojo, claro  
 vermelho, claro  
 röd, klar  
 punainen, kirkas  
 rød  
 rød  
 красный  
 czerwiał  
 κόκκινο, διαυγές  
 kırmızı, şeffaf  
 červená, čirá  
 piros, áttetszE  
 rdeča, jasna

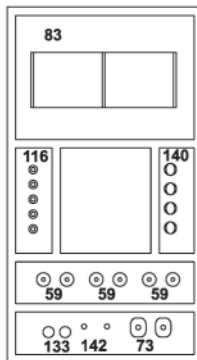
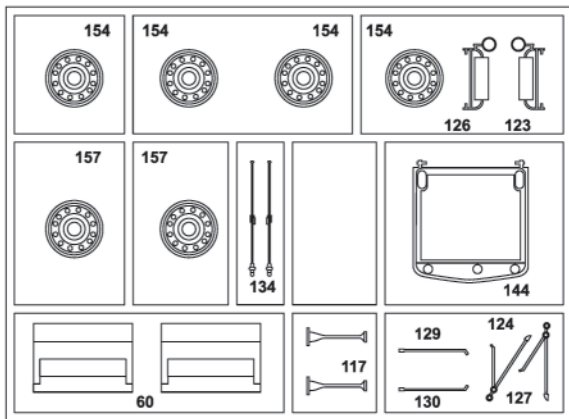
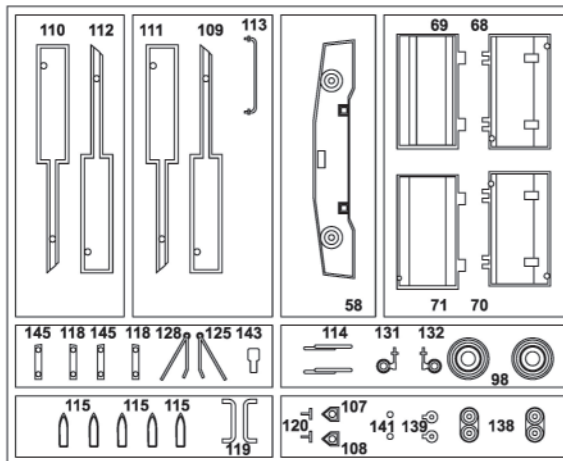
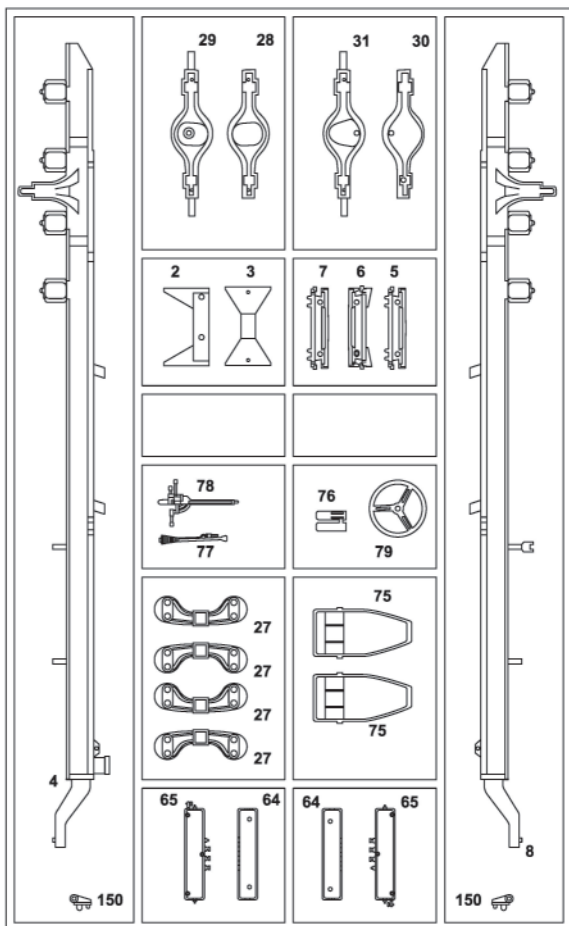

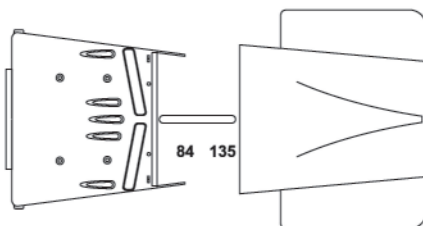
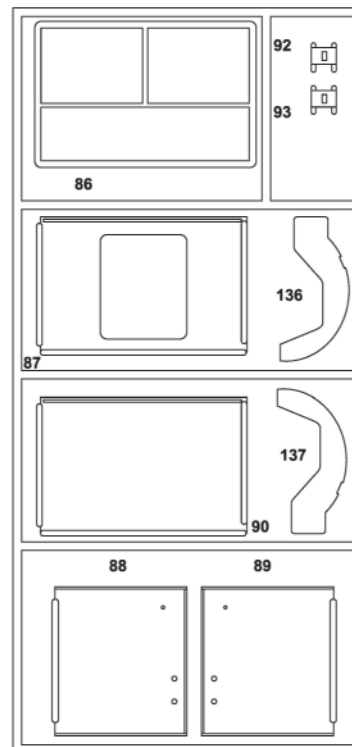
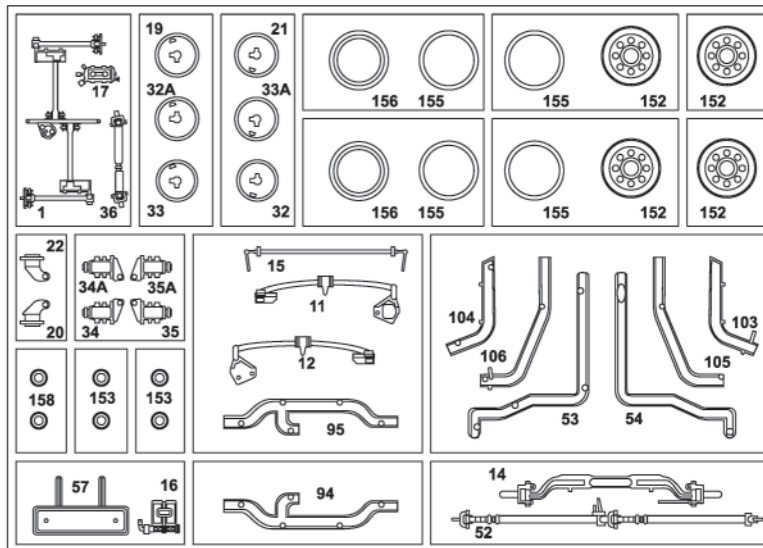
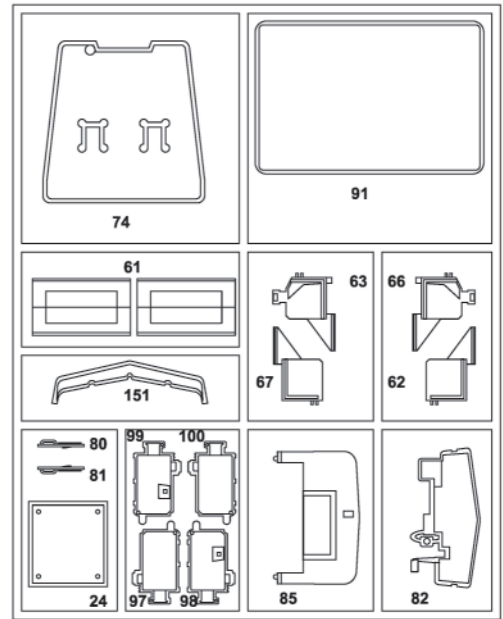
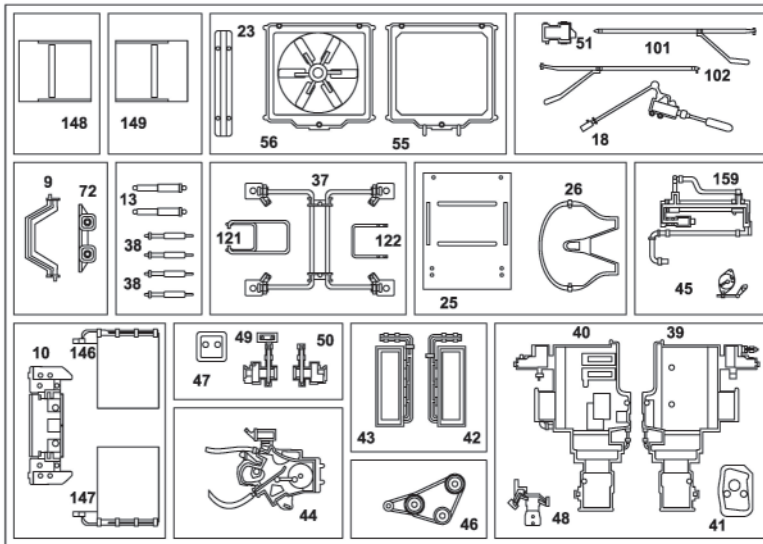

1

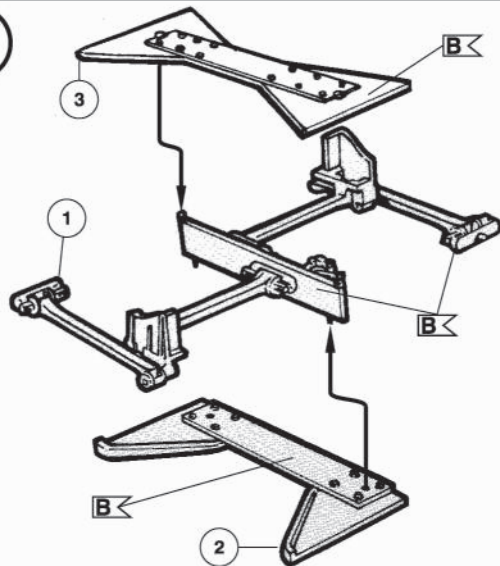

2

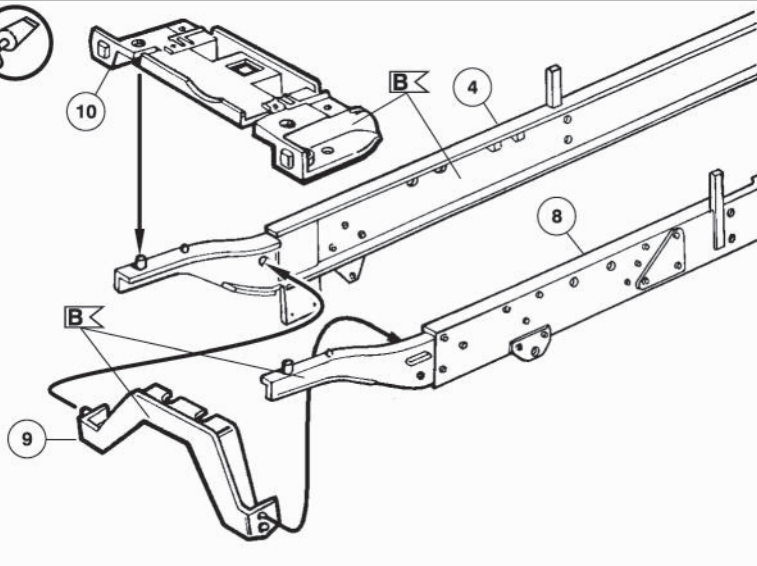

3

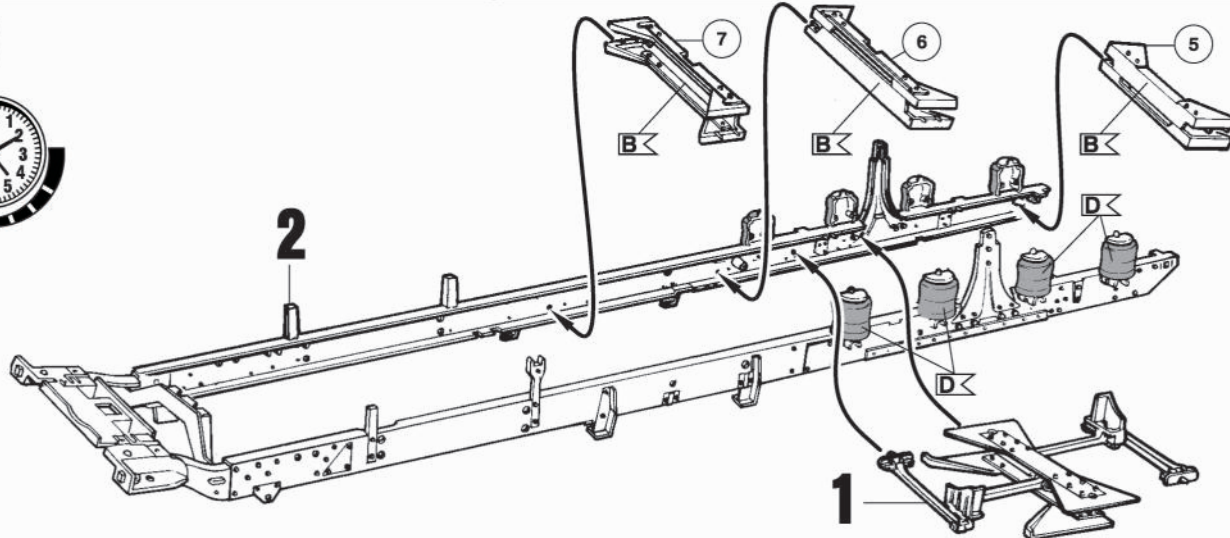

4

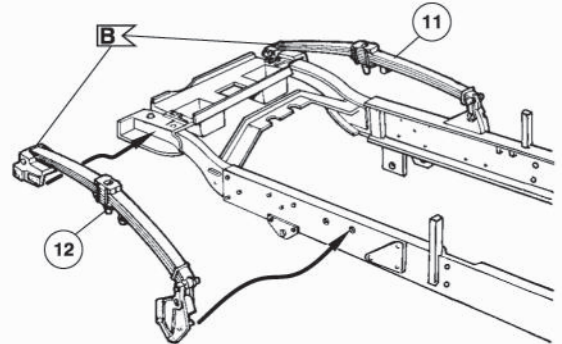

5

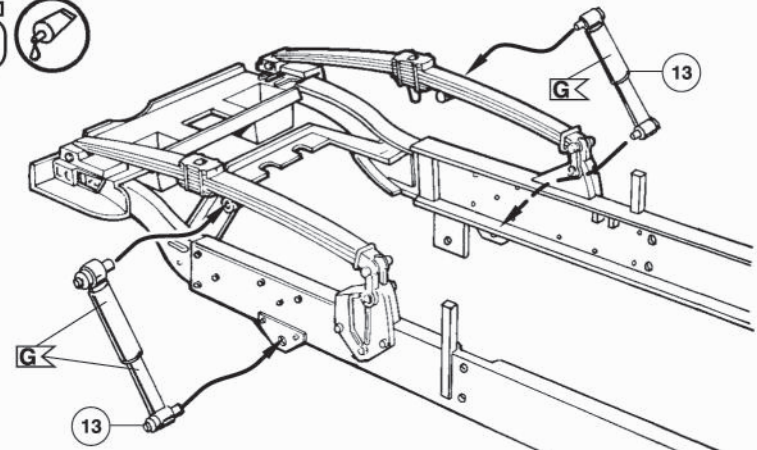

6

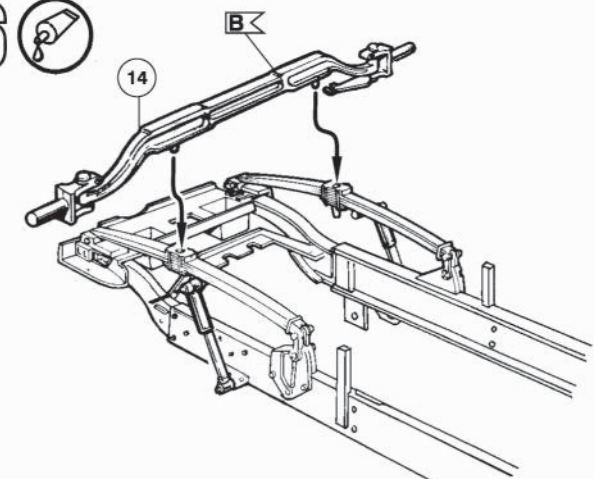

7

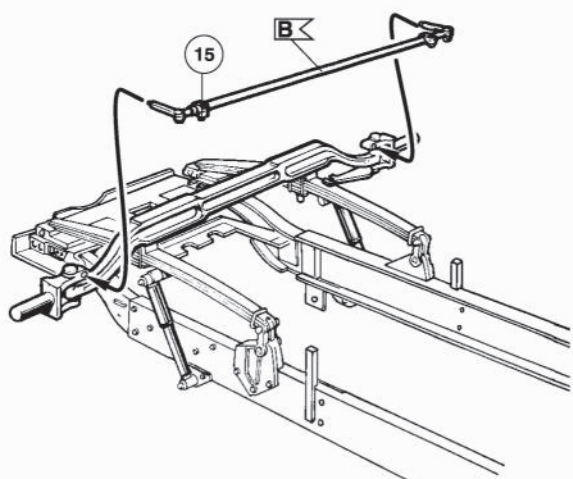

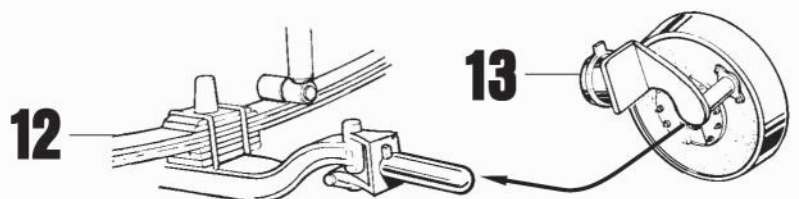
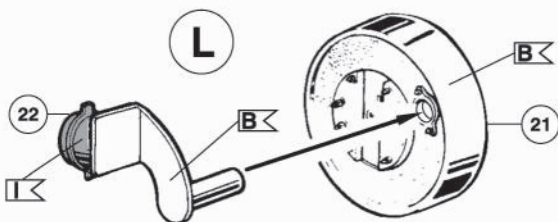
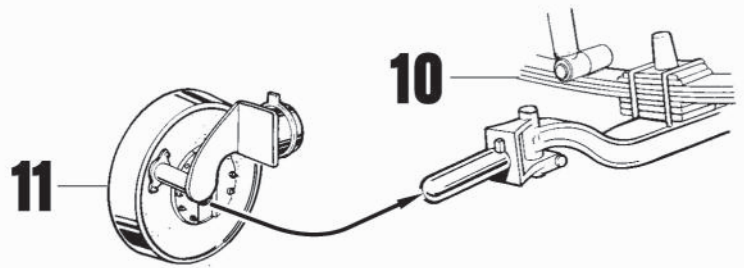
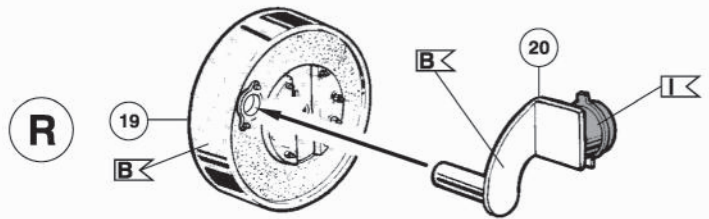
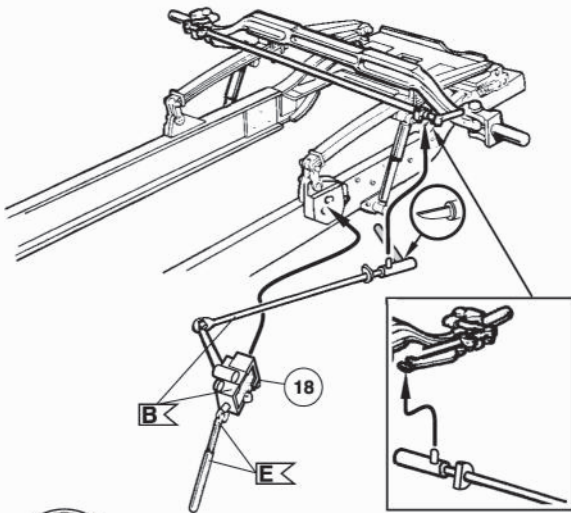
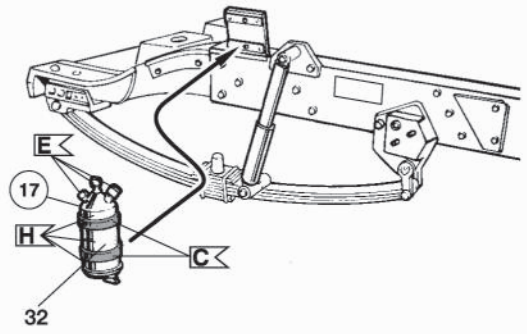
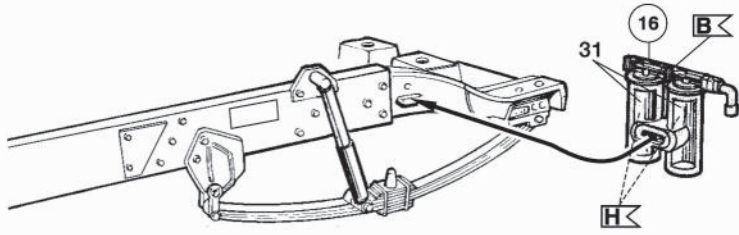



15 

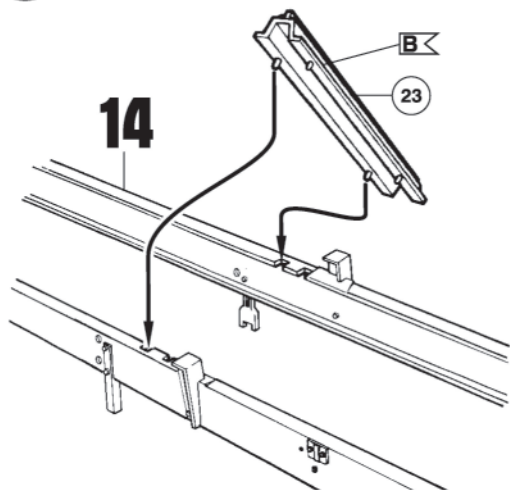

16 

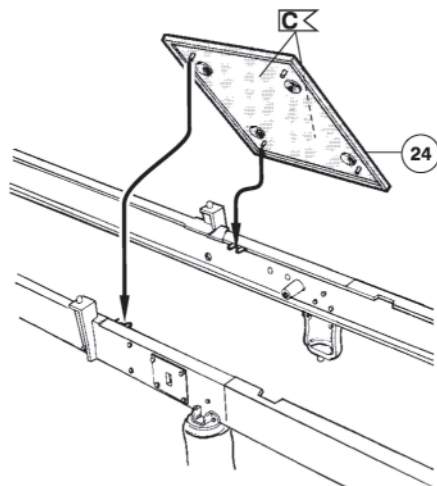

17 

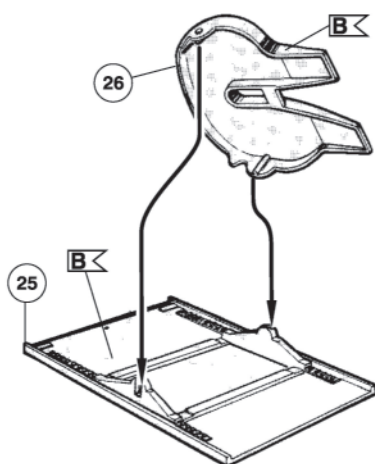

18   

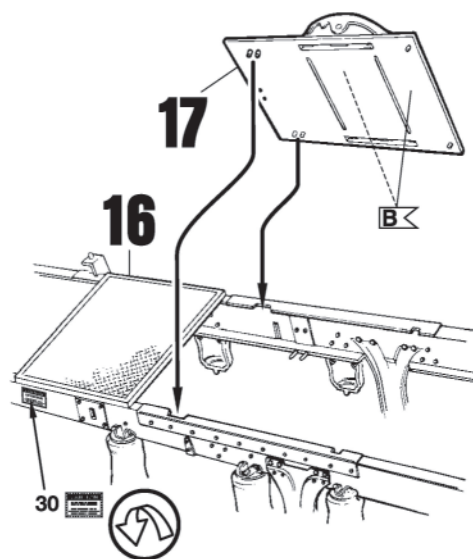

19 

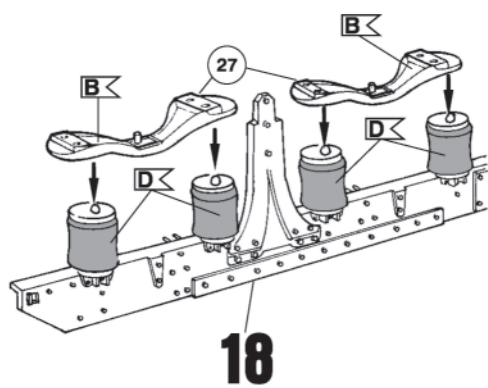

20 

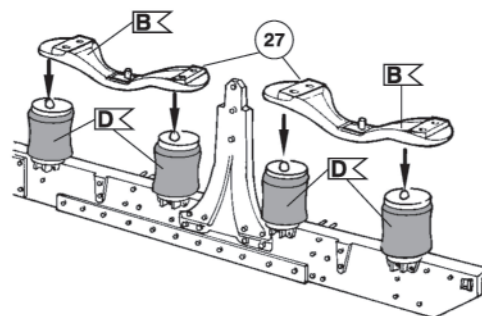

# 21

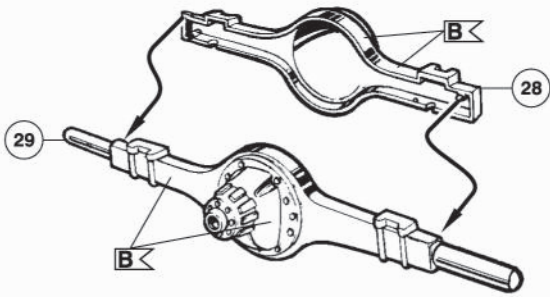

# 22

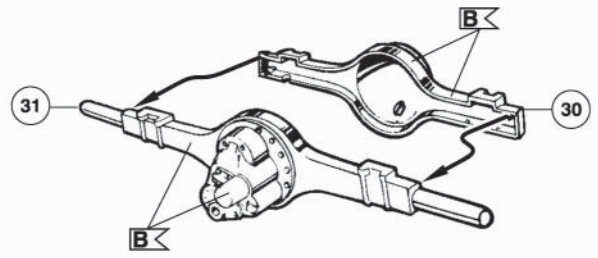

# 23

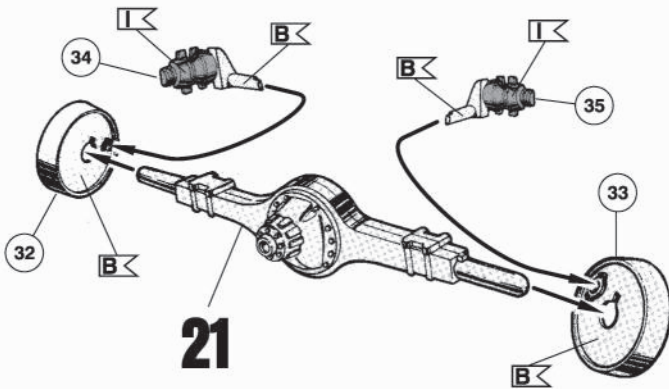

# 24

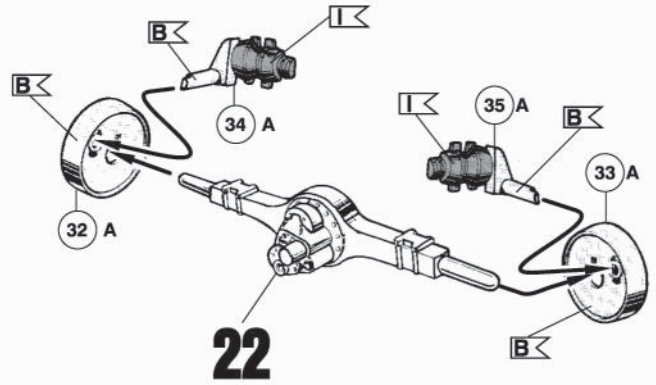

# 25

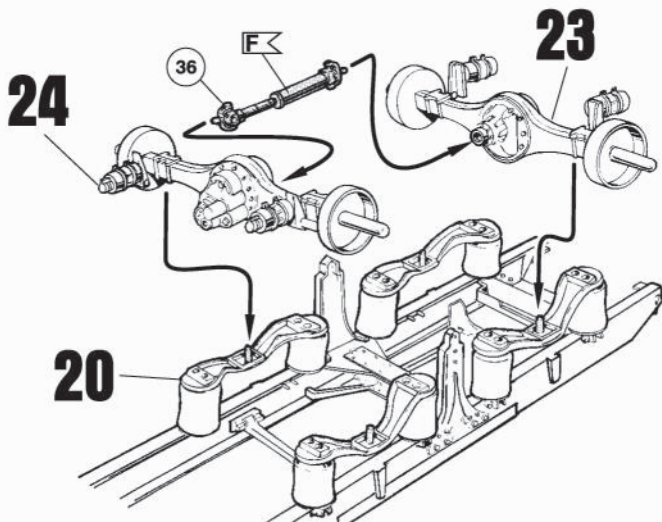

# 26

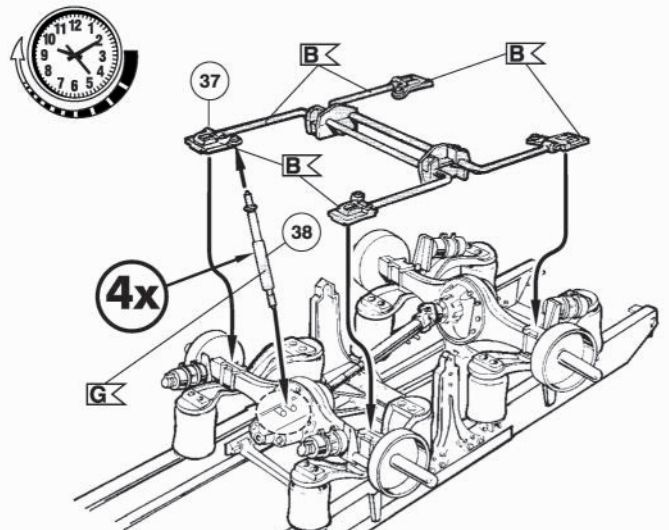

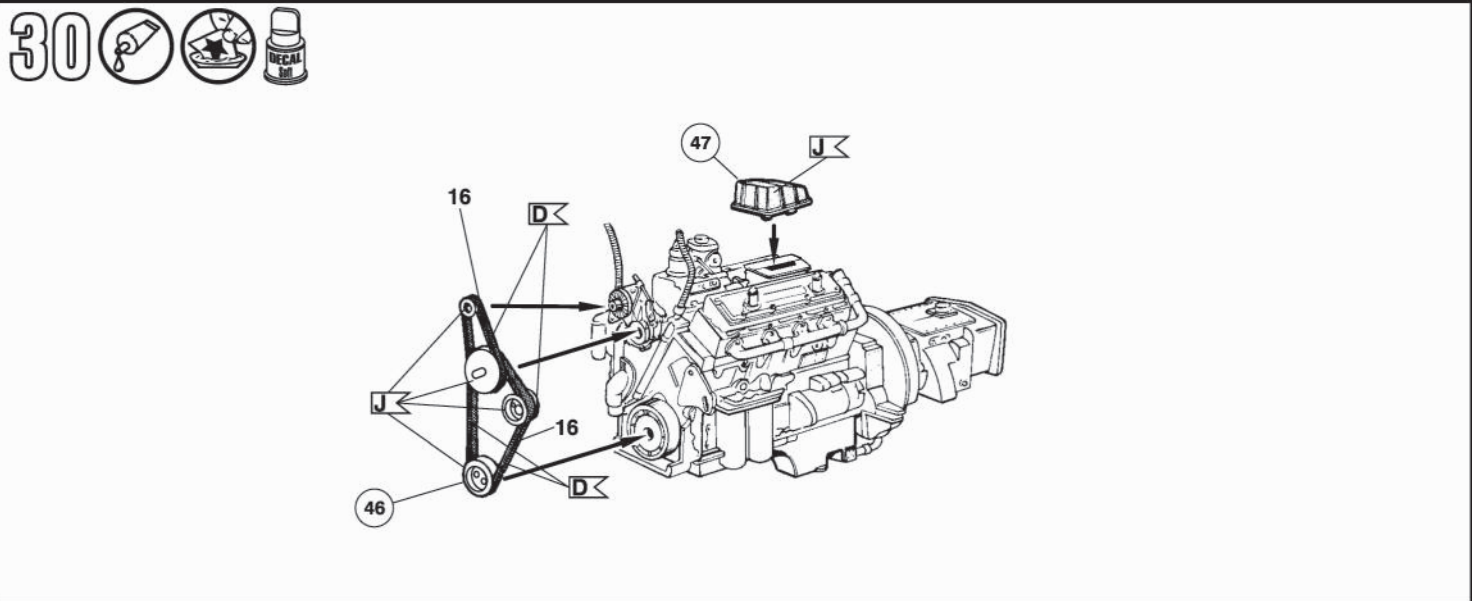
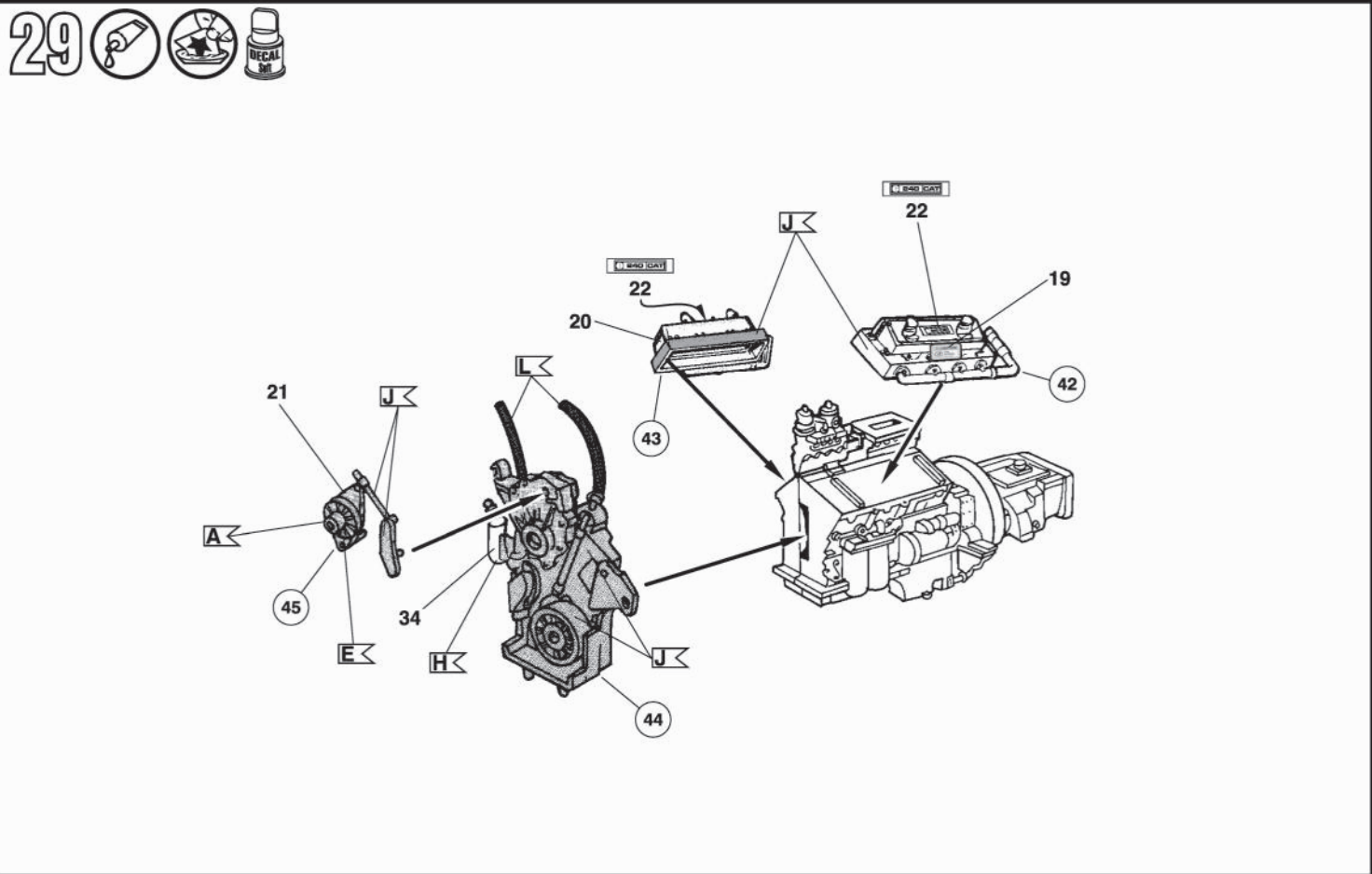
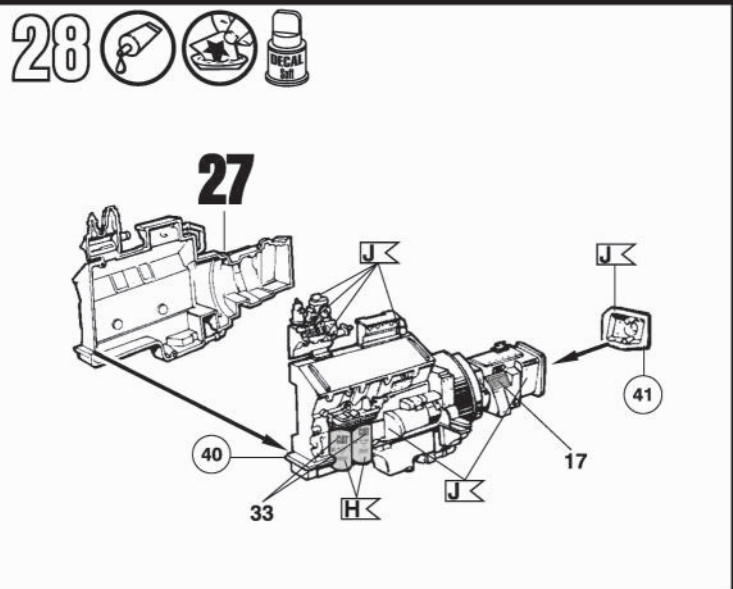
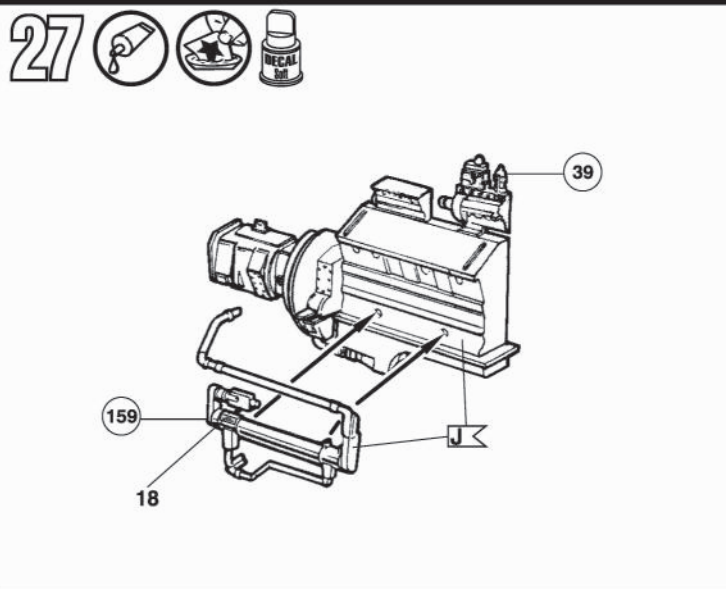

31 

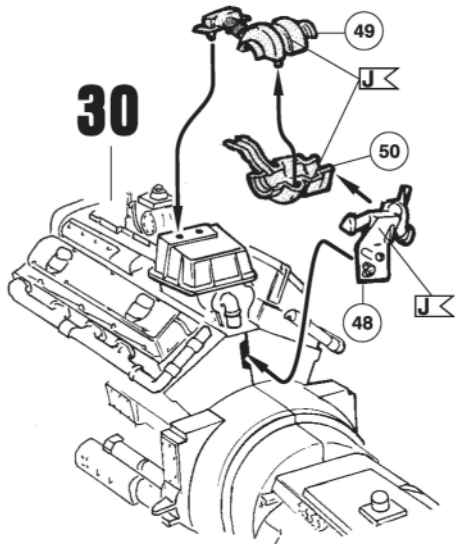

32 

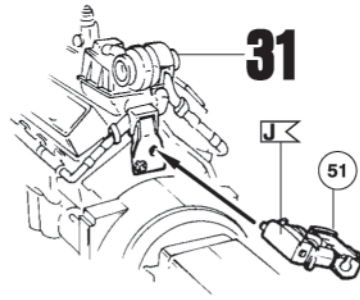

33   

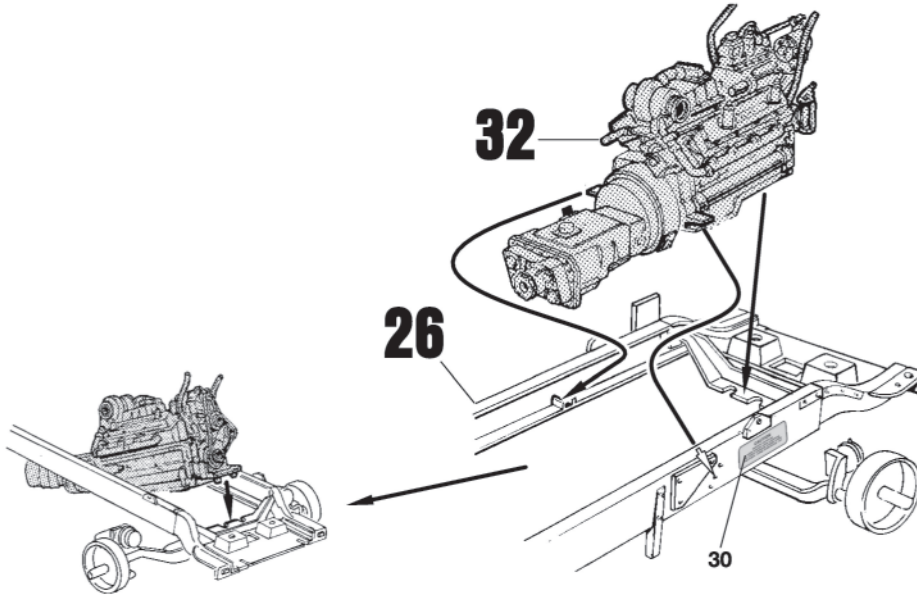

34   

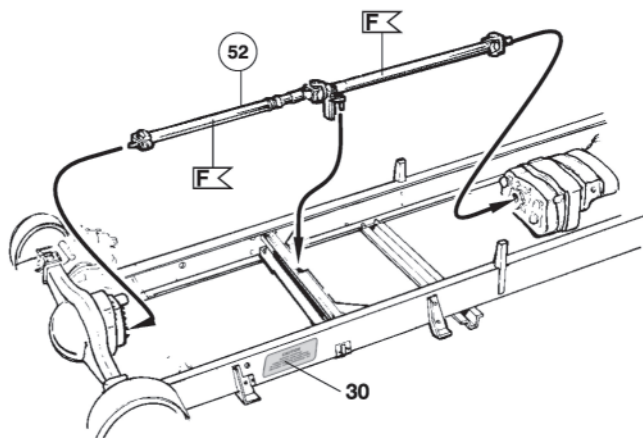

35 

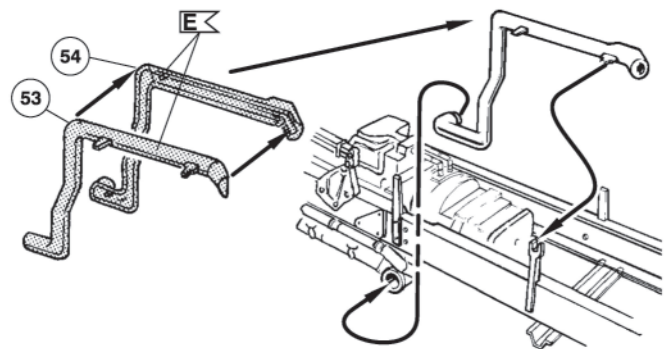

36   

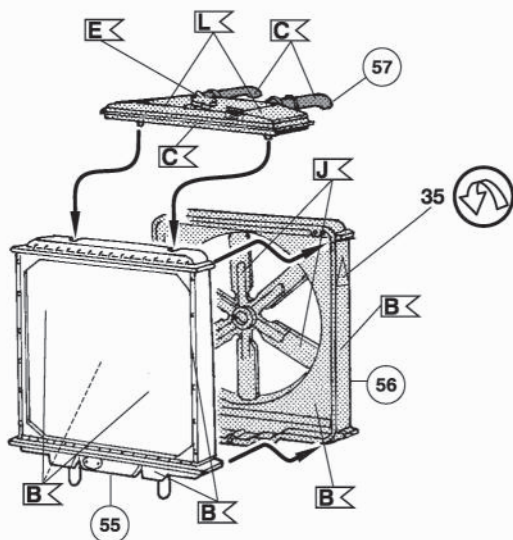

37    

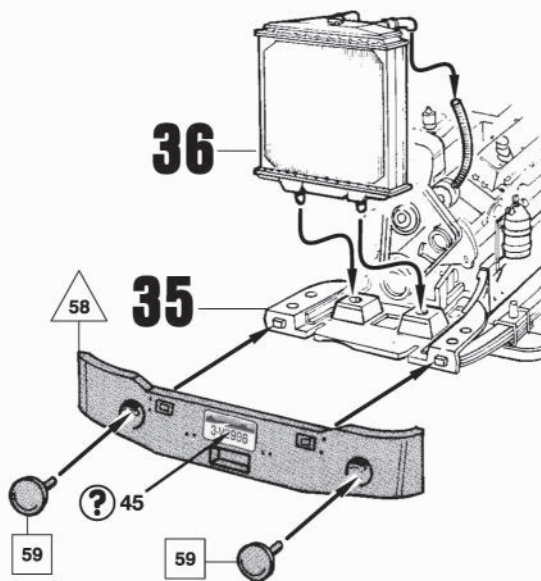

38  

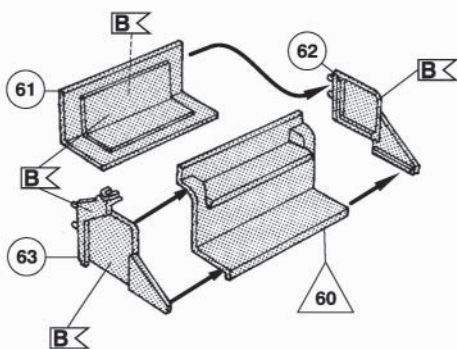

39  

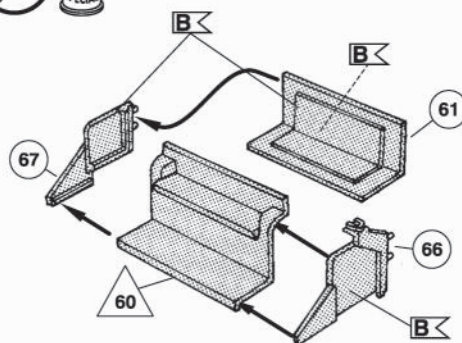

40  

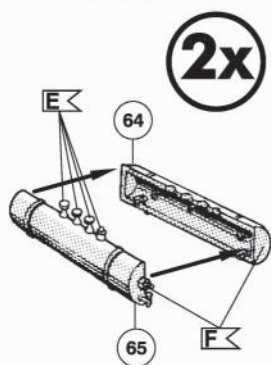

41  

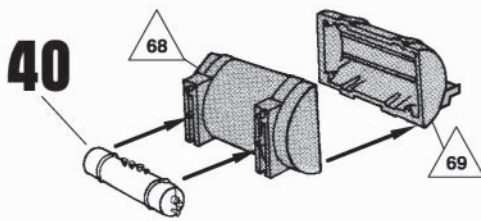

42  

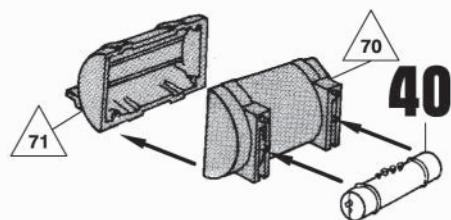

43    

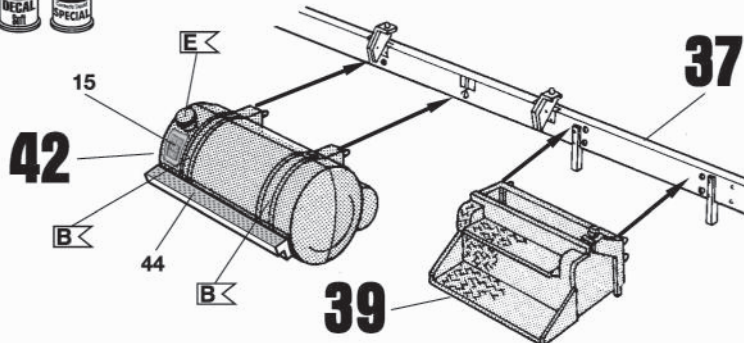



44

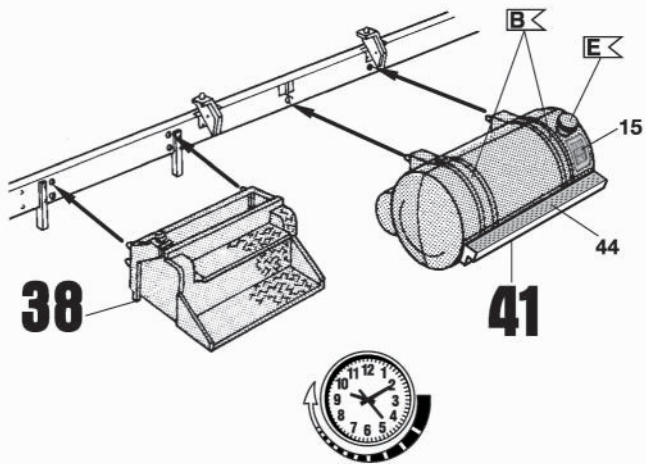

45

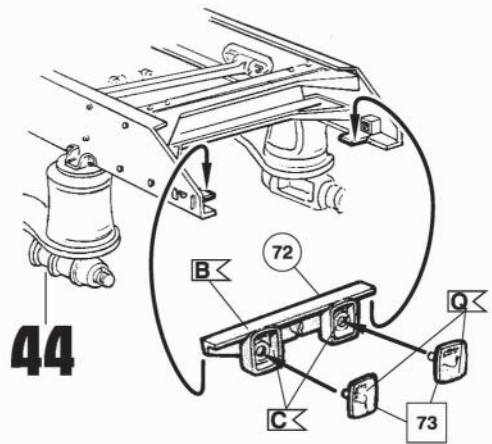

46

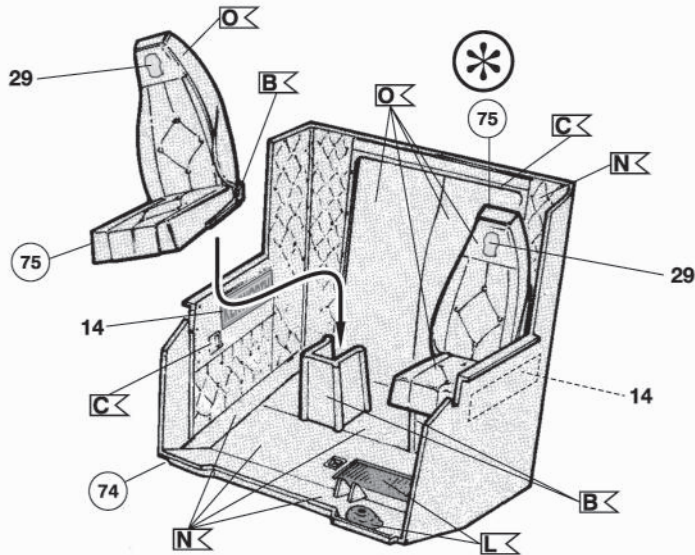

47

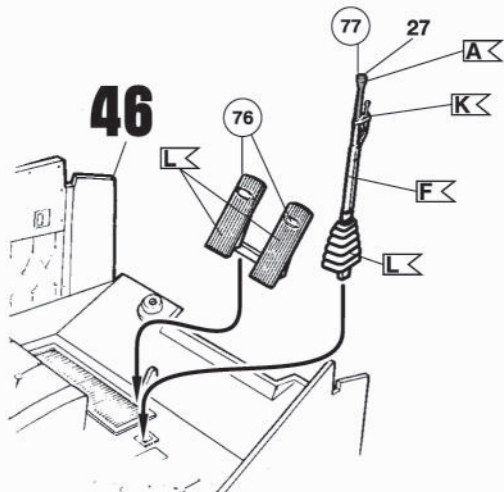

48

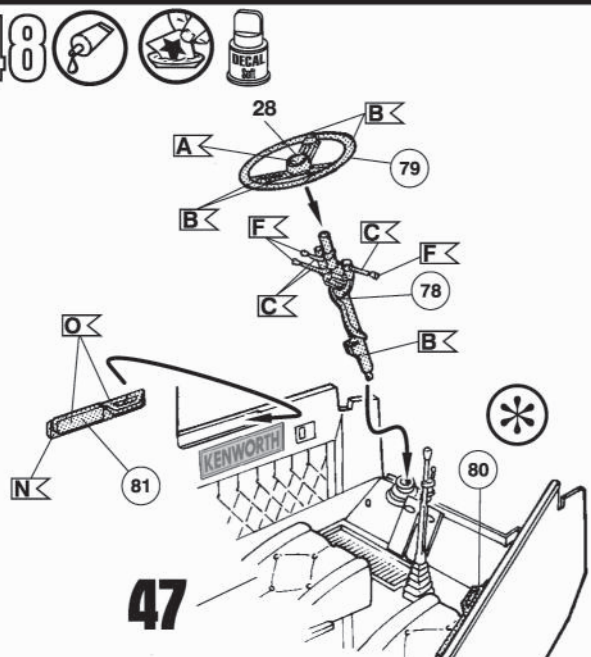

49   

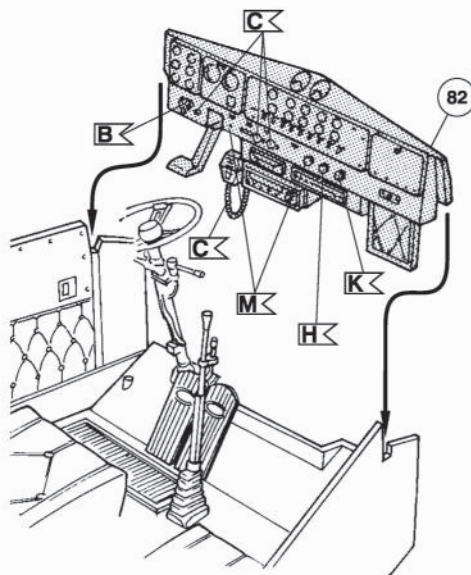
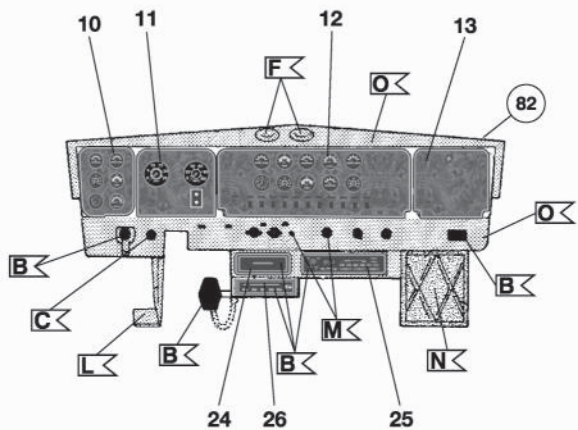

50   

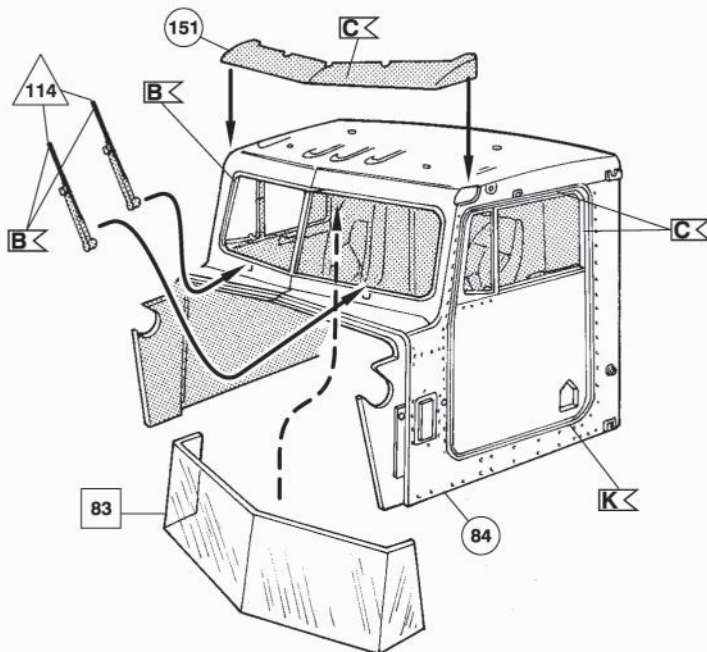

51 

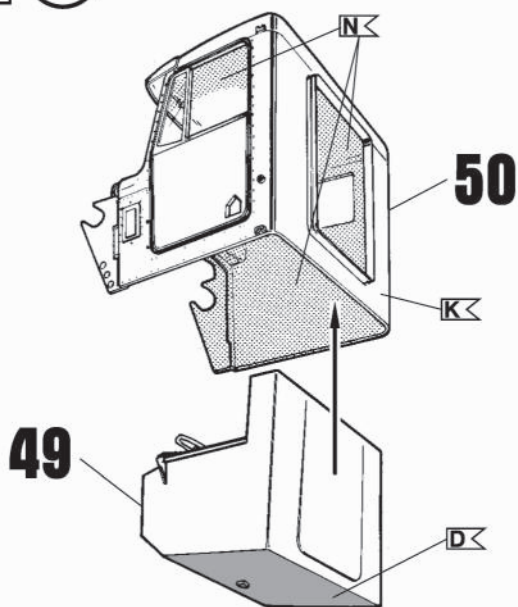

52  

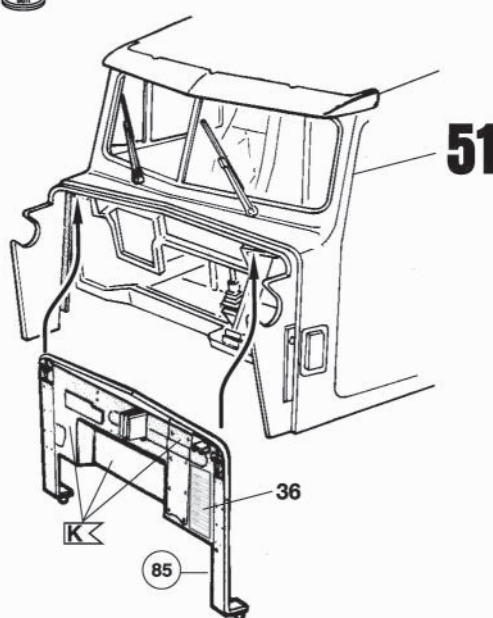

# 53

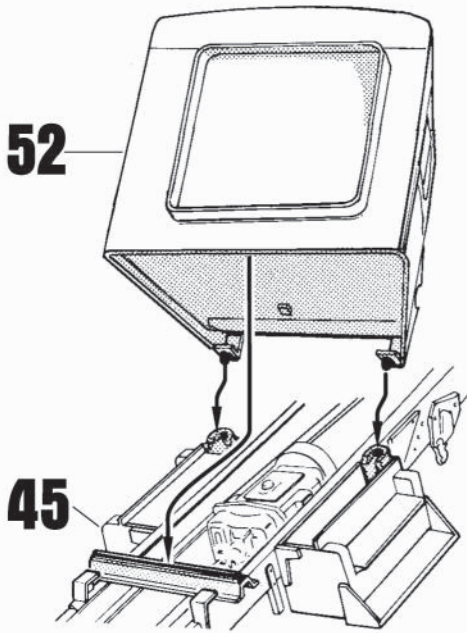

# 54

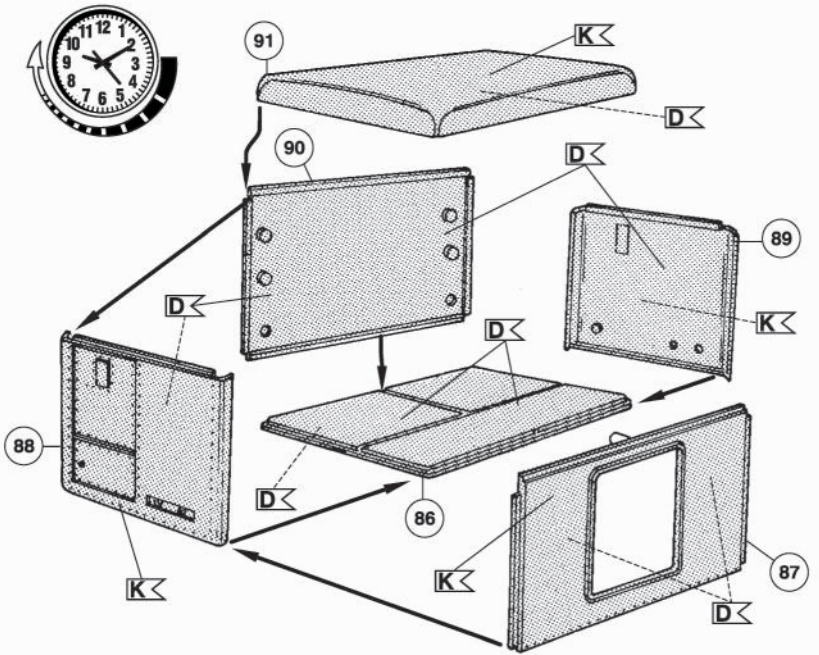

# 55

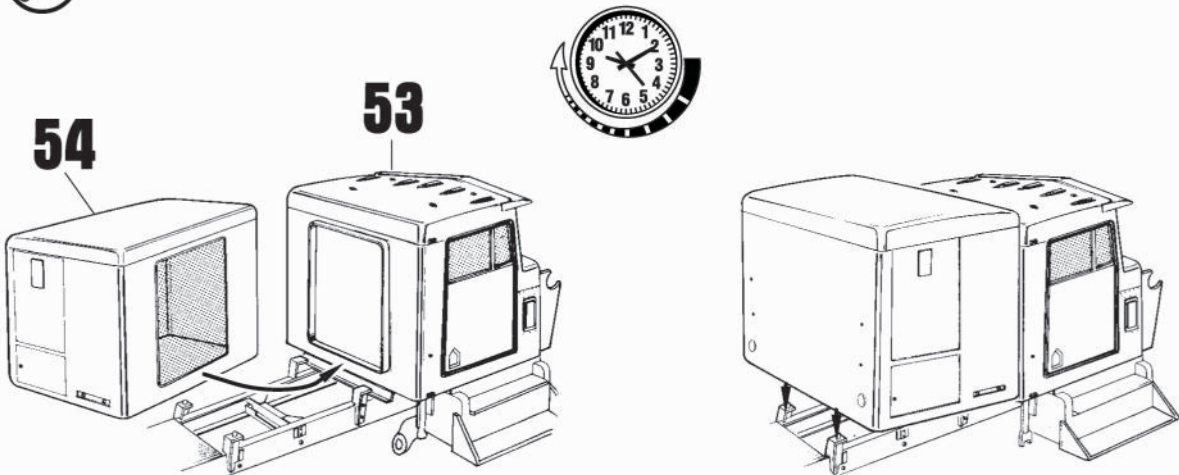

# 56

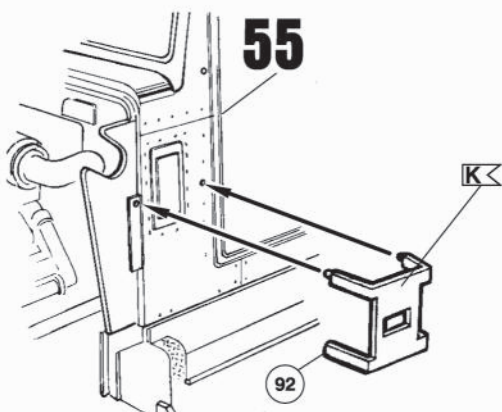

# 57

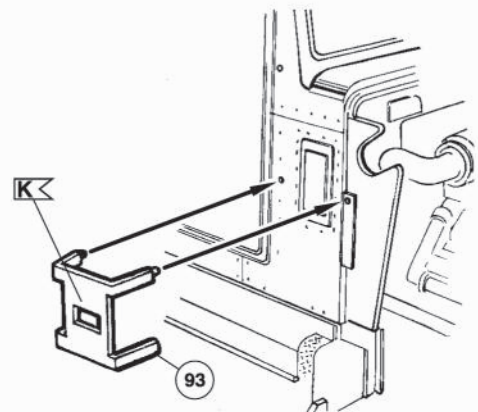



58 

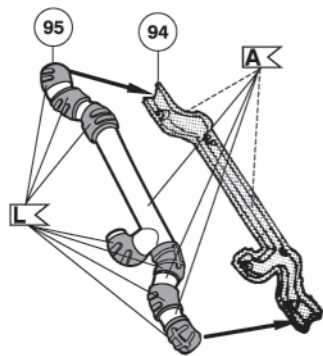

59  

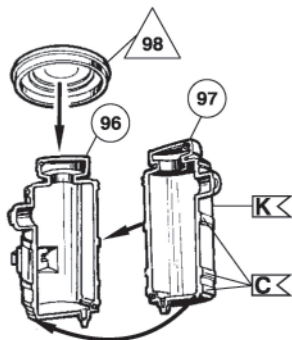

60  

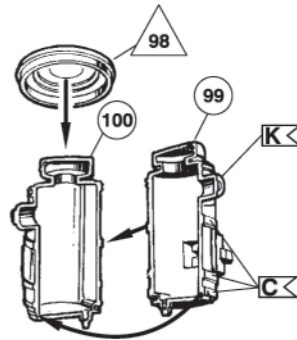

61 

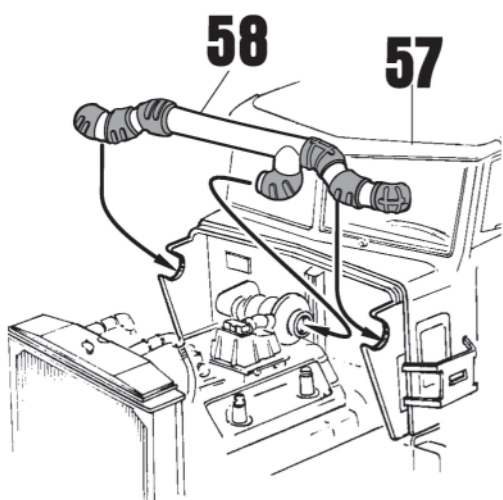

62  

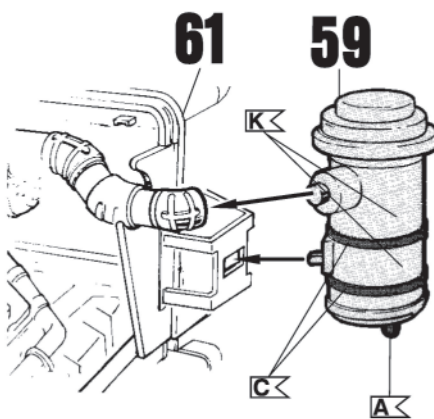

63  

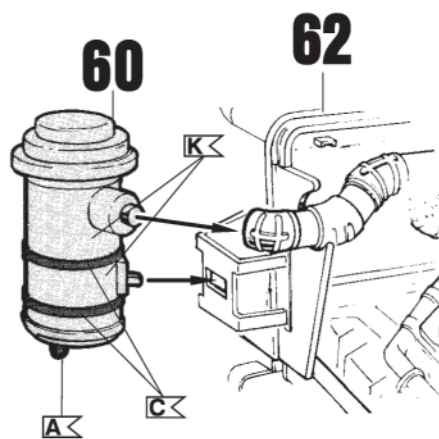

64 

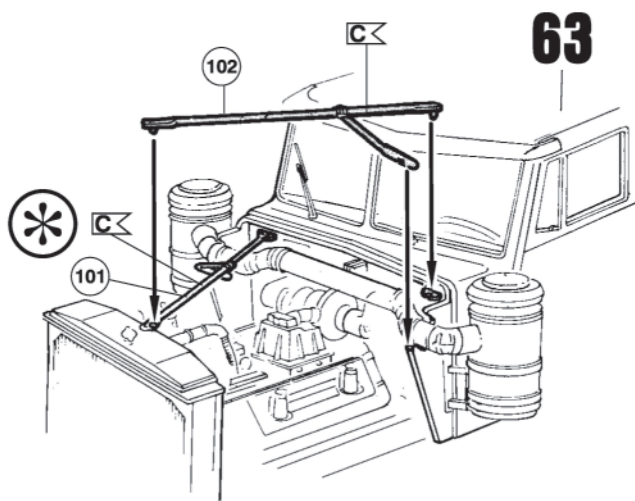

65 

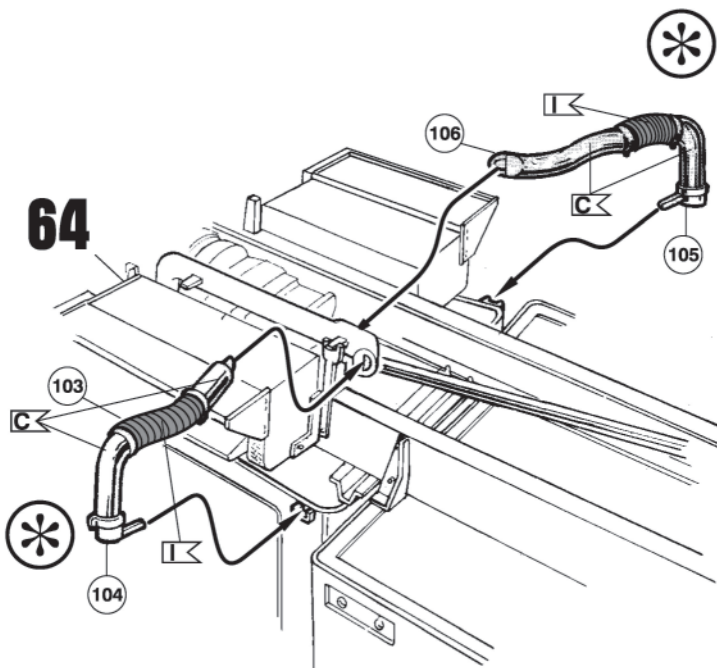



88

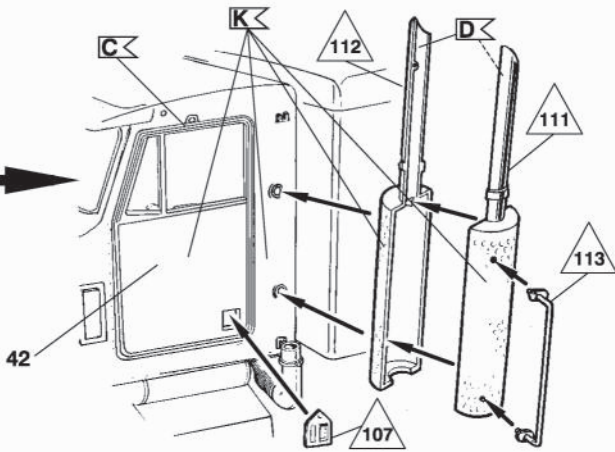

88

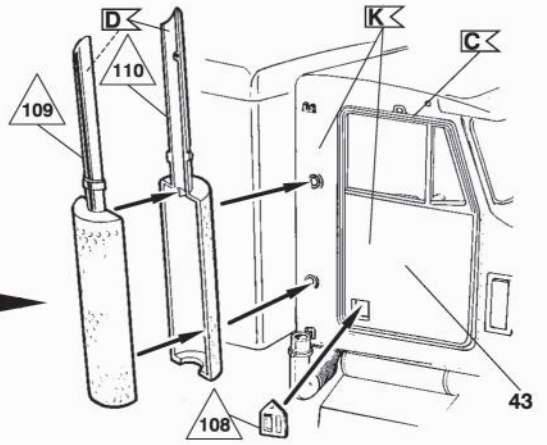

5x

2x

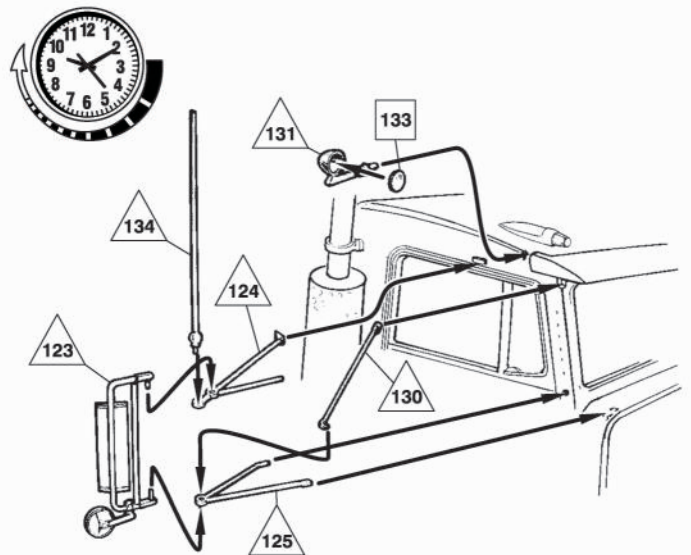
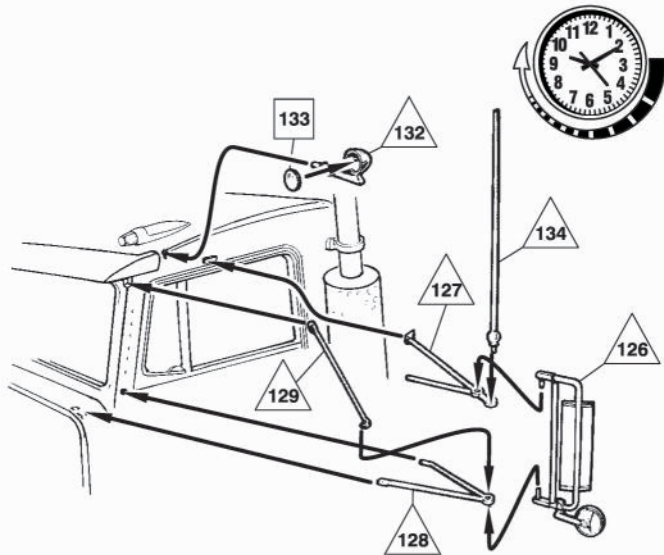
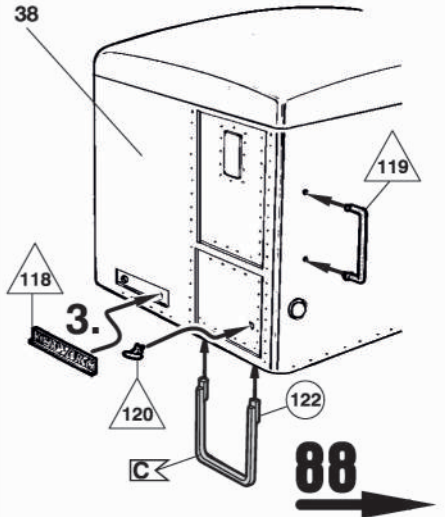
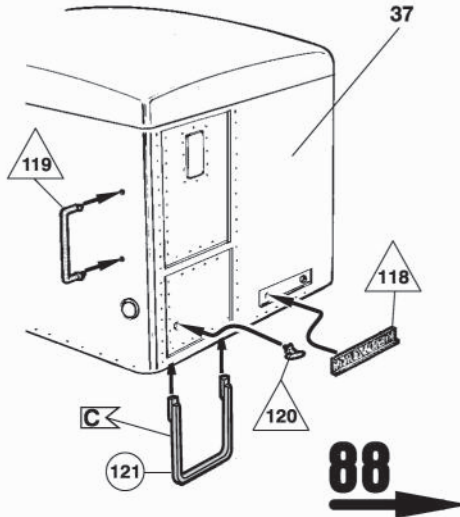
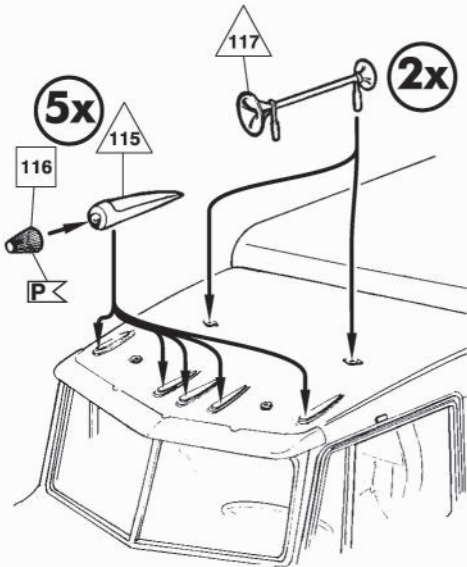

73   

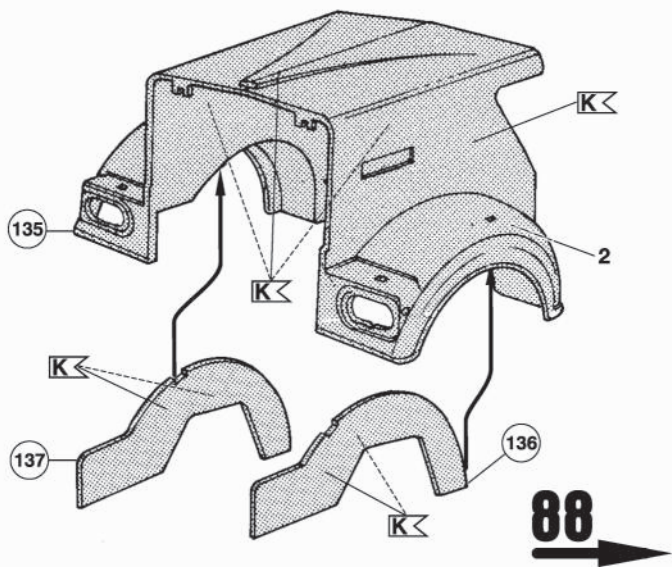

74    

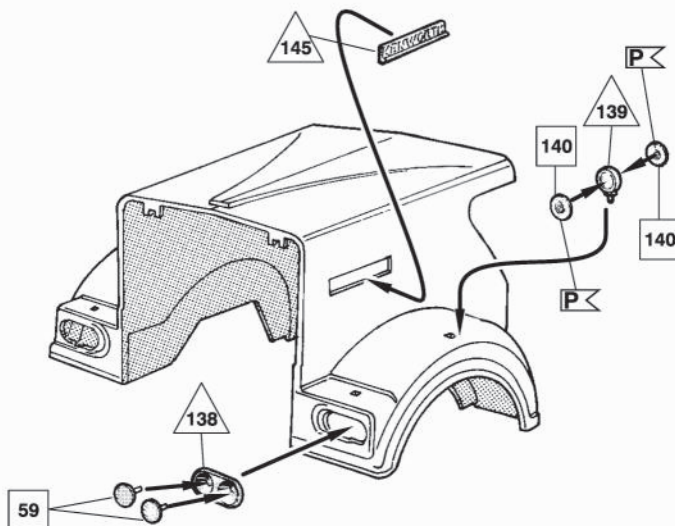

75     

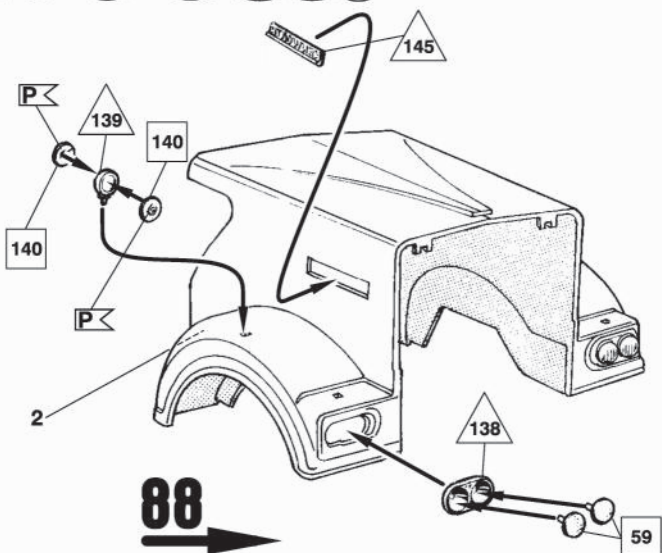

76     

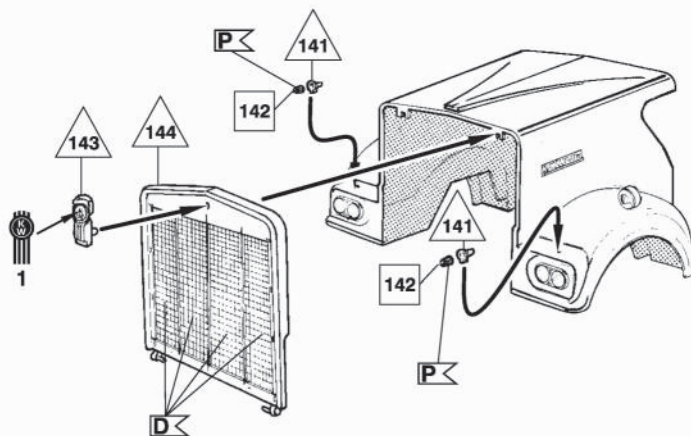

77   

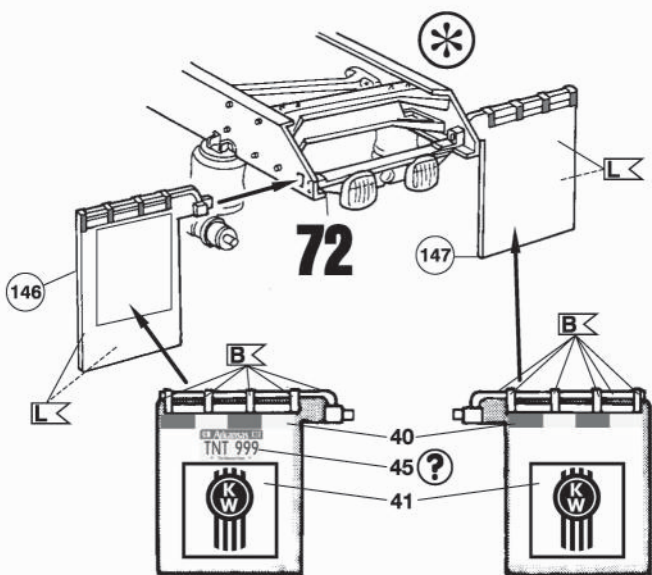

78   

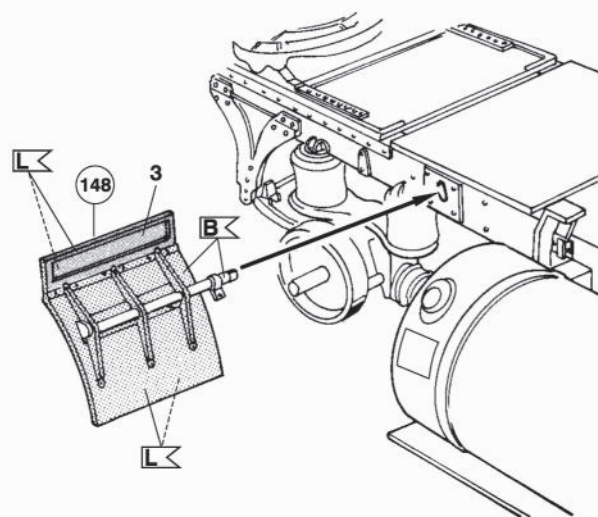

79  

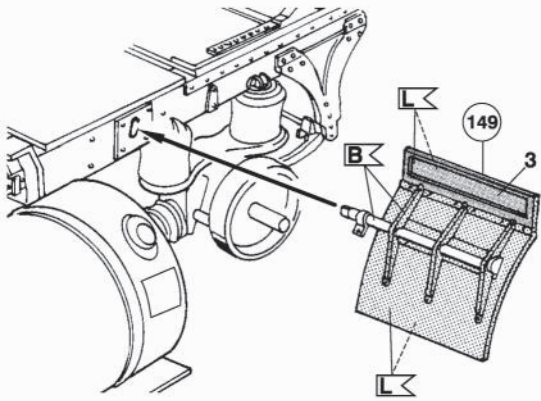

80 

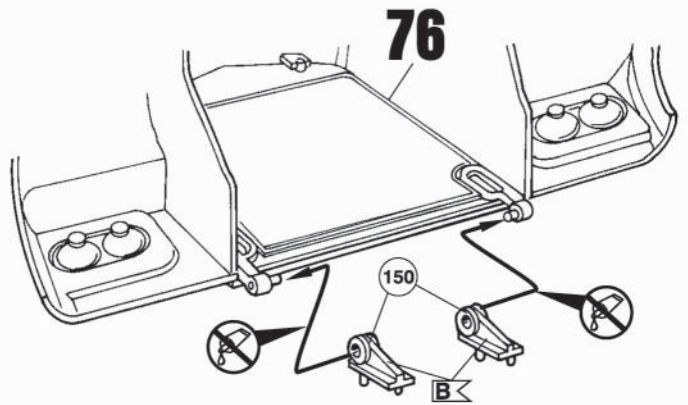

81 

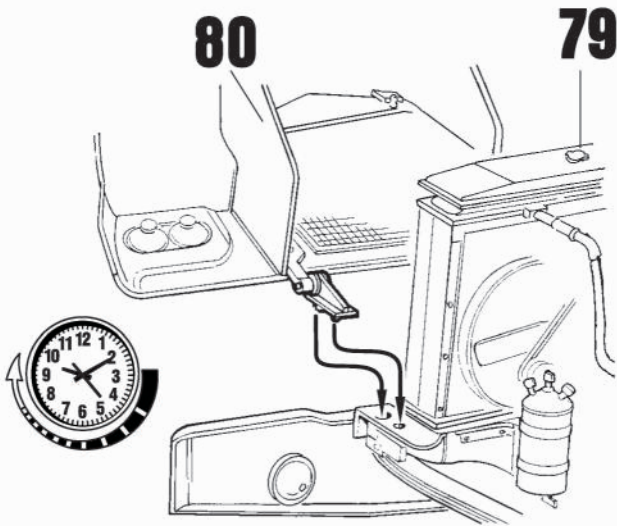

82 

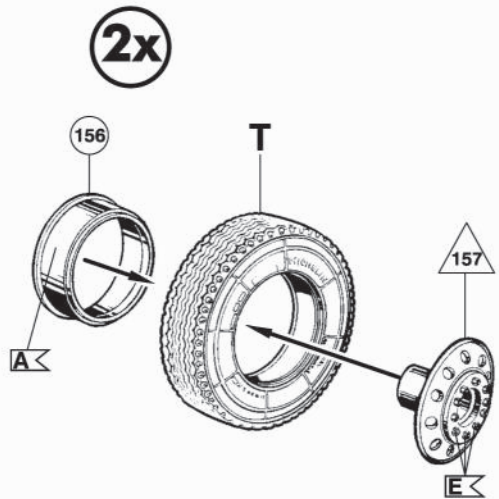

83 

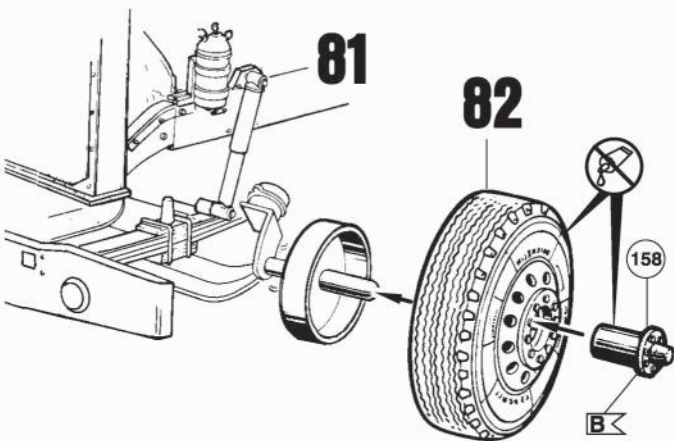

84 

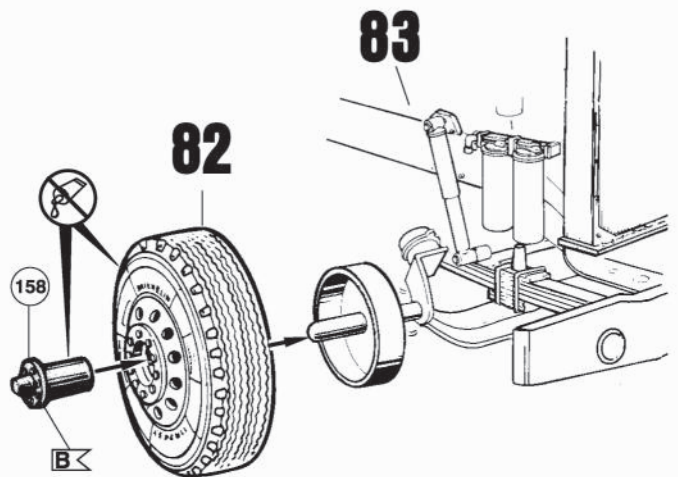

85  

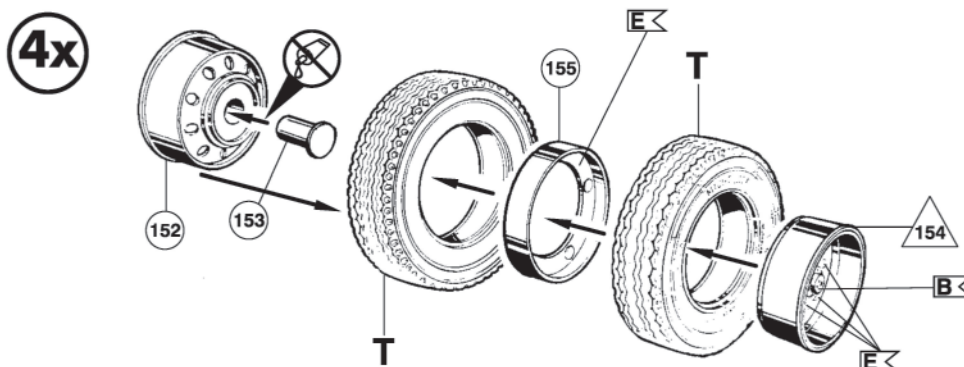

86 

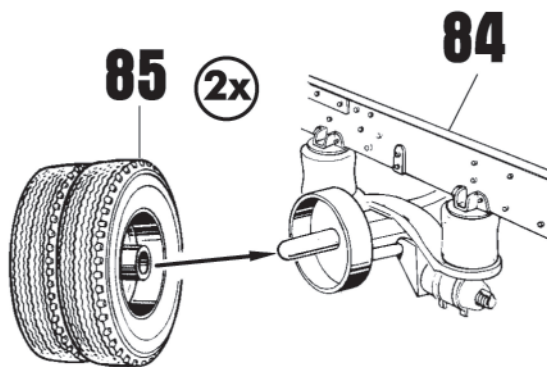

87 

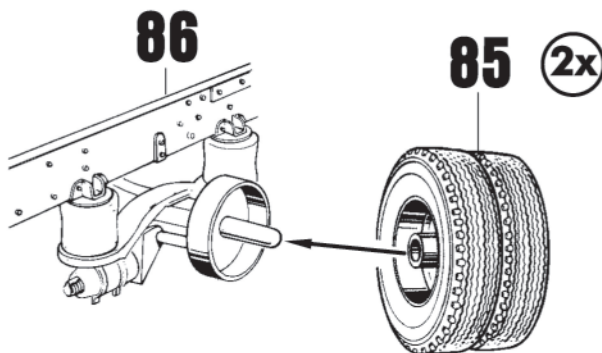

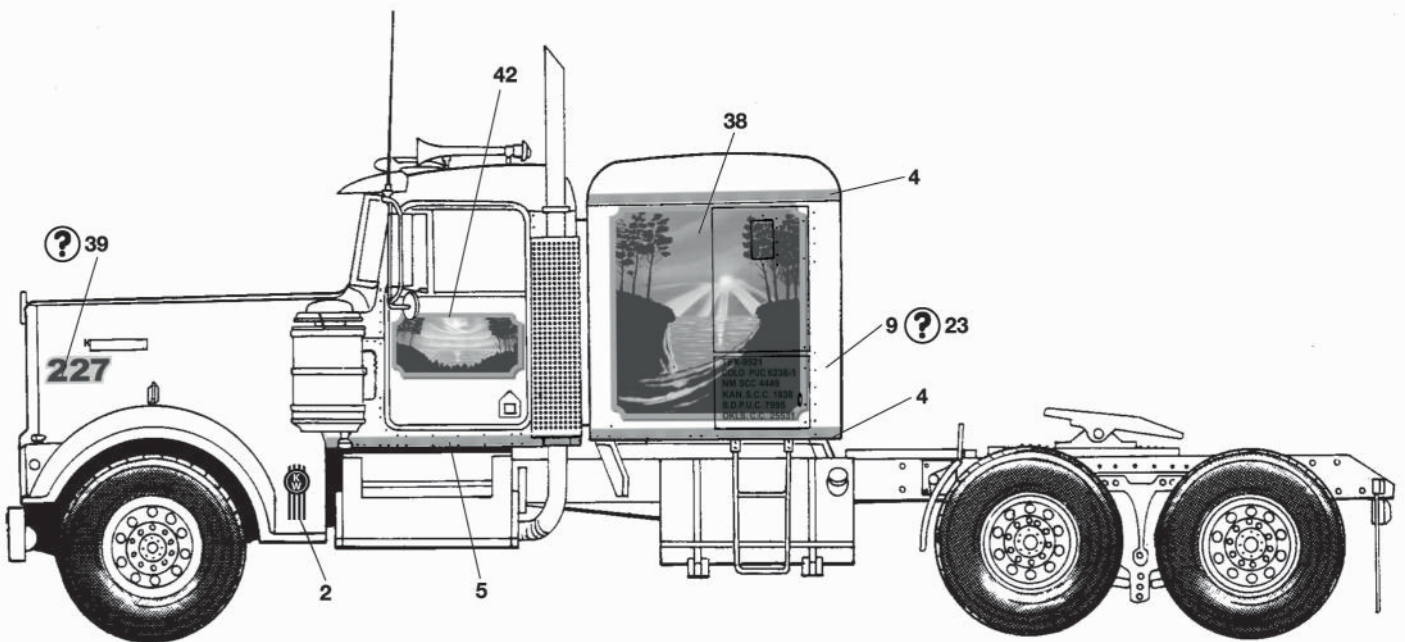
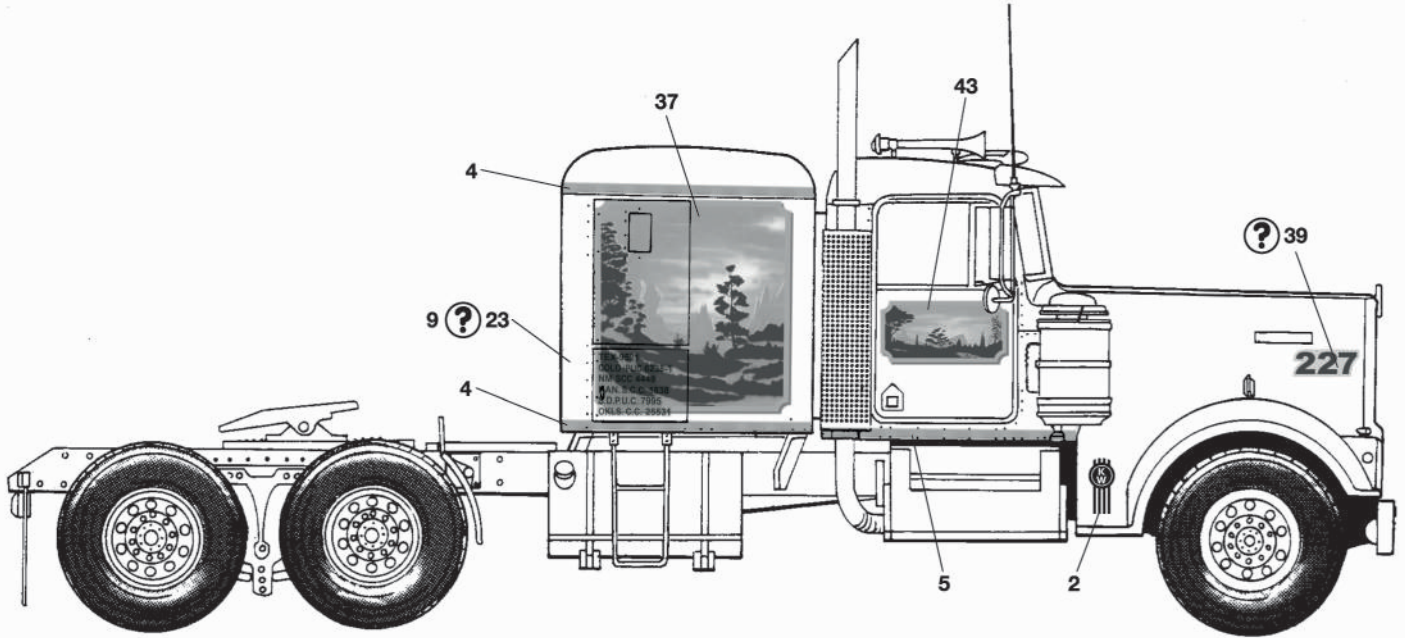
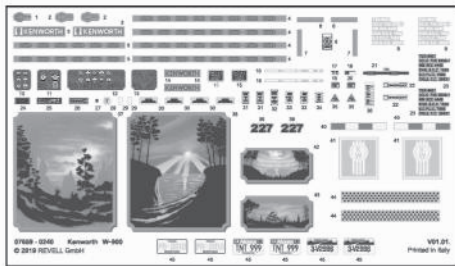

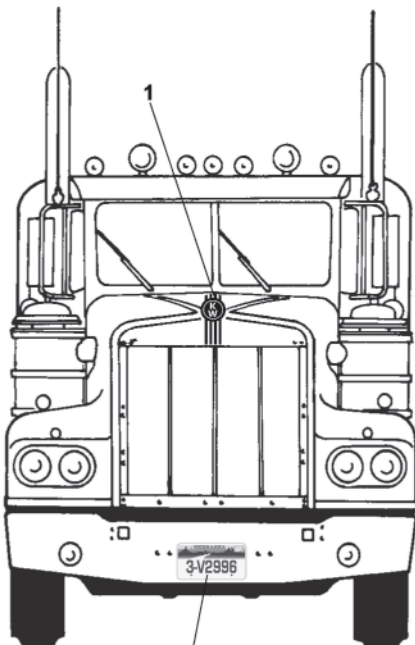
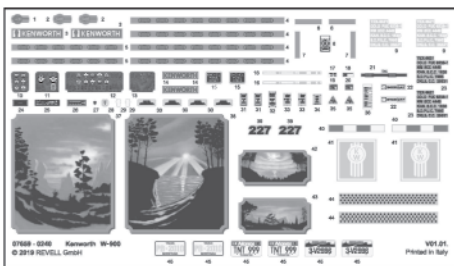

? 45

