

Ki-102 and I-Go



The Kawasaki Ki-102 was a Japanese twin engine two seat long-range heavy fighter developed to replace the Ki-45 Toryu. Three variants were planned: Ki-102a day-fighter, Ki-102b ground-attack and close-support, and the Ki-102c night-fighter which differed considerably from the a and b variants.

The Ki-102a Ko was externally similar to the Ki-102b but with turbo-charged engines for better performance at higher altitudes. It had a 37mm (1.46in) cannon, and 2 x 20mm (0.79in) cannons. The aircraft was to be pressurised for high altitude operation. Six prototypes were built and 20 pre-production units followed, but the aircraft was never put into production.

The Ki-102b Otsu ground attack aircraft was similar to the original 102 prototype, but had a revised (taller) tail-wheel. It had a 57mm (2.24 in) nose cannon, 2 x 20mm (0.79in) cannons mounted in the belly, and a 12.7mm (0.50 in) rear gun. Introduced into service in 1944, the b model only saw limited action over Okinawa, the aircraft being held in reserve to protect Japan itself from an allied invasion. It was also to carry the Igo-1-B air to ground guided missile. Figures vary, but many as 238 may have been built.

Both a and b variants could be fitted with a pair of external fuel tanks, and / or bombs.

川崎 キ-102乙 日本陸軍 襲撃機

川崎キ 102 は、キ 45 屠龍の後継機として開発された長距離双発戦闘機でした。甲型・乙型・丙型の3タイプがあり、それぞれ高高度戦闘機、襲撃機、夜間戦闘機として開発されました。

甲型は高高度性能を改善するため、有圧キャビンとエンジンに排気タービンが装着されました。武装は37mm機関砲1門20mm機関砲2門でした。試作機6機と先行量産機20機が生産されましたが、量産には至りませんでした。

乙型襲撃機は地上攻撃機型でプロトタイプに近い形でした。尾輪は改良のために延長されました。

武装は57mm砲1門、20mm機関砲2門と後方防衛のための12.7mm機関銃1門を装備しました。1944年から配備された甲型は司令部の命令により本土決戦に備え機体を温存していたため、一部が沖縄戦で実戦に参加した以外は使用されませんでした。イ号1B対地ミサイルの母機として仕様される計画もありました。生産数には諸説ありますが、一説には238機が生産されたとされます。

甲型と乙型は両方増槽又は爆弾を2つずつ搭載可能でした。

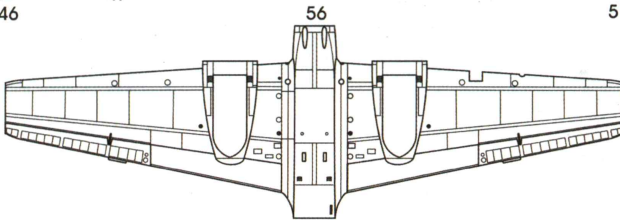
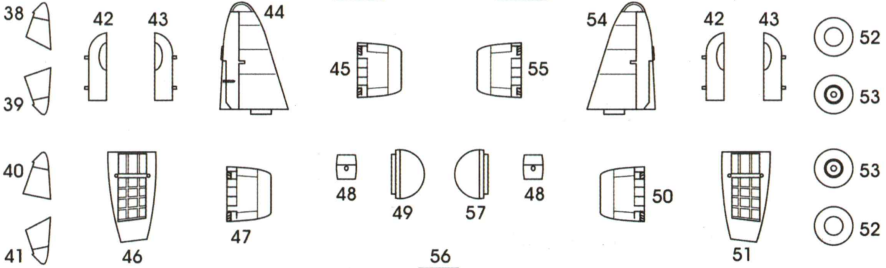
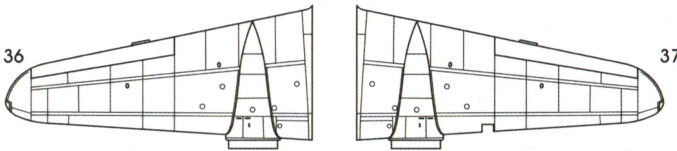
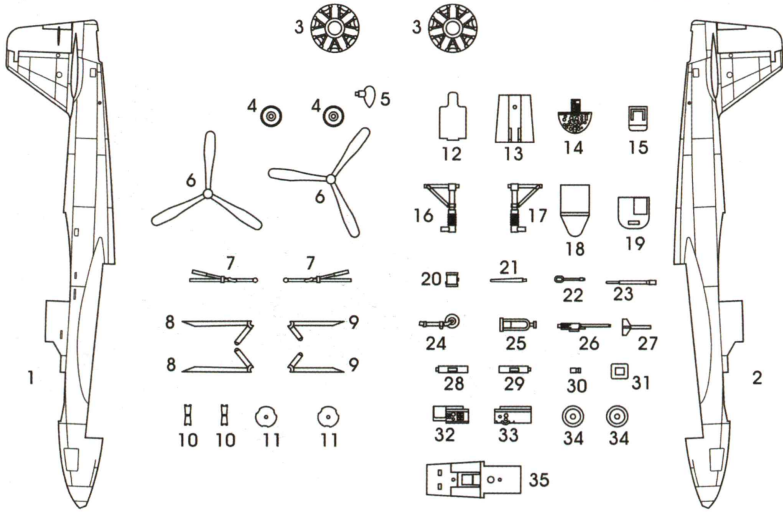

čiré díly/ clear parts

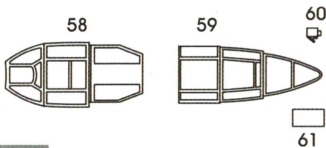

2

- A** C33/H12 * Black
- B** C137/H77 * Tire Black
- C** C55/H81 * Khaki
- D** C8/H8 * Aluminium
- E** C339/H339 * Engine Gray

barvy/ colours

- F** C61/H76 * Burnt Iron
- G** C28/H18 * Steel
- H** MC211 * Chrom Silver
- I** C131 * Brown
- J** C29/H17 * Brown Leather

Note: * = Mr. Color/GSI Creos Aqueous Hobby Color

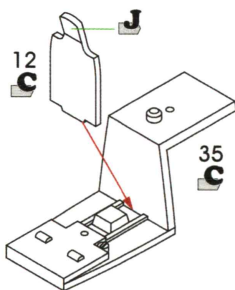
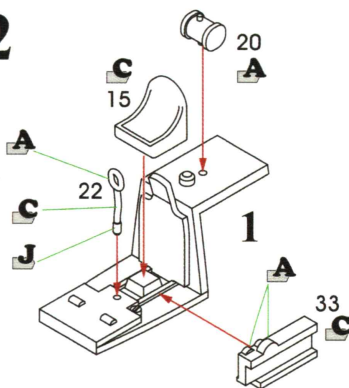
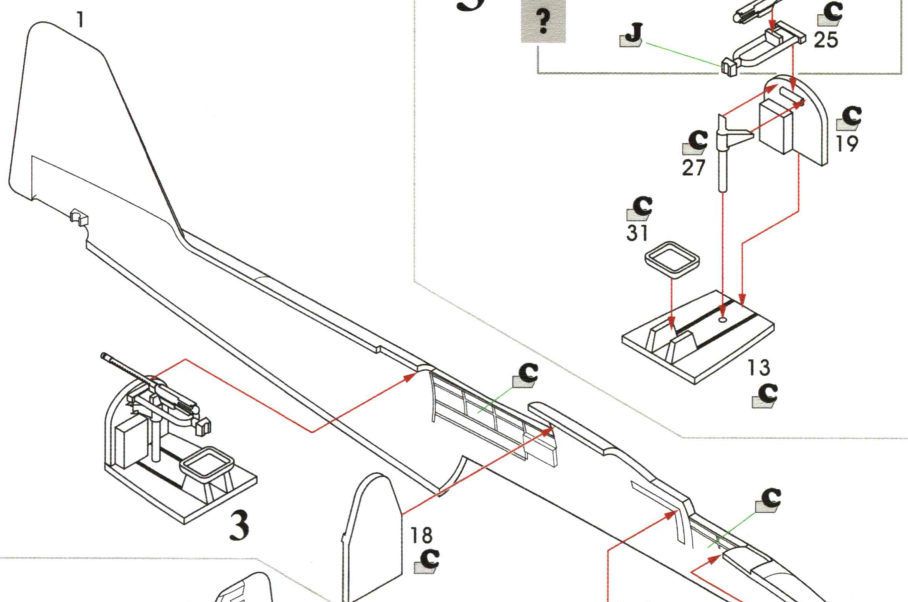
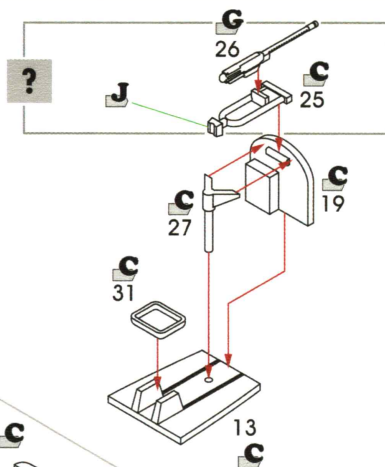
1**2****4****3**

Note:
a possible adjustment
of the fuselage

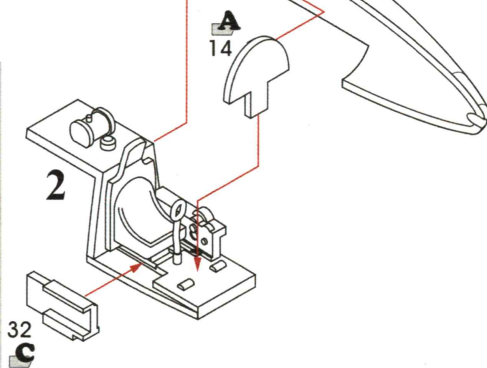
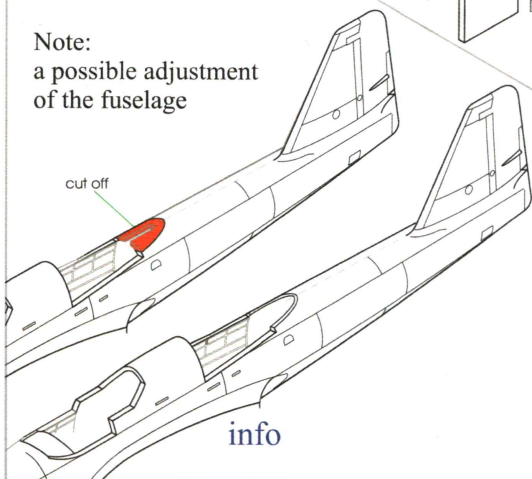
**3**

5

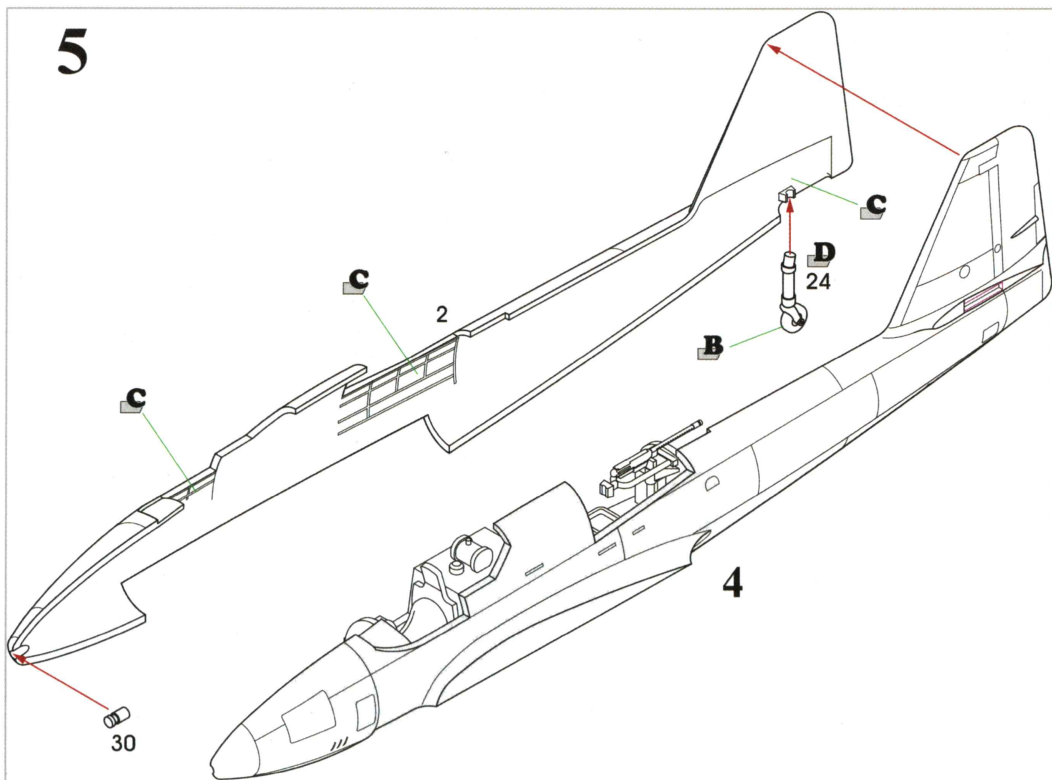

6

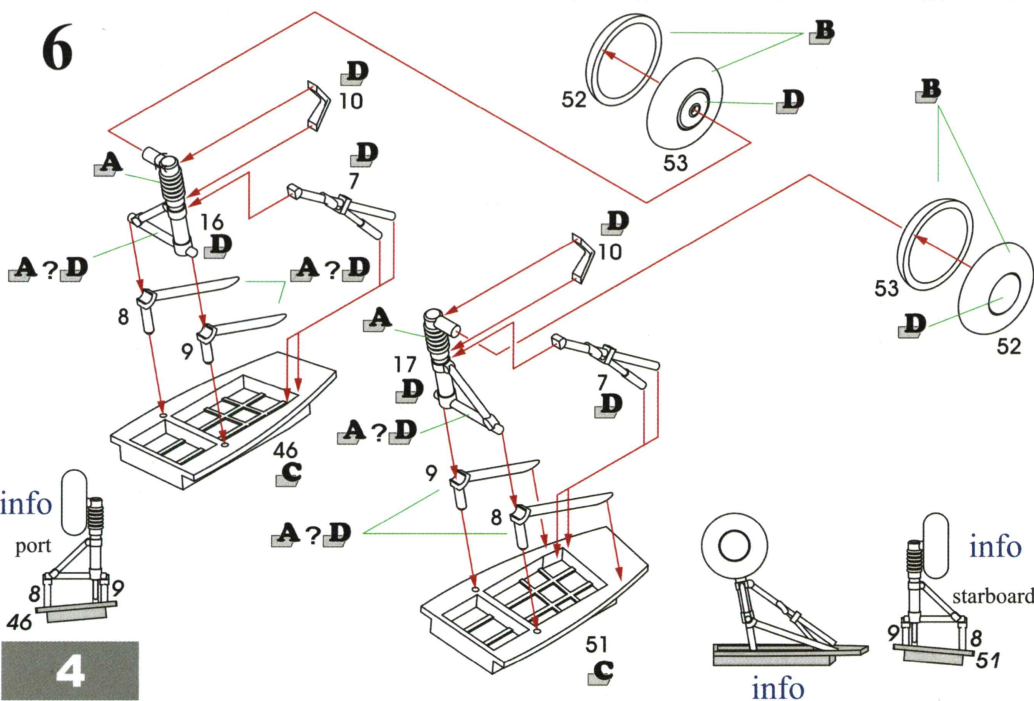

4

7

Edit by Supplement

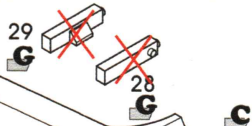

8

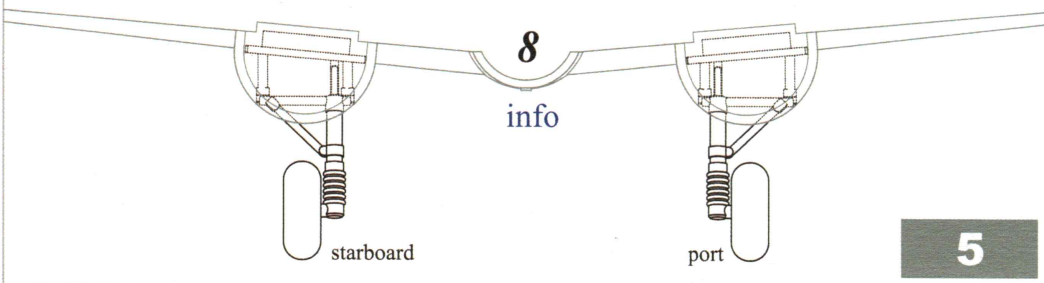
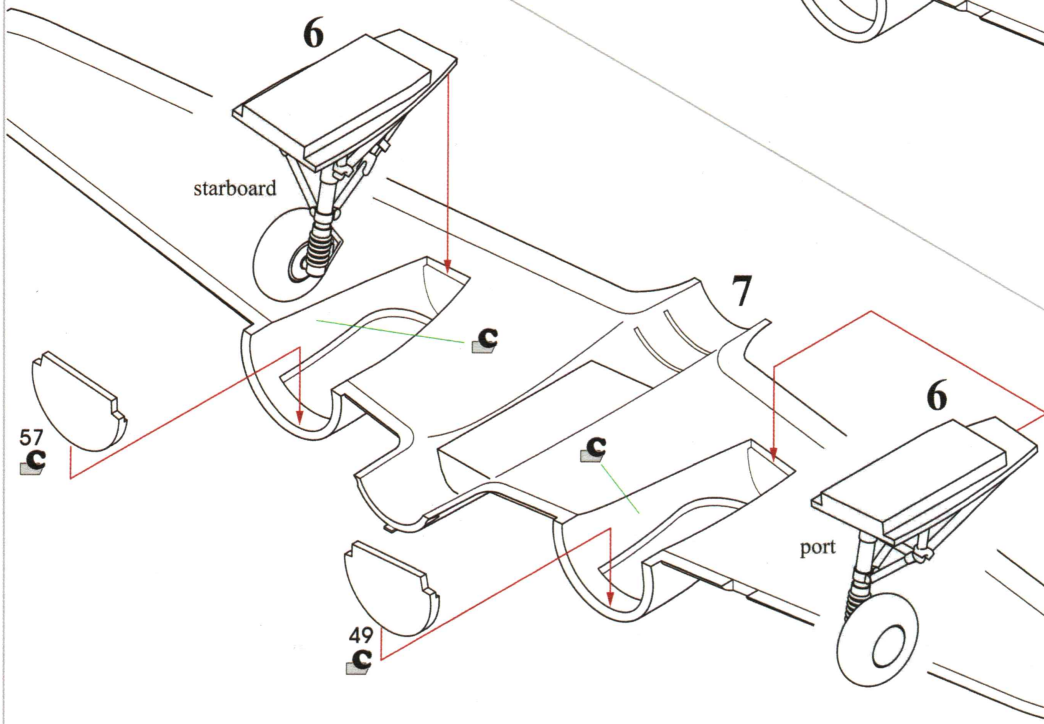
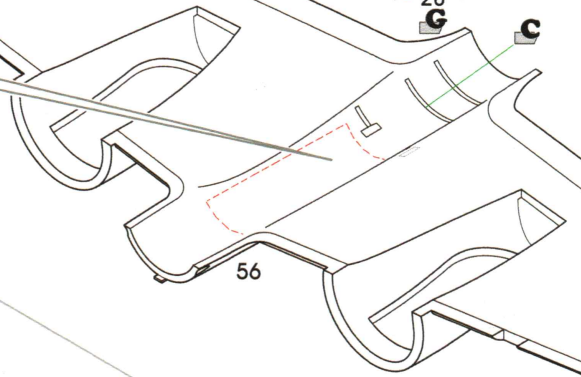



Supplement

Kawasaki Ki-102 and I-go

scale 1/72

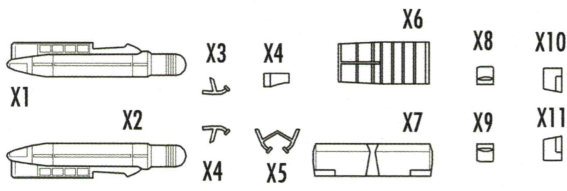

REMOVE



SYMMETRICAL ASSEMBLY

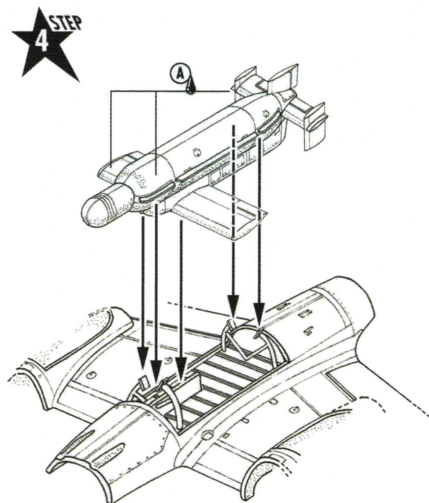
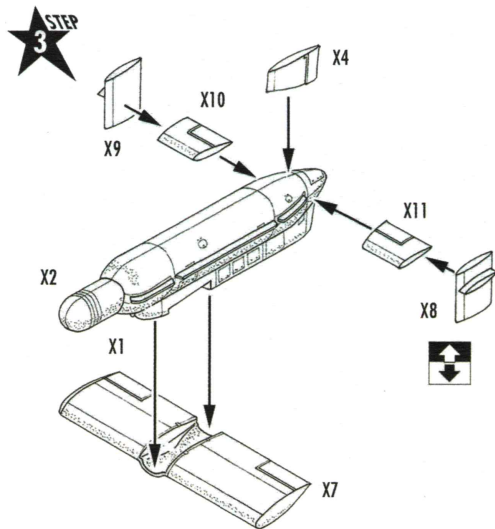
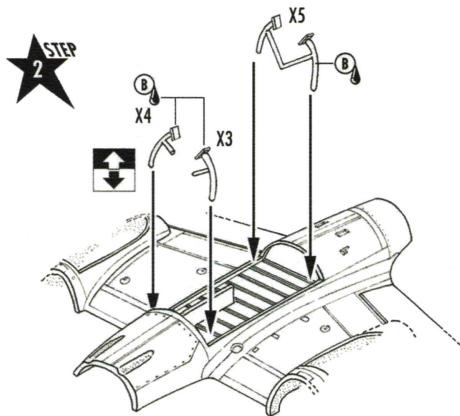
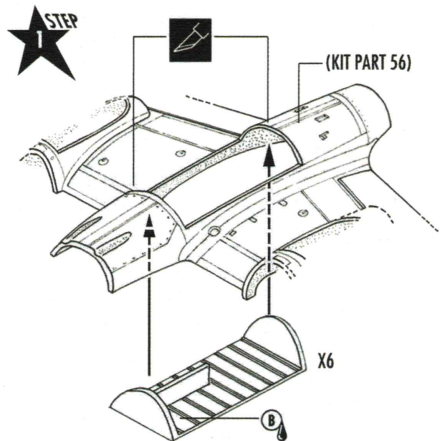

11

2x

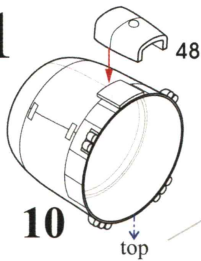

12

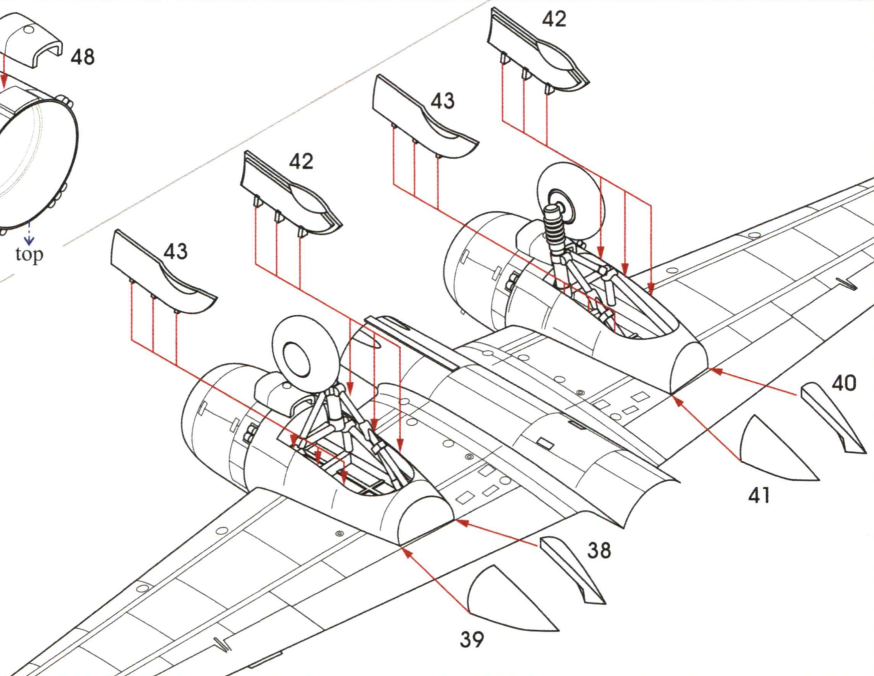

13

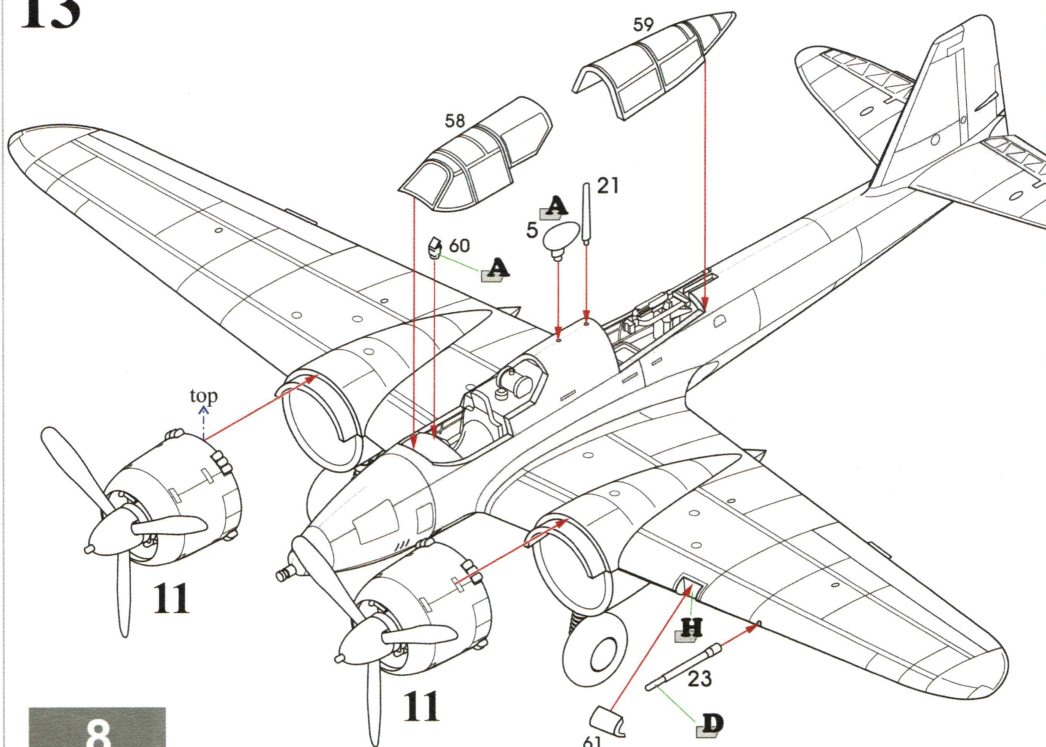

Kawasaki Ki-102 Kou and I-go

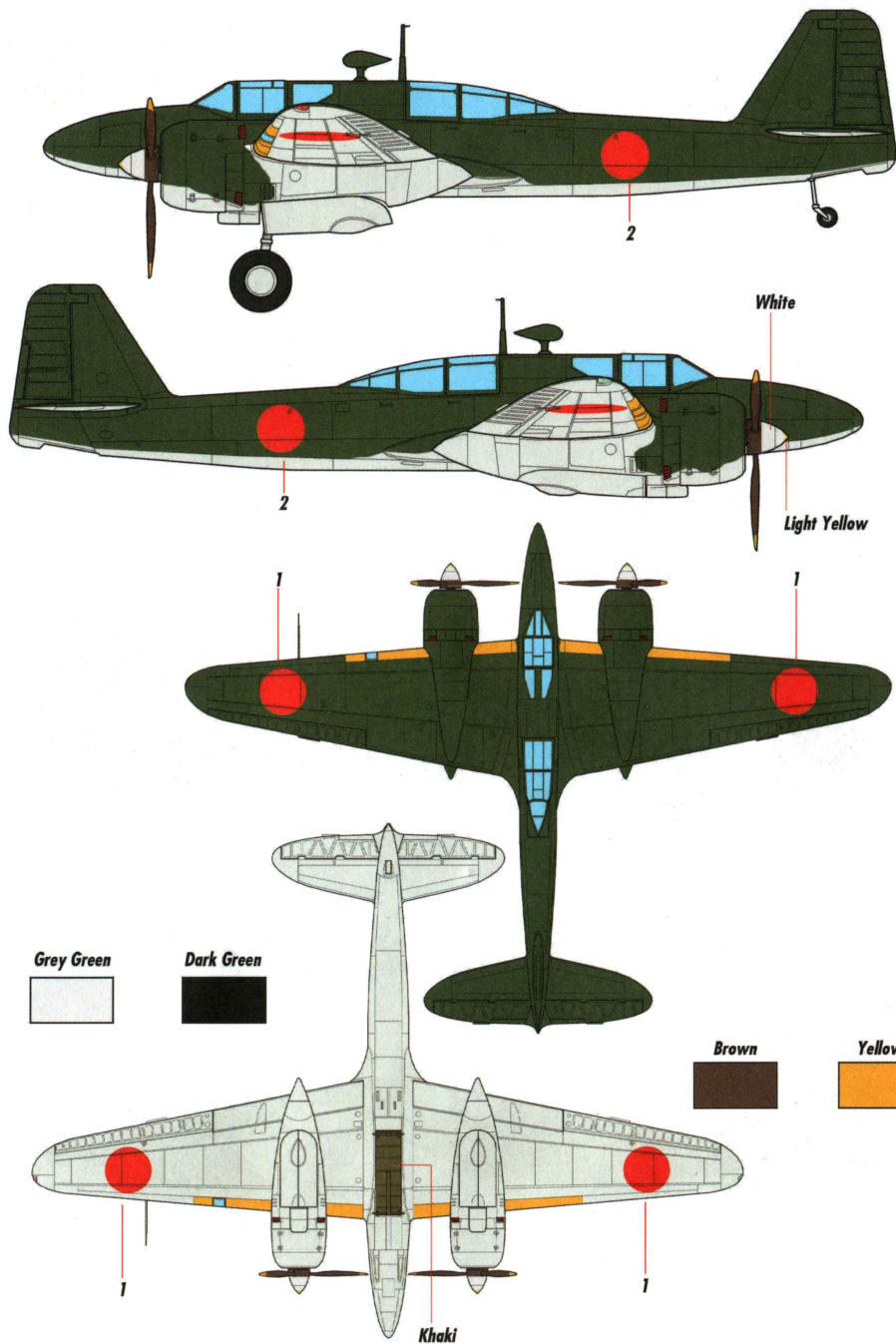

Kawasaki Ki-102 Kou and I-Go

*Kawasaki ki-148 I-Go-Model 1 Otsu
Experimental Army Remote Controlled Flying Missile*

Natural metal/Silver

Red

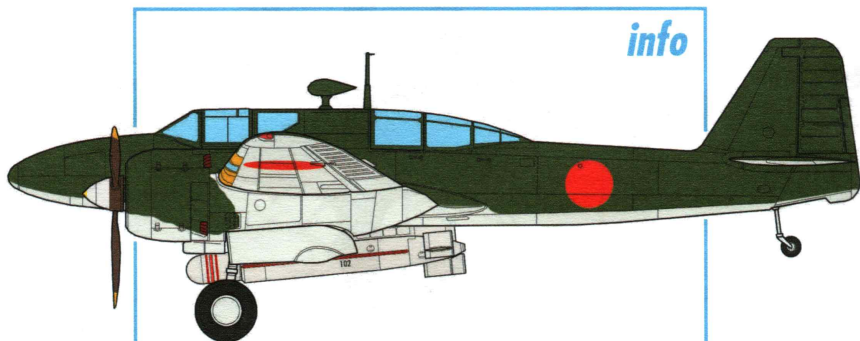
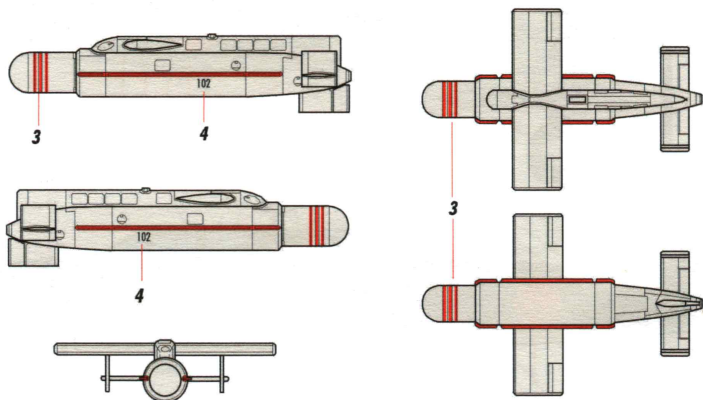

*Test trials were carried out in late 1944 and the weapon was quickly ordered by the war ministry.
Launched during tests from a modified Ki-47, its standard mother aircraft was to be the modern ki-102.*

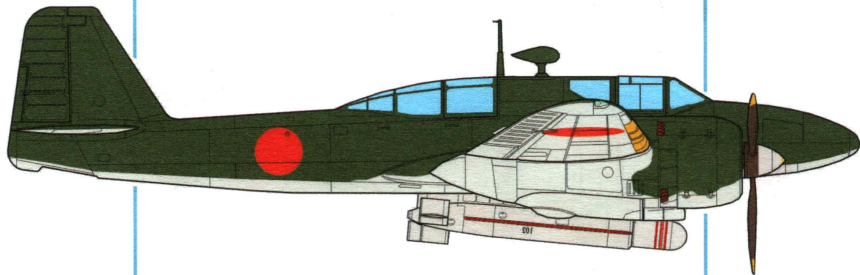

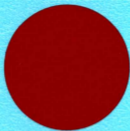
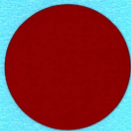

1

2

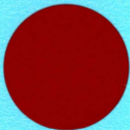
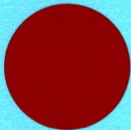

3

102

102

4



SW 72125 Kawasaki Ki-102 and I-go

PRINTED BY TECHMOD

Kawasaki Ki-102 and I-Go

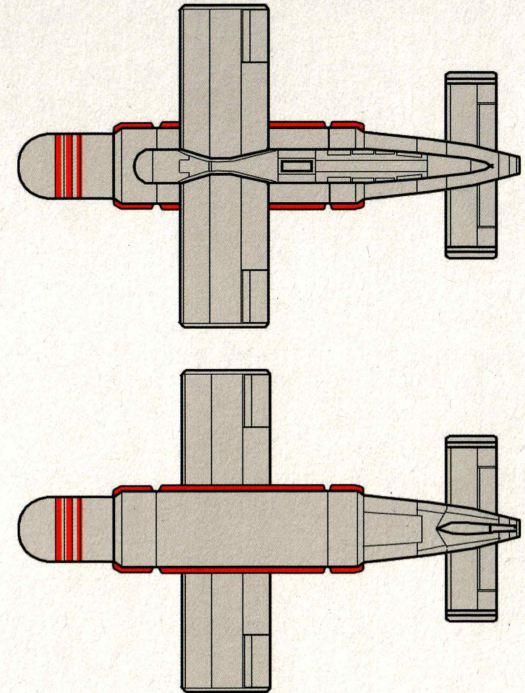
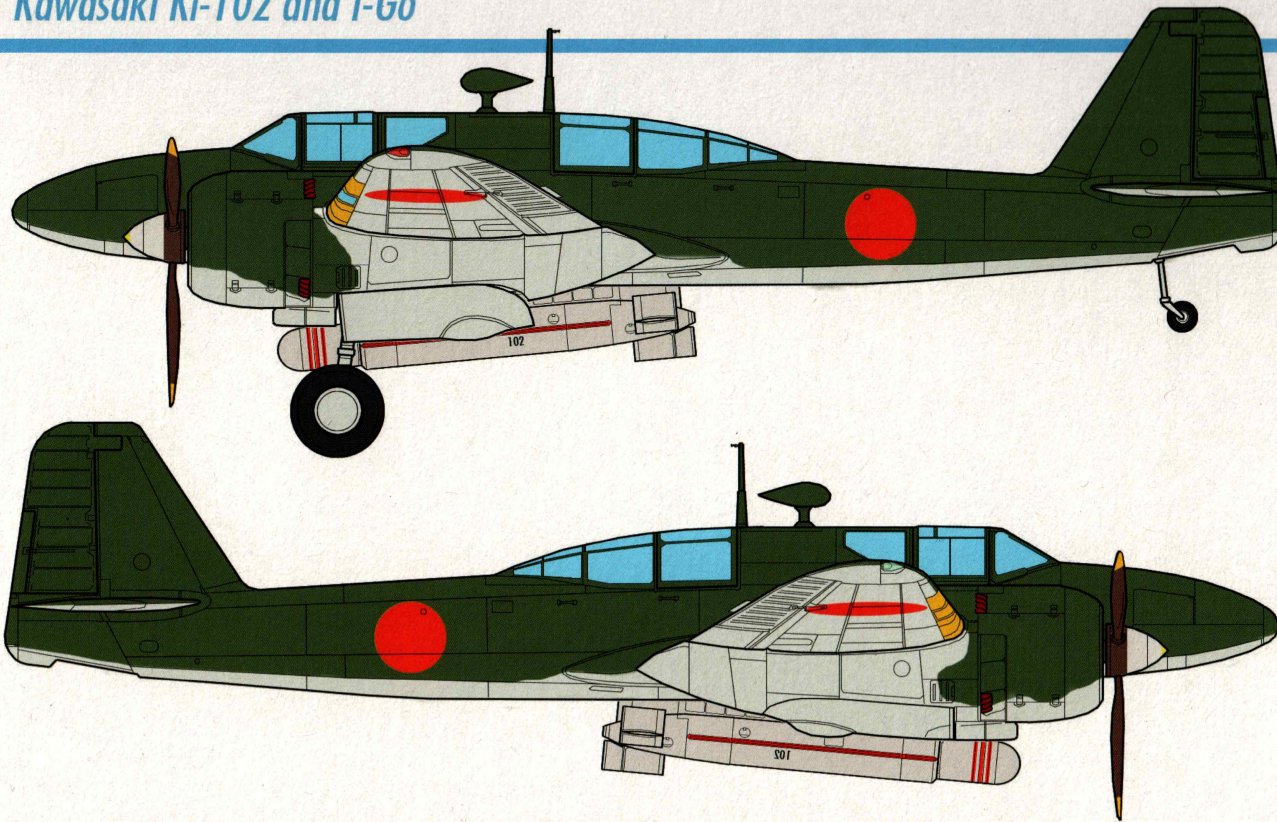

Test trials were carried out in late 1944 and the weapon was quickly ordered by the war ministry. Launched during tests from a modified Ki-47, its standard mother aircraft was to be the modern ki-102.

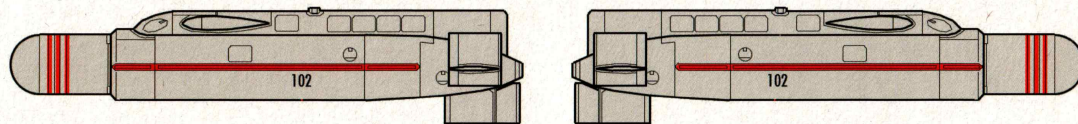

*Kawasaki ki-148 I-Go-Model 1 Otsu
Experimental Army Remote Controlled Flying Missile*

SW 72125(scale 1/72)