

SPACE: 1999

MPC838/06

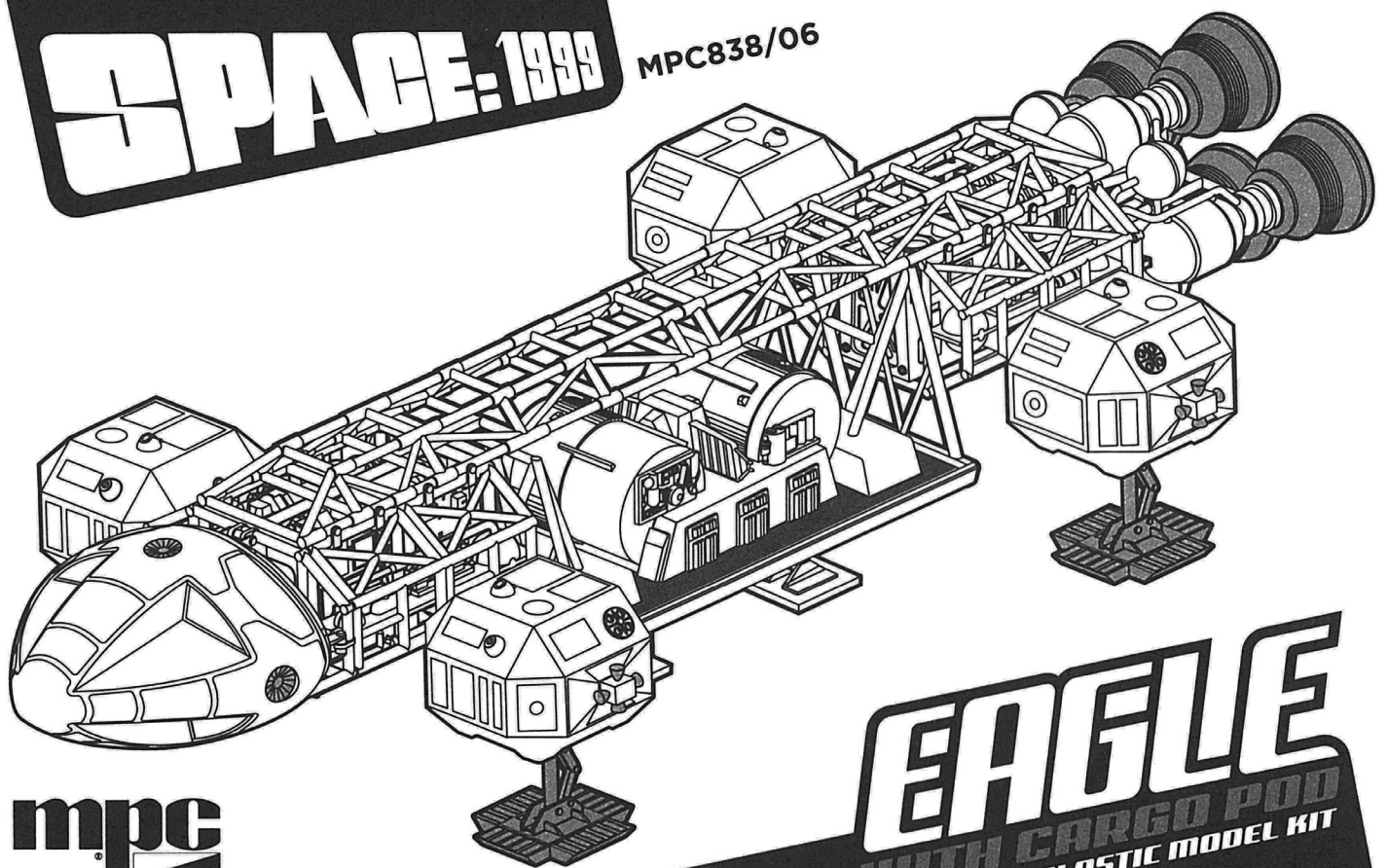

EAGLE

WITH CARGO POD
PLASTIC MODEL KIT

KEY TO SYMBOLS

- E1** WHITE PART
- 06** GRAY PART
- S101** CLEAR PLASTIC PART
- 1** STEP / SUB-ASSEMBLY
-  DO NOT GLUE

-  PAINT & DECAL BEFORE PROCEEDING
-  ALLOW GLUE TO DRY BEFORE PROCEEDING
- x2** REPEAT ASSEMBLY

Thanks to Brian Johnson, the designer of the Eagle Transporter • Thanks to Chris Trice whose measurements and reference were used to develop components of this kit • Thanks to Daniel Prud'homme for his work in creating the CAD model used to develop this kit • Thanks to E. James Small for consulting during the development of this kit and for supplying the buildup and photography shown on the packaging and so much more.

Space 1999 © ITC Entertainment Group Limited. 1975 and 2017. Licensed by ITV Ventures Limited. All rights reserved. MPC is a registered trademark of Round 2, LLC. ©2017 Round 2, LLC, South Bend, IN 46628 USA. Product and packaging designed in the USA. Made in China. All rights reserved.

 Round 2, LLC
4073 Meghan Beeler Ct.
South Bend, IN 46628

 International Hobbycraft (UK) Ltd.
21 St. Thomas St.
Bristol BS1 6JS England

round2models.com
collectormodel.com

GENERAL ASSEMBLY: This highly detailed kit features precision-tooled parts for ease of assembly, but care and patience must be exercised to achieve optimal results. It is recommended that the builder examine the instructions carefully and do a dry test fit of parts before applying liquid cement. You will find this very helpful, as it will allow you to gain a clear understanding of how the parts fit together in order to best plan painting and final assembly. In addition, it is important to note that clear parts are designed to cement in place from the backside of main parts. Windows that are to be painted black should be painted on the backside of the parts

SUB-ASSEMBLIES: Note that this kit should be built in sub-assemblies. This makes building the kit far more manageable. It is very important to note that it is extremely advantageous to apply paint and decals to sub-assemblies before completing final assembly.

PAINT: The plastic color of the ship provides the best reference for the accurate color of the filming model. The sides of the box tray supply further instruction on paint and decal placement.

DECAL APPLICATION:

1. Cut the desired decal from the sheet.
2. Dry fit the trimmed decal to become familiar with its correct placement.

3. Dip the decal in water for 20-30 seconds. For best results, mix one drop of common dish washing detergent per cup of lukewarm water.

4. Place the wet decal on paper towel and wait 30-60 seconds until the decal is movable on paper backing.

5. Wet the area of the model the decals will be applied to.

6. Hold the decal face up, in position on model and slide backing away from under it.

7. Once positioned correctly, absorb excess water with a paper towel. Starting in the center of the decal, blot out air bubbles toward the edges with a soft damp cloth.

8. Troublesome air bubbles can be rubbed to the edge of the decal with a clean, soft paintbrush or simply puncture the decal with a sharp #11 blade. Air bubbles must be removed before the decal dries.

9. Let decals dry completely before handling or applying more decals next to or on top of previous work. It is best not to use heat to accelerate drying times as this may crack the decals, affect their adhesive or melt plastic parts!

10. After all decals are applied, a spray of dull coat is suggested to bury and protect the decals as well as hide surface imperfections and supply a lifelike final appearance to the model.

The kit has been engineered to incorporate optional upgrade parts featured in our Deluxe Accessory Set and Small Metal Parts Set that will deliver the utmost in the finish of the ship. See your model retailer or round2models.com for more info on these products. Available now!

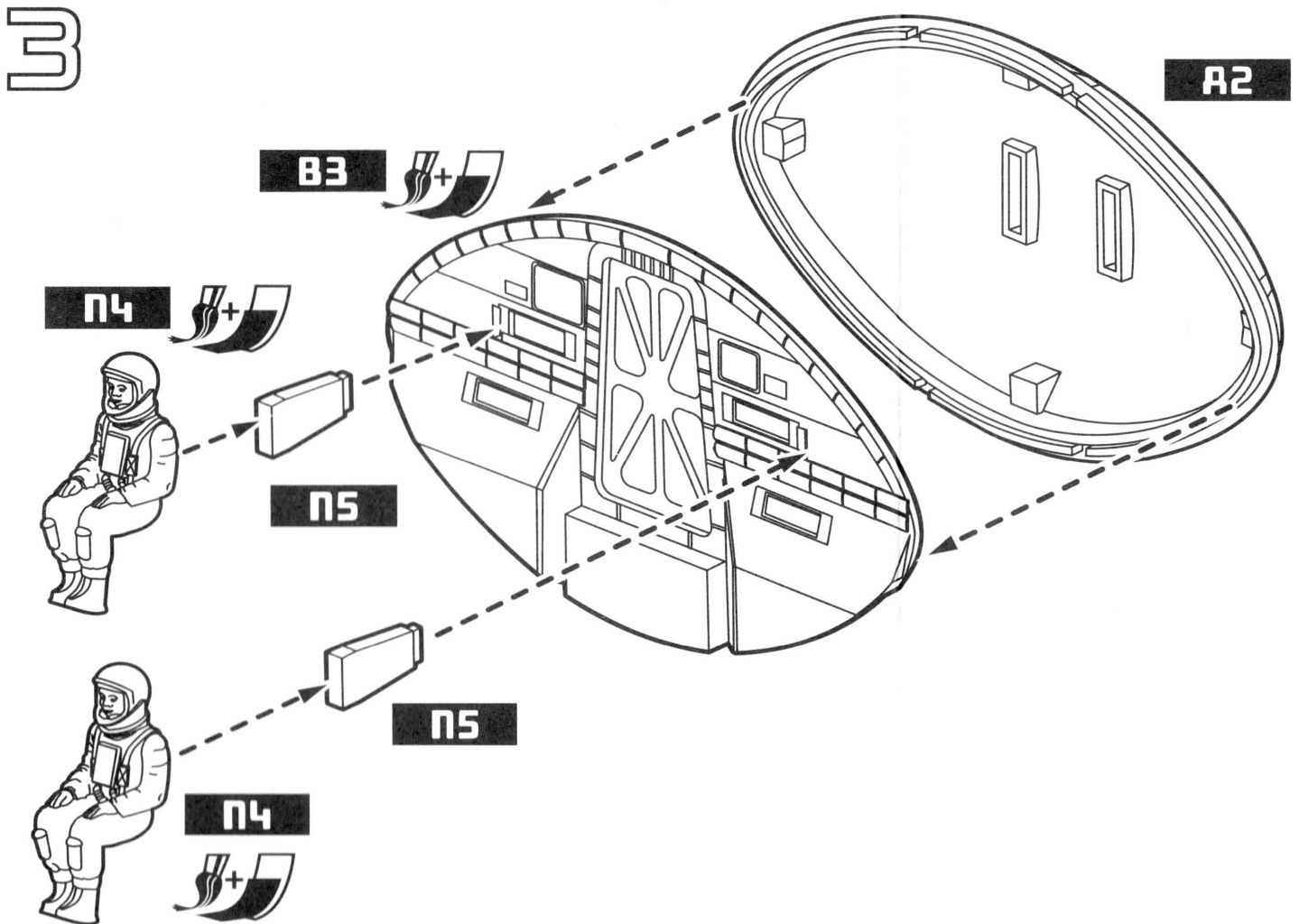
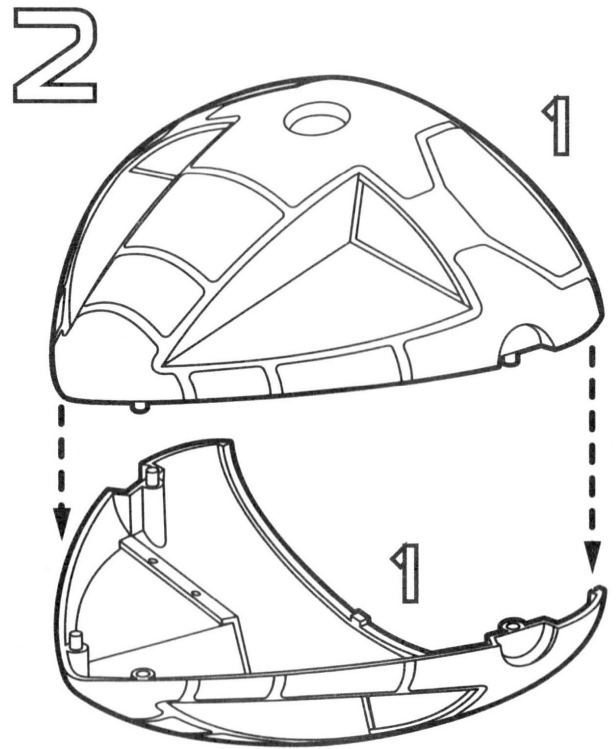
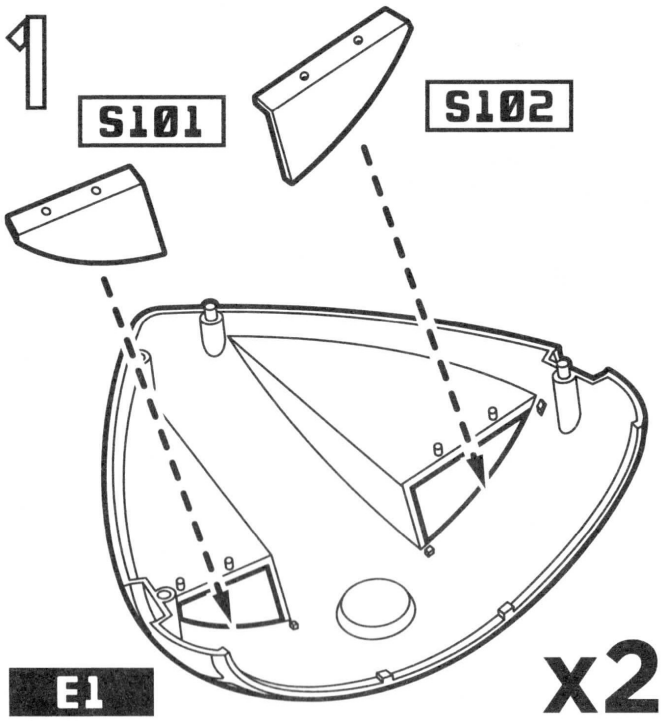

4

2

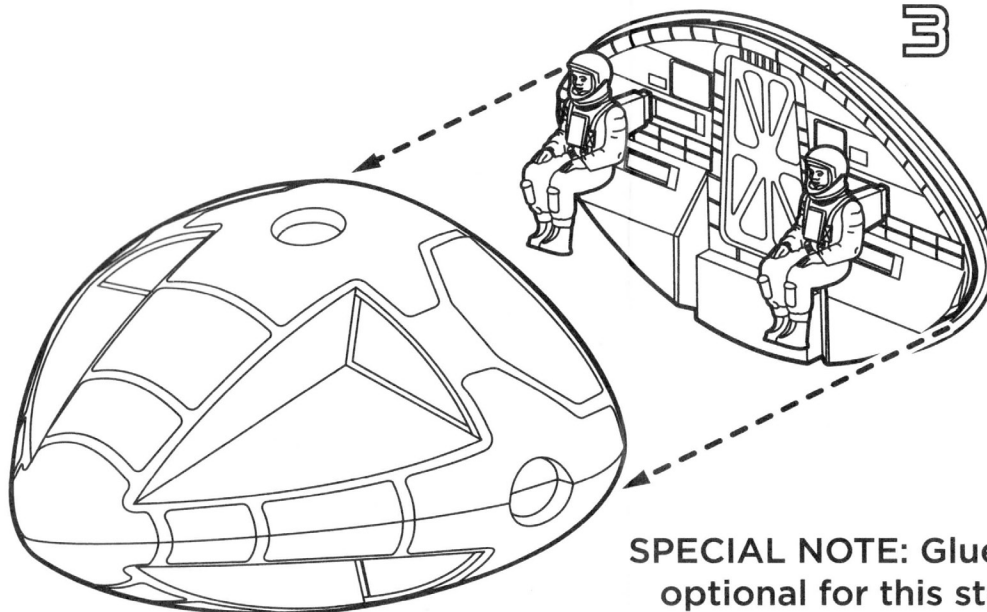

SPECIAL NOTE: Glue is optional for this step.

5

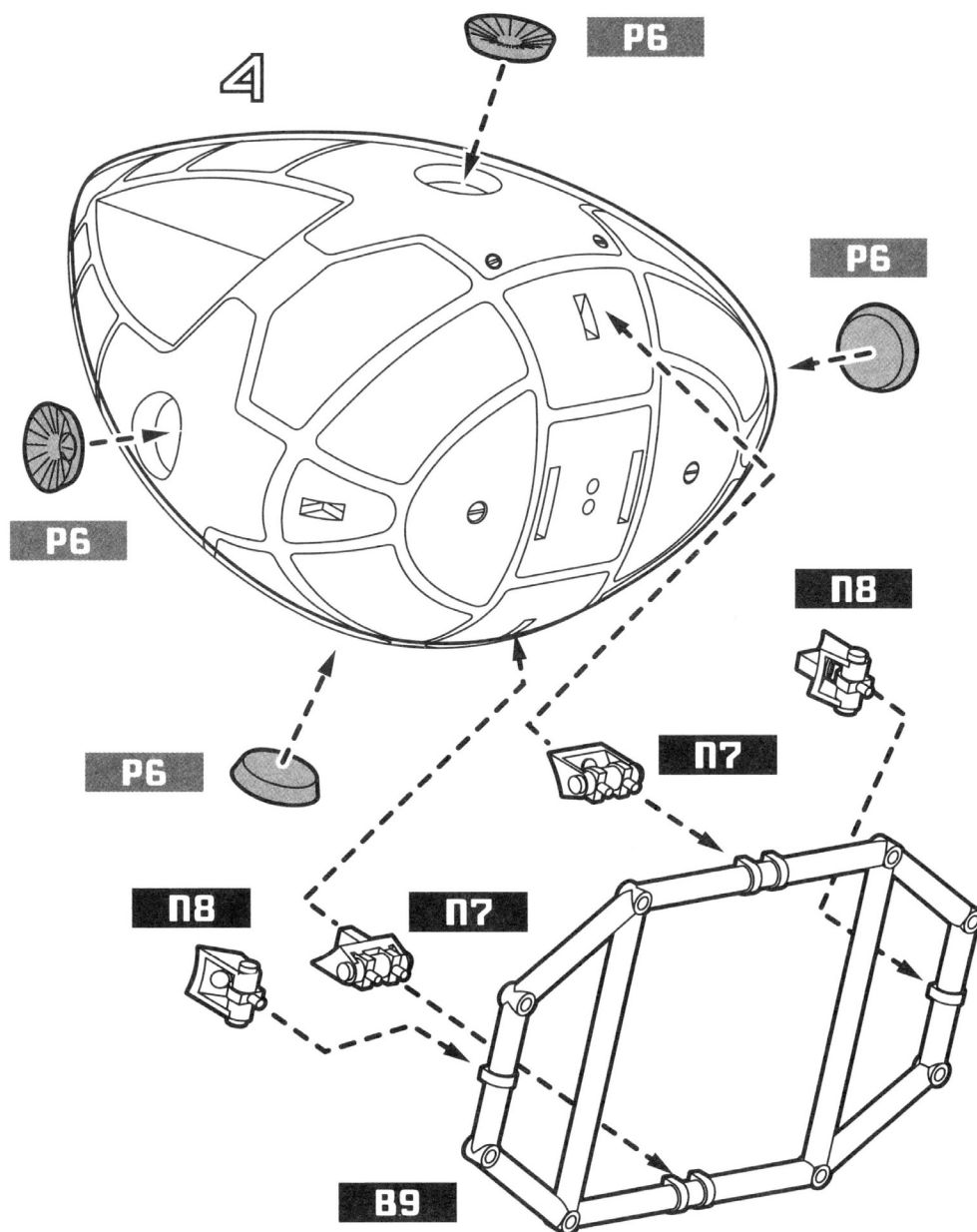

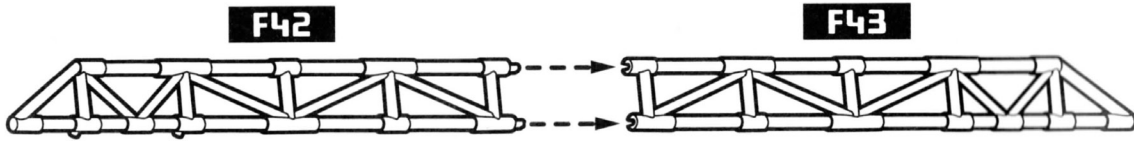
6**x2****7**

Glue parts N46 to holes 4 & 5. (note orientation of slot in part N46) Then glue parts M44 to upper end corners and M45 to hole 1 at each end.

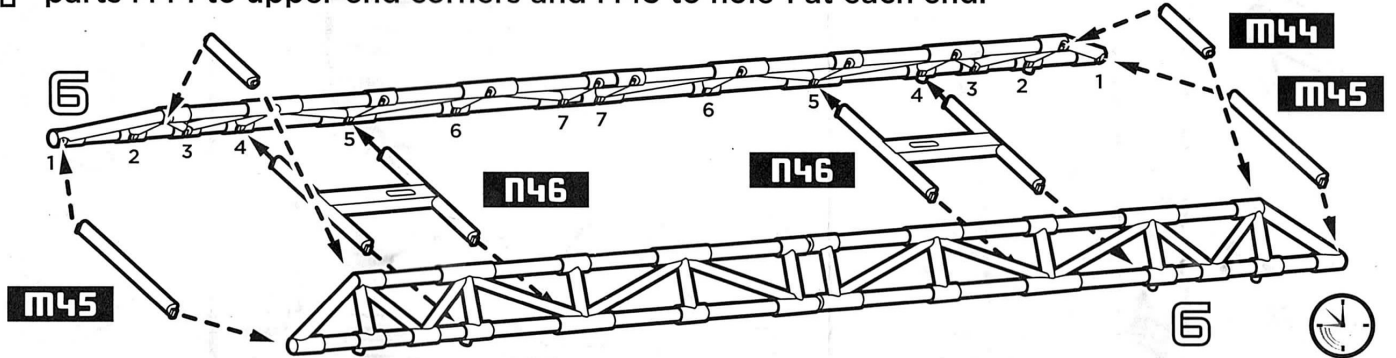
**8**

Dry fit each part in place then apply liquid cement to the joint allowing capillary action to bond parts. Install all parts M44 before beginning to install parts M45.

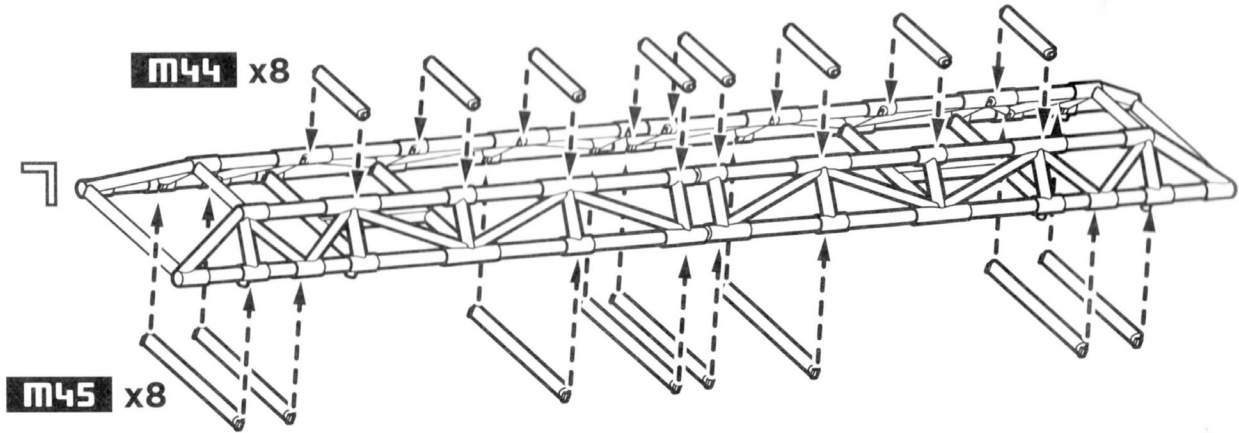
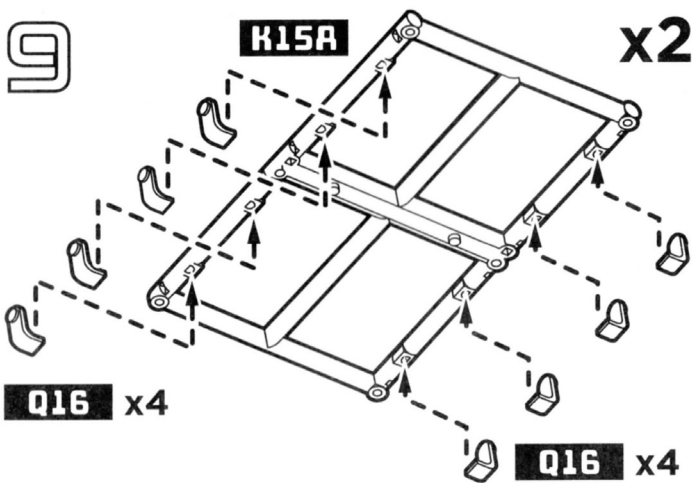
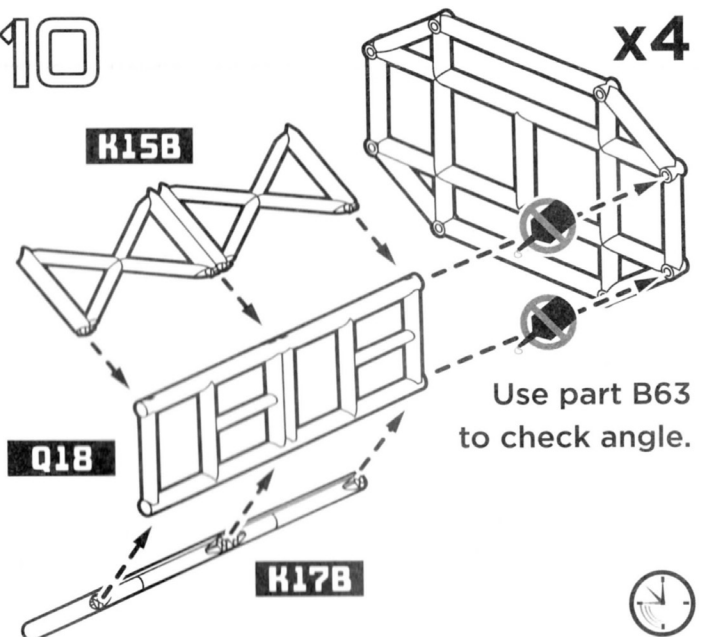
**9****10**

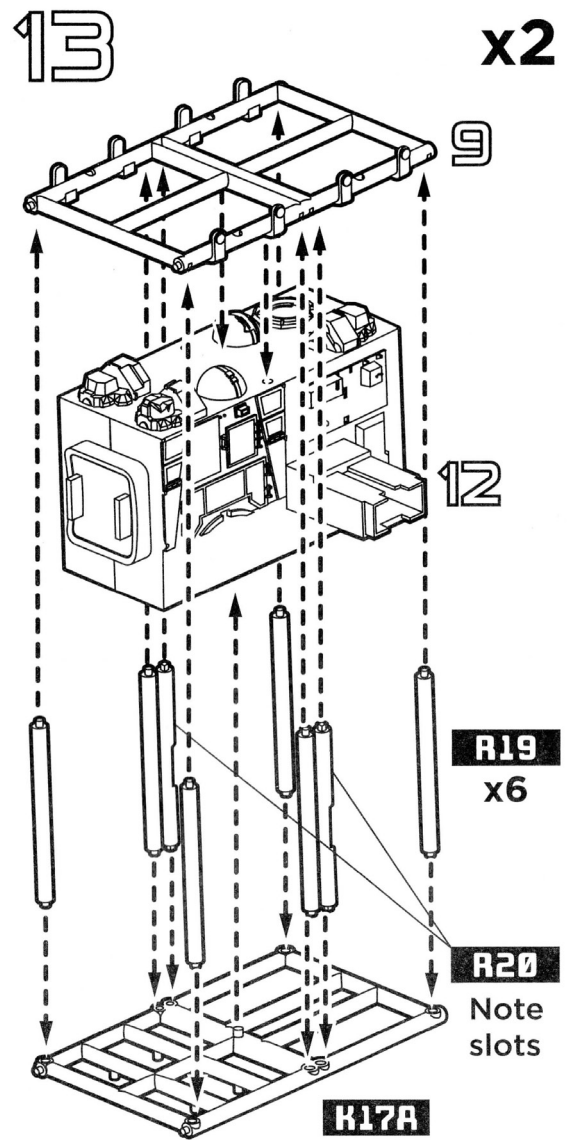
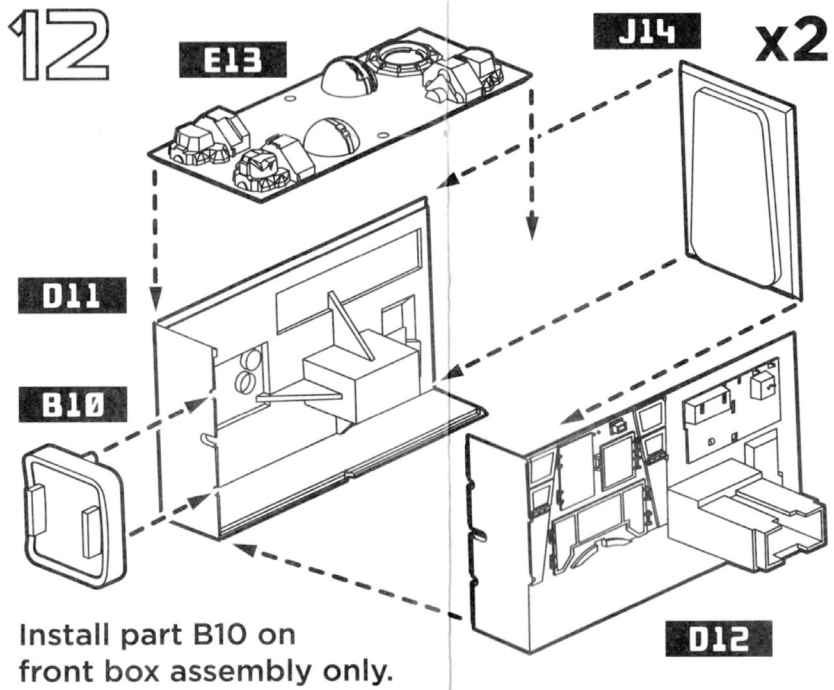
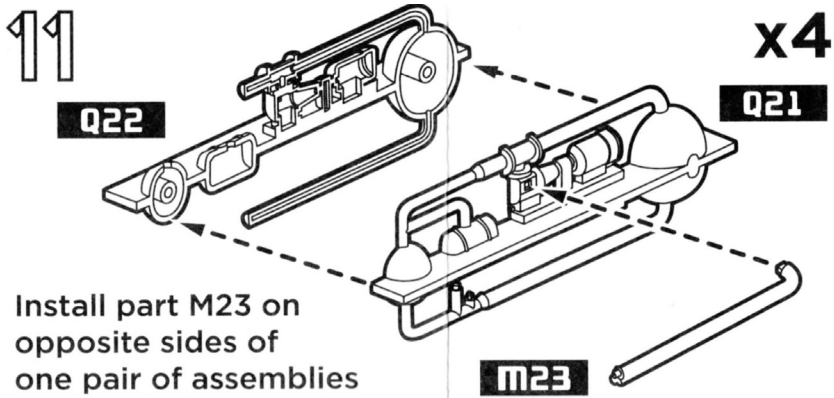

14 Note orientation of part M23*. Install these on the rear cage assembly only.

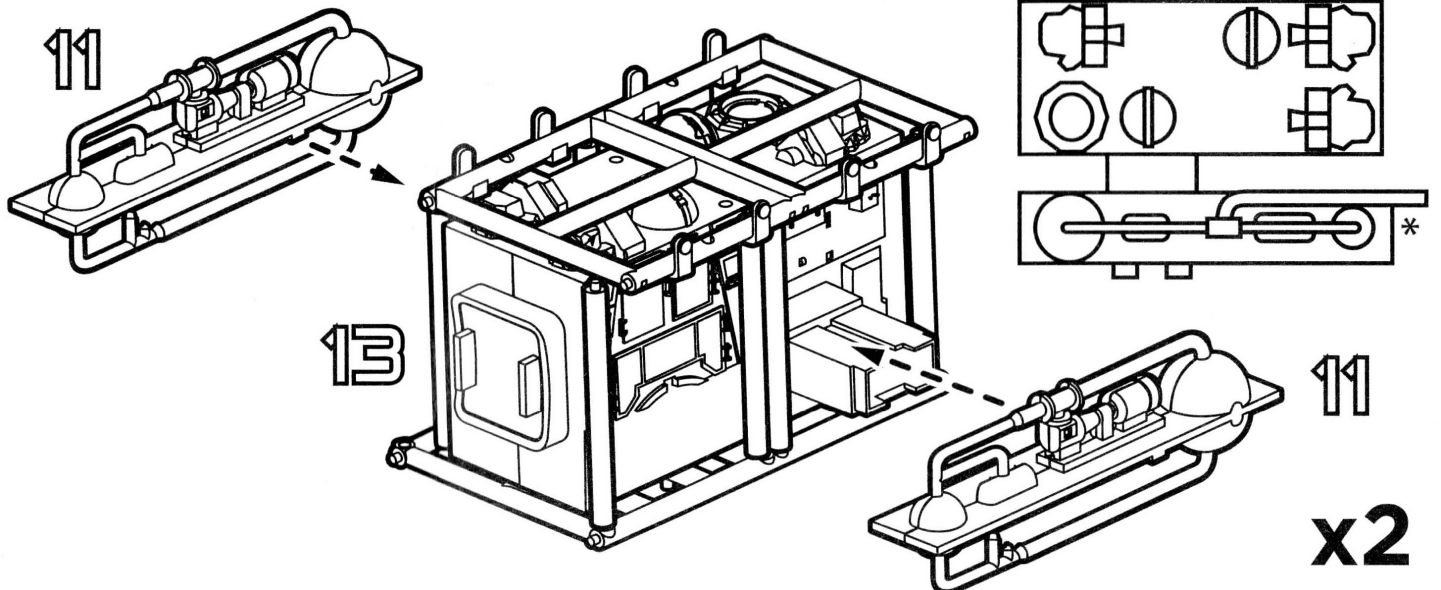

15

x2

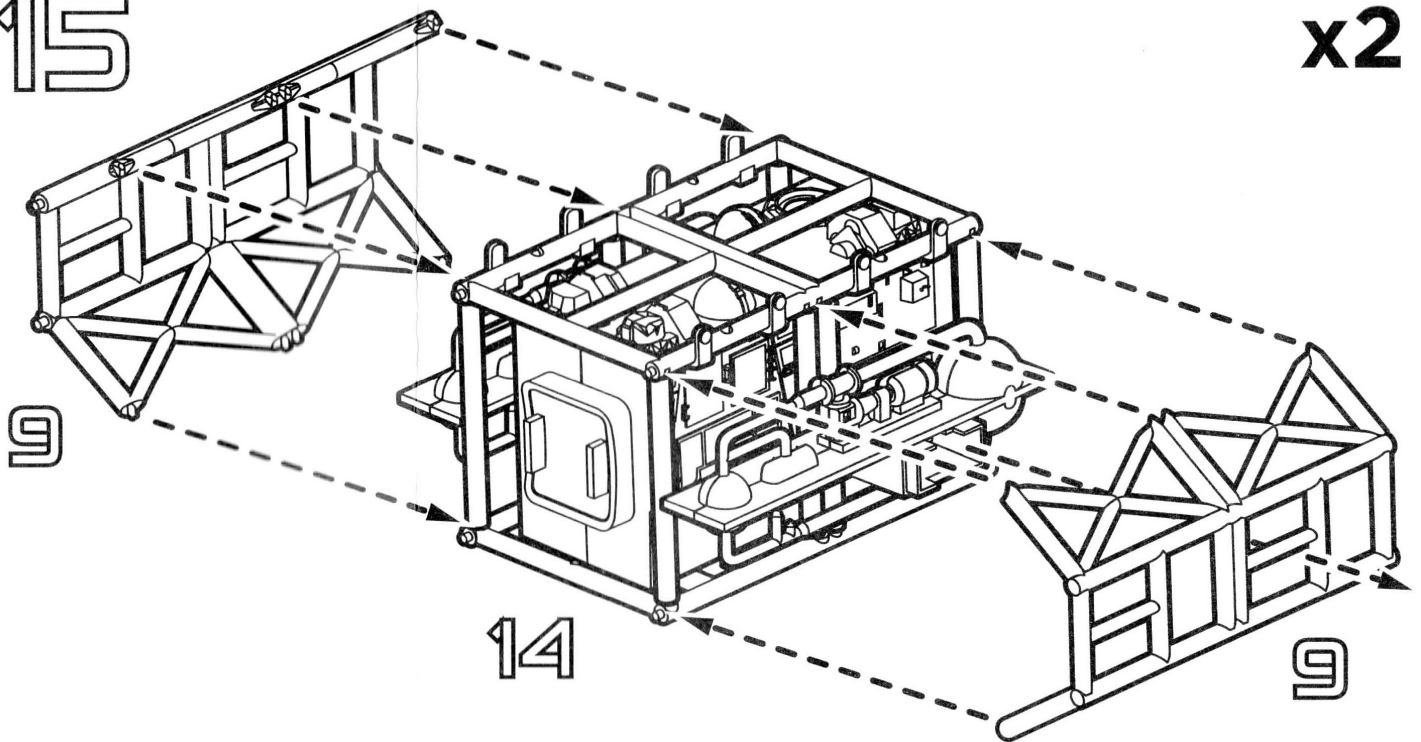

16

x4



057

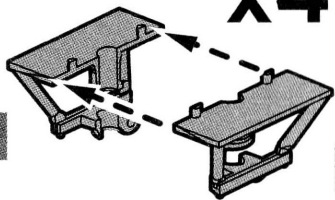

056

17
x4

Use a drop of super glue hold spring to part 060.



17

063

065

060

064

062

061A

061B

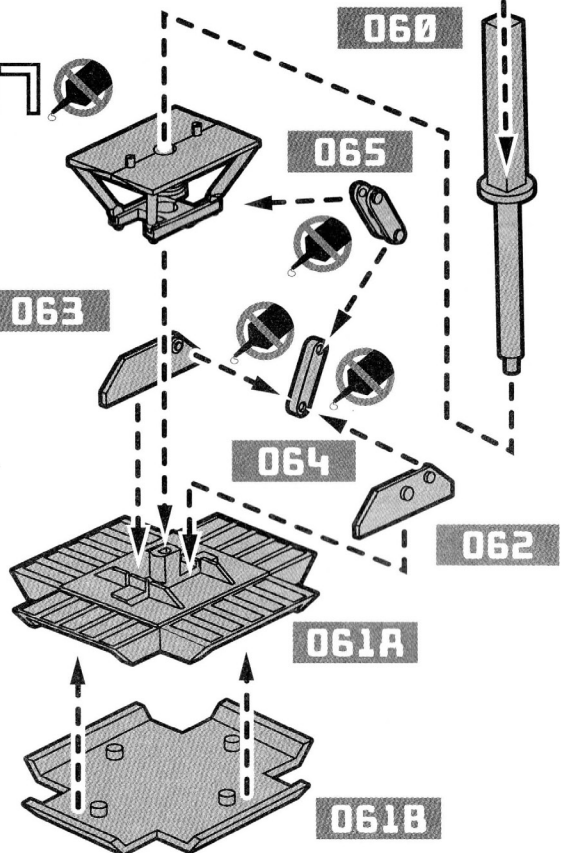

18

Use Q39 on front pods only.
Remove pin from H47 & H48 used on rear pods.

x4

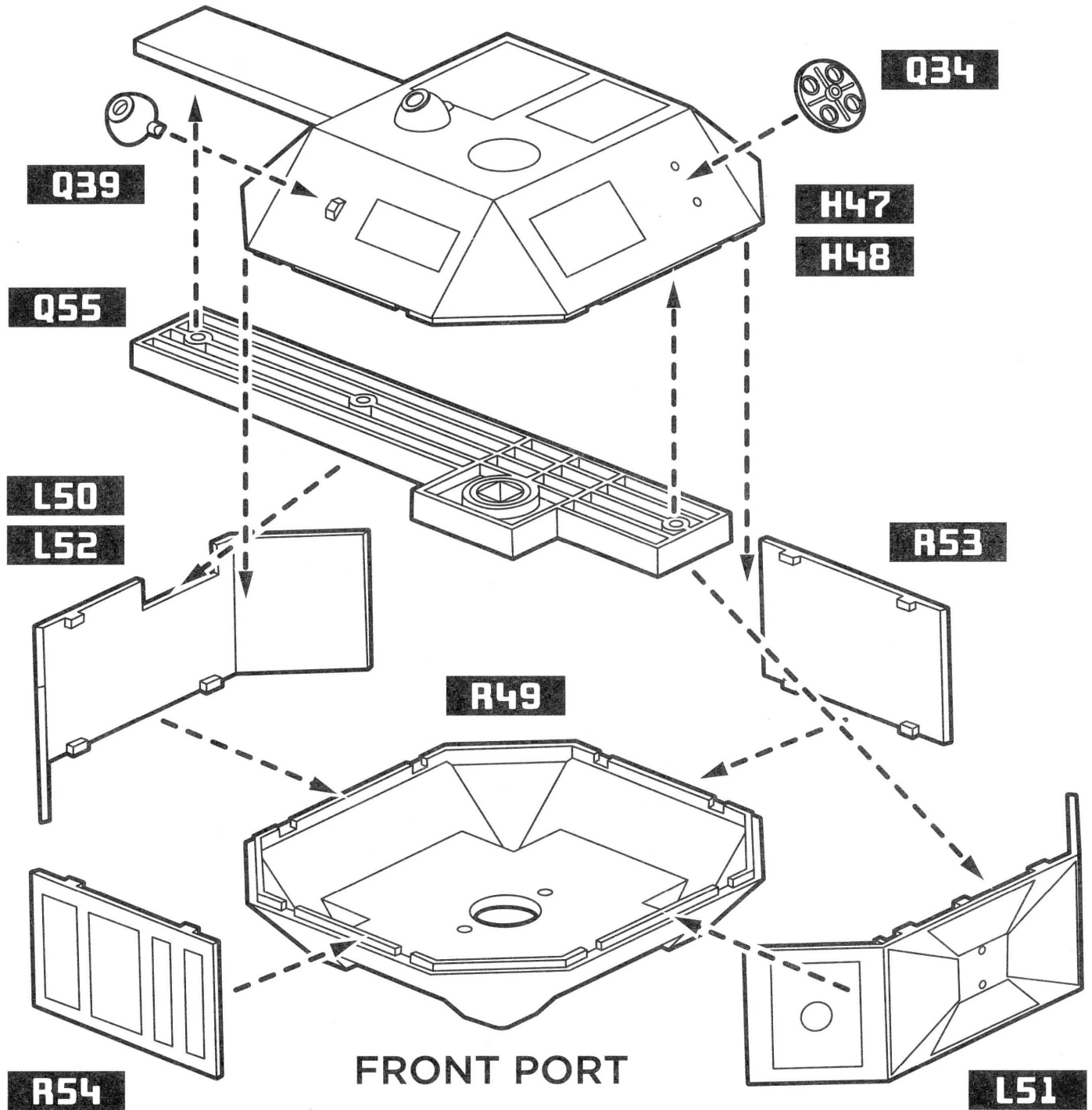

Orient the shoulder pod parts like this.

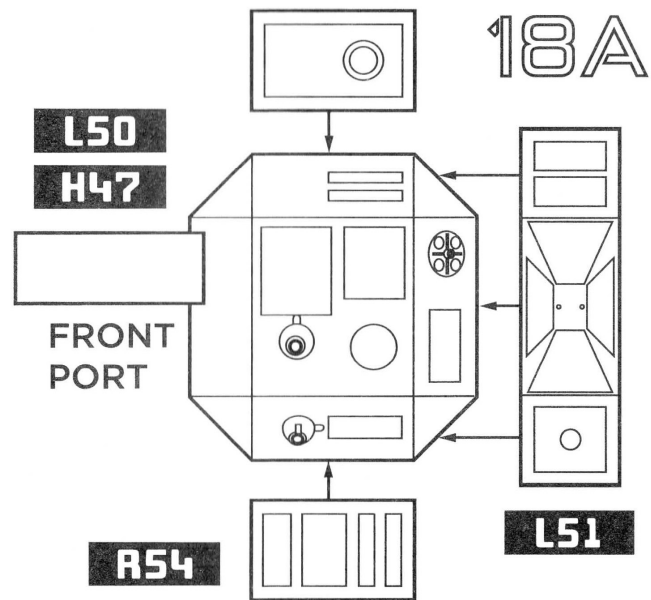
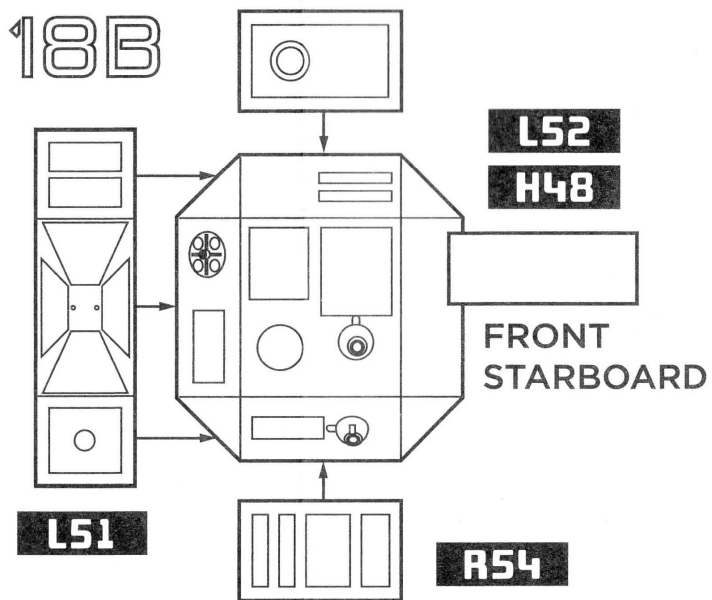
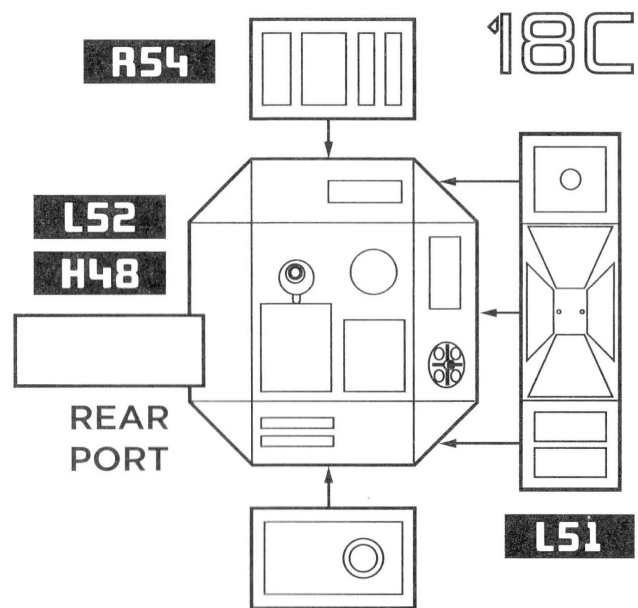
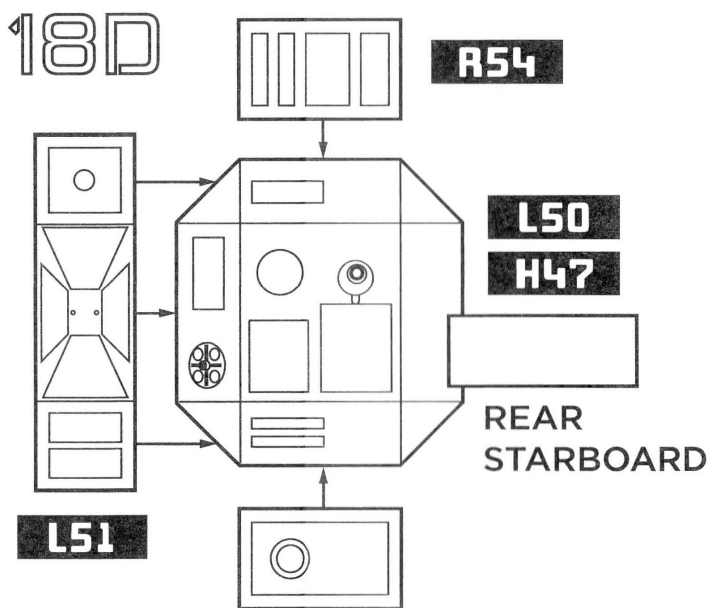

19

x4

R71

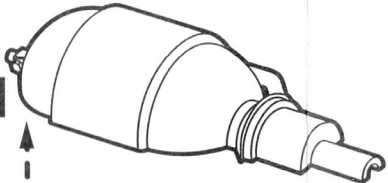

R70

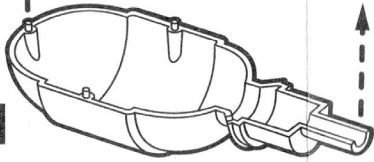

20

x4

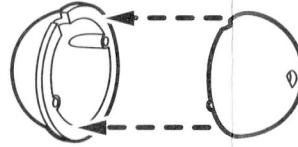

068

069

21

x2



M65

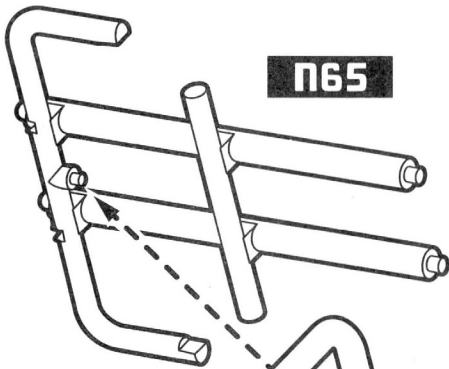

M72



22

B63

M64 x4

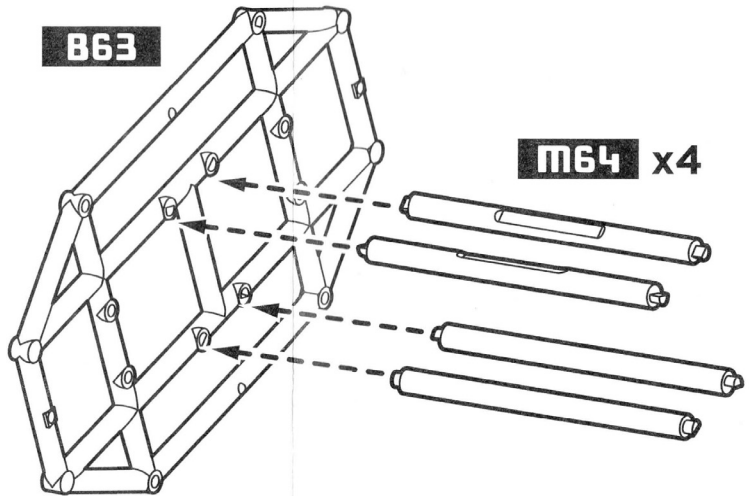

23

21

M67 x4

B75

21

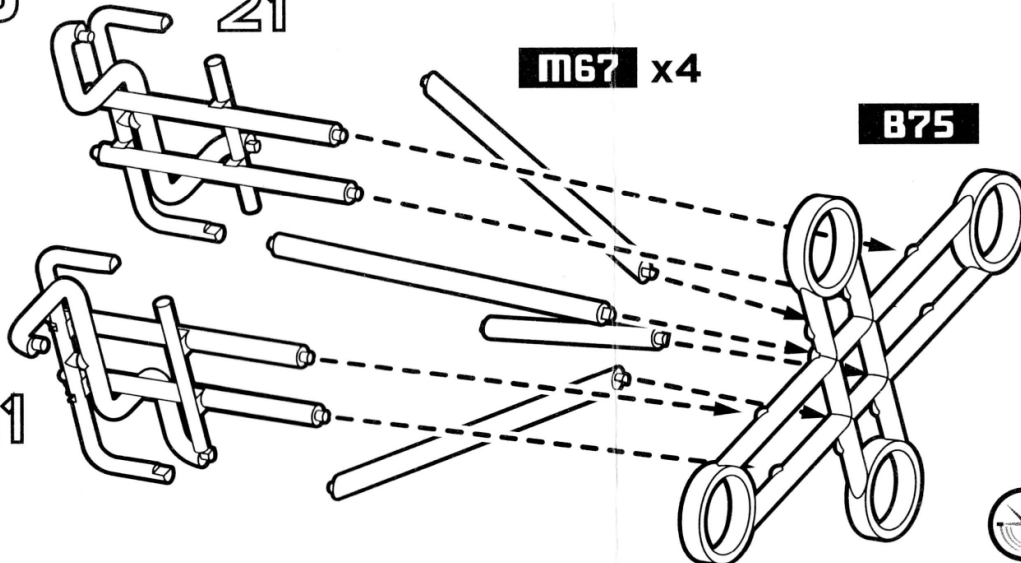

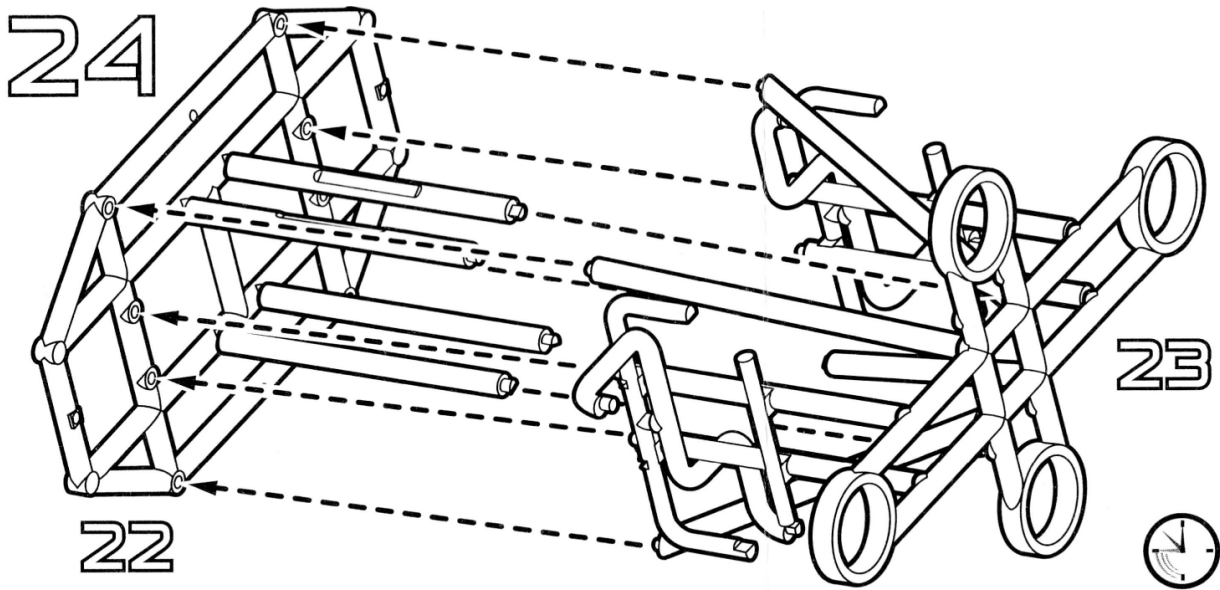

25

Insert assembly 19 into rings in assembly 24 and click back ends into place on the back frame. Rotate assembly 19 until side tubes meet ends of part 72. Then glue in place.

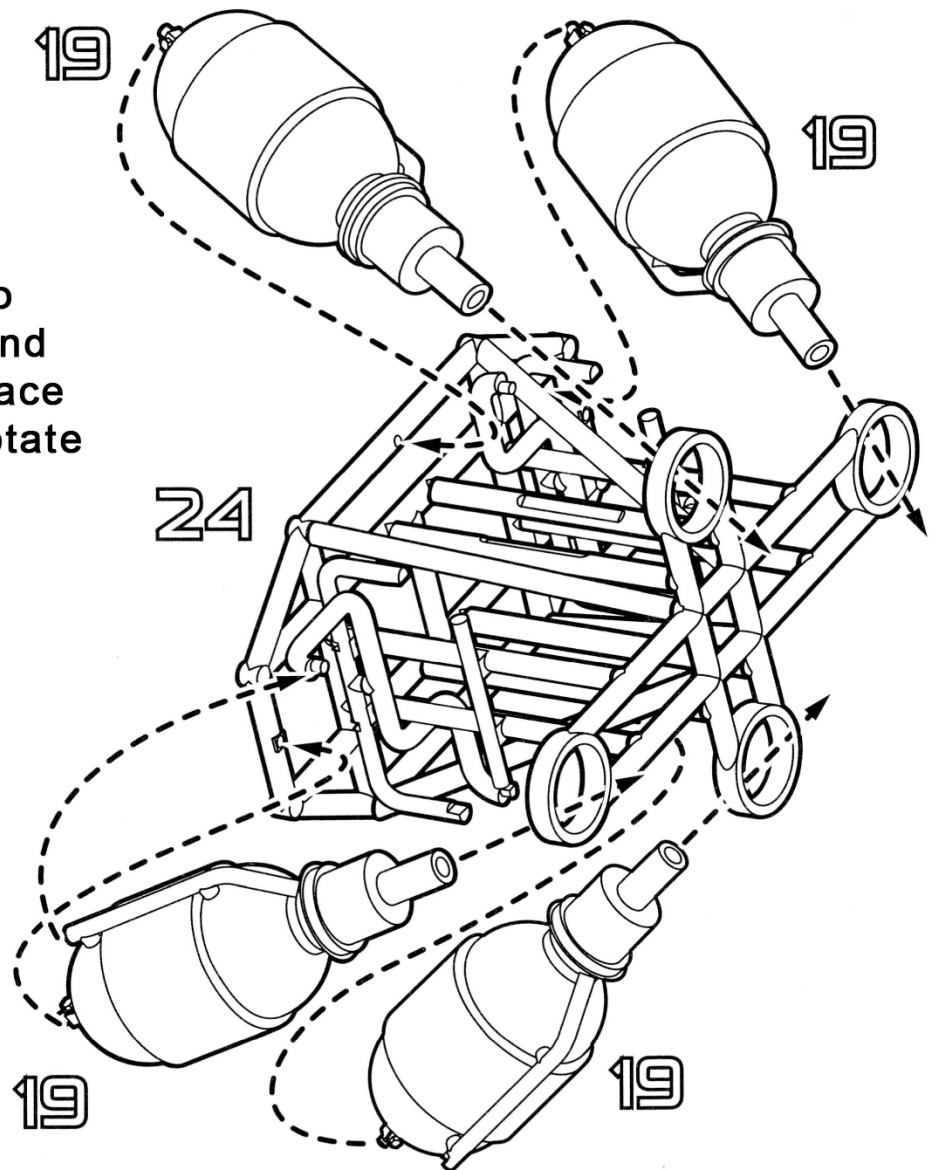

26

Place assembly 20 onto ends of part N65. Then add parts N73 & N74 to assembly 20 and attach other ends to holes in assembly 19.

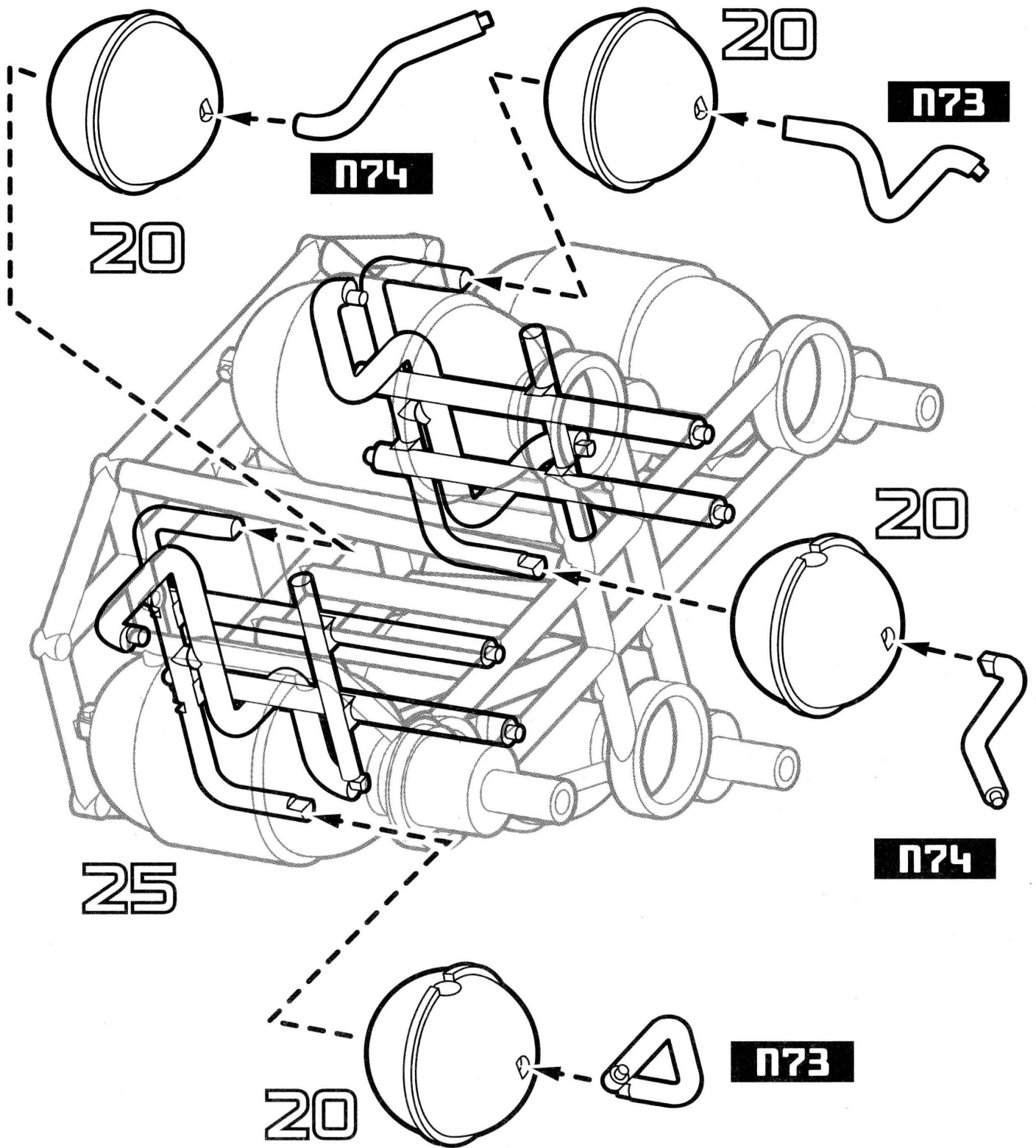

27

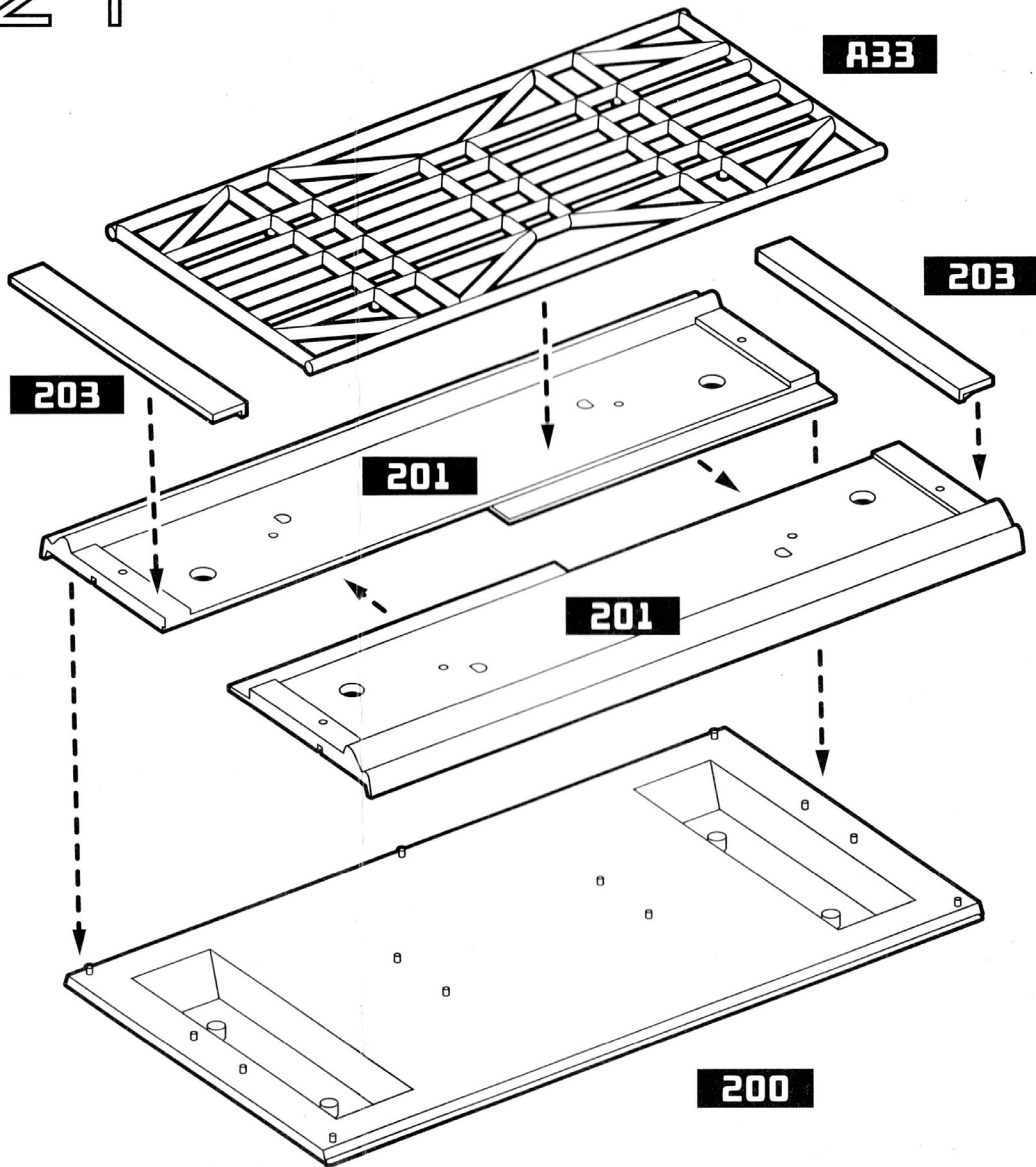

28 x2

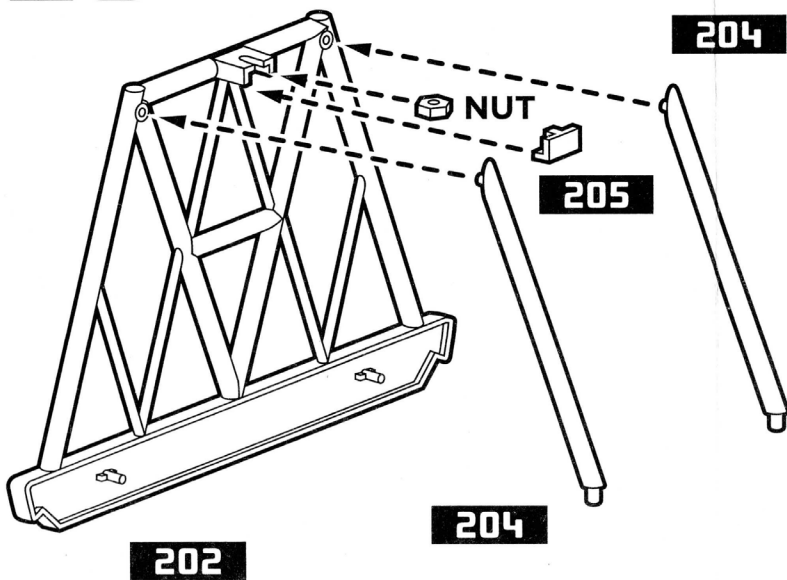

29 x4

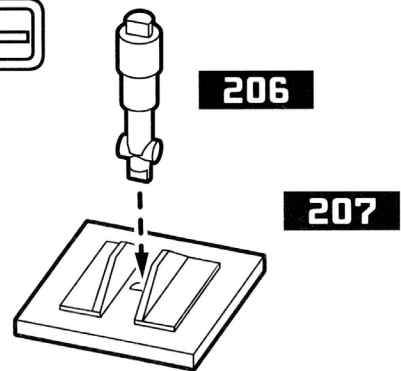

30

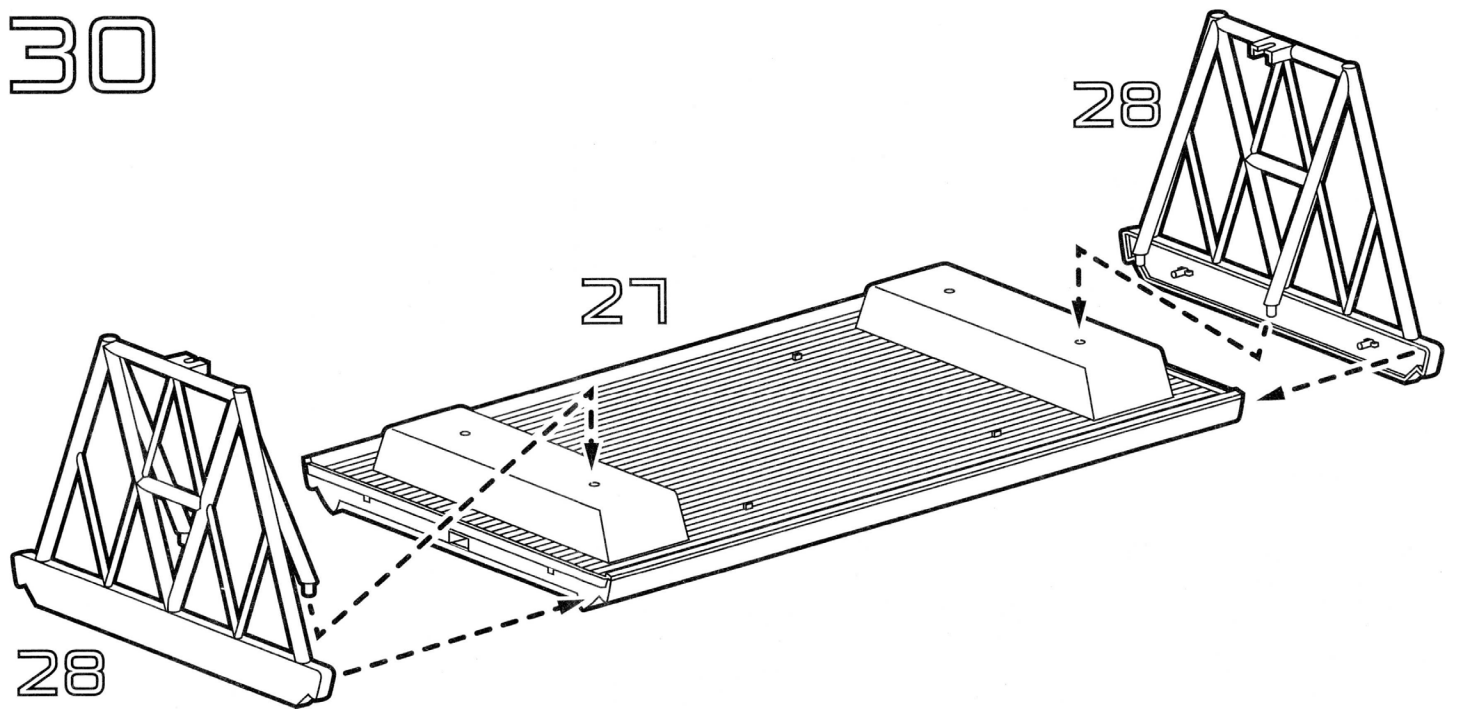

31

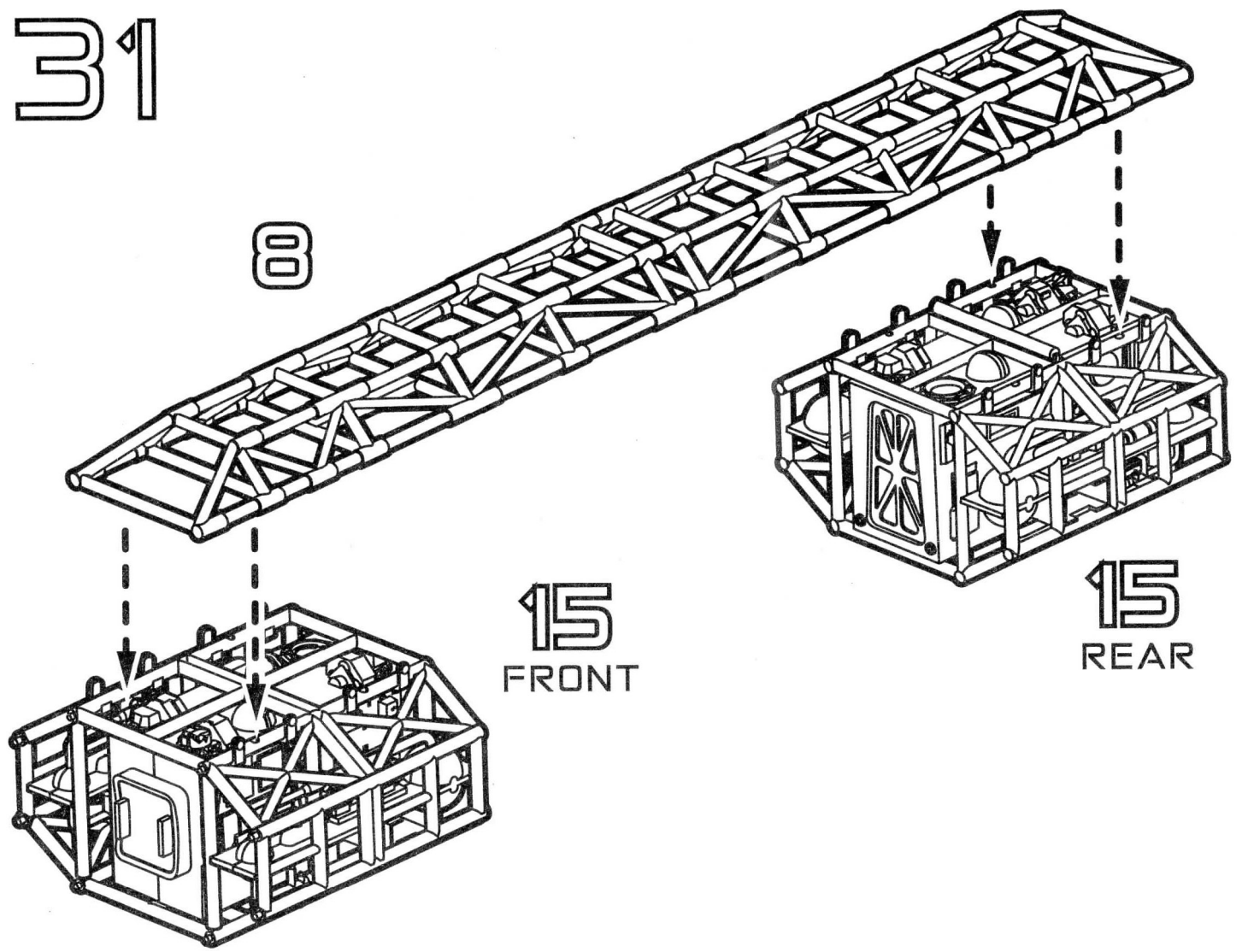

32

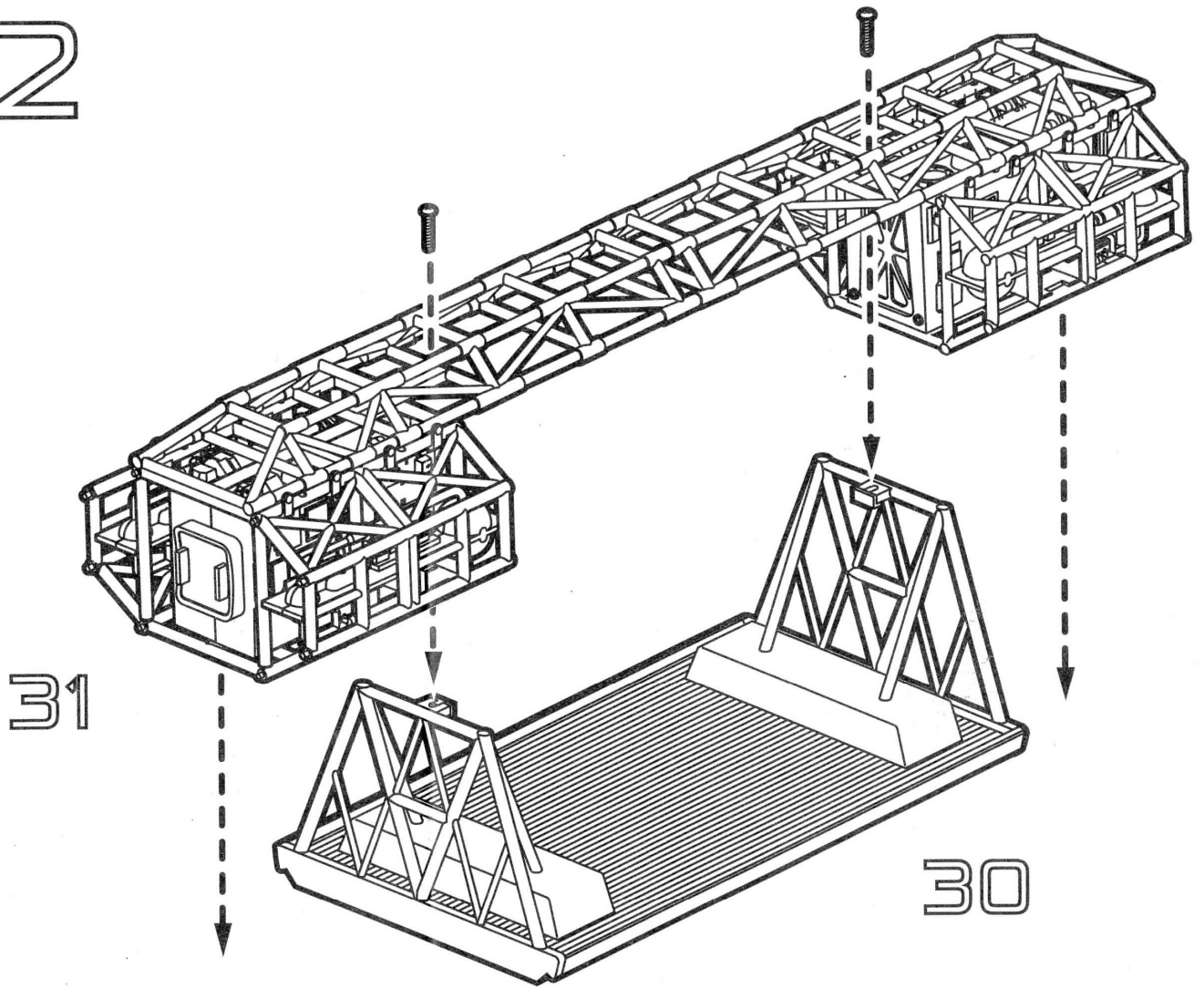

33 x4

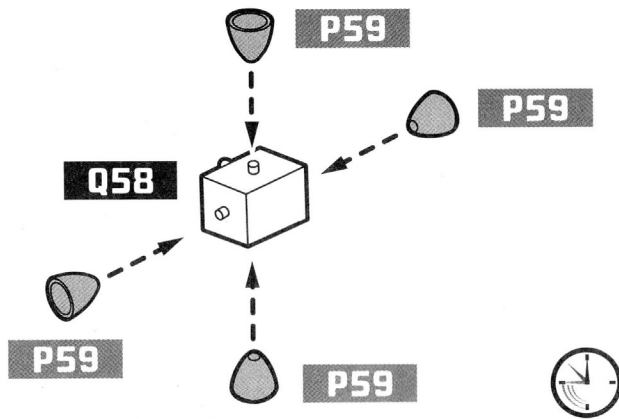

34 x4

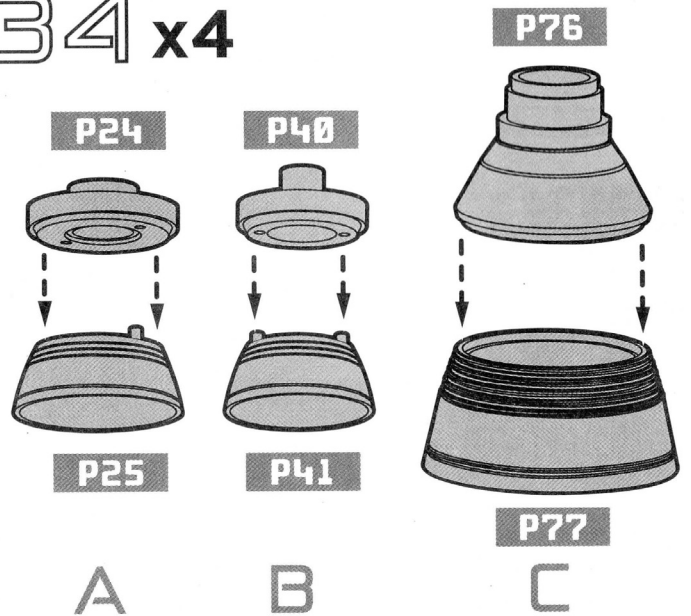

35

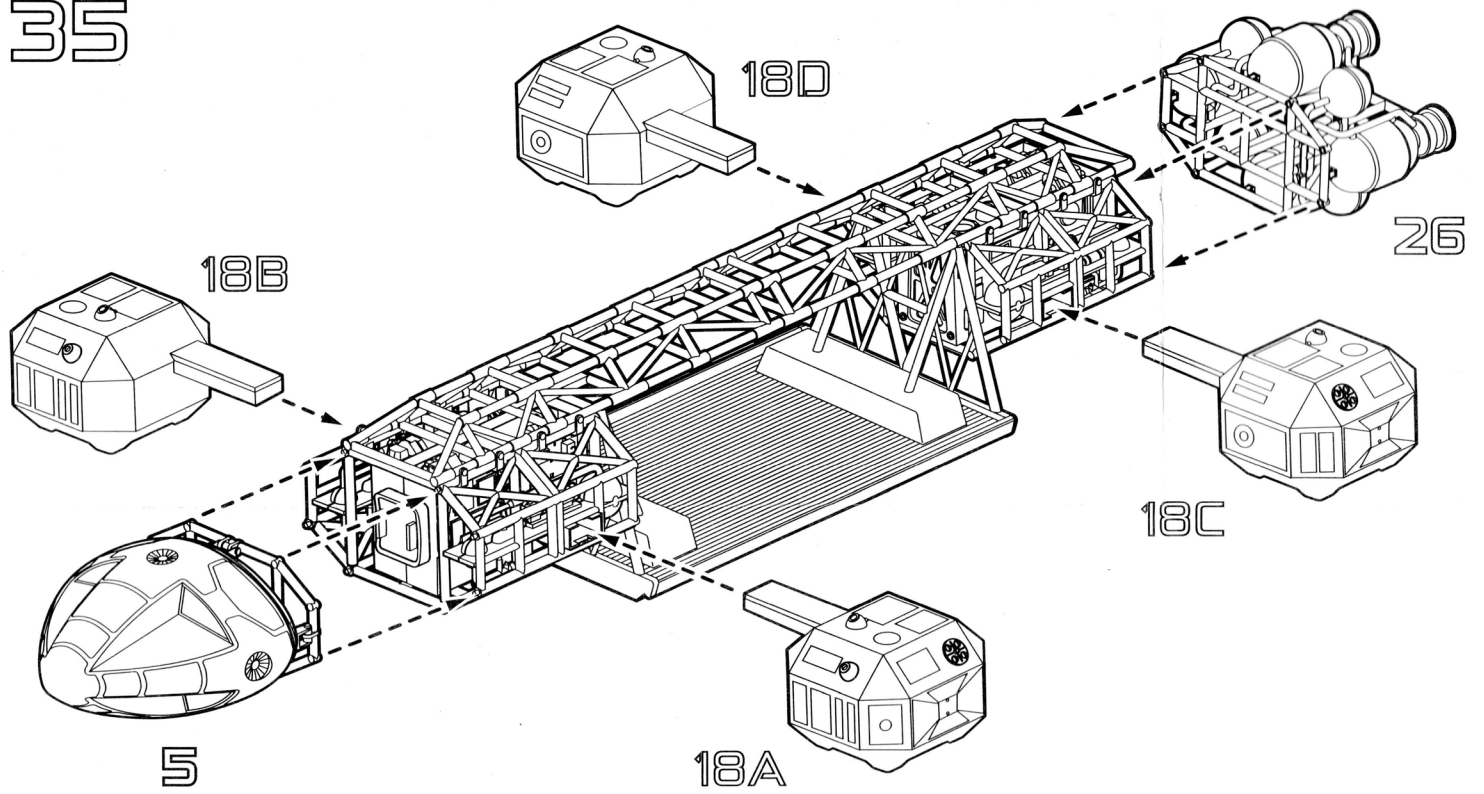

36

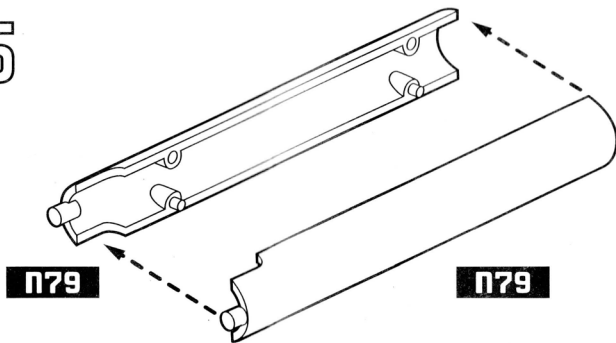

37

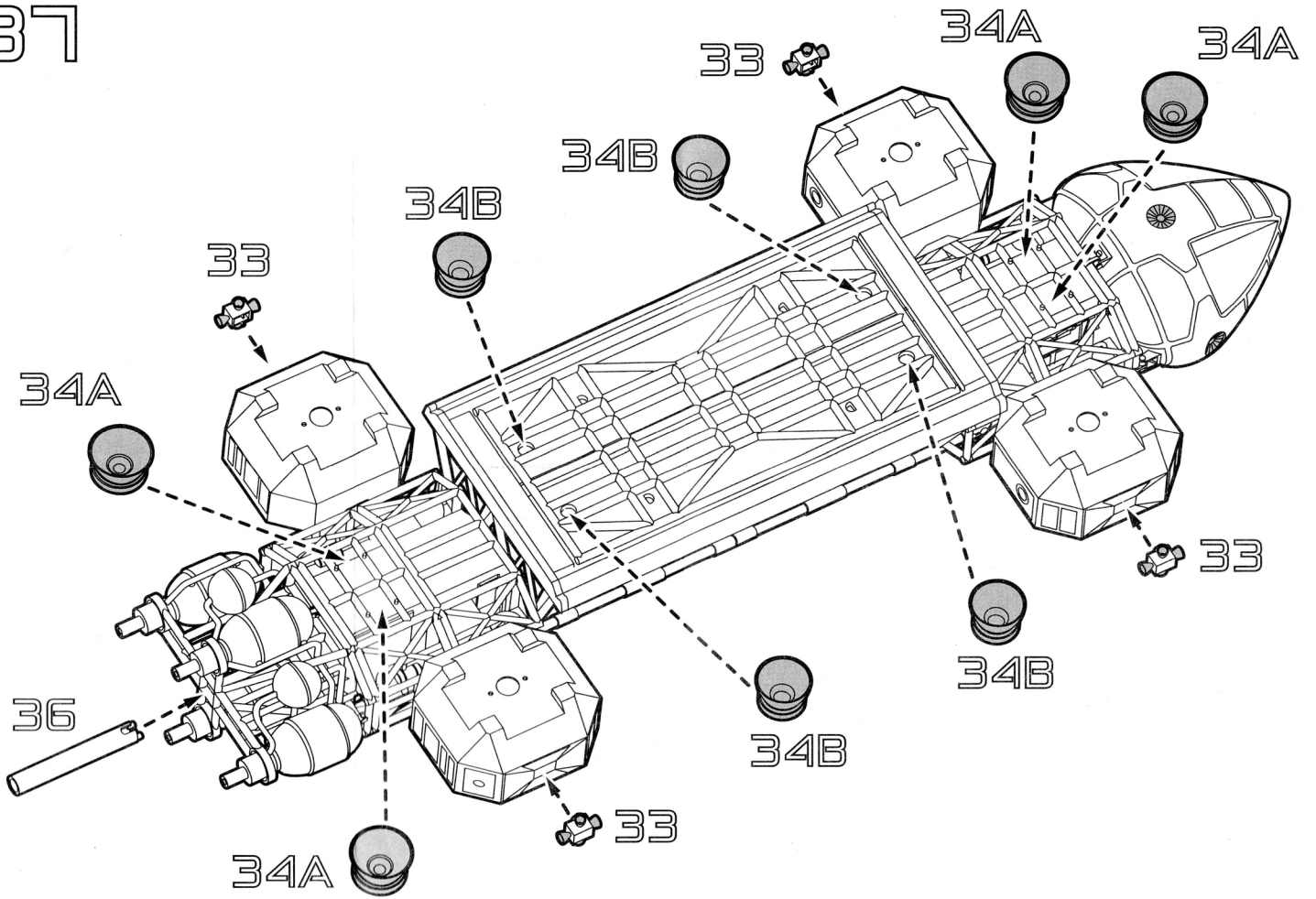

38

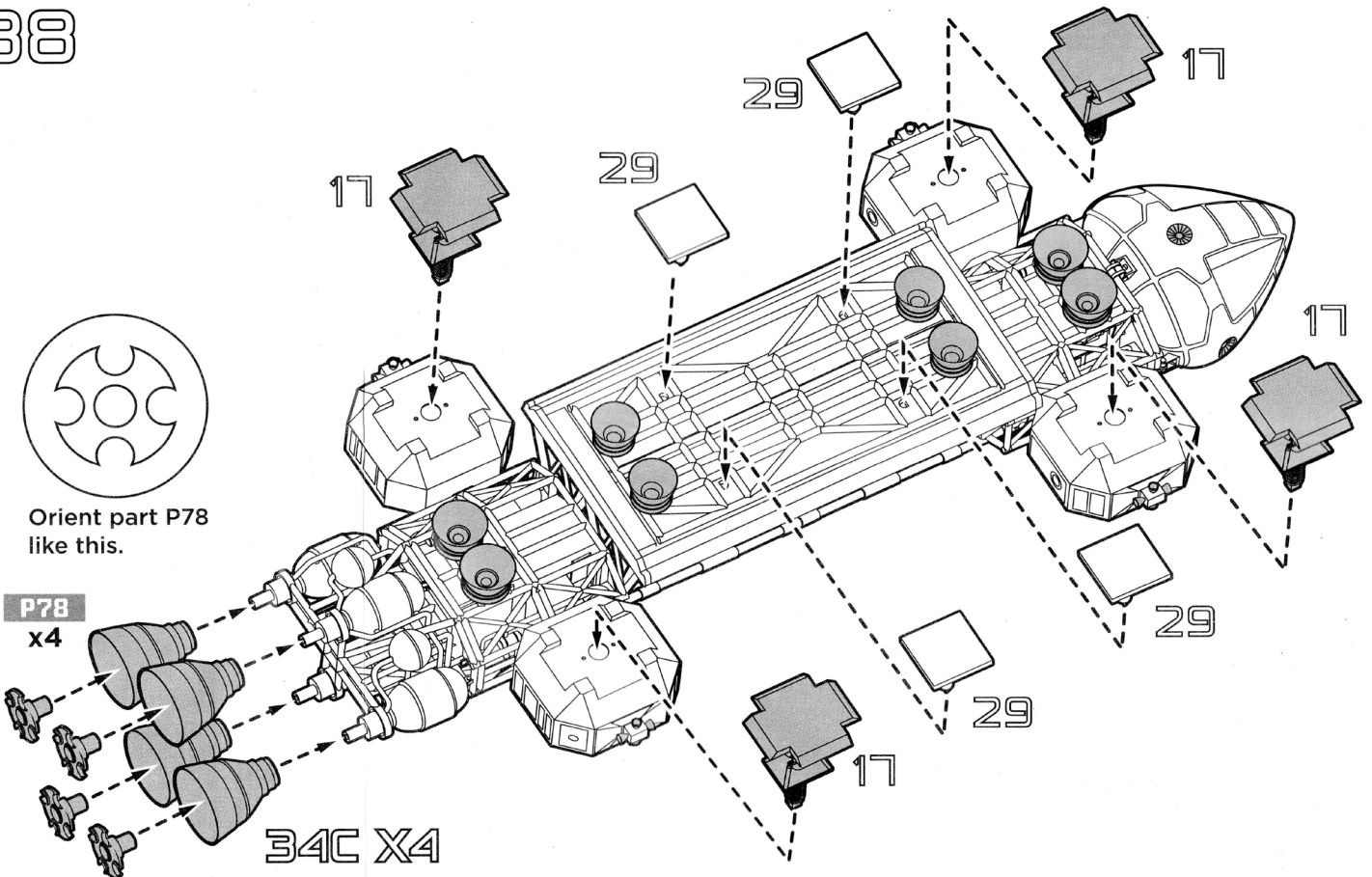

39

208

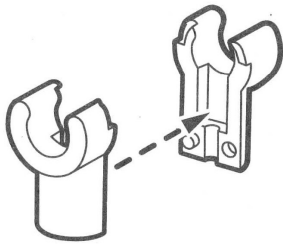

208

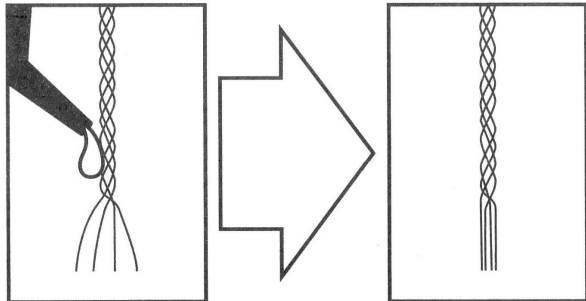

Apply a small amount of glue to the end of the cable and twist the frayed end together. Allow to dry thoroughly.

214

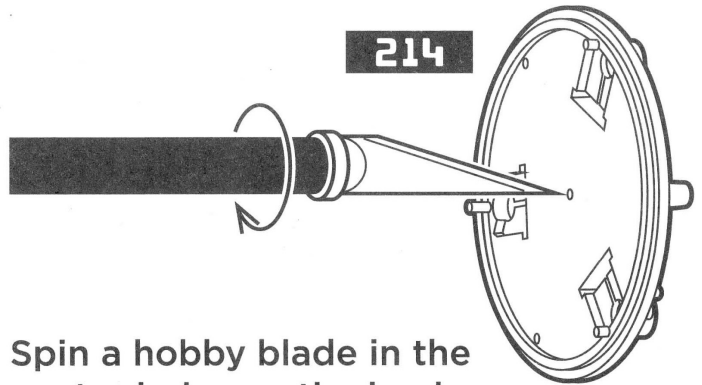

Spin a hobby blade in the center holes on the back sides of parts #213 and #214 to allow a bit of clearance to insert the cable.

213

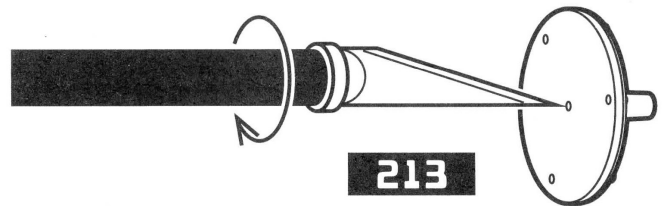

Tie a knot in the end of cable

Pass cable through holes in parts

Tie a knot in the end of cable. Then pull back into cavity in clasp.

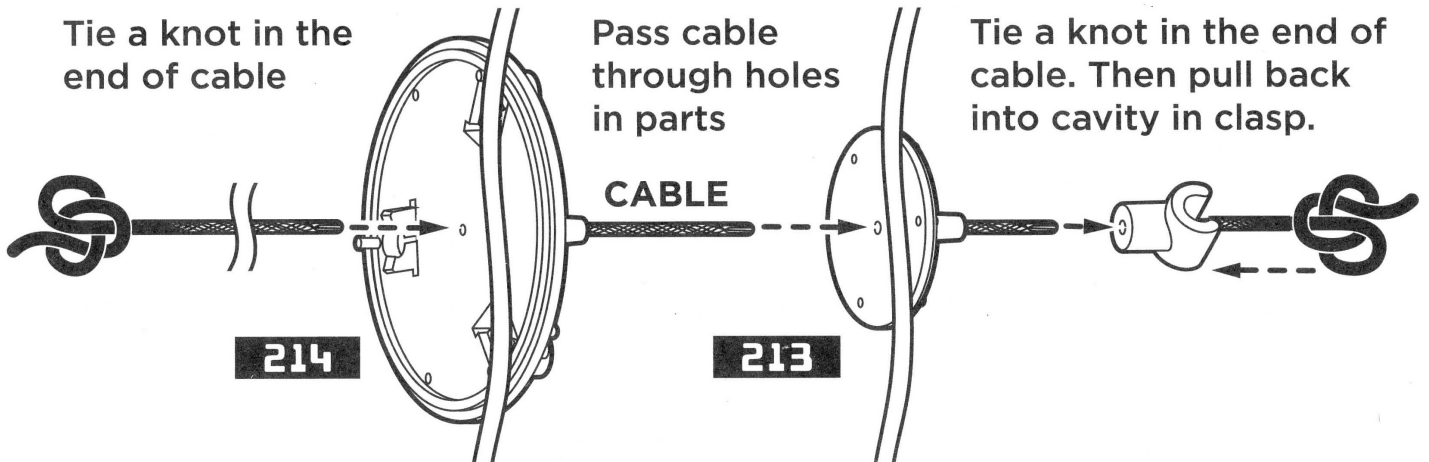

40

Use "super" glue or epoxy to glue in metal wires.

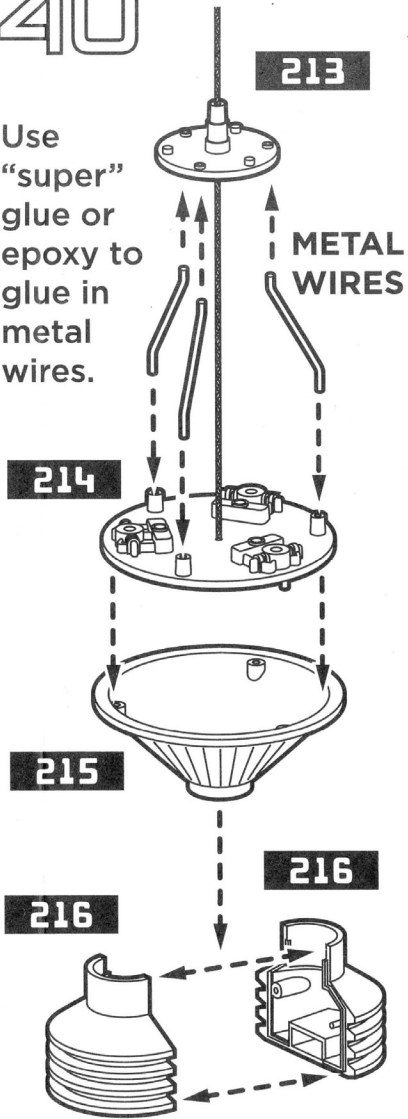

41x4

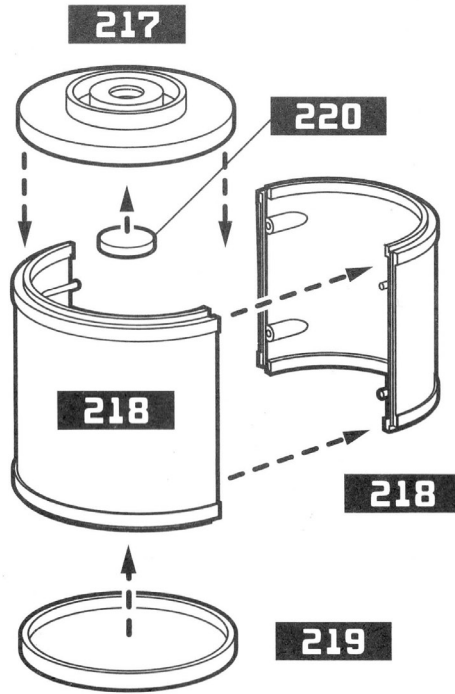

ROUND 5/15" (8mm) x 1/16" (2mm) NEODYMIUM MAGNETS CAN BE ADDED TO STEP 40 & 41 ASSEMBLIES TO HOLD CANISTERS TO BOOM.

42

Grip clasp to center frame bar.

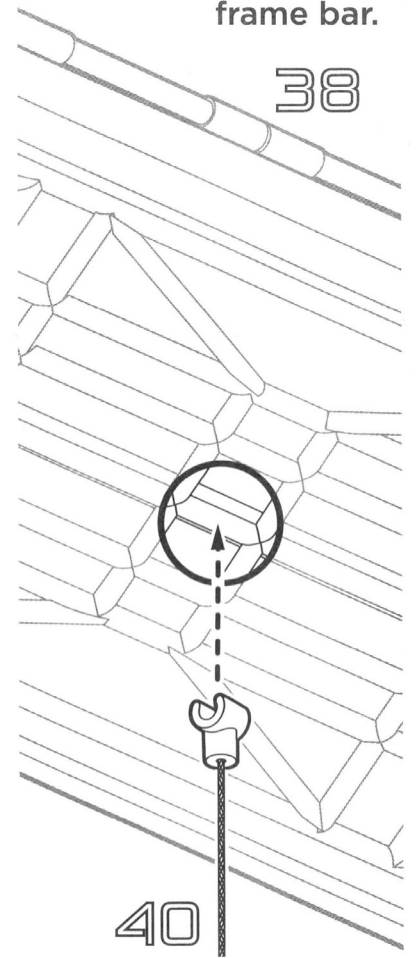

43

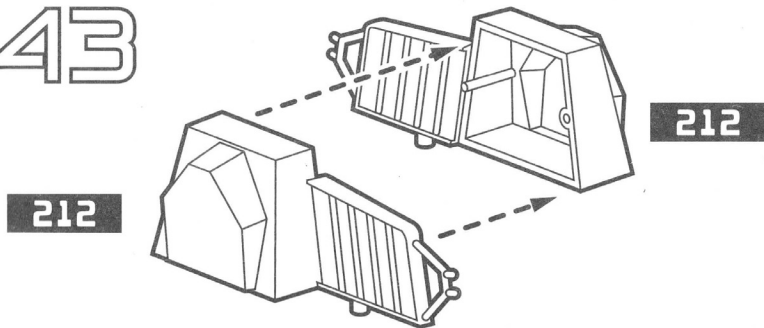

44

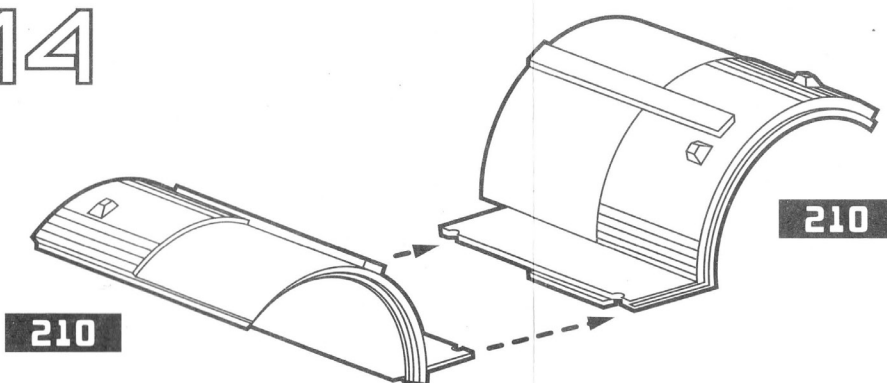

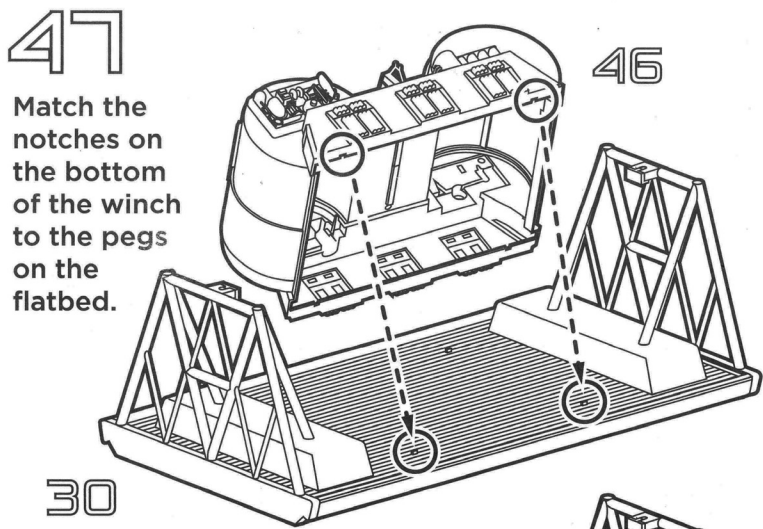
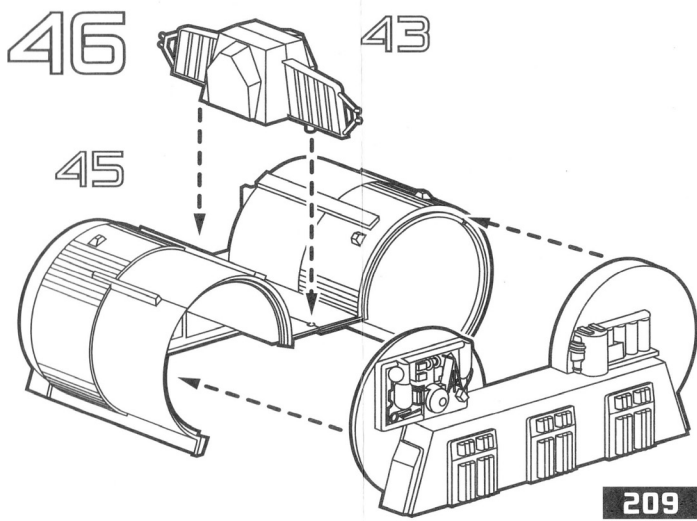
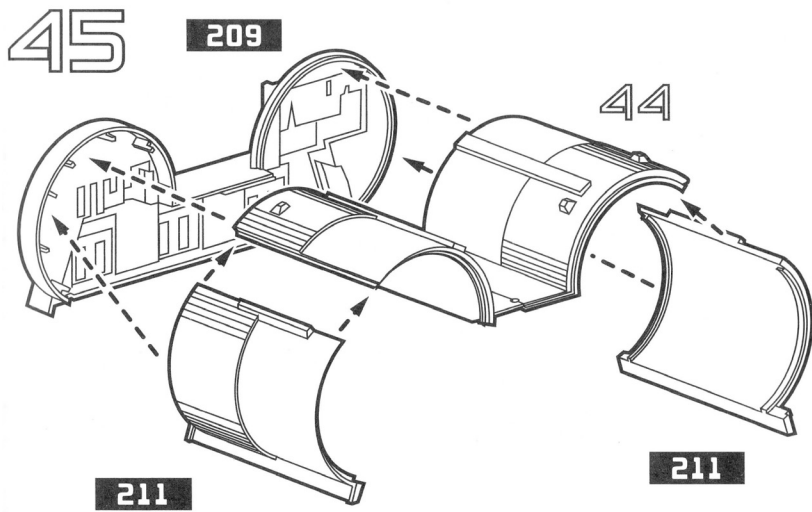

OR

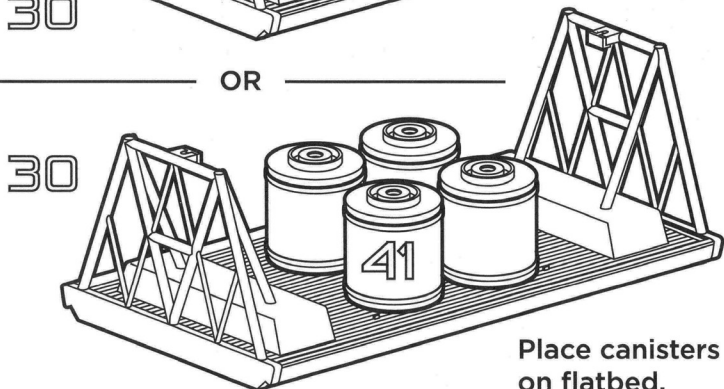

Place canisters on flatbed.