

G.W.H.®

SU-35S

"FLANKER-E"

MULTIROLE FIGHTER SU-35S "侧卫-E" 多用型战斗机



Special thanks for research work by  
Gabor Szekeres and Yufei Mao

1/72 SCALE L7207



**A** Parts x 1

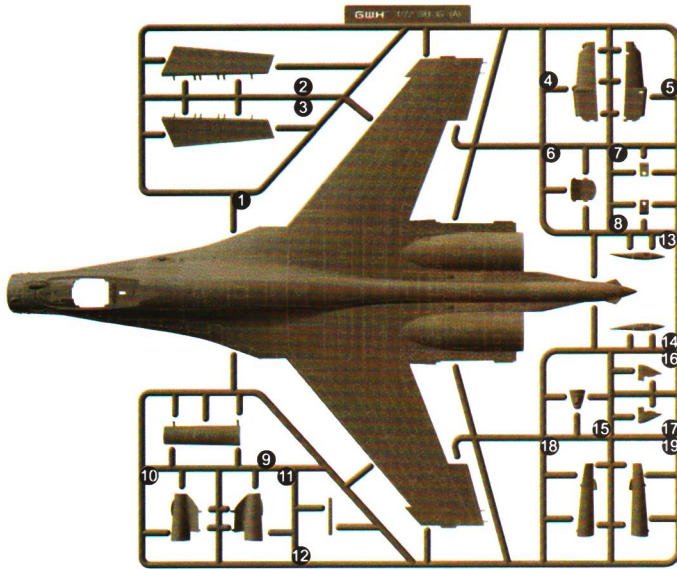

**B** Parts x 1

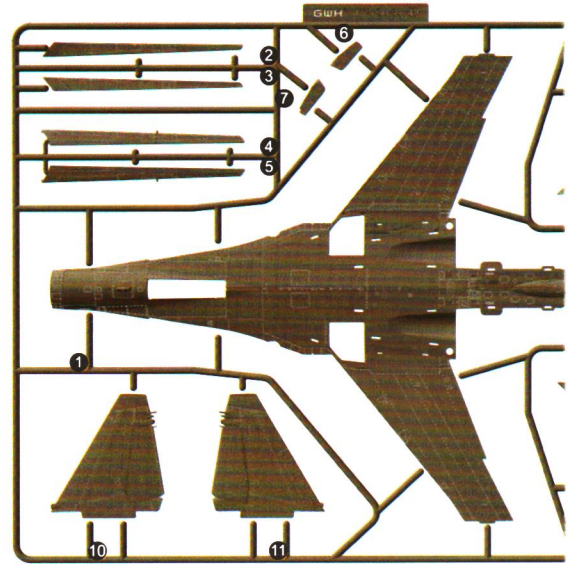

**J** Parts x 1

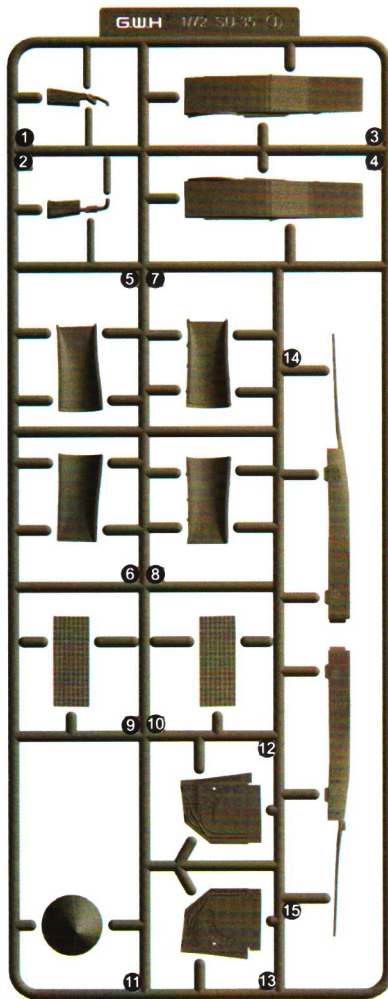

**G** Parts x 2

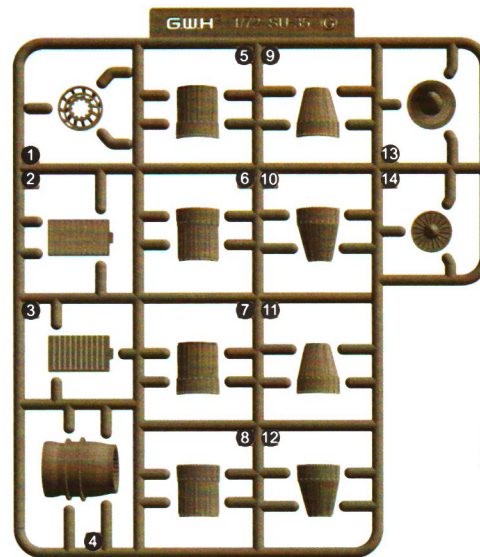

**M** Parts x 1

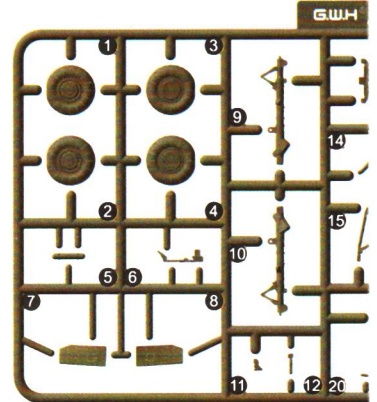

**H** Parts x 2

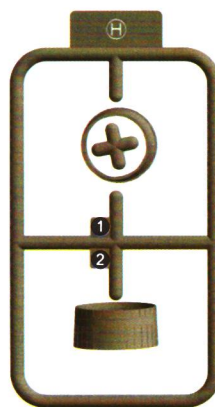

**W** Parts x 2

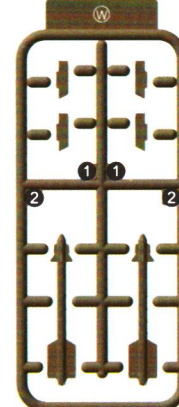

**X** Parts x 1

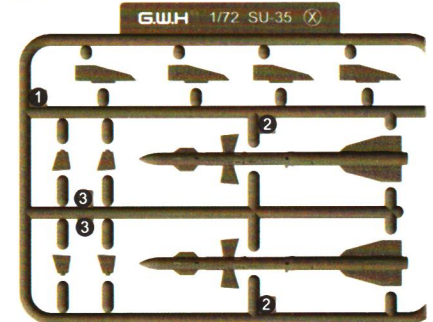

**Q** Parts x 2

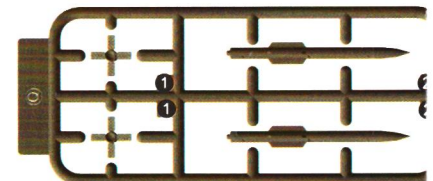



C Parts x 1

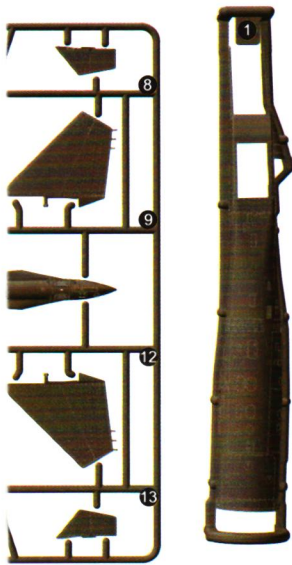

C Parts x 1



D Parts x 1

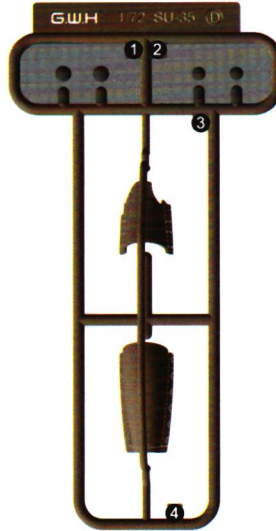

E Parts x 2

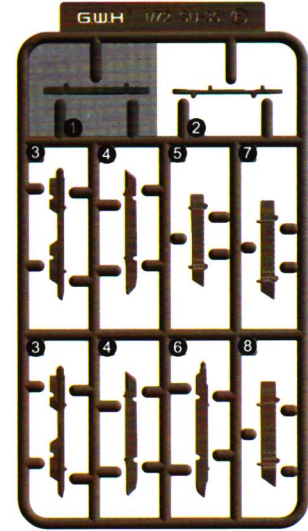

K Parts x 1

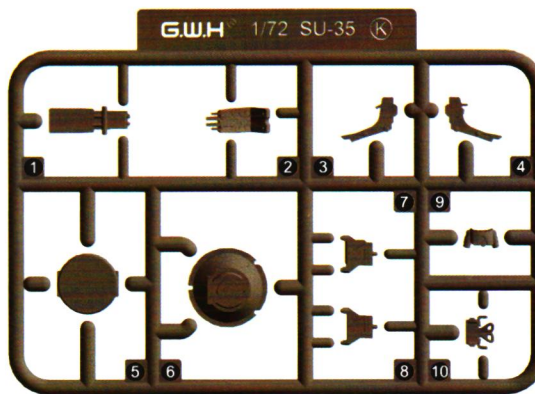
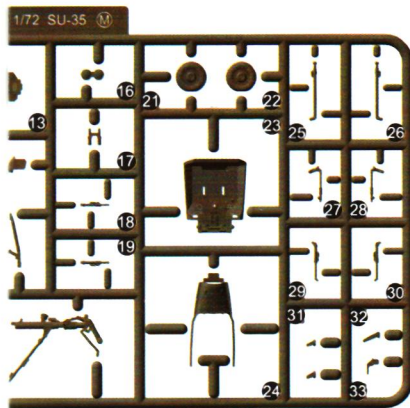

L Parts x 1

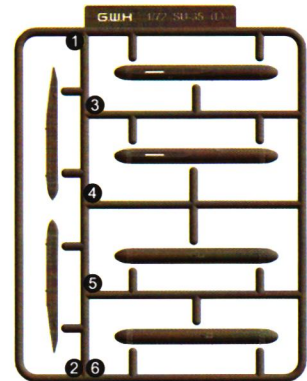

V Parts x 1

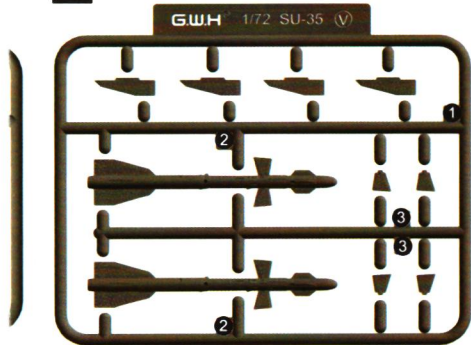

Z Parts x 1

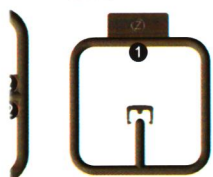

DE

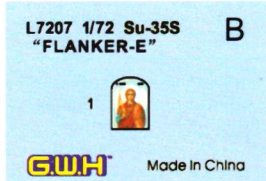

阴影零件不使用  
DO NOT USE THE  
SHADOW PARTS

PE

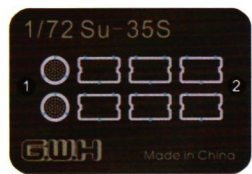

L7207 1/72 Su-35S "FLANKER-E" MULTIROLE FIGHTER

03 03 06 06 25 25 03 06 25 03 06 25

R-27ET/R-27ER 30 31 32 33 34

L-26SM10-02 Khibiny-M 41 42 43 44 45 46 47

AKU-170 48 49 50 51 52 53 54 55

APU-470 73 74 75 76 77 78 79 80 81 82 83 84 85

P-72 56 57 58 59 60 61 62 63 64

Adaptor 86 87

R-77 88 89 90 91 92 93 94 95 96 97 98 99

Left/Right 100 101 102 103 104 105 106 107 108 109 110 111 112 113 114 115 116 117 118 119 120 121 122 123 124 125 126 127 128 129 130 131 132 133 134 135 136 137 138 139 140 141

Top 142 143 144 145 146 147 148 149 150 151 152 153 154 155 156 157 158 159 160 161 162 163 164 165 166 167 168

Bottom 169 170 171 172 173 174 175 176 177 178 179 180 181 182 183 184 185 186 187 188 189 190 191 192 193 194 195 196

Researched by Mr. Gabor Szekeres



注意事項 CAUTION 組み立てのご注意

- (1) 勿于近火处使用胶水或油漆, 并打开窗户保持空气流通。
- (2) 涂料的号码请参考本栏以下的说明。本品本身不包括胶水和涂料。
- (3) 自板件中取出部件时, 应用模型专用剪, 并用介刀或小锉除去多余胶料。
- (4) 各图形的含义可参考本栏以下说明。

- (1) When you use glue or paint, do not use near a open flame, and use in a well-ventilated room.
- (2) See below for the color list. Glue and paint are not included in the kit.
- (3) When you take parts off the runner frame, use the modeling scissors and trim excess plastic with a cutter or a file.
- (4) See below for the meaning of symbols.

- (1) 接着剂や塗料は火の近くで使わないで下さい、使用の際は換気をよくして下さい。
- (2) 塗料指定のは下記のとおりです、接着剂や塗料は入っていませんので別に求めて下さい。
- (3) 部品のランナーから切り離す時は模型用ハサミ等を使い、余分な部分はカッターやヤスリ等で仕上げして下さい。
- (4) 組立図のサインマークは下の説明を御覧下さい。

图形含义 CAUTION マーク

填平 FILL HOLE 穴を埋めて下さい	水印粘紙 APPLY DECAL デカールを貼って下さい	切除 CUT OFF 切り取って下さい	弯折 BEND 折り曲げて下さい	制作两组 MAKE TWO SET 2箇所作って下さい	另一側相同制作 DO THE SAME ON THE OPPOSITE 反対側も取り付けます
胶水 CEMENT 接着して下さい	钻孔 OPEN HOLE 穴を開けて下さい	选择使用 OPTIONAL どちらを選んで下さい	不用胶水 NO CEMENT 接着しないで下さい	注意 BE CAREFUL 注意して下さい	瞬間胶 INSTANT GLUE FOR METAL 瞬間接着剂 (金属用)

所使用工具 RECOMMENDED TOOLS 専用工具

塑胶件用模型胶水 Cement プラスチック用接着剂	模型用剪钳 Side cutters 模型用ニッパー	模型用镊子 Tweezers ピンセット
模型用瞬間胶水 Instant Cement 瞬間接着剂	模型用刻刀 Modeling knife 模型用ナイフ	模型用锉刀 Diamond file 模型用ヤスリ

水贴纸使用说明·DECAL APPLICATION スライドマークの貼り方

- (1) 用模型剪刀或刻刀切下所需的图案部分。
- (2) 将水贴纸浸泡在温水中10秒左右取出放置于干水的干布上。
- (3) 手拿着水贴纸基的一角, 用模型镊子小心夹住浮起的水贴图案移至模型表面准确位置。
- (4) 用手指适当沾水均匀涂于水贴图案表面, 使其延展移动到精确位置。
- (5) 用柔软吸水的干布将水贴图案中的气泡向一边挤出, 使水贴在模型表面保持平整。

- (1) Cut off decal from sheet.
- (2) Dip the decal in tepid water for about 10 sec. and place on a clean cloth.
- (3) Hold the backing sheet edge and slide decal onto the model.
- (4) Move decal into position by wetting decal with finger.
- (5) Press decal down gently with a soft cloth until excess water and air bubbles are gone.

- (1) 貼りたいマークをハサミで切り抜きます。
- (2) マークをぬるま湯に10秒ほど浸してからタオル等の布の上に置きます。
- (3) 台紙のはしを手で持ち、貼るところにマークをスライドさせてモデルに移して下さい。
- (4) 指に少し水を付けてマークを濡らしながら、正しい位置にずらしします。
- (5) 柔らかな布でマークの内側の水泡を押し出しながら、押しつけるようにして水分をとります。

蚀刻片使用说明 PHOTO-ETCHED PARTS エッチングパーツ

- (1) 使用蚀刻片专用剪刀或模型专用刻刀将蚀刻片零件切割下待用。
  - (2) 切割下的零件上有蚀刻片的残留连接点部分, 使用模型专用锉刀细心打磨干净。
  - (3) 蚀刻片部分在涂装之前必须使用专用的模型金属底漆打底。
- 注意事项: 蚀刻片很薄外延较为尖锐, 有刮伤手的可能, 在使用之时请务必小心。

- (1) Cut off photo-etched parts using a modeling knife.
  - (2) Carefully remove any excess using a file.
  - (3) Apply metal primer prior to painting.
- Attention, please: Extra care should be taken to avoid personal injury when handling photo-etched parts.

- (1) 切り離す時はカッターナイフを使用してパーツを切り離します。
  - (2) 切り出した時、部品に出張った部品が残っている場合は、ヤスリなどで丁寧に削り落とします。
  - (3) 塗装が必要なパーツは下地にメタルプライマーを吹着けてから塗装します。
- ご注意: エッチングパーツは大変薄く、手などを切り恐れがあります。取扱いには十分注意して下さい。

涂装色表 PAINT REQUIRED カラー番号リスト

■ C|000 GSI CREOS Mr.COLOR ■ 00-000 ACRYLICOS VALLEJO ■ FS00000 联邦色号

C 1 亮光白 White	C 28 黑铁色 Black iron	C 56 明灰绿 Gray green	C 117 RLM76浅蓝 Rim76 blue
C 2 亮光黑 Black	C 31 舰灰色 Ship gray	C 60 RLM02灰 Rim02 Gray	C 136 消光绿 Nero Green
C 3 亮光红 Red	C 32 军舰灰 Ship gray	C 61 烧铁色 Burning iron color	C 301 FS36081灰 FS36081 Gray
C 4 亮光黄 Yellow	C 33 消光黑 Nero nemesis	C 66 亮光绿 Light green	C 306 FS36270灰 FS36270 Gray
C 8 亮光银 Silver	C 35 明灰白 Bright Grey white	C 73 飞机灰 Plane gray	C 308 FS36375灰 FS36375 Gray
C 13 灰色 Blue	C 45 帆布色 Sail color	C 74 天空蓝 Sky blue	C 311 FS36622灰 FS36622 Gray
C 20 浅蓝 light blue	C 47 透明红 Clear red	C 79 朱红色 Red	C 315 FS16440灰 FS16440 Gray
C 25 暗海灰 Dark grey sea	C 50 透明蓝 Clear blue	C 115 RLM65浅蓝 Rim65 blue	C 316 FS17875白 FS17875 White

C 319 薄松叶色 Rim76 blue	
C 338 FS36495灰 Nero Green	
C 393 茄子色 Eggplant	
SM01 超级银色 Supper silver	
SM03 超级熟铁色 Super metallic	
SM06 超级烙银色	
GX 109 透明棕色 Clear color	



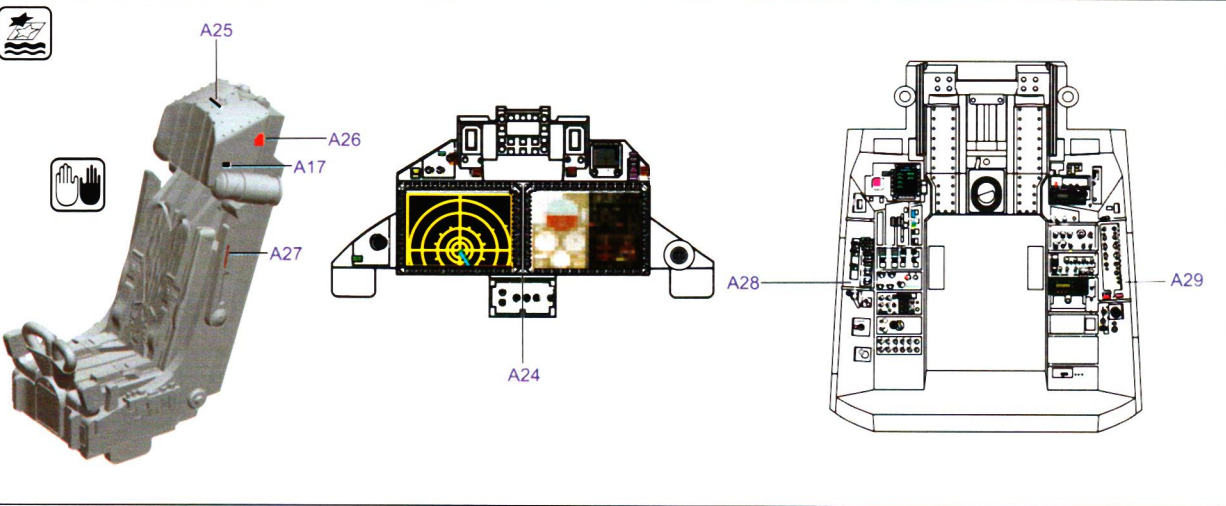
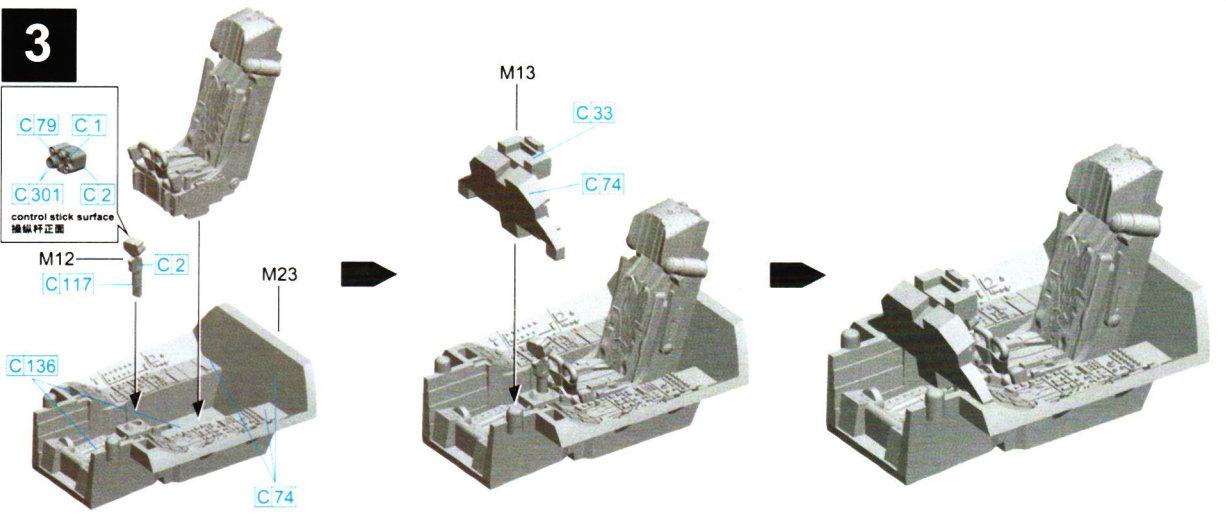
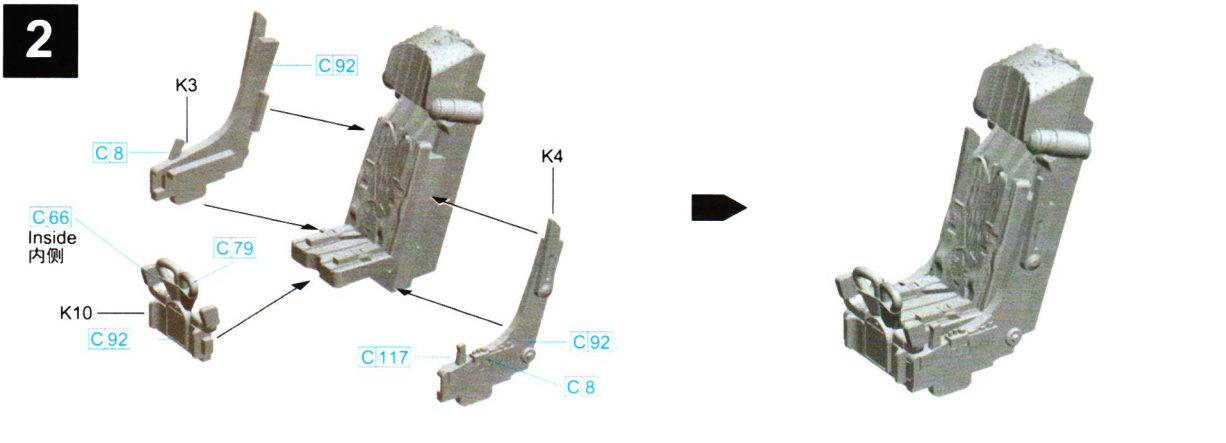
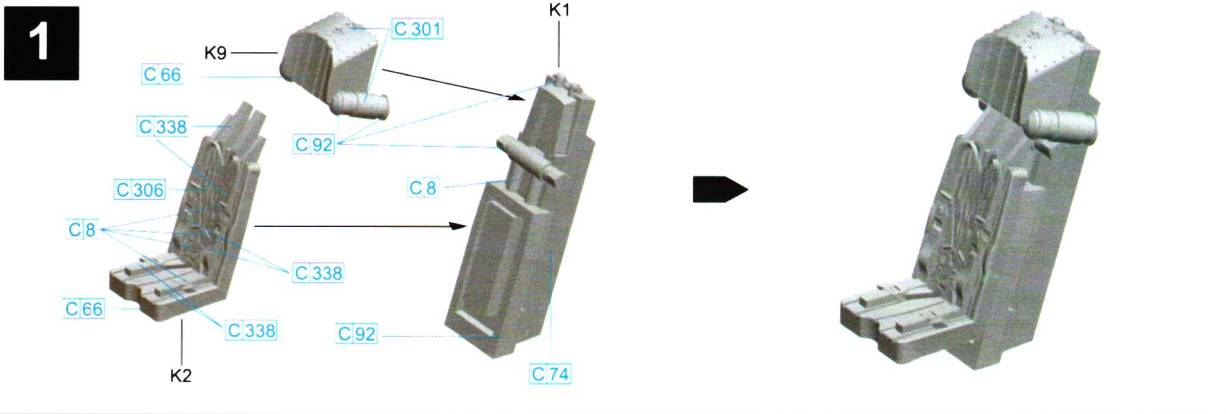



4

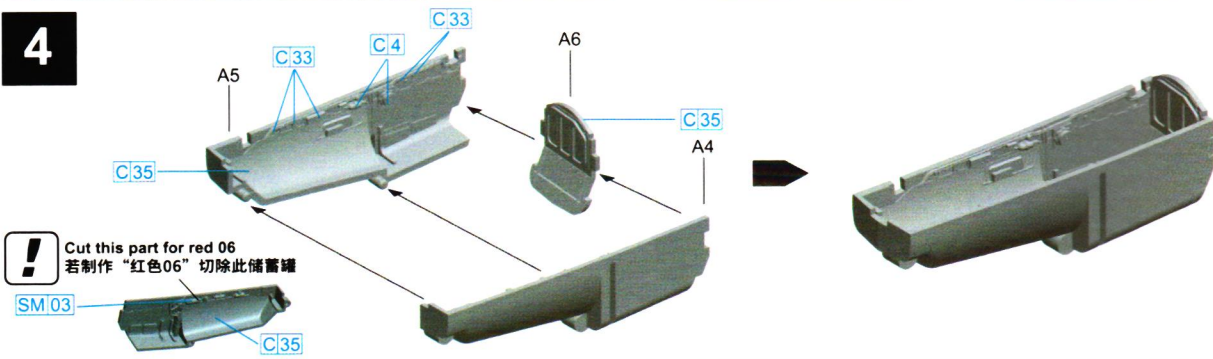

5

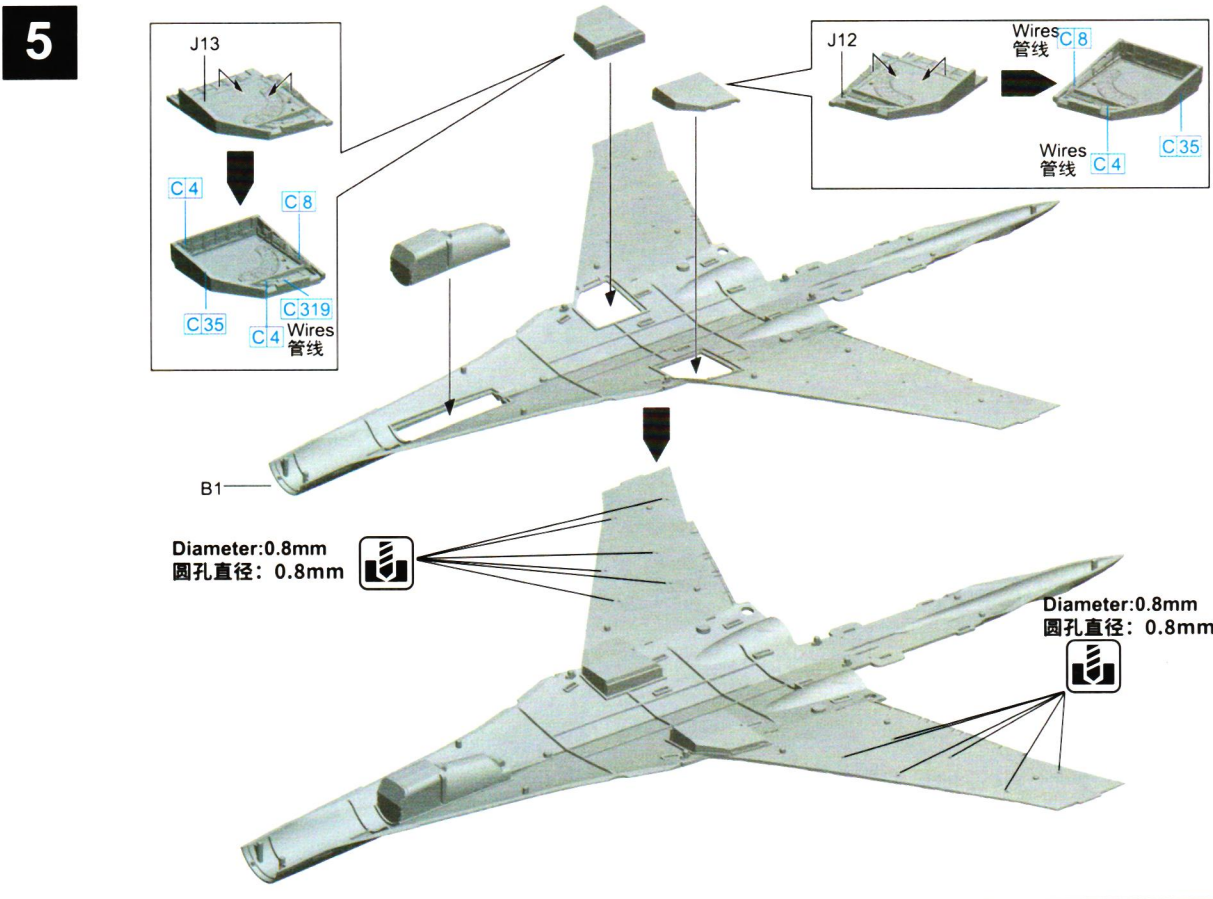

6

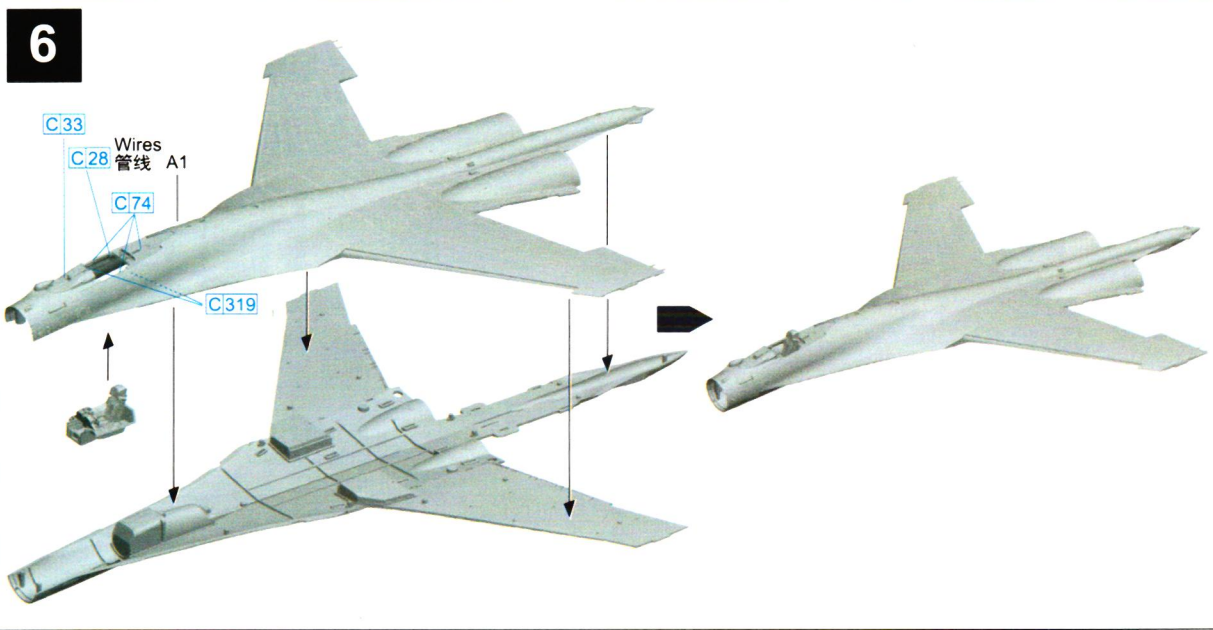



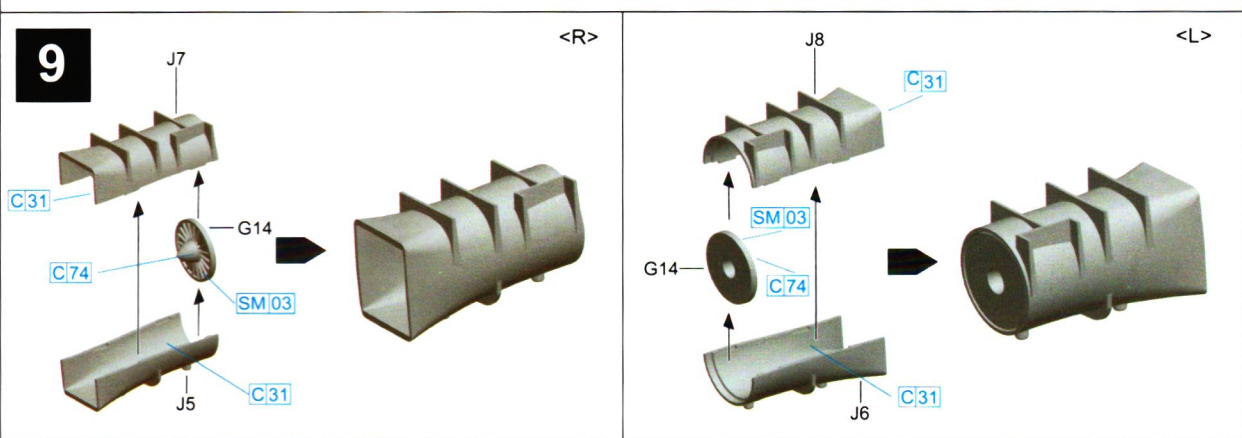
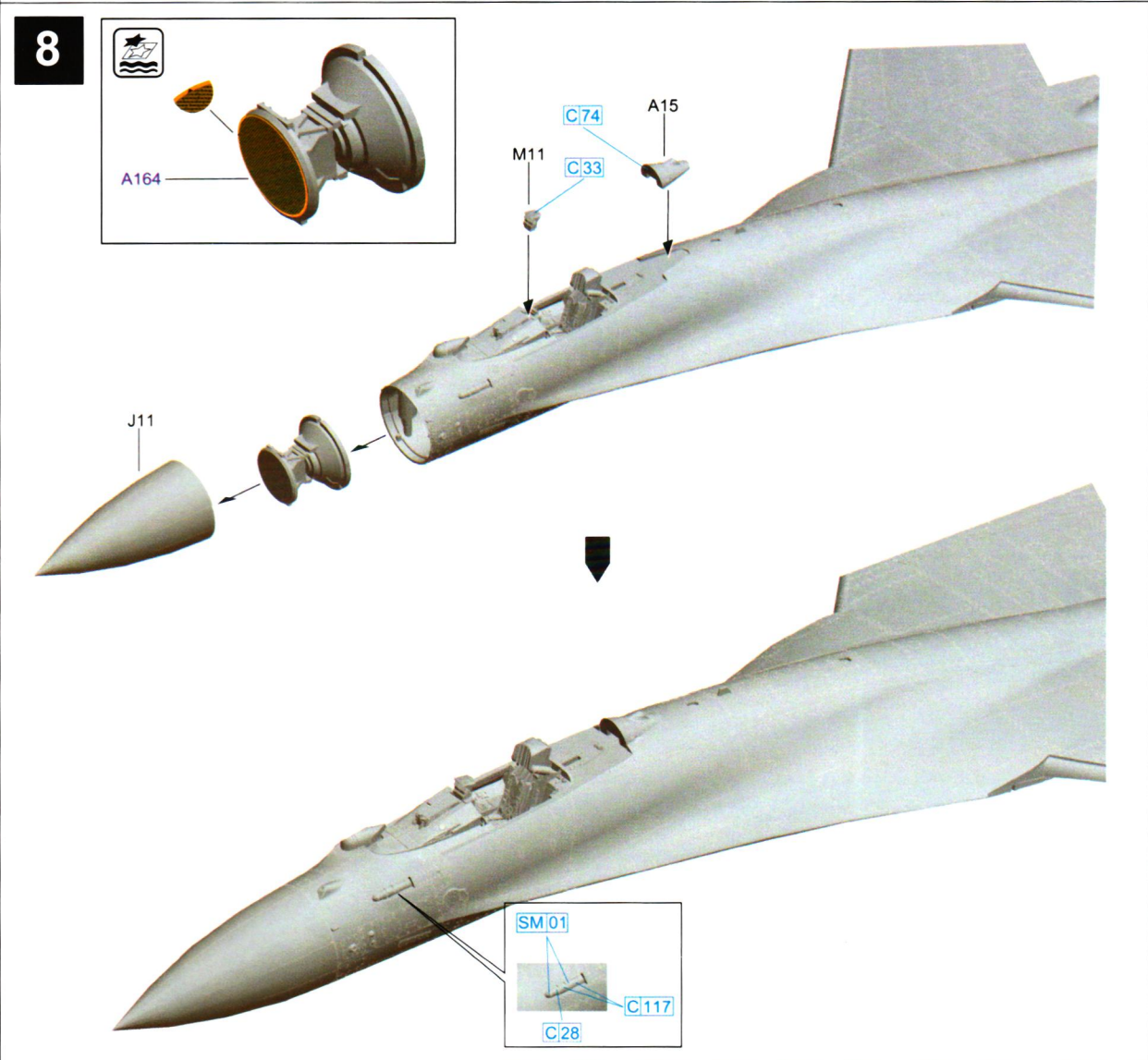
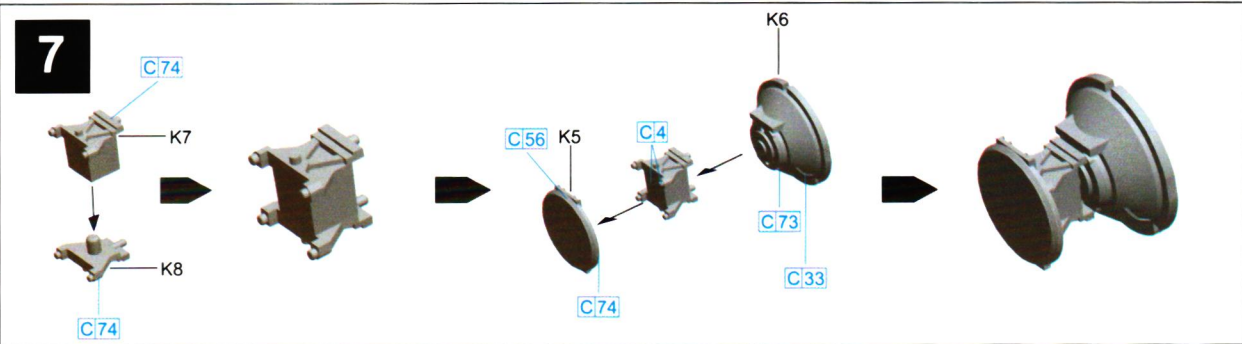



# 10

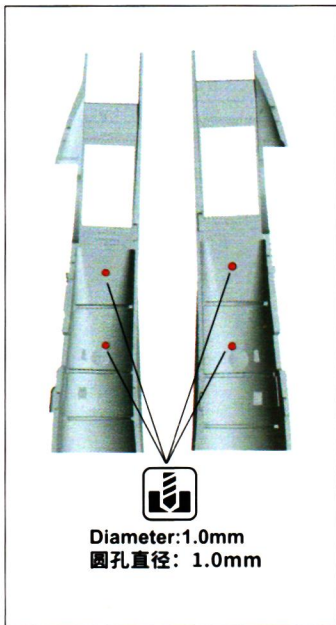

Serial ramber  
生产序列号

- A161
- A162
- A163

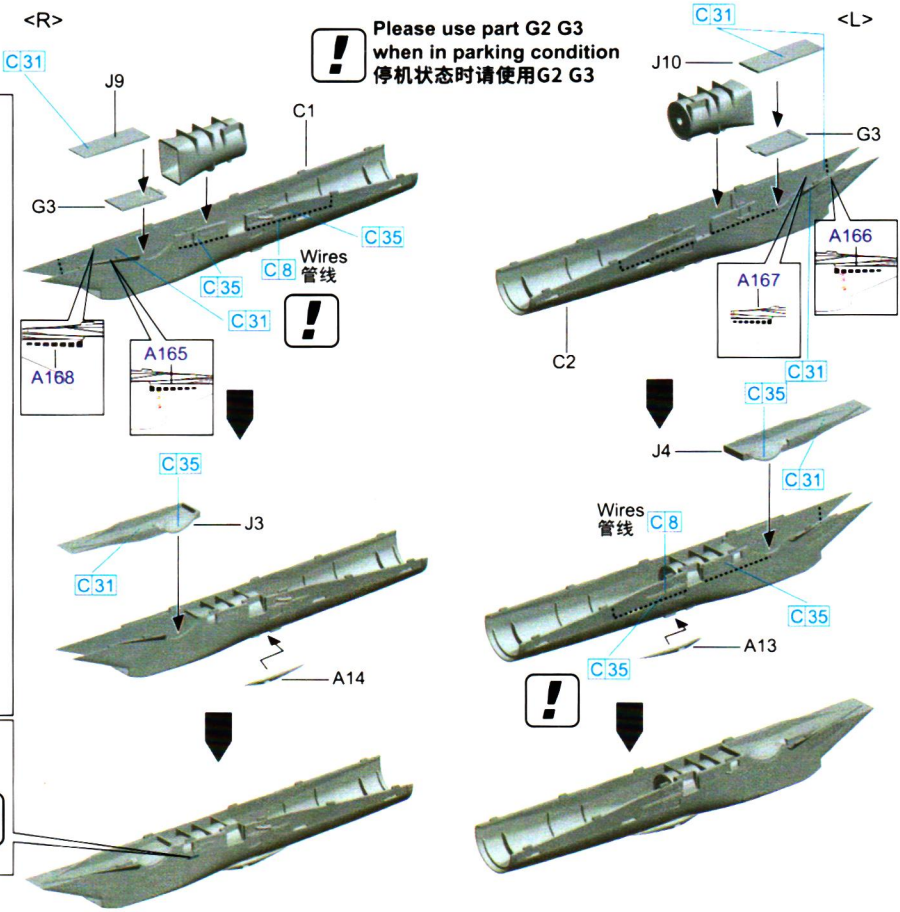

# 11

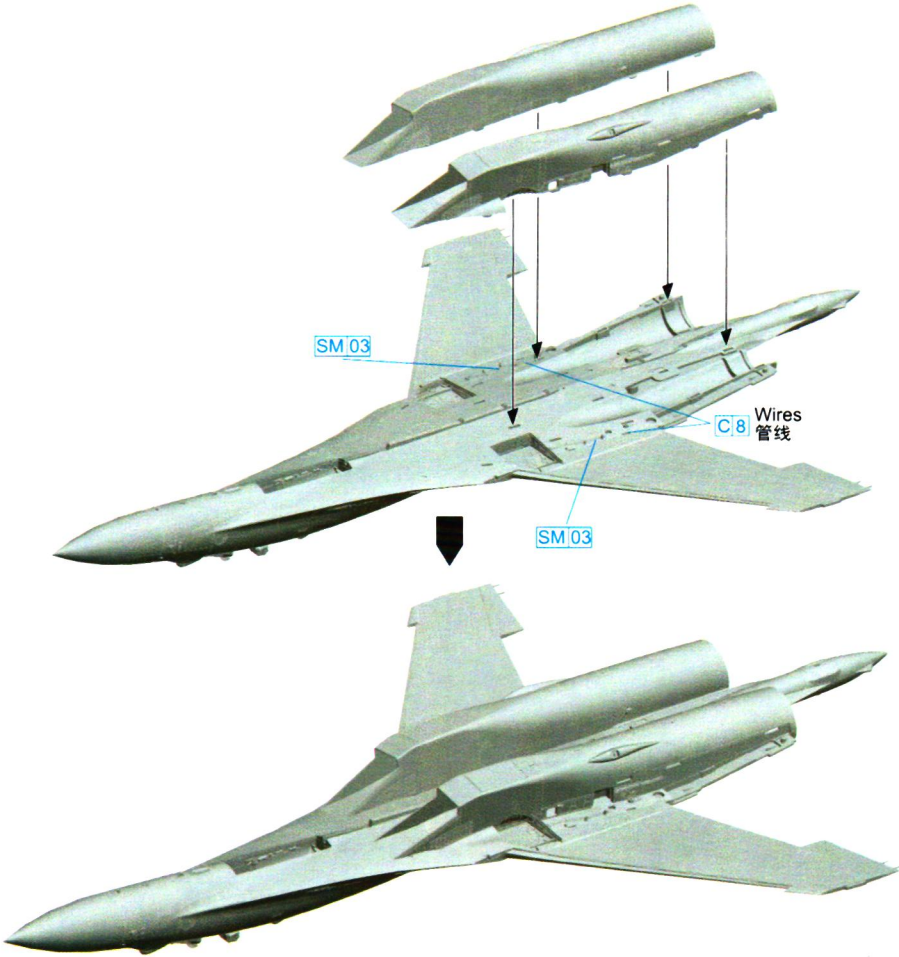



12

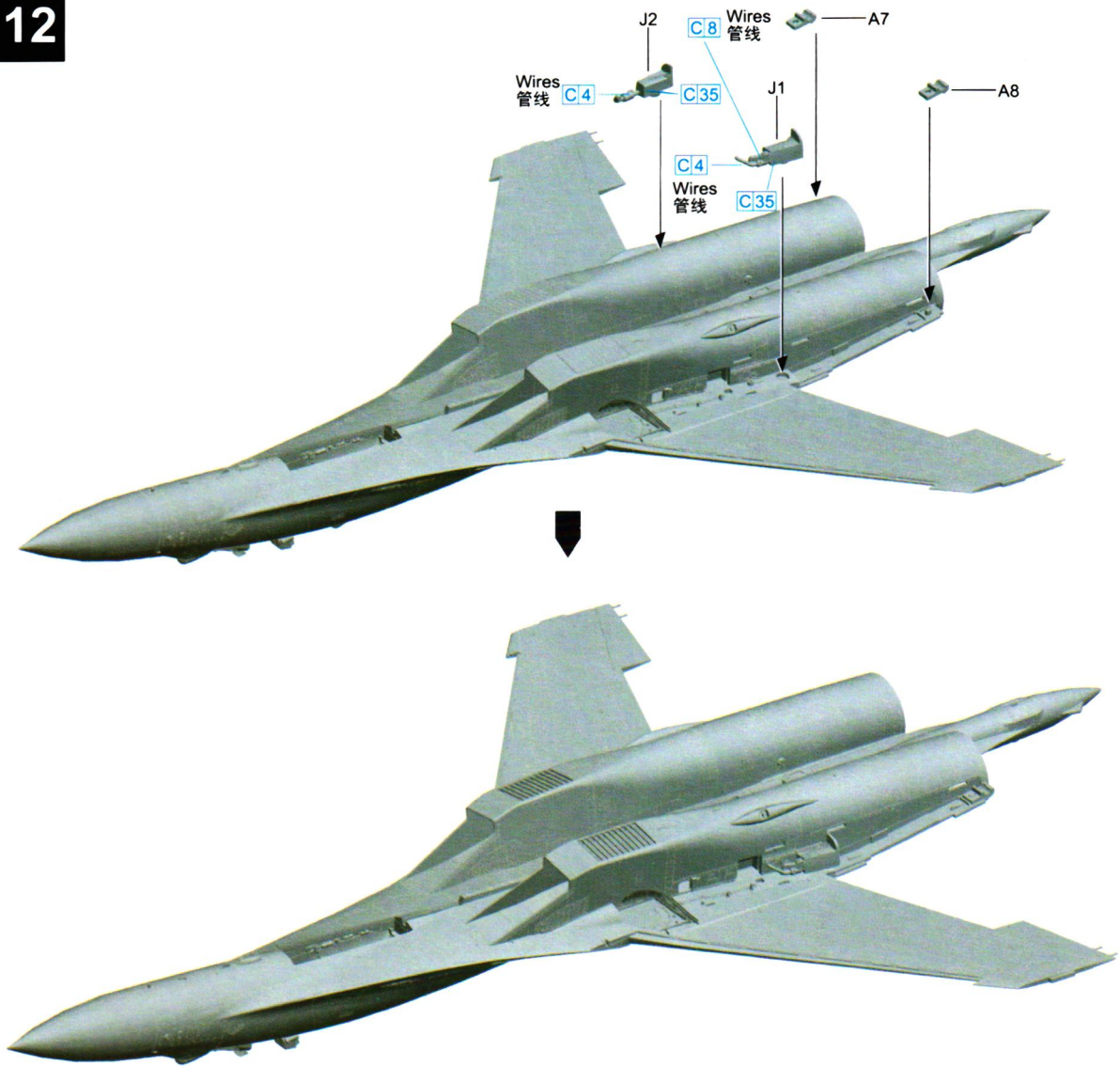

13

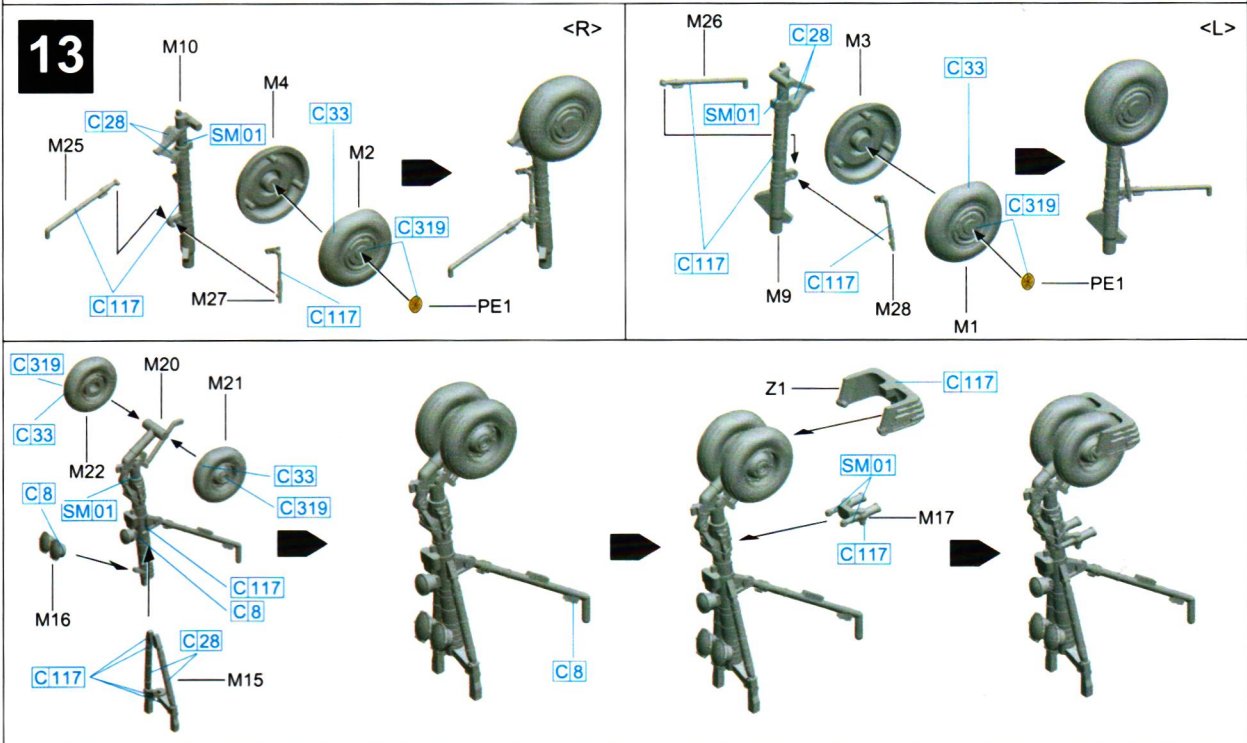



14

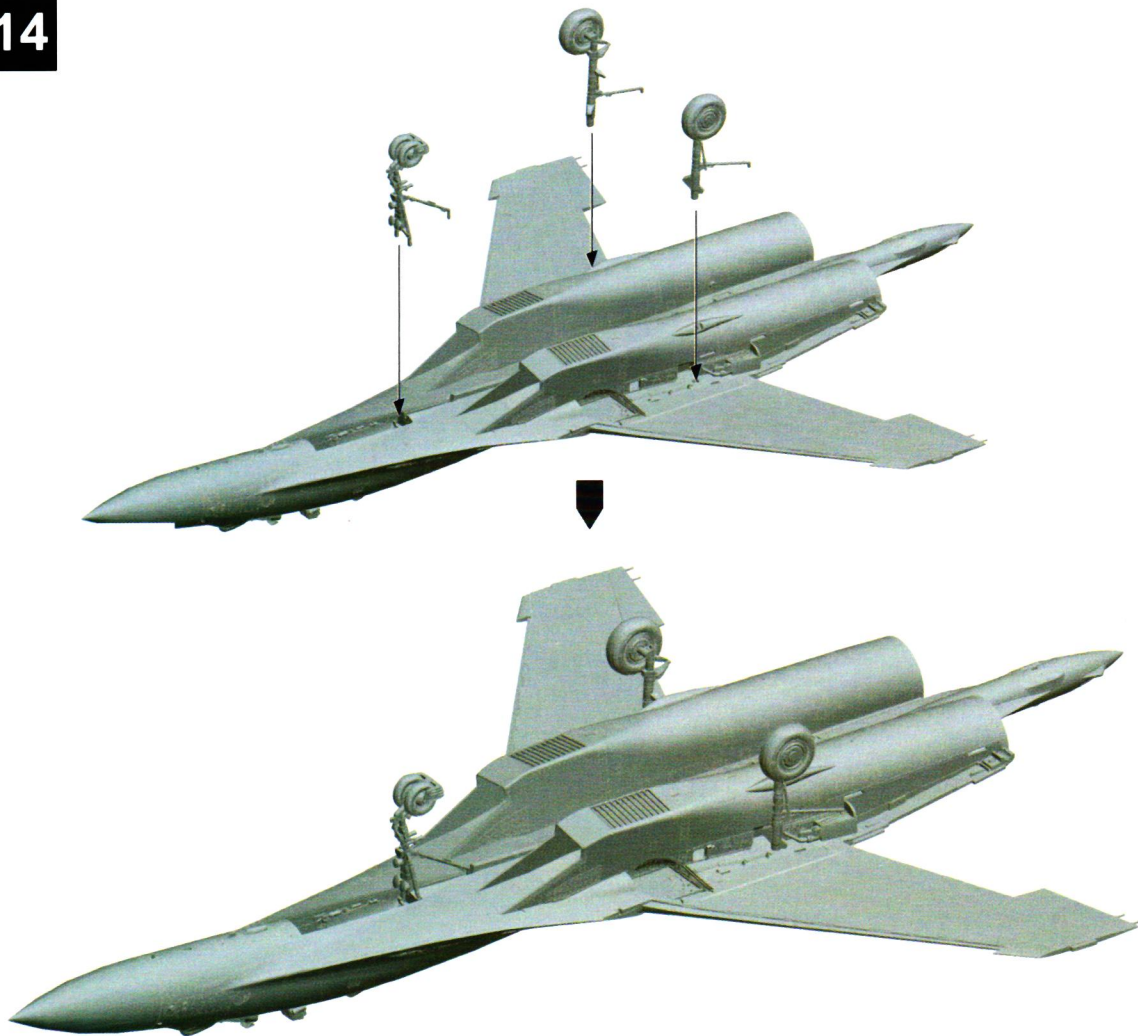

15

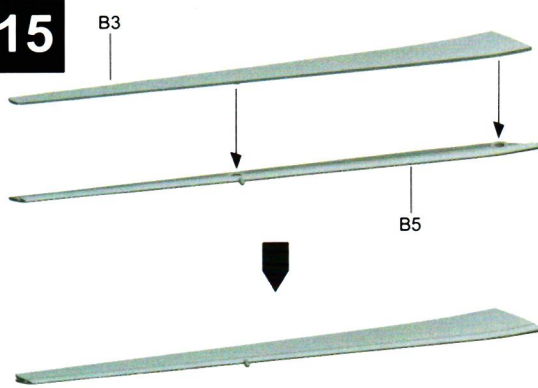

<R>

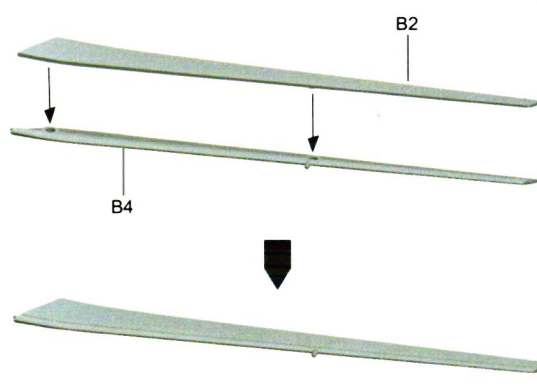

<L>

16

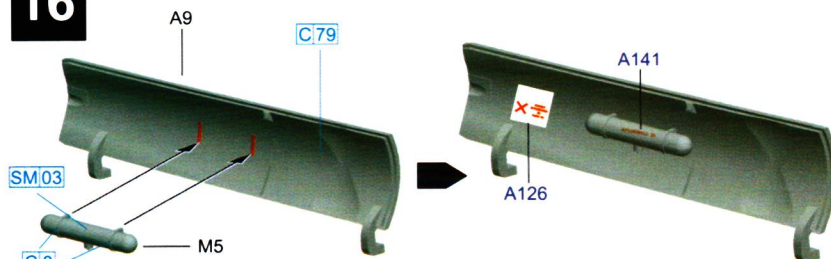

**!** Part M5 and decal A141 is only for "red 06"  
若制作“红色06”请安装M5号零件并使用水贴A141

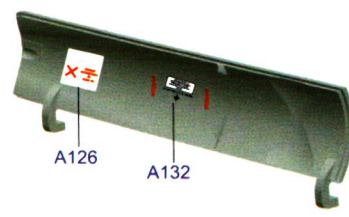

**!** Decal A132 is only for "red 03" "blue 25"  
若制作“红色03”或“蓝色25”请使用水贴A132



17

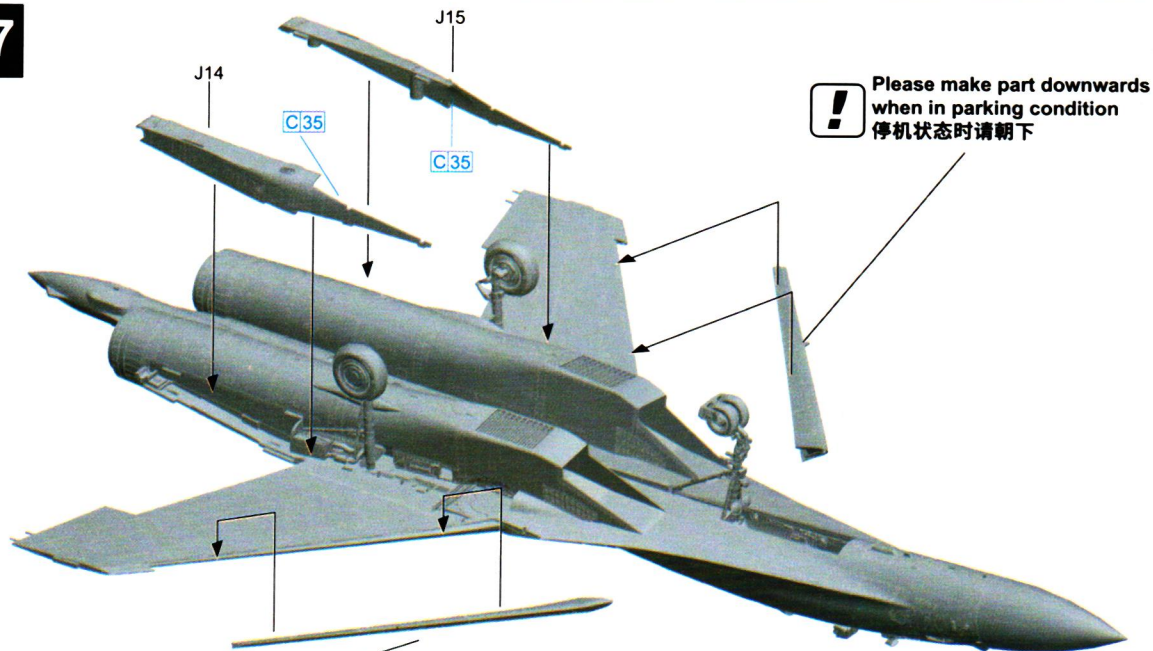

**!** Please make part downwards when in parking condition  
 停机状态时请朝下

**!** Please make part downwards when in parking condition  
 停机状态时请朝下

Chaff dispenser protect covers do not install for combat flight  
 干扰弹发射器保护罩实战前不安装

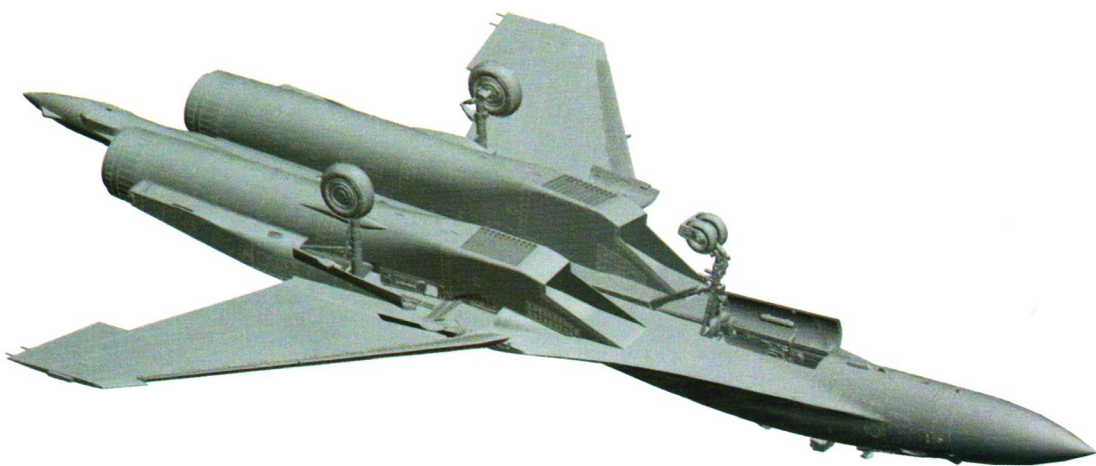
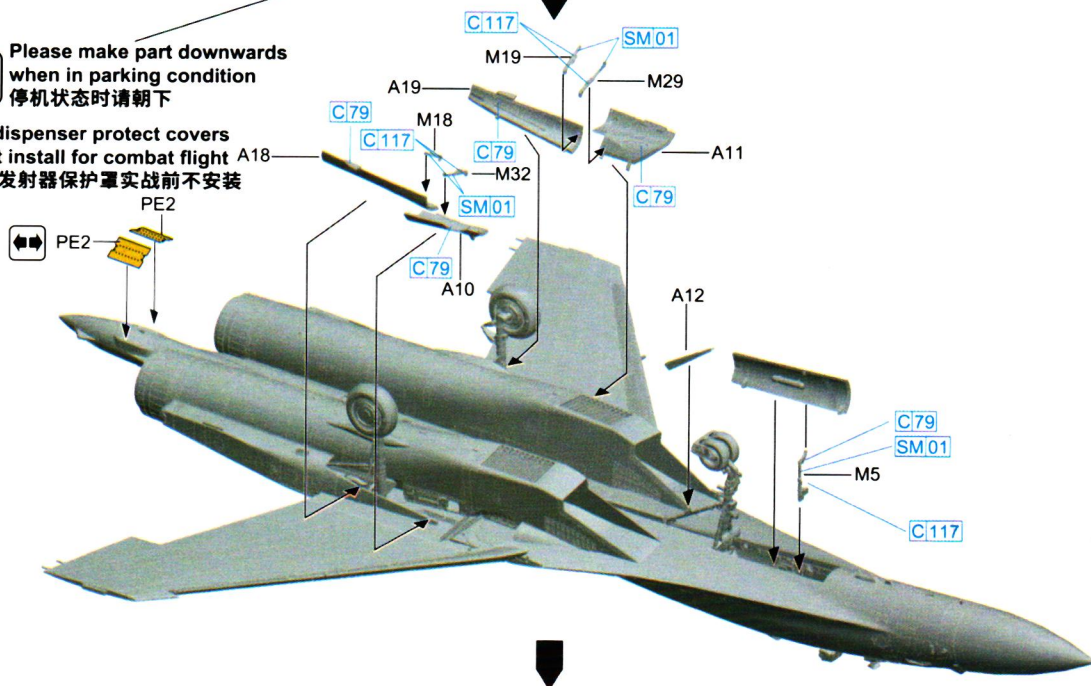



18

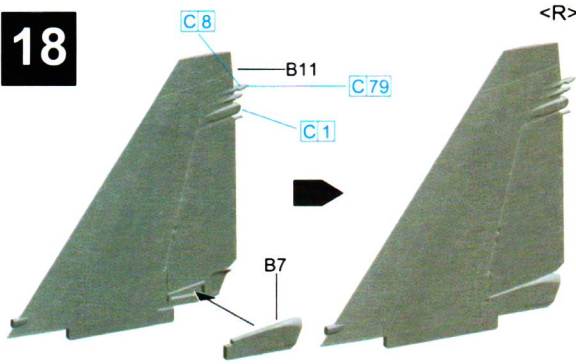

<R>

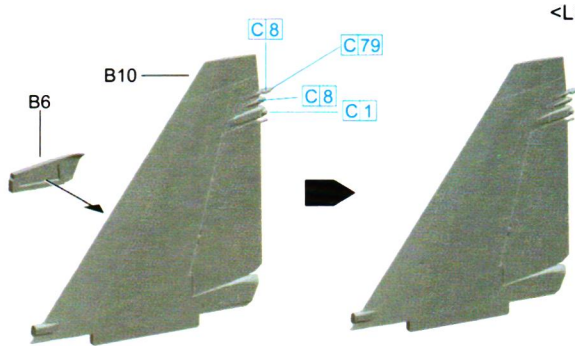

<L>

19

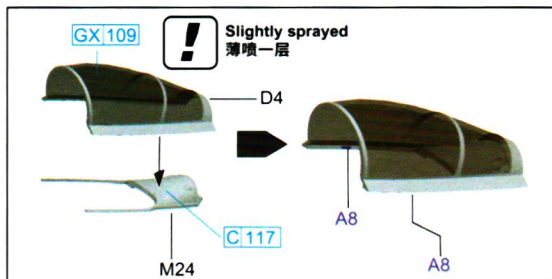

Slightly sprayed  
薄喷一层

Chaff dispenser  
protect covers  
do not install  
for combat flight  
干扰弹发射器保护  
罩实战前不安装

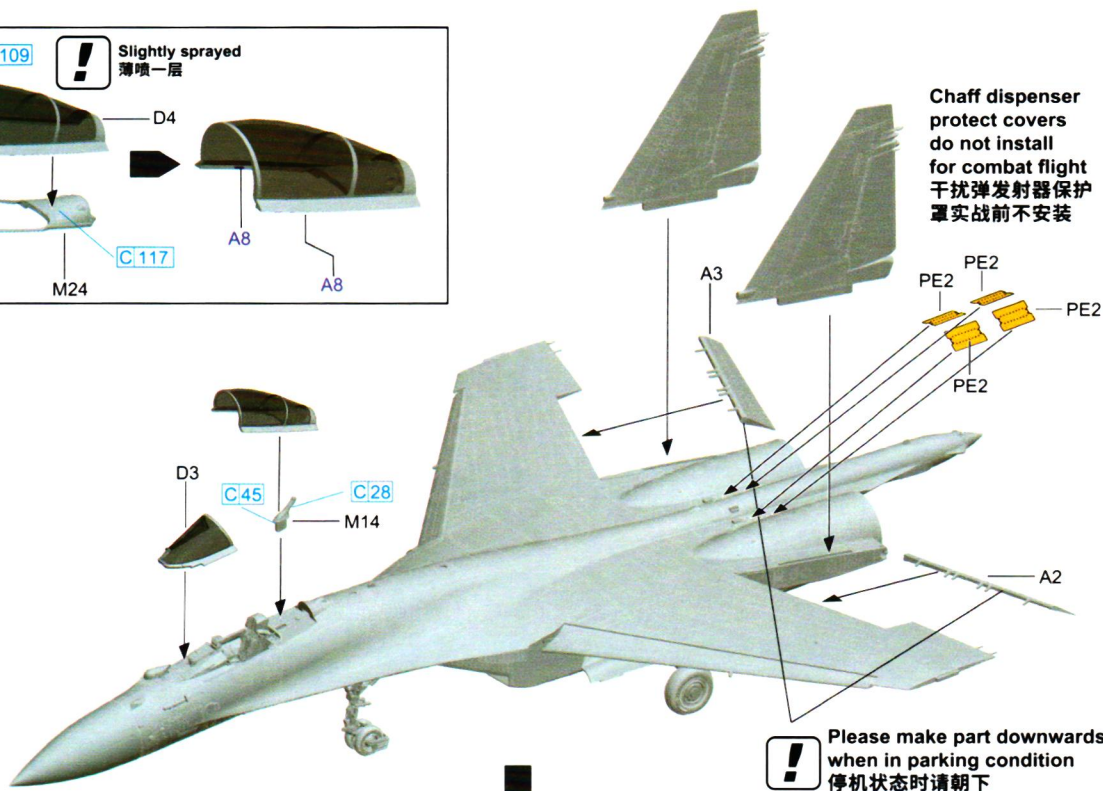

Please make part downwards  
when in parking condition  
停机状态时请朝下

Close State  
关闭状态



Open State  
打开状态

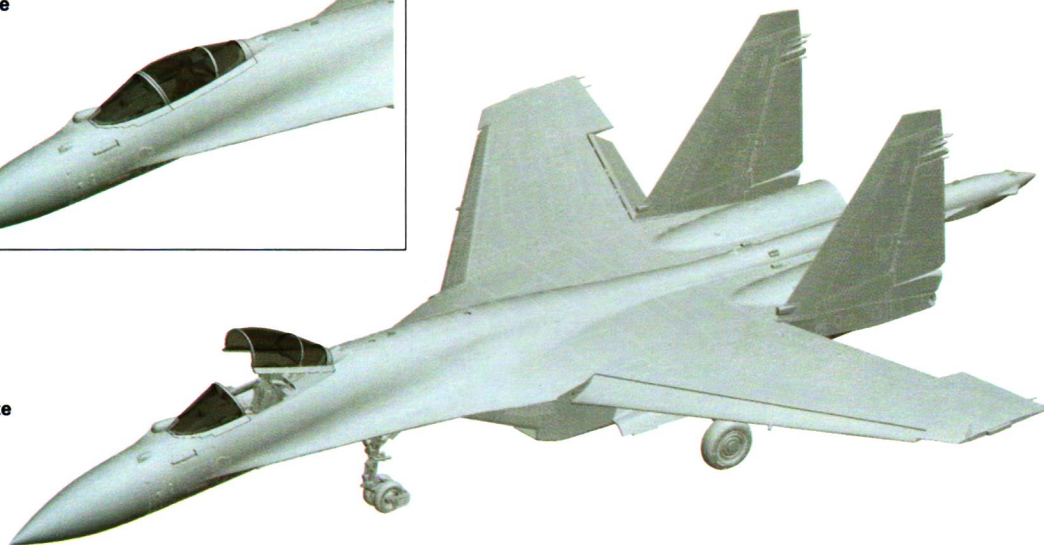



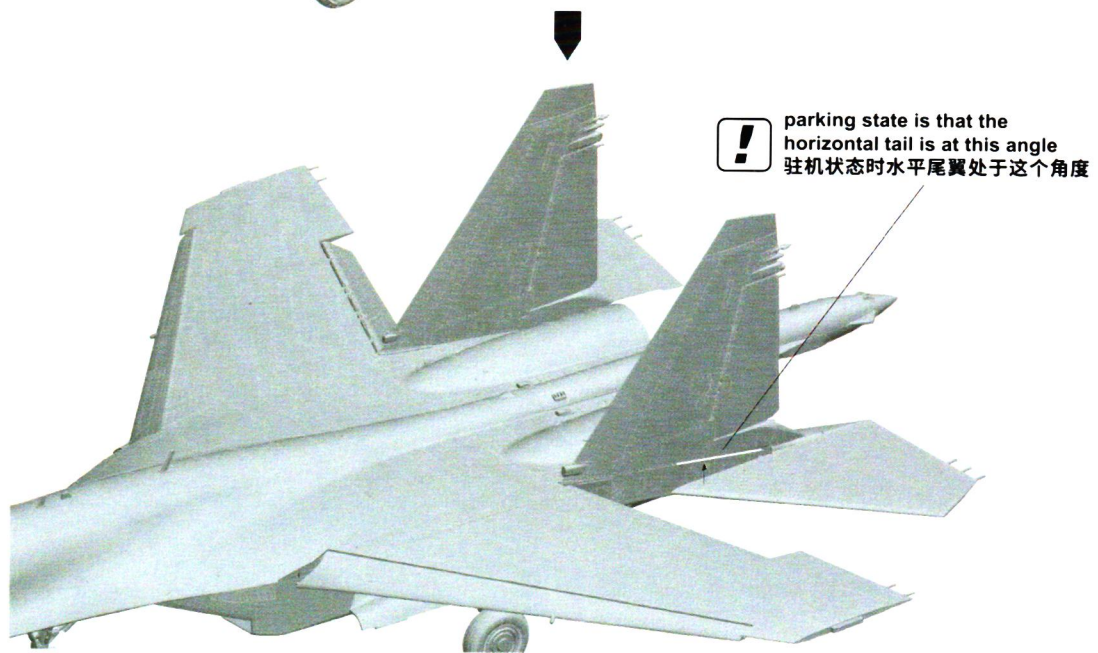
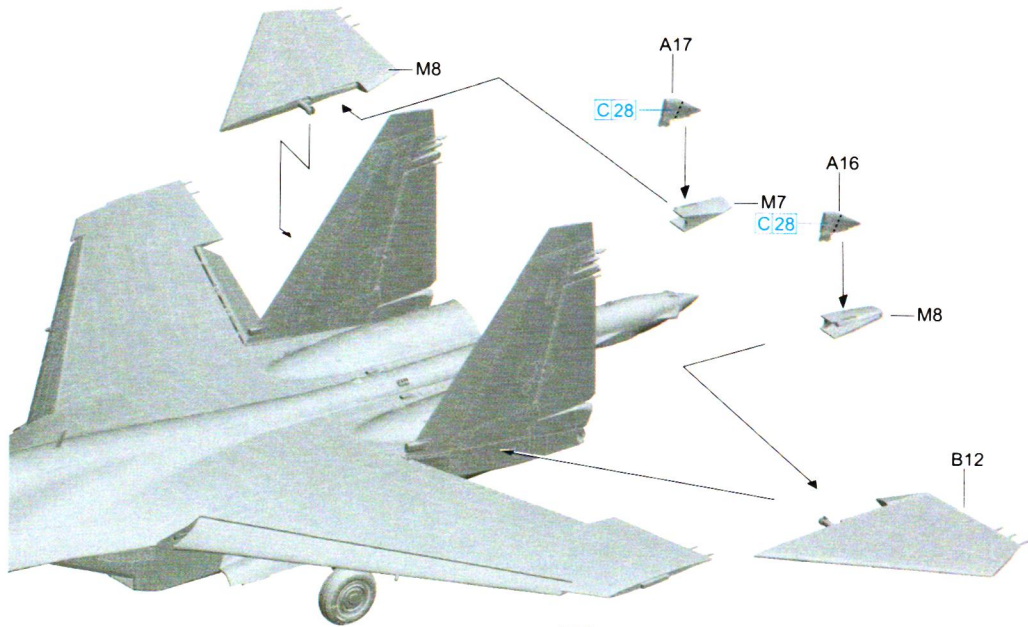

21 Open State  
打开状态

**!** For parking condition  
驻机姿态使用

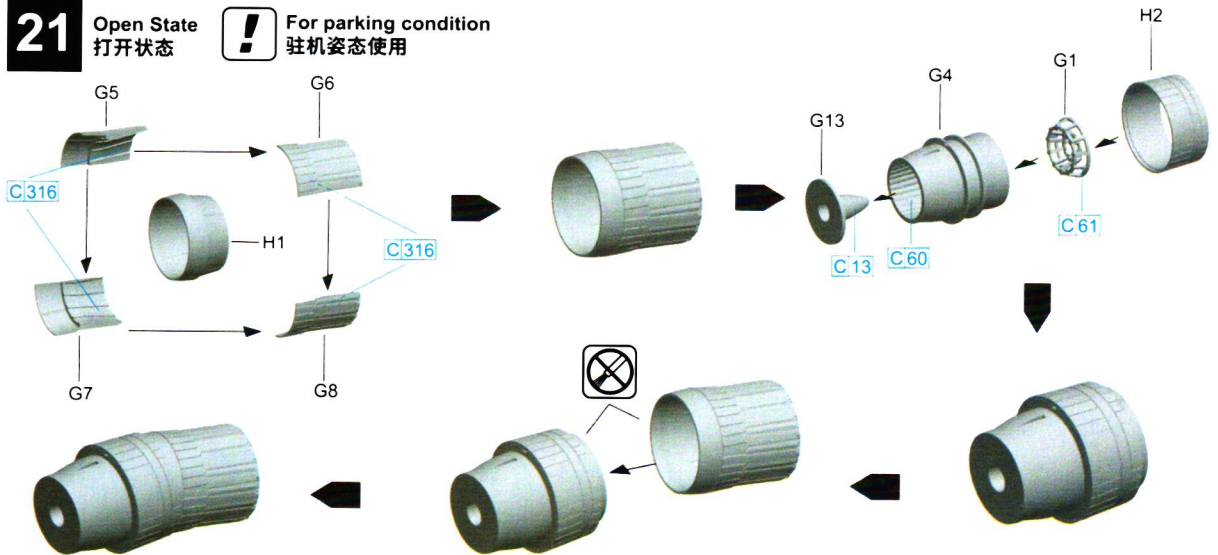



**22** Close State  
关闭状态

**!** For in flight condition  
飞行姿态使用

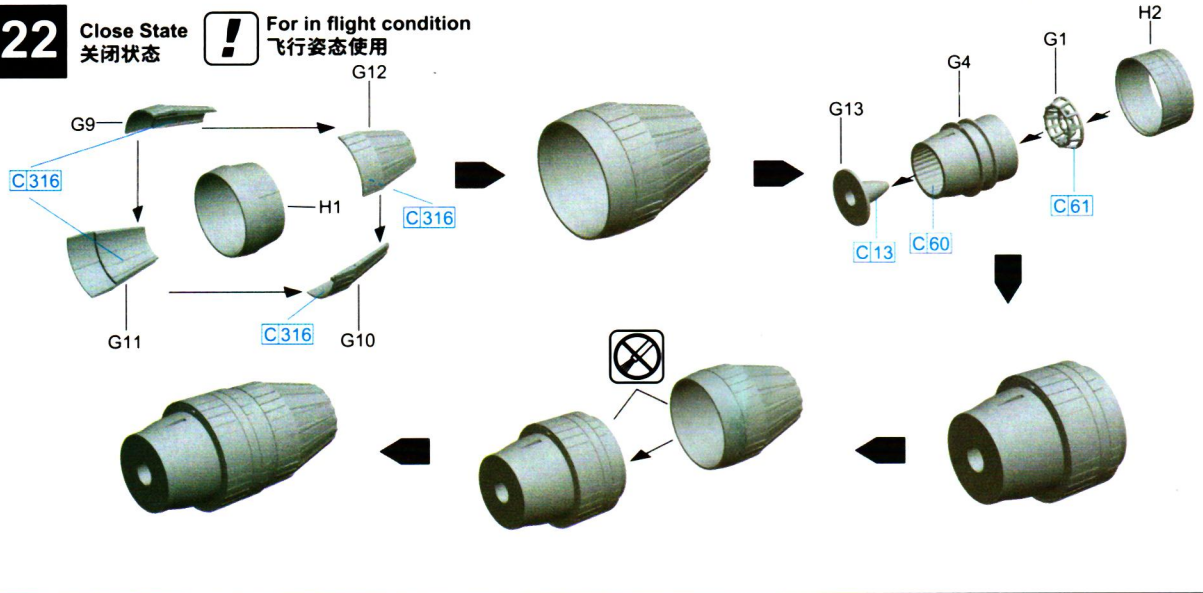

**23**

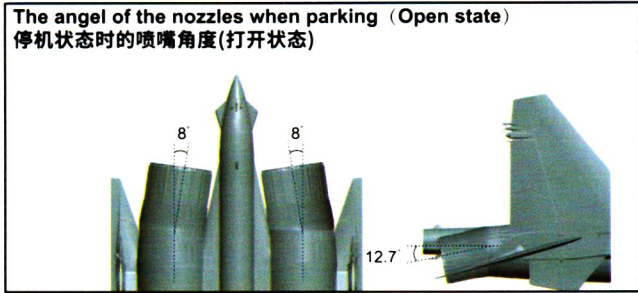
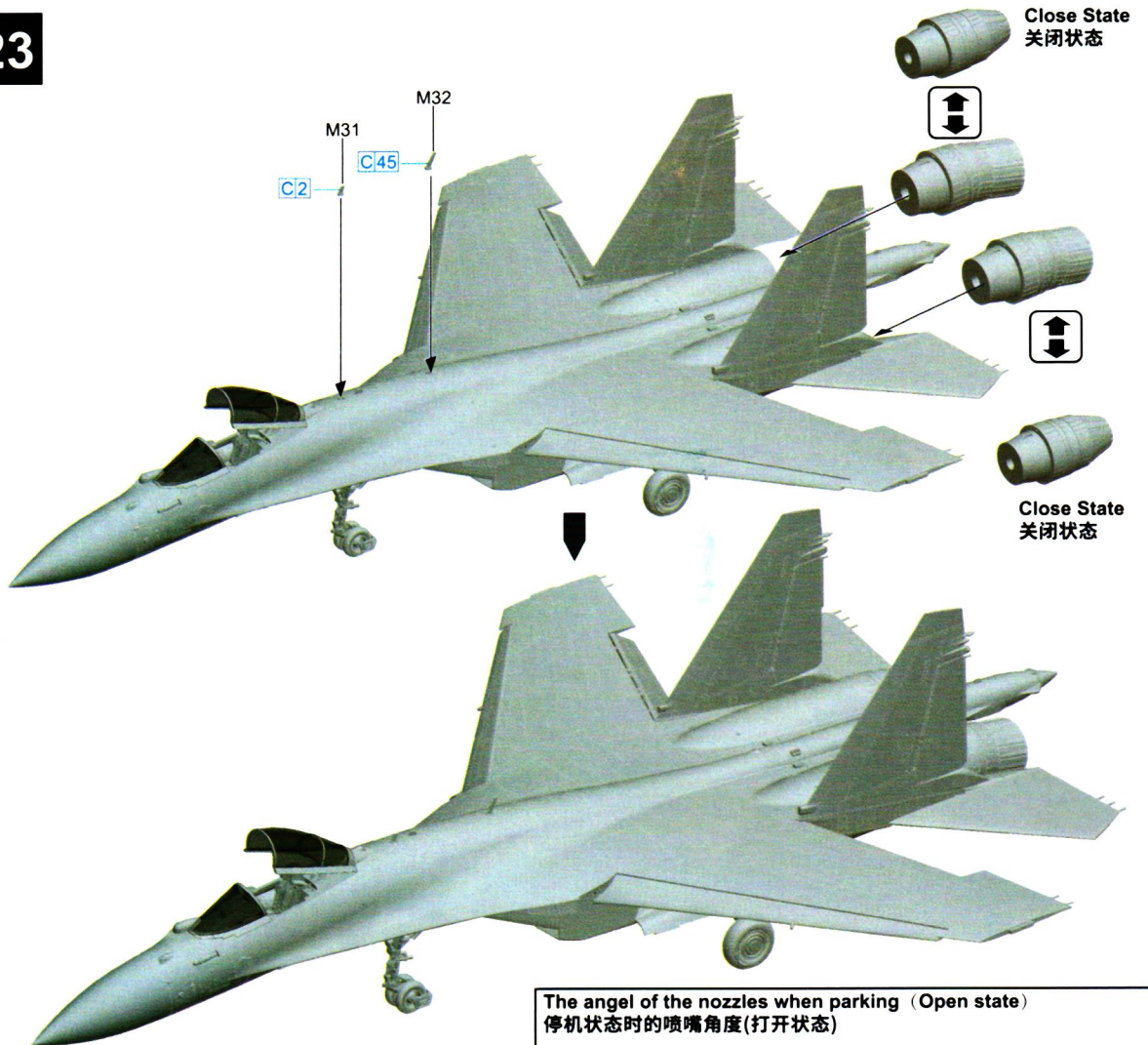



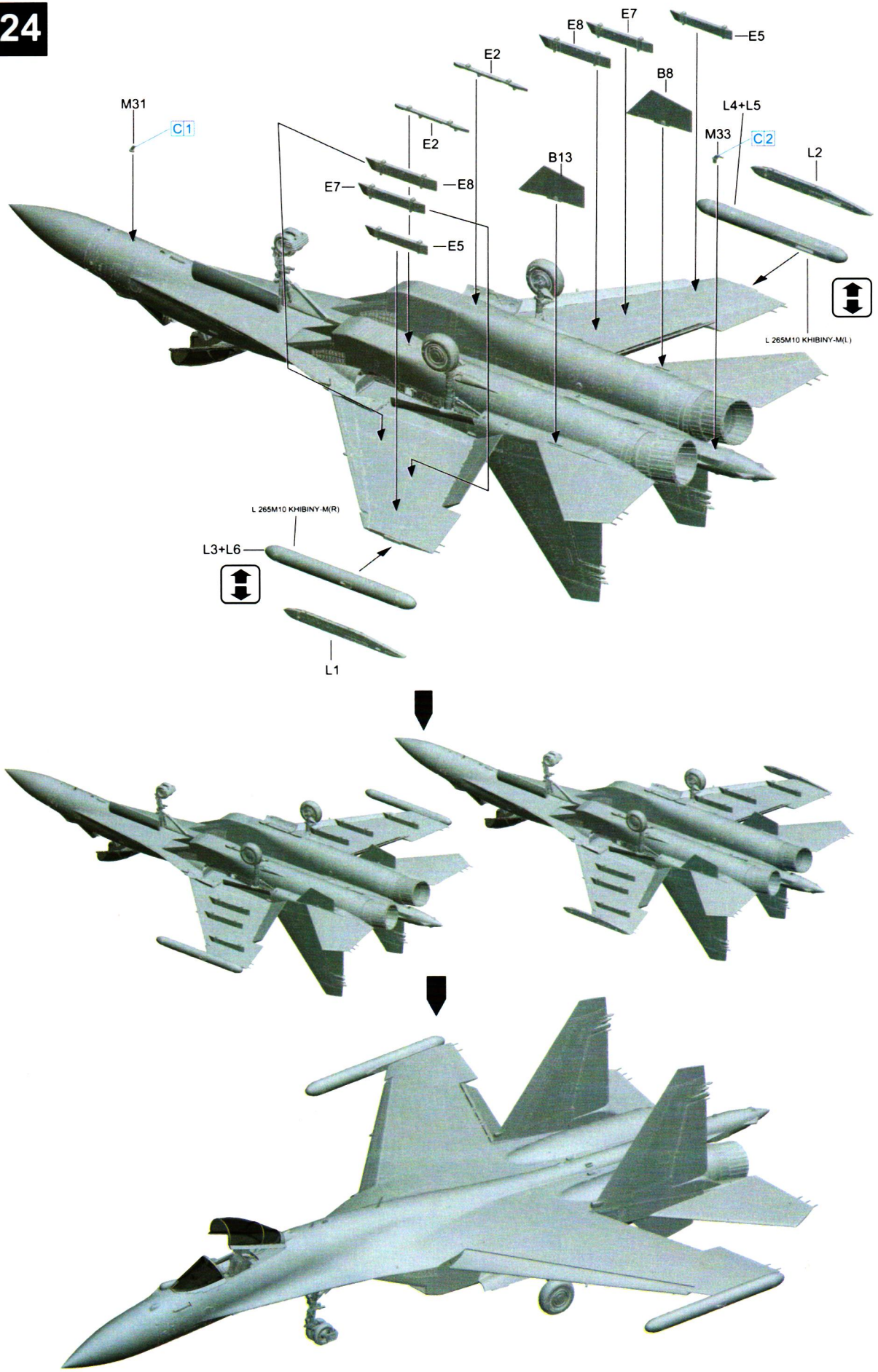

25



Please use 0.8mm drill to deepen install holes on all missiles  
所有导弹定位孔请使用0.8mm钻头加深

R-27ER

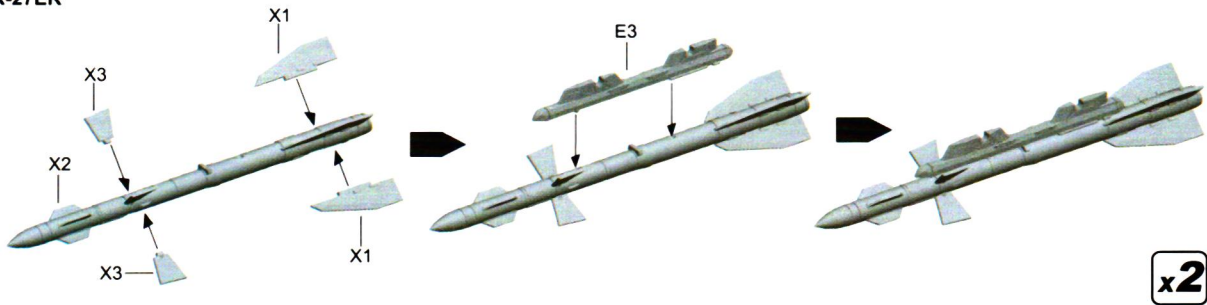

R-27ET

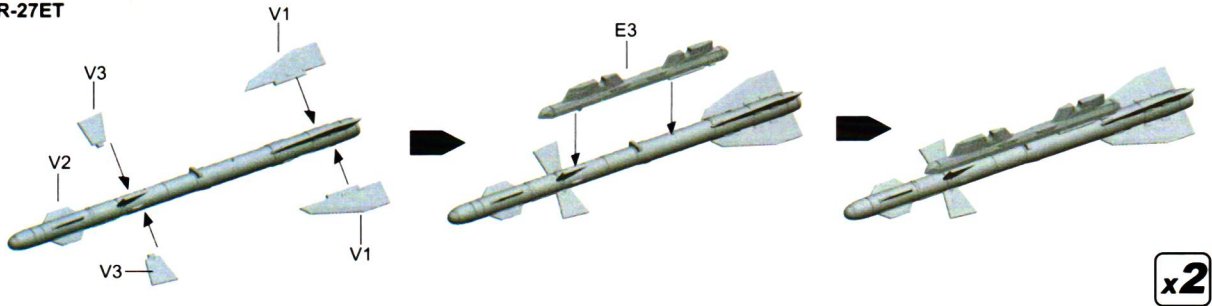

R-77

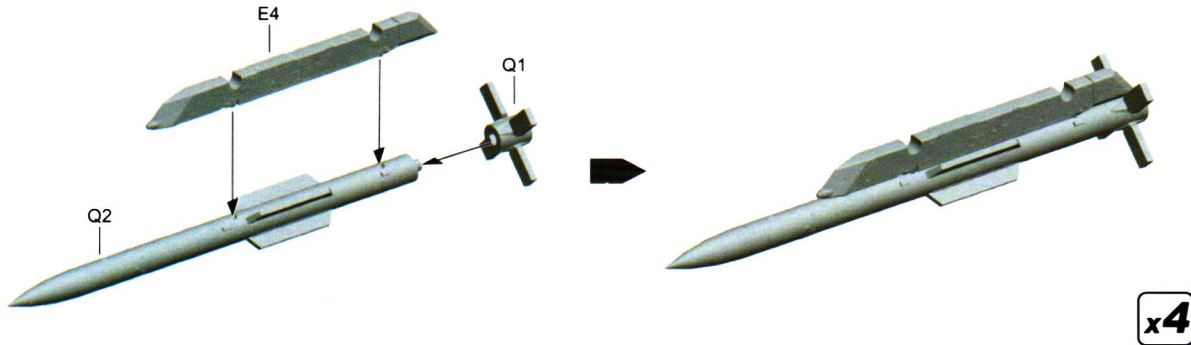

R-73

Use nipper to cut trace for all 4 fins  
使用剪钳切一刀(4片弹翼)

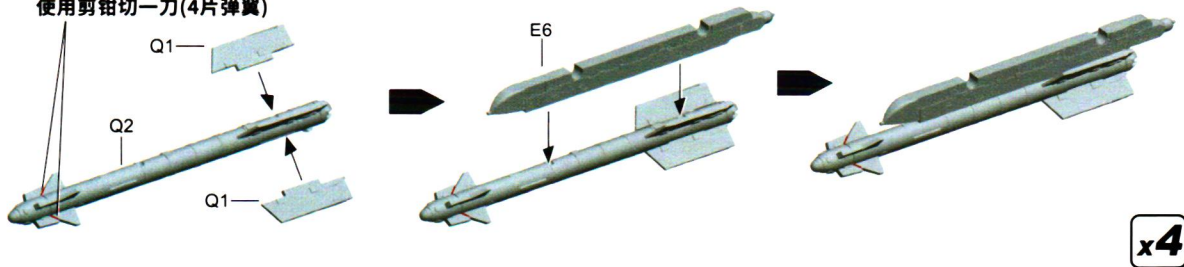

(L)

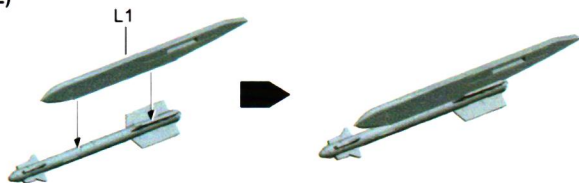

(R)

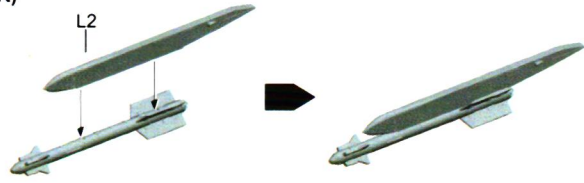



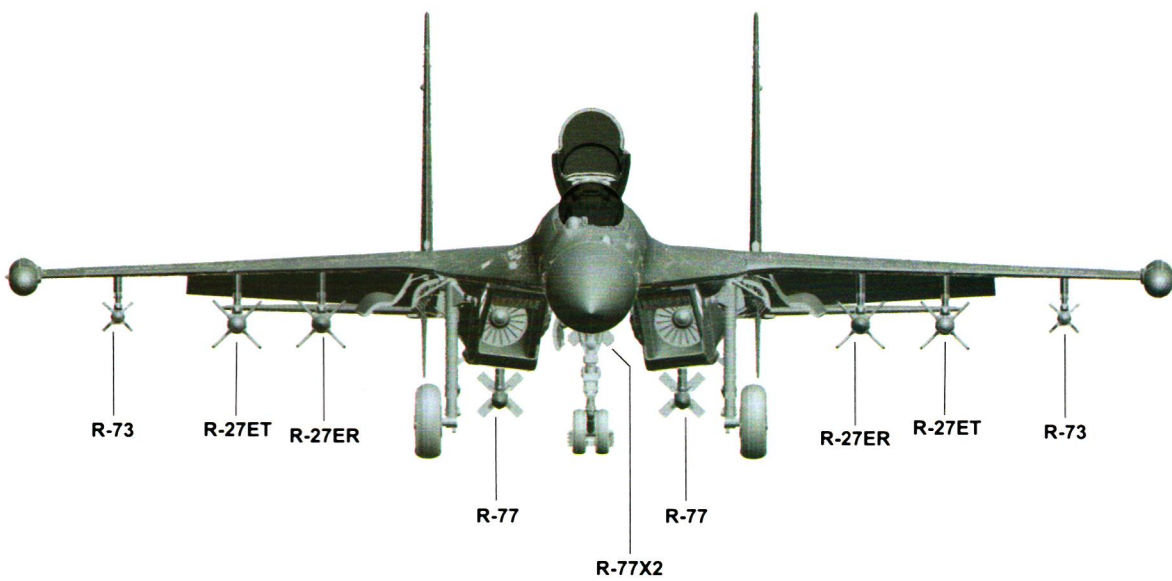
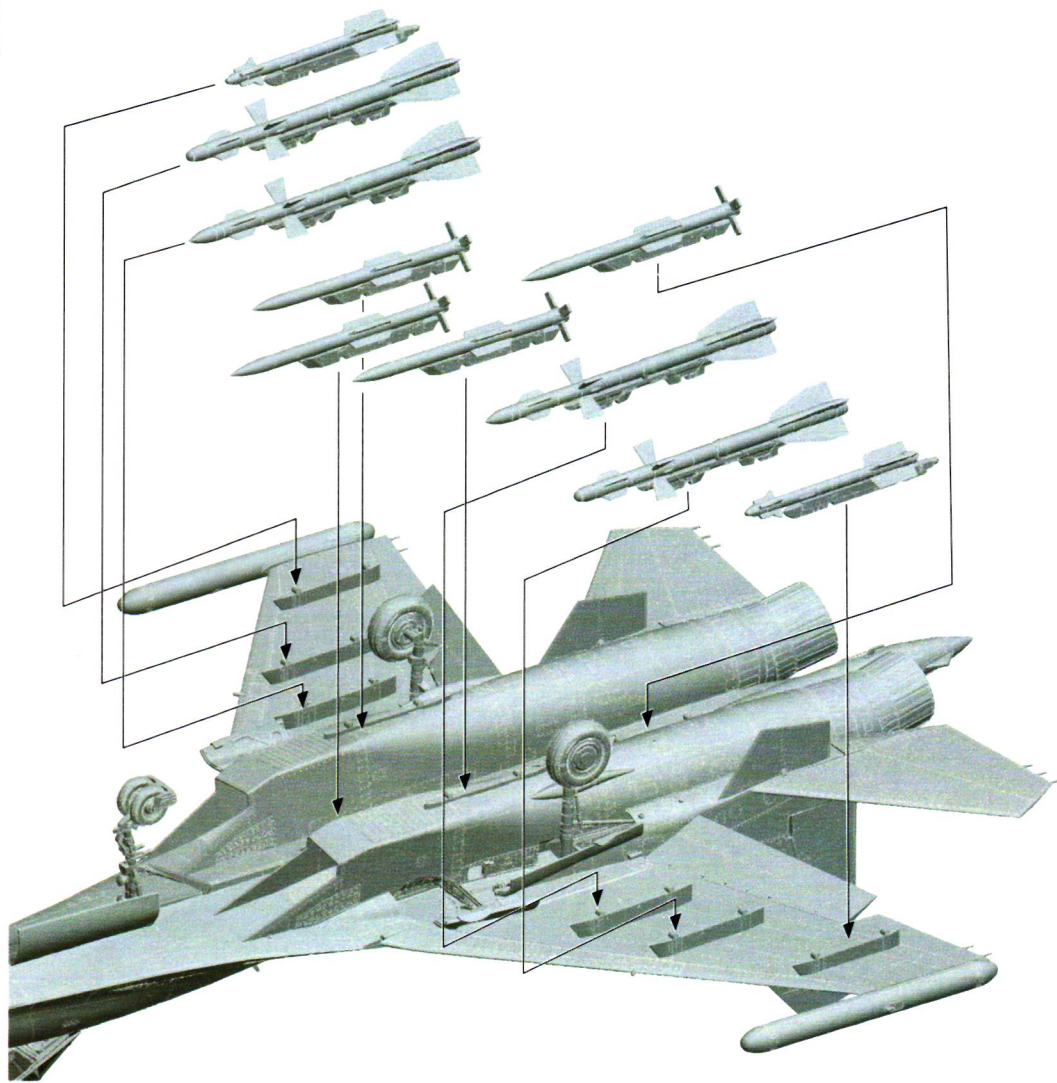

P-72

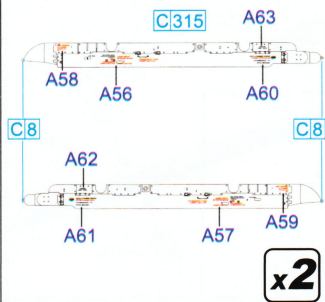

APU-470

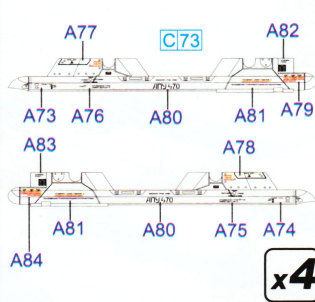

AKU-170

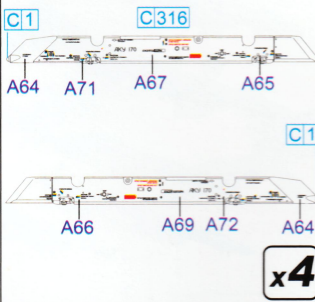

ADAPTOR

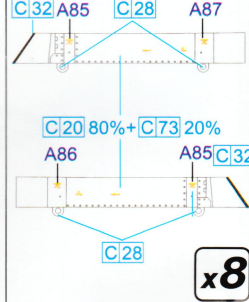

L 265M10 Khibiny-M(L)

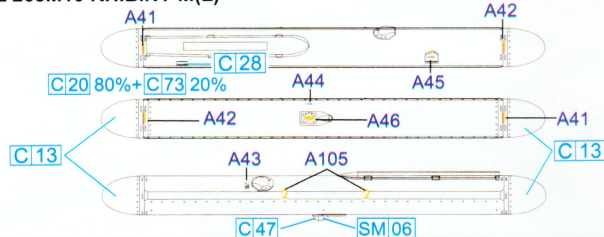

L 265M10 Khibiny-M(R)

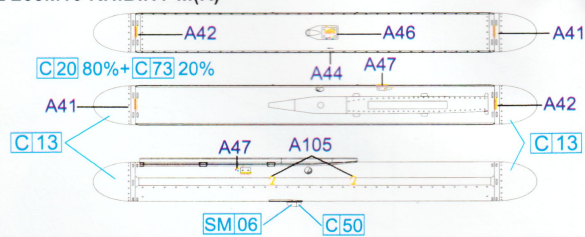

Wingtip P-72(L)

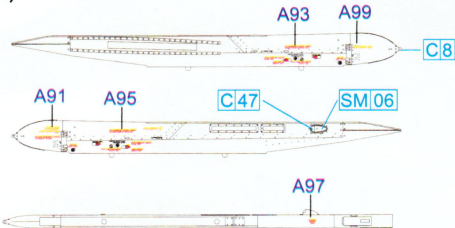

Wingtip P-72(R)

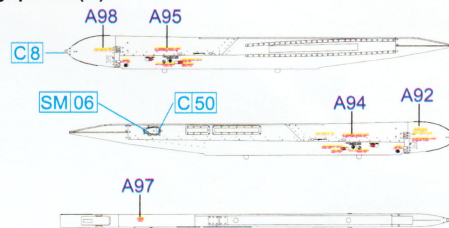

R-27ER

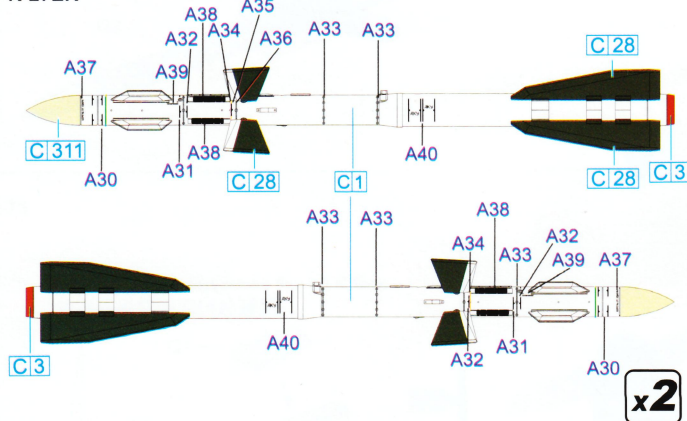

R-73

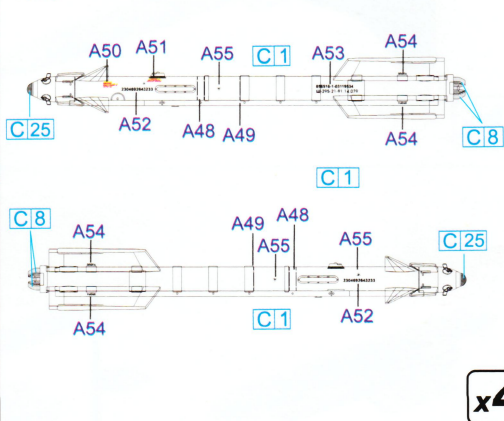

R-27ET

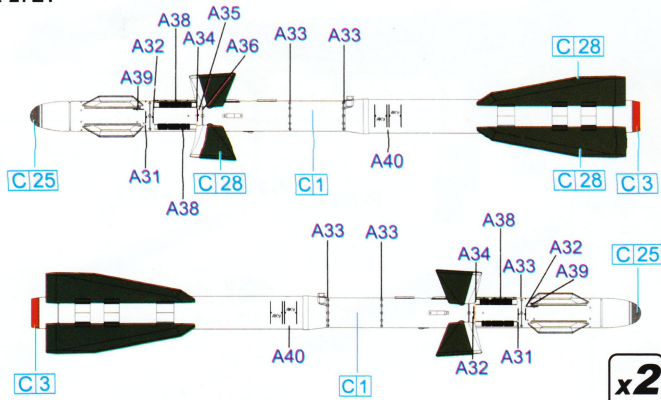

R-77

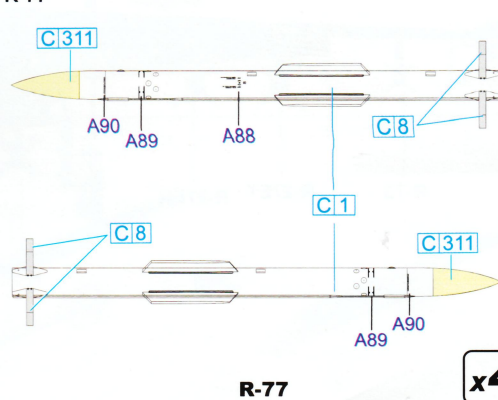



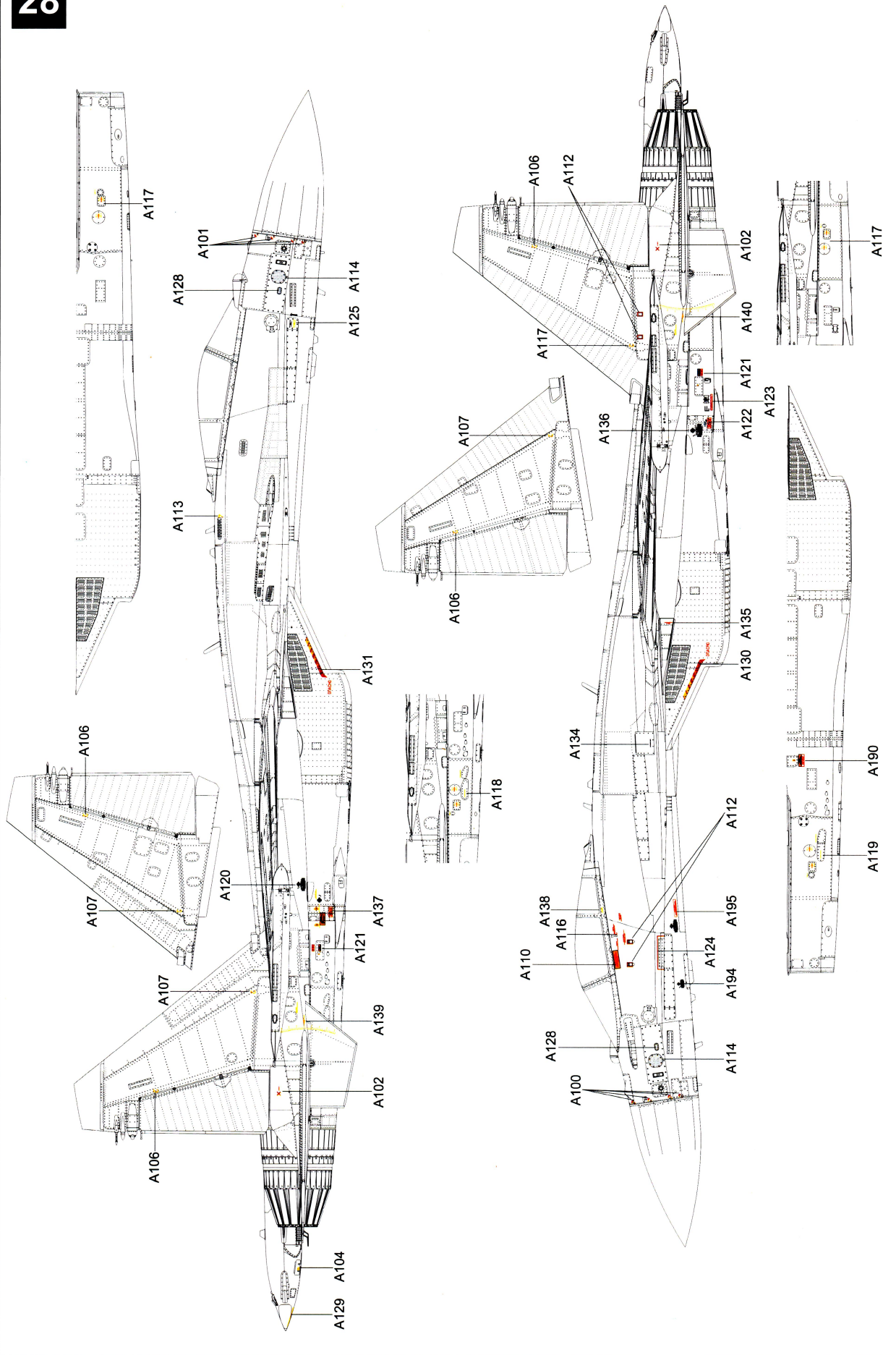

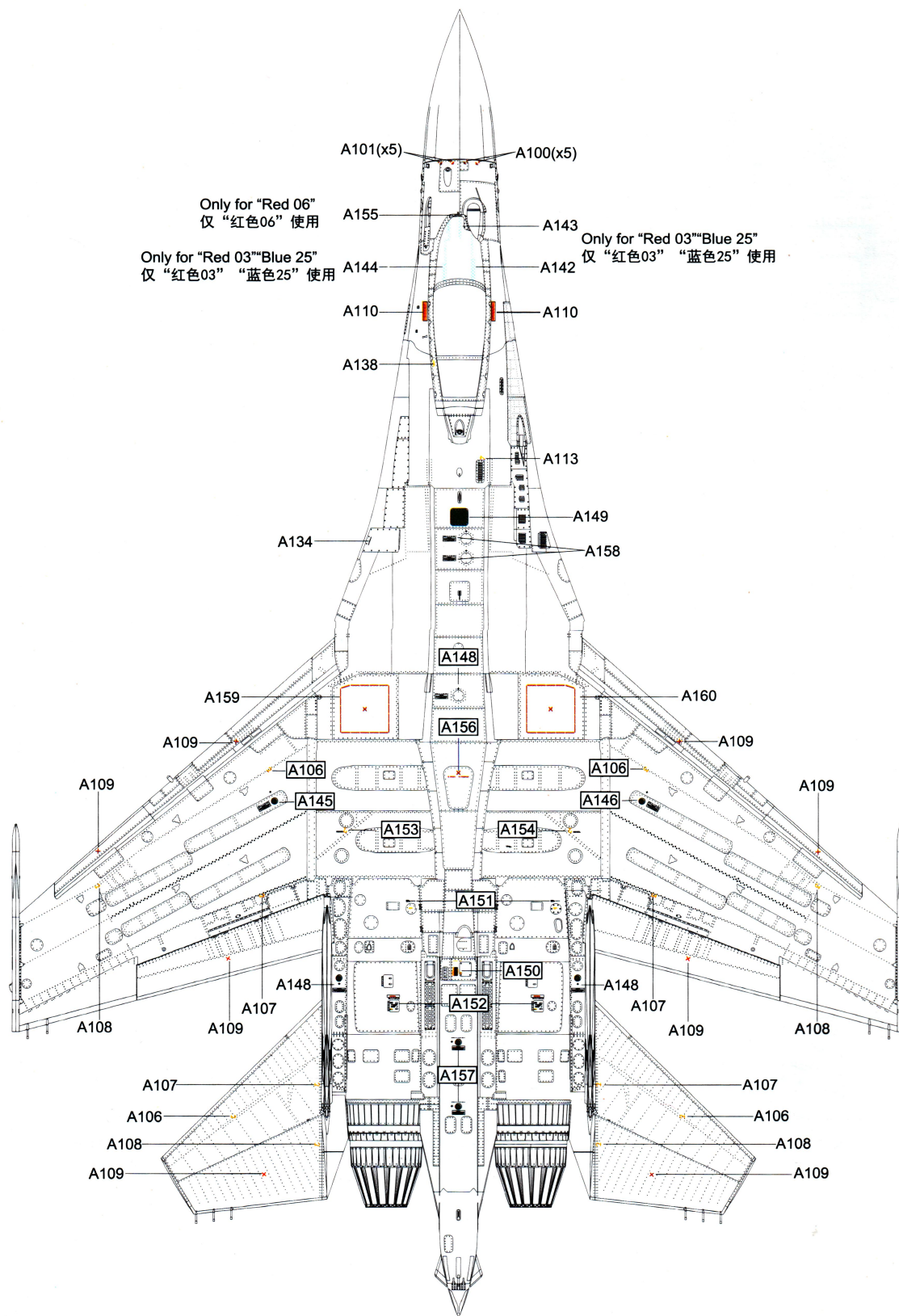



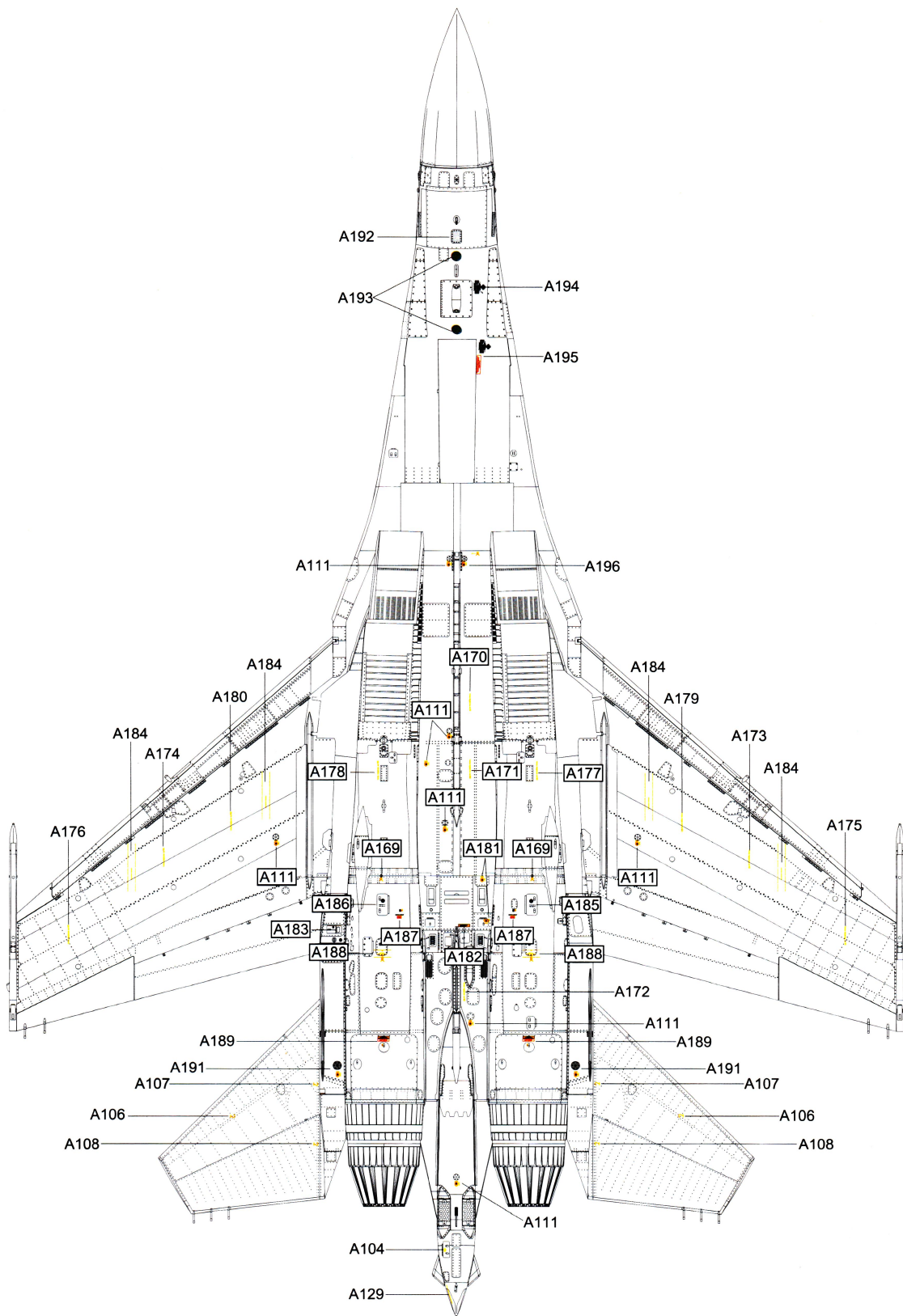

RF-95816 "Red 06" 23rd IAP, 25th DPVO, 11th Air Army, VKS Hmeymin AB, Syria 2016  
RF-95816 "红色06"俄罗斯空军第11航空军第25师第23近卫歼击团 克梅明基地, 叙利亚 2016年

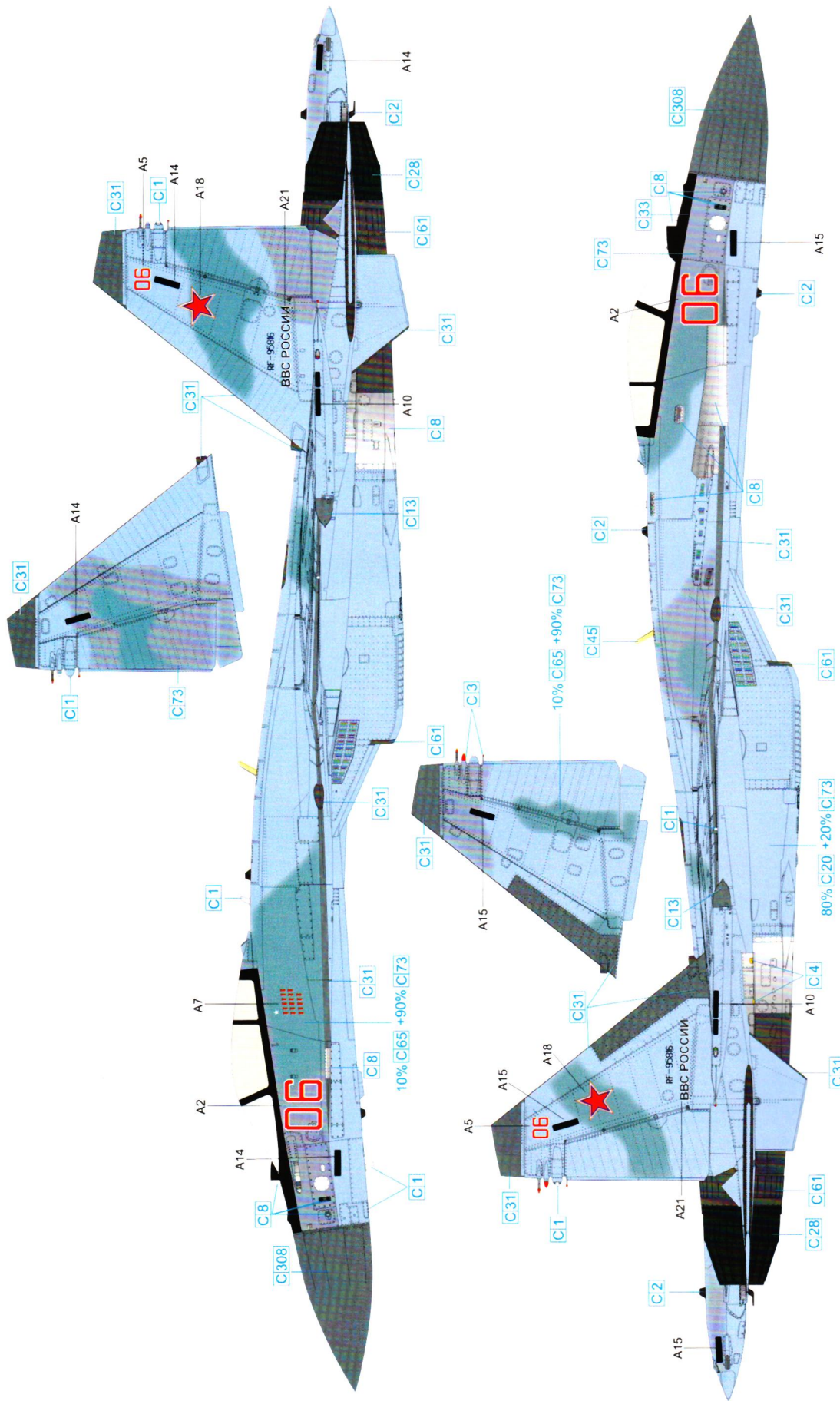



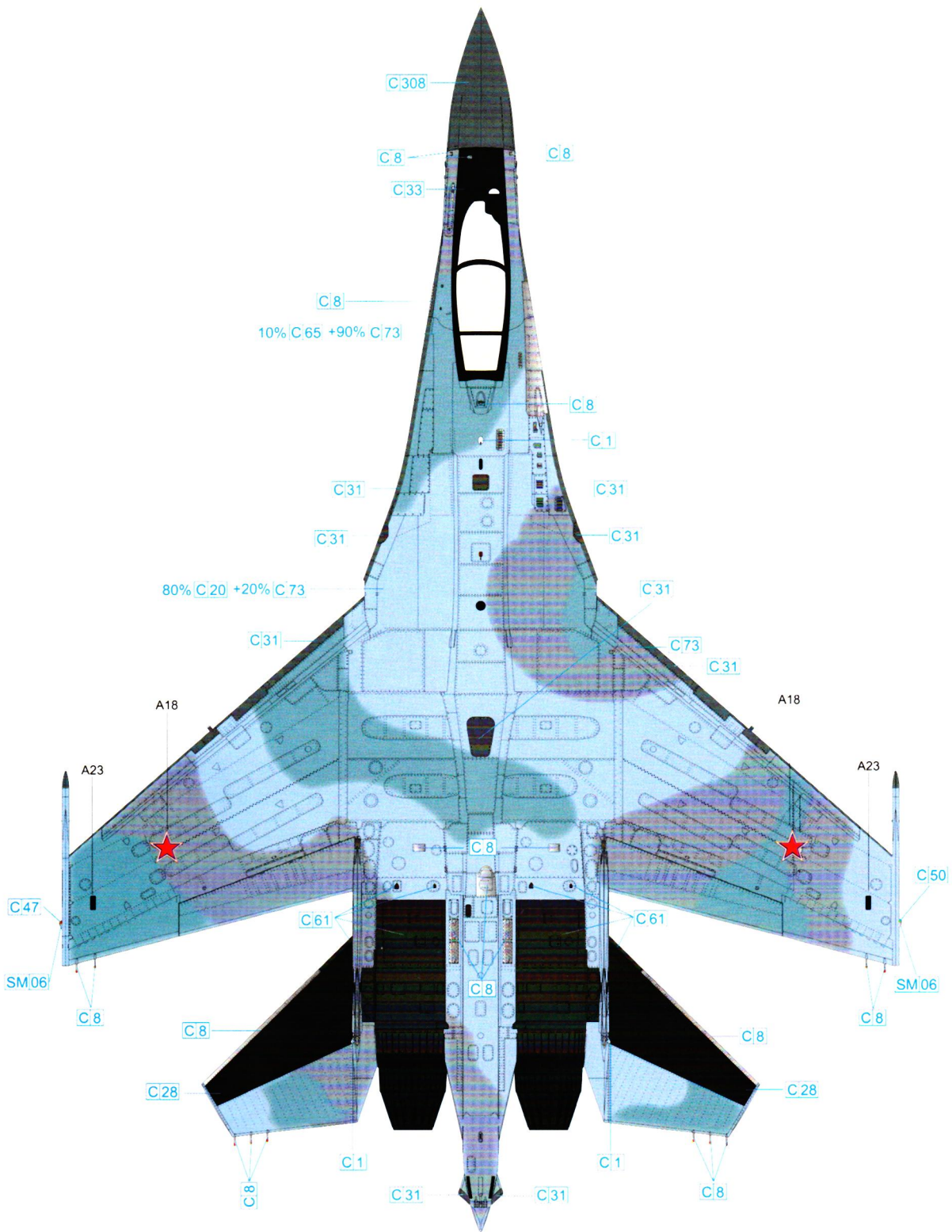

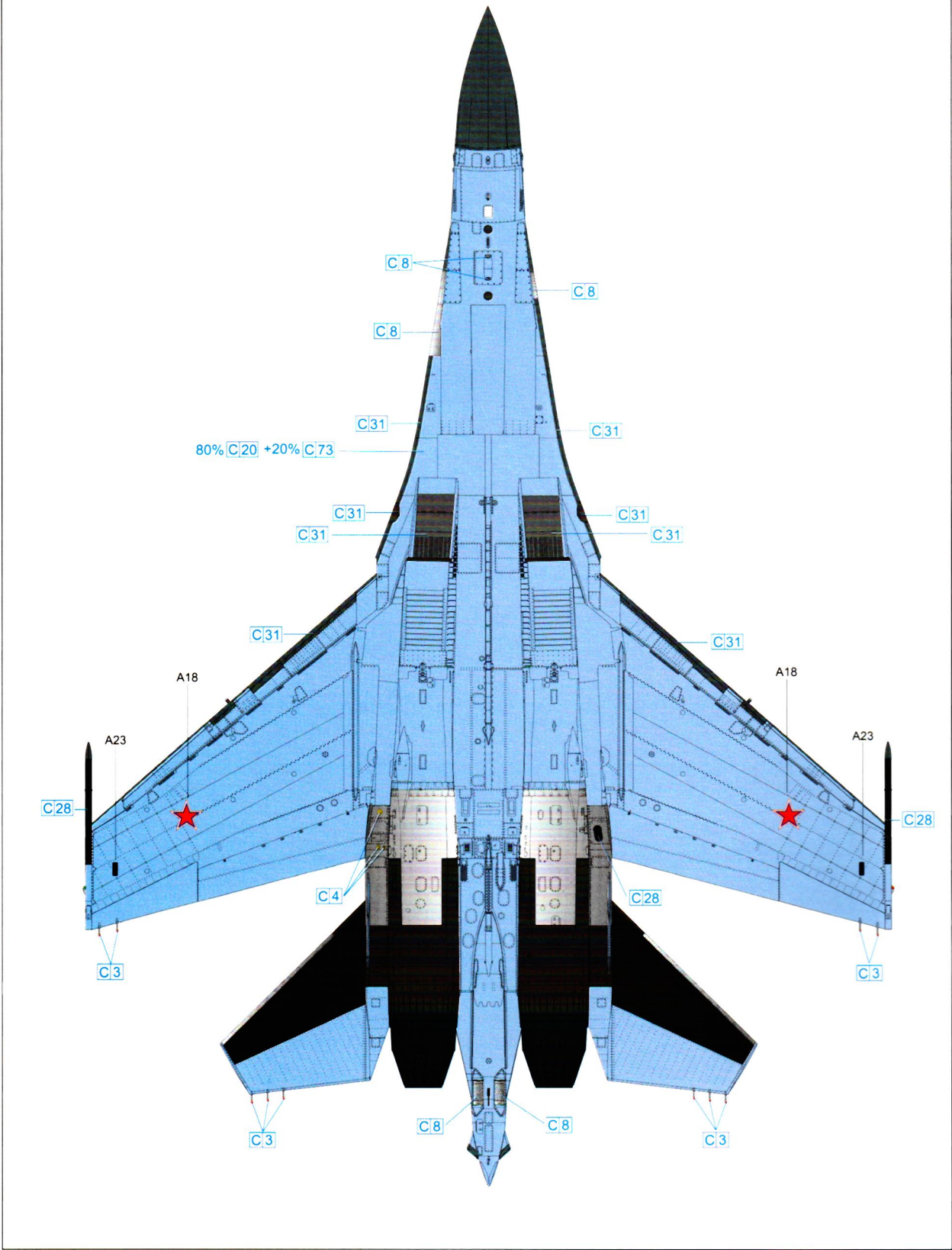



# G.W.H

# SU-35S 'FLANKER'

MULTIROLE FIGHTER SU

RF-95242 "Red 03" 23rd IAP, 303rd DPVO, 11th Air Army, VKS

RF-95242 "红色03"俄罗斯空军第11航空军第303近卫混成师第23近卫歼击团

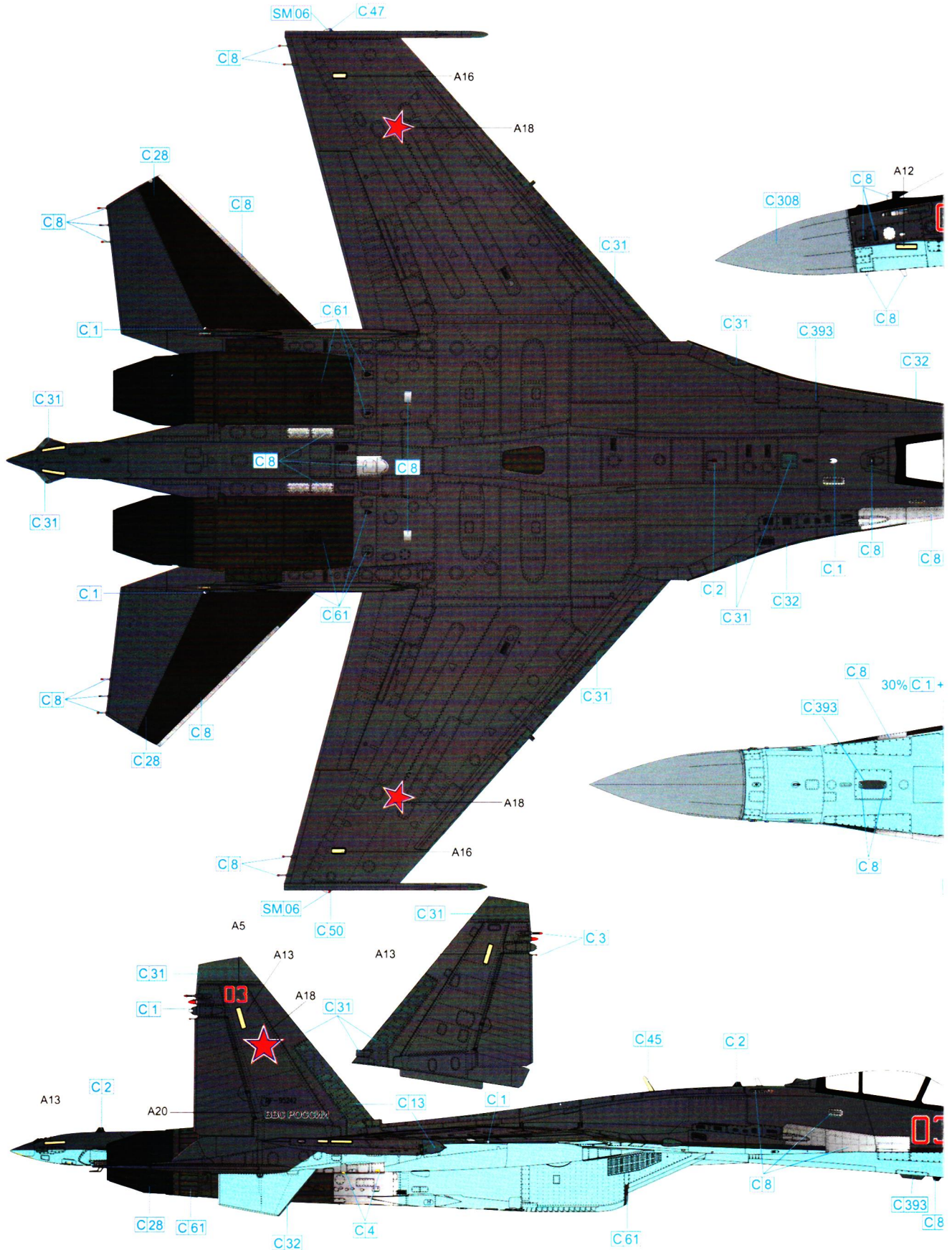



# “侧卫-E”

苏-35S“侧卫-E”多用途战斗机



# 1/72 SCALE AIRCRAFT

# L7207

涂装指示

PAINTING

カラーガイド





# G.W.H

# SU-35S "FLANKER" MULTIROLE FIGHTER

RF-95495 "Blue 25" 22nd IAP, 303rd DPVO, 11th Air Army, VKS

RF-95495 "蓝色25"俄罗斯空军第11航空军第303近卫混成师第22近卫歼击团

